

SPECIFICATION & FEATURES

DROP-ON-BAR SLIDER BRACKET FOR SQUARE BOXES

DESCRIPTION:

Orbit's Drop-On-Bar Slider Brackets, the BARB and BARB-CS, provide a quick and efficient solution for mounting 4" and 4-11/16" boxes onto Orbit's Adjustable Bar Hangers, BHA-16 & BHA-24, even after the Hangers are installed. Once mounted, boxes can be fully adjusted along the Bar Hanger for precise positioning before securing. For 4" Pancake Boxes (Vanity Lights) and Multigang box applications, see the BARB-SLIM.

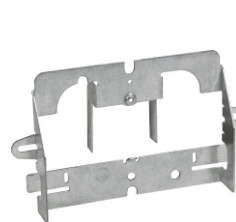

BARB



BARB-CS

CERTIFICATION:

UL file E310661, E227970, Patented



FEATURES:

- Quickly attaches to any 4" or 4-11/16" Square Box with just one tek screw.
- Easily drops onto BHA-16 & BHA-24 Adjustable Bar Hangers, which accomodates 1-1/2", 2-1/8" and 2-1/2" deep boxes, and can be installed between ceiling joists or wall studs.
- Once on a BHA, the BARB and box assembly can be repositioned along the hanger
- A full box assembly can be prefabricated onto the Bar Hanger by bending the locking tabs.
- Multiple box assemblies can be easily added before and after the Bar Hanger is installed.
- Allows for the installation of up to 2 boxes between 16" studs and 4 between 24" studs
- BARB-CS comes complete with conduit & cable support pin holes
- Compatible with Angled MC Cable Box (4SDB-AMC-PT)
- Secure cable with device ring on
- Patented

CONFIGURATION DATA:

Cat. No.	Description	Std.Pkg.
BARB	Drop-On-Bar Slider Bracket	50
BARB-CS	Drop-On-Bar Slider Bracket With Conduit & Cable Support Pin Holes	50
BHA-16	11" to 18" Adjustable box bracket-Mount Box with self-tapping screws on notches between ceiling joists or wall studs. Ends bend and wrap around stud-Can be used with boxes 1-1/2", 2-1/8" or 2-1/2" Deep	50
BHA-24	15-3/4" to 26" Adjustable box bracket-Mount Box with self-tapping screws on notches between ceiling joists or wall studs. Ends bend and wrap around stud-Can be used with boxes 1-1/2", 2-1/8" or 2-1/2" Deep	50

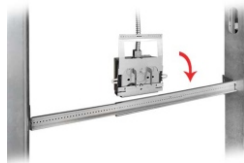

BARB Dropping on BHA

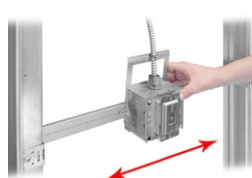

BARB-CS Installed Adjustment



BARB-CS Installed 4 Boxes



BARB-CS Installing on Box



BARB-CS Installed 4 Boxes 2



BARB Locked on BHA



www.orbitelectric.com

Application and Performance Specification Information is Subject to Change Without Notification

LOS ANGELES, CA 1-800-90-ORBIT

