

## SPECIFICATION & FEATURES

### DESCRIPTION:

Orbit Industries' side mount snap close conduit to flange clips can be easily and fast installed to beam flanges from 1/8" to 3/4" with only a hammer. The clips support EMT and rigid conduits from the side of beams and the conduit clamp can be snapped easily. The rotatable joint allows the snap-close conduit clip to rotate 360° to fit conduits in different directions.

### CERTIFICATION:

UL file E328572, conforms to UL 2239.

### FEATURES:

- Spring Steel
- Available for EMT, rigid and aluminum conduit
- Snap close clip can pivot through 360°
- Easy installation

## CONDUIT TO FLANGE CLIPS SIDE MOUNT, SNAP CLOSE 1/2" ~ 2" EMT, 1/8" ~ 3/4" FLANGE

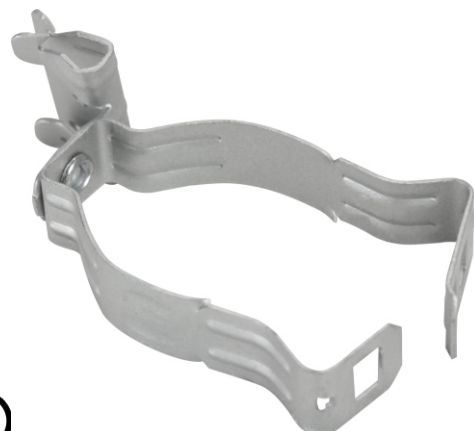

### CONFIGURATION DATA:

Part No.	Flange Thickness	EMT/Rigid Size	FMC Size	MC/AC Size	Static Load	Std. Pkg.
F6M24SM	1/8" ~ 1/4"	-	3/8"	14-2 ~12-3	25 LB	100
F6M58SM	5/16" ~ 1/2"	-	3/8"	14-2 ~12-3	25 LB	100
F6M912SM	9/16" ~ 3/4"	-	3/8"	14-2 ~12-3	25 LB	100
F812M24SM	1/8" ~ 1/4"	1/2", 3/4"	-	-	25 LB	100
F812M58SM	5/16" ~ 1/2"	1/2", 3/4"	-	-	25 LB	100
F812M912SM	9/16" ~ 3/4"	1/2", 3/4"	-	-	25 LB	100
F16M24SM	1/8" ~ 1/4"	1"	-	-	25 LB	100
F16M58SM	5/16" ~ 1/2"	1"	-	-	25 LB	100
F16M912SM	9/16" ~ 3/4"	1"	-	-	25 LB	50
F20M24SM	1/8" ~ 1/4"	1-1/4"	-	-	25 LB	100
F20M58SM	5/16" ~ 1/2"	1-1/4"	-	-	25 LB	100
F20M912SM	9/16" ~ 3/4"	1-1/4"	-	-	25 LB	100
F24M24SM	1/8" ~ 1/4"	1-1/2"	-	-	25 LB	50
F24M58SM	5/16" ~ 1/2"	1-1/2"	-	-	25 LB	50
F24M912SM	9/16" ~ 3/4"	1-1/2"	-	-	25 LB	50
F32M24SM	1/8" ~ 1/4"	2"	-	-	25 LB	50
F32M58SM	5/16" ~ 1/2"	2"	-	-	25 LB	50
F32M912SM	9/16" ~ 3/4"	2"	-	-	25 LB	50

