

## SPECIFICATION & FEATURES

## INSULATED CONDUIT CHASE NIPPLES

### DESCRIPTION:

Orbit Industries conduit Chase nipples with insulated throat are used to effectively bush factory or field-punched, cut, or drilled holes in metal boxes or enclosures. They are also used to couple boxes back-to-back.



### CERTIFICATION:

UL file E310658, Conforms to UL 514B



### FEATURES:

- Zinc Die Cast
- With Insulated Throat (Yellow, Throat color may vary)
- Meets Federal Spec. A-A-50553

### LINE DRAWINGS:

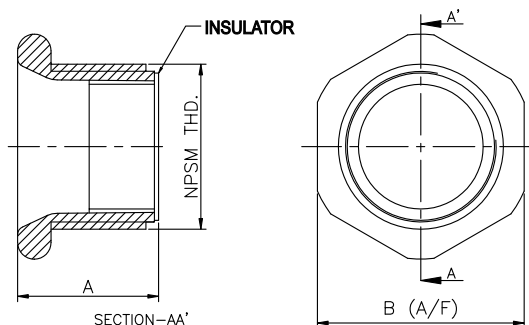

### CONFIGURATION DATA:

Part No.	Trade Size	A (in)	B (in)	Std.Pkg.	Master Ctn.
CNI-50	1/2"	0.685	0.976	100	1000
CNI-75	3/4"	0.736	1.177	100	1000
CNI-100	1"	0.839	1.496	50	500
CNI-125	1-1/4"	0.996	1.772	25	250
CNI-150	1-1/2"	1.122	2.106	25	250
CNI-200	2"	1.122	2.606	15	90
CNI-250	2-1/2"	1.181	3.071	2	10
CNI-300	3"	1.339	3.720	2	10
CNI-350	3-1/2"	1.339	4.244	-	5
CNI-400	4"	1.339	4.685	-	5

