

SPECIFICATION & FEATURES

MALLEABLE IRON THREADED CONDUIT BODIES "T" SERIES

DESCRIPTION:

Orbit Industries' malleable conduit bodies are zinc plated malleable iron with high tensile strength and ductility. High corrosion-resistance, high impact and shock resistance. Smooth and rounded integral bushings for protection of wire insulation. They are interchangeable with appleton Form 35 and Cooper Crouse Hinds Form 5 conduit bodies.



CERTIFICATION:

UL file E227970, Conforms to UL 514A



FEATURES:

- Malleable Iron
- Electroplated Zinc
- Suitable for wet location when used with Gasket and Cover
- NPT Thread Hubs

LINE DRAWINGS:

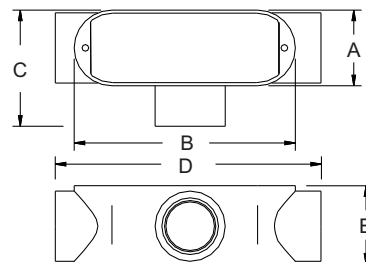

CONFIGURATION DATA:

Part No.	Trade Size	A (in)	B (in)	C (in)	D (in)	E (in)	Max. no. of conductors	Volumn (Cu. In.)	Std.Pkg.
MT-50	1/2"	1-3/8"	4"	2-1/16"	5-7/16"	1-7/16"	-	4.000	10
MT-75	3/4"	1-5/8"	4-11/16"	2-5/16"	6-3/16"	1-11/16"	3#6	7.000	10
MT-100	1"	1-13/16"	5-3/8"	2-11/16"	7-3/16"	2"	3#4	12.000	5
MT-125	1-1/4"	2-1/2"	7-1/4"	3-7/16"	9"	2-11/16"	3#2	33.000	2
MT-150	1-1/2"	2-1/2"	7-1/4"	3-7/16"	9-1/16"	2-13/16"	3#1	36.000	2
MT-200	2"	3-3/16"	9-1/2"	4-1/8"	11-1/2"	3-1/2"	3#2/0	76.000	1
MT-250	2-1/2"	4-7/16"	12-1/4"	5-7/8"	15-5/16"	4"	3#300	146.000	1
MT-300	3"	4-7/16"	12-1/4"	5-15/16"	15-7/16"	4-11/16"	3#300	185.000	1
MT-350	3"-1/2"	5-1/2"	15"	7-1/8"	18-5/16"	5-7/16"	3#350	300.000	1

