

## SPECIFICATION & FEATURES

## MALLEABLE IRON THREADED CONDUIT BODIES "C" SERIES

### DESCRIPTION:

Orbit Industries' malleable conduit bodies are zinc plated malleable iron with high tensile strength and ductility. High corrosion-resistance, high impact and shock resistance. Smooth and rounded integral bushings for protection of wire insulation. They are interchangeable with appleton Form 35 and Cooper Crouse Hinds Form 5 conduit bodies. Built-in easy-pulling rollers is optional from 1-1/4" to 4", eliminate damage when cable is pulled through hubs.



### CERTIFICATION:

UL file E227970, Conforms to UL 514A



### FEATURES:

- Malleable Iron
- Electroplated Zinc
- Suitable for wet location when used with Gasket and Cover
- NPT Thread Hubs

### LINE DRAWINGS:

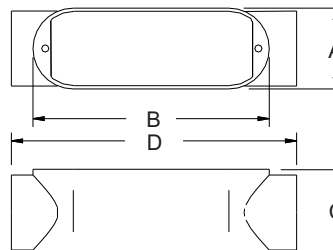

### CONFIGURATION DATA:

Part No.	Trade Size	A (in)	B (in)	C (in)	D (in)	Max. no. of conductors	Volumn (Cu. In.)	Std.Pkg.
MC-50	1/2"	1-3/8"	4"	1-1/2"	5-7/16"	-	4.5	10
MC-75	3/4"	1-9/16"	4-11/16"	1-11/16"	6-3/16"	3#6	7.5	10
MC-100	1"	1-13/16"	5-7/16"	2"	7-3/16"	3#4	12.5	5
MC-125	1-1/4"	2-1/2"	7-1/4"	2-5/8"	9-1/16"	3#2	35	2
MC-150	1-1/2"	2-1/2"	7-1/4"	2-13/16"	9-1/16"	3#1/0	35.3	2
MC-200	2"	3-3/16"	9-1/2"	3-1/2"	11-1/2"	3#4/0	75	1
MC-250	2-1/2"	4-7/16"	12-1/4"	4"	15-5/16"	3#300	153	1
MC-300	3"	4-7/16"	12-1/4"	4-5/8"	15-7/16"	3#300	181	1
MC-350	3-1/2"	5-1/2"	15"	5-7/16"	18-5/16"	3#350	300	1
MC-400	4"	5-1/2"	15"	5-3/4"	18-5/16"	3#350	330	1

