

SPECIFICATION & FEATURES

MALLEABLE IRON THREADED CONDUIT BODIES "LL" SERIES

DESCRIPTION:

Orbit Industries' malleable conduit bodies are zinc plated malleable iron with high tensile strength and ductility. High corrosion-resistance, high impact and shock resistance. Smooth and rounded integral bushings for protection of wire insulation. They are interchangeable with appleton Form 35 and Cooper Crouse Hinds Form 5 conduit bodies.



CERTIFICATION:

UL file E227970, Conforms to UL 514A



FEATURES:

- Malleable Iron
- Electroplated Zinc
- Suitable for wet location when used with Gasket and Cover
- NPT Thread Hubs

LINE DRAWINGS:

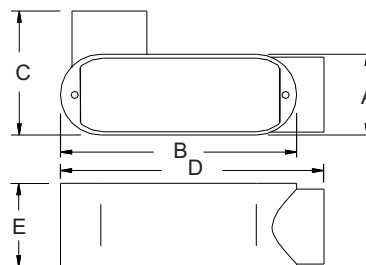

CONFIGURATION DATA:

| Part No. | Trade Size | A (in) | B (in) | C (in) | D (in) | E (in) | Max. no. of conductors | Volumn (Cu. In.) | Std.Pkg. |
|----------|------------|----------|----------|----------|-----------|----------|------------------------|------------------|----------|
| MLL-50 | 1/2" | 1-3/8" | 4" | 2-1/16" | 4-11/16" | 1-7/16" | - | 4.5 | 10 |
| MLL-75 | 3/4" | 1-5/8" | 4-11/16" | 2-1/4" | 5-7/16" | 1-11/16" | 3#6 | 7.5 | 10 |
| MLL-100 | 1" | 1-13/16" | 5-3/8" | 2-11/16" | 6-1/4" | 2" | 3#4 | 12.5 | 5 |
| MLL-125 | 1-1/4" | 2-1/2" | 7-1/4" | 3-7/16" | 8-1/8" | 2-5/8" | 3#2 | 32 | 2 |
| MLL-150 | 1-1/2" | 2-1/2" | 7-1/4" | 3-7/16" | 8-1/8" | 2-13/16" | 3#2 | 35.3 | 2 |
| MLL-200 | 2" | 3-1/8" | 9-1/2" | 4-3/16" | 10-1/2" | 3-9/16" | 3#4/0 | 73 | 1 |
| MLL-250 | 2-1/2" | 4-3/8" | 12-1/4" | 5-7/8" | 13-3/4" | 4" | 3#300 | 142 | 1 |
| MLL-300 | 3" | 4-3/8" | 12-1/4" | 5-15/16" | 13-13/16" | 4-11/16" | 3#350 | 173 | 1 |
| MLL-350 | 3-1/2" | 5-1/2" | 15" | 7-1/8" | 16-5/8" | 5-7/16" | 3#350 | 300 | 1 |

