

## SPECIFICATION & FEATURES

## LOW VOLTAGE PARTITION

### DESCRIPTION:

Partition for 1-5/8" Deep SB Boxes & 2-1/2" Deep SDB Boxes with raised or flat Covers. It is constructed from 16 gauge galvanized steel.

### CERTIFICATION:

UL file E227970, conforms to UL514A.

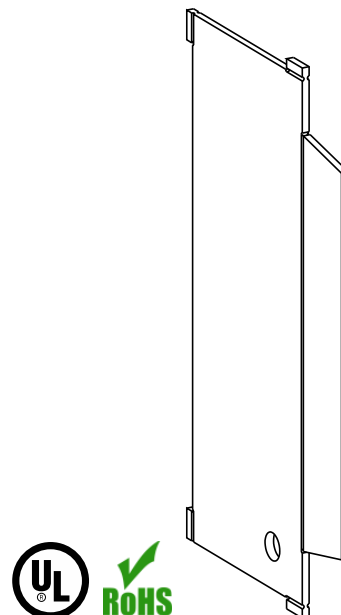

## CONFIGURATION DATA

Catalog No.	Description	Std. Pkg.
SB-D	Partition for 1-5/8" SB Boxes, flat or raised cover	25
SDB-D	Partition for 1-5/8" Deep SB Boxes, flat, and 2-1/2" SDB Boxes, flat or raised cover	25



SB-D

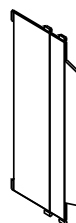

SDB-D

