

CONDUIT LOCKING CONNECTOR WITH SEISMIC WIRE HOLES



CLCSL Series



SOLUTION TO SECURE

Fixtures From Rotating

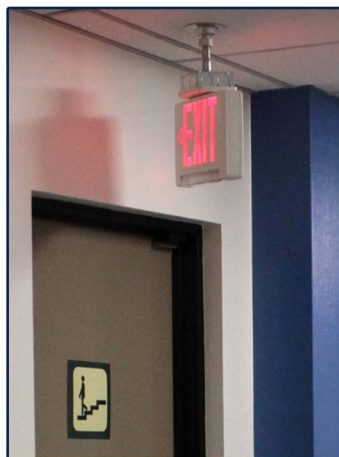

Before Installation



After Installation Prevents Rotation

The first of its kind, the Conduit Locking Connector is designed to secure fixture installations and prevent the rotation of outlet boxes. Holes are also included for seismic wiring connections offering protection against seismic disturbances.

PATENT PENDING

CONDUIT LOCKING CONNECTOR WITH SEISMIC WIRE HOLES



FEATURES

- Fits 4", 4-11/16" and 40 junction boxes as well as Orbit's patented EALB
- Available for 1/2" and 3/4" threaded conduits.
- Hooks prevent rotation of fixtures such as security cameras and emergency lighting
- Holes allow for use of seismic wiring for added protection against seismic disturbances
- Includes set-screw and locknut for secure conduit installations

INSTALLATION



1 Fasten CLCSL to threaded conduit



2 Tighten set-screw to secure conduit



3 Using center KO, mount to box using hooks on CLCSL



4 Secure conduit to box using locknut



5 Mount seismic wires to surroundings and tie to holes of CLCSL



Cat. No.	Trade Size	Std. Pkg.	Master Ctn.
CLCSL-50	1/2"	10	100
CLCSL-75	3/4"	10	100