

INSTALLATION INSTRUCTIONS

PVC FLOOR BOX AND ADAPTER

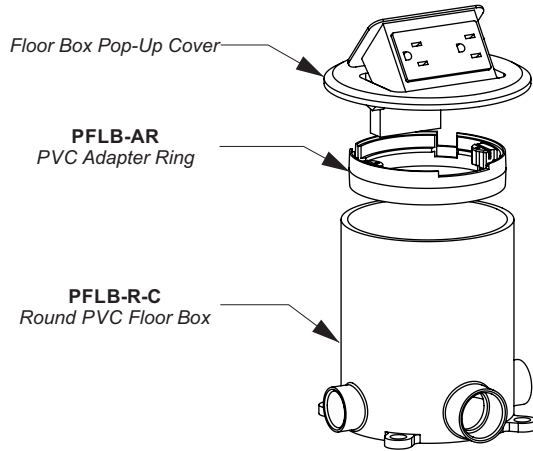

Note: Floor Box, Adapter Ring, and Covers all sold separately.

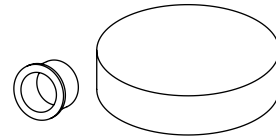

PFLB-R-C includes plastic cap and 4 reducer plugs (1" x 3/4")

* Knock KO out on plugs for 3/4" conduit use

Installation Steps:

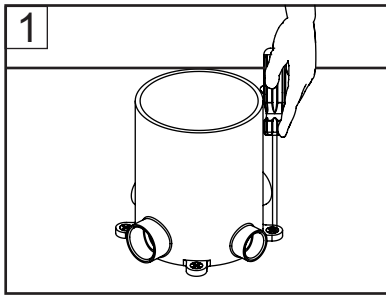

Secure floor box to level surface.

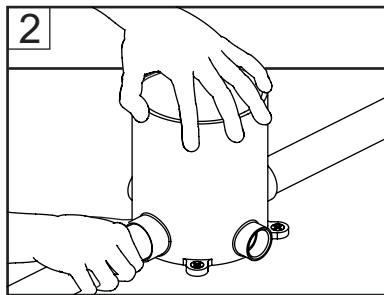

Install solvent cementing conduit into floor box outlets.

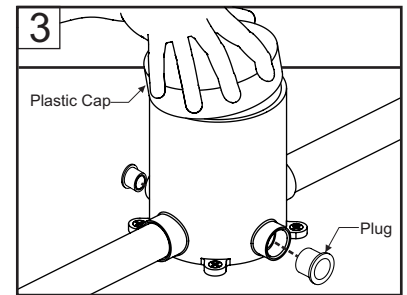

Install plastic cap and seal unused outlets. Apply concrete.

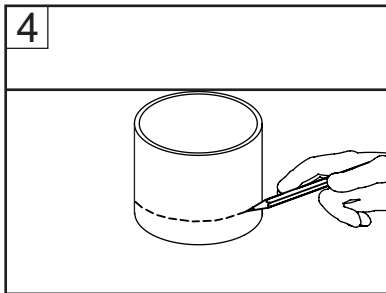

Scribe line on floor box based on finished floor thickness.

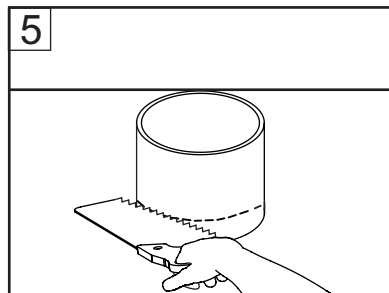

Using line as a guideline, cut excess material with saw.

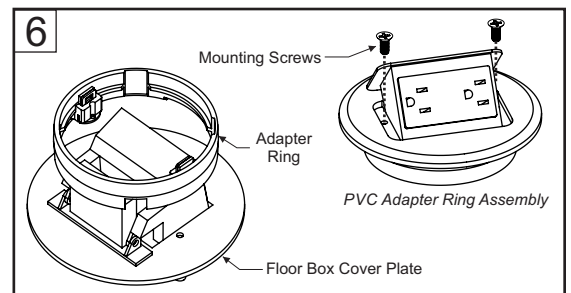

Install PVC Adapter Ring to desired round floor box cover.

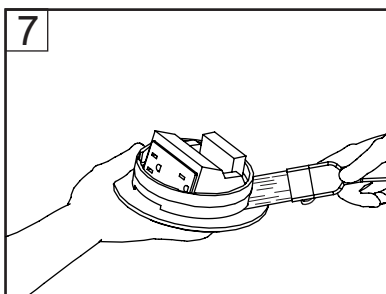

Apply solvent cement to PVC Adapter Ring.

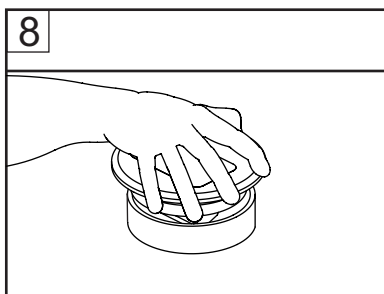

Mount PVC Adapter Ring Assembly to floor box.

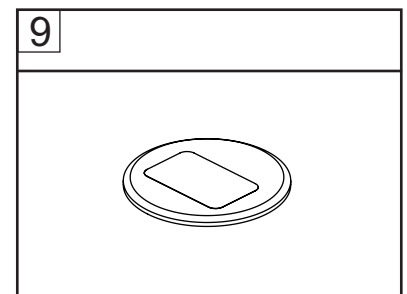

Finished Installation.

Compatibility Table

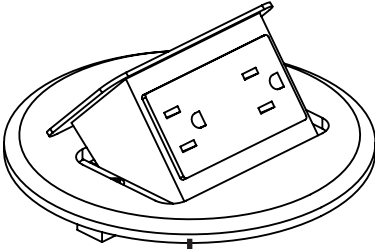
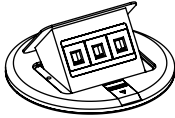
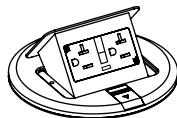
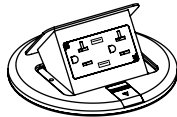

Orbit Covers:

	Finish:	Part Number:
	Brass	FLBPU-D-R-C-BR
	Stainless Steel	FLBPU-D-R-C-SS
	Brass	FLBPU-L-R-C-BR
	Stainless Steel	FLBPU-L-R-C-SS
	Brass	FLBPU-G-R-C-BR
	Stainless Steel	FLBPU-G-R-C-SS
	Brass	FLBPU-DU-R-C-BR
	Stainless Steel	FLBPU-DU-R-C-SS

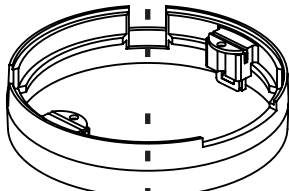
Adapter Ring:

Adapter Ring:	Description:	Part Number:
	Fits Round Covers	PFLB-AR

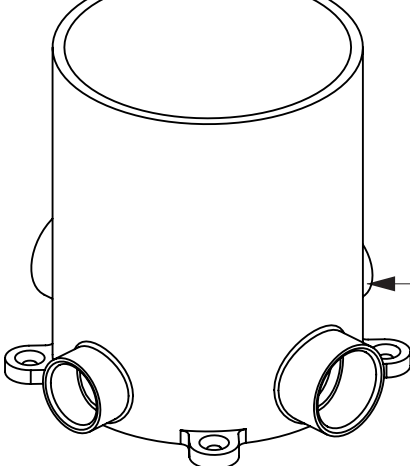
Floor Box:

Floor Box:	Accessories:	Part Number:
	 Plastic Cap x1  Reducer Plug x4 (1" x 3/4")	PFLB-R-C