

STUD WALL BRACKETS

SLIM DROP-ON-BAR SLIDER BRACKET

PRODUCT FEATURES

- ▶ Ideal Prefab solution for mounting vanity lights
- ▶ Allows use of back K.O. for vanity light
- ▶ Mounts one 4" pancake box with a single BARB-SLIM; multigang boxes with two
- ▶ Pancake box center sits 1-1/2" above the BHA-16 or BHA-24 centerline for K.O. access
- ▶ Recommend using sharp-point wafer head screws when securing to boxes
- ▶ Secures to BHA-16 or BHA-24 bar hangers
- ▶ Drops onto bar hanger and adjust box location before final screw placement
- ▶ Supports multi-box assemblies before or after bar installation

Cat. No.	Description	Std. Pkg.
BARB-SLIM <small>NEW</small>	Slim Drop-On-Bar Slider Bracket for Pancake & Multigang Boxes	50



BARB-SLIM

The only Vanity Light Prefab Solution

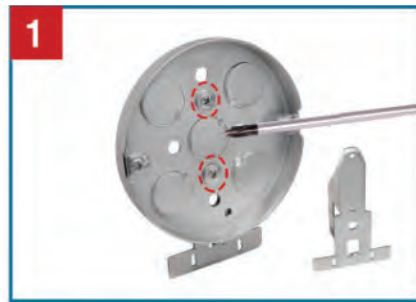

1 Mount using two sharp-point wafer-head screws. (Note: Ensure the pancake box has four holes aligned properly when installing the screws.)

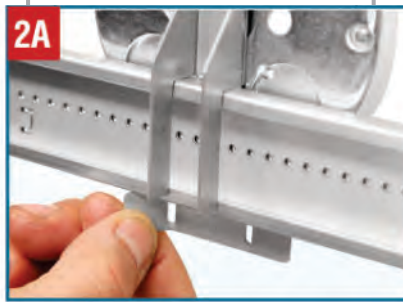

2A For preassembly and transportation, drop the BARB-SLIM onto the Bar Hanger and bend the locking tab to secure it in place.



2B Place the BARB-SLIM onto the Bar Hanger. Ensure the Bar Hanger height is 1-1/2" lower than the desired position of the light fixture. (Note: The BARB-SLIM raises the pancake box by 1-1/2" to allow back KO access.)

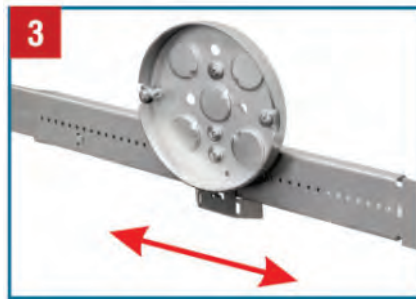

3 Adjust the BARB-SLIM left to right on the Bar Hanger to the desired location.

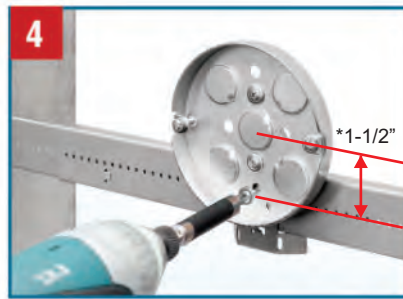

4 Secure the BARB-SLIM to the Bar Hanger at the front face attachment point using oneTek screw.



*Ensure box center is positioned 1-1/2" above the BHA-16 or BHA-24 centerline for K.O. access.

ADJUSTABLE BAR HANGER

PRODUCT FEATURES

- ▶ Electroplated Zinc
- ▶ Ends bend and wrap around studs
- ▶ Can be used with boxes 1-1/2", 2-1/8" or 2-1/2" deep
- ▶ For stud and hard lid ceiling joists

SHIPS PREASSEMBLED

Cat. No.	Description	Std. Pkg.
BHA-16	Adjustable Box Bracket 11" to 18" - Mount box with self-tapping screws	50
BHA-24	Adjustable Box Bracket 15-3/4" to 26" - Mount box with self-tapping screws	50



BHA-16

Adjust from 11" to 18"



BHA-24

Adjust from 15-3/4" to 26"

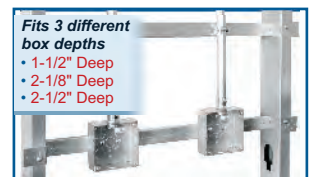

Fits 3 different box depths

- 1-1/2" Deep
- 2-1/8" Deep
- 2-1/2" Deep

BOX AND CONDUIT SUPPORT BETWEEN STUDS USING BHA