

# Prefab Products





## Innovative Labor Saving Solutions

As an electrical manufacturer founded by contractors, Orbit knows the importance of having products that solve problems. Since Orbit was founded in 1997, we have consistently developed innovative electrical products, establishing ourselves as a forward-thinking and solutions-based manufacturer.

Today, our prefab line continues to deliver engineered solutions for optimizing job site productivity and flexibility during installations. Every product is designed with contractors in mind to provide the following features:

- Efficient installations for reduced labor
- Increase safety and bring the construction environment to a controlled environment
- Allow contractors to bid and complete jobs more effectively
- A reduction of on-site mistakes and waste

## The Orbit Advantage

With a team of industry experienced sales representatives and talented engineers, Orbit provides innovative and high quality products with a convenience not found anywhere else.

The Orbit Advantage include:

- State-of-the-art automated manufacturing facilities that consistently product quality products
- Industry experienced sales and engineering teams
- 98.7% fill rate with over 7,000 products in more than 12 different product lines, all ready to ship
- Compliance with current safety standards and electrical codes

**PROFAB**  
ENGINEERED ELECTRICAL SYSTEMS

NEW



*For more information on Orbit's  
Engineered Electrical Systems, email  
**info@orbitprefab.com***

A Division of **orbit**



## Simple Support Bracket | Pg. P1~2

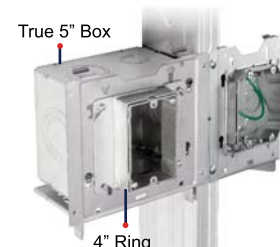

Prefab Products

### PREFAB STUD BRACKET SYSTEM, SNAP BOXES ON TO ADD MORE

*Patented*

The Simple Support Bracket (SSB) is the most versatile adjustable bracket on the market. Available as individual components or preassembled with a 4" (SSB-4S-MKO) or 4-11/16" (SSB-5S-MKO) Sq. Box, there isn't an application it cannot accomplish. Adjusts from 15" - 25", the SSB maintains rigidity throughout, eliminating the need of a Box Back Support. In addition to standard square boxes, the SSB will also accept multigang boxes.

## Drop-On-Bar Slider Brackets | Pg. P4



BARB

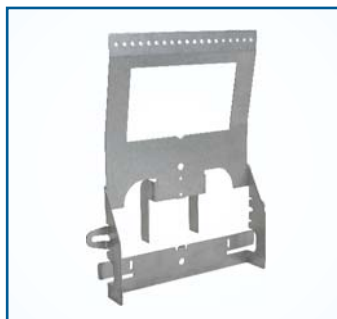

BARB-CS

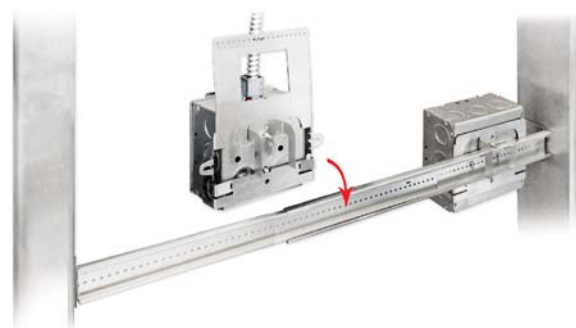

### QUICKLY DROP BOXES ONTO ADJUSTABLE BAR HANGERS

*Patent Pending*

The Drop-On-Bar Slider Brackets attach to 4" and 4-11/16" square boxes, creating a versatile box assembly which can then be dropped onto Orbit's Adjustable Bar Hanger and conveniently repositioned. This unique method of box on bracket allows the installer to Prefab using traditional Adjustable Bar Hangers (BHA-16 & 24). The BARB-CS features pin holes for cable support.



## Height Adjustable Box Installation Template | Pg. P11



FRONT



BACK



STACKED



2017 NECA  
**Show  
Stopper**

**THE MORE YOU USE IT,  
THE MORE YOU SAVE**

*Patent Pending*

The Height Adjustable Box Installation Template (HABIT) is a reusable tool used to mount boxes and brackets at a consistent height. The HABIT's adjustable, magnetic platform can be preset in heights up to 21". Built-in magnets firmly hold assemblies in place for a uniform installation. Multiple HABITs can even be stacked, allowing for installations in heights up to 49".

## Roof Coupling Plates | Pg. P12



RCP



**THE ULTIMATE SUPPORT  
FOR CONDUIT STUBS ON  
BUILDING ROOFS**

*Patent Pending*

The Roof Coupling Plate (RCP) provides installers with a fast, efficient solution for routing conduit through rooftop penetrations. Once fastened, the RCP will eliminate conduit movement for up to 5' above or below the roof line. These plates are perfect for electrical and HVAC power or control available in all major trade sizes from 1/2" up to 2".





## Recessed Light Adapter Plates | Pg. P13

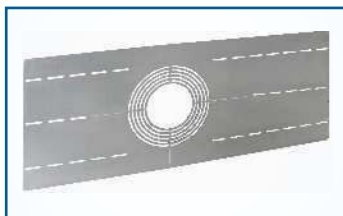

RAP



RAP-T



**INSTALL DOWNLIGHTS UP TO  
4X FASTER THAN TRADITIONAL  
INSTALLATION METHODS**

*Patented*



The Industry-First Recessed Light Adapter Plates allow for a fast and convenient installation of recessed lighting fixtures. Available for Hard Lid (RAP) and T-Bar (RAP-T) applications. Each plate features multiple CKOs that accommodate most 4" - 8" round and up to 5-1/4" square luminaires with ease. The RAP fits up to a 26" stud spacing via its slotted holes, while the RAP-T drops into any 2' wide T-Bar grids.

## Box & Conduit Hanger Support Plates | Pg. P14



BCHS-10



BCHS-6S

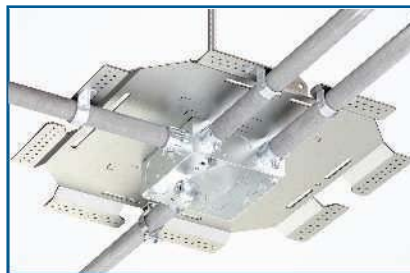

BCHS-6

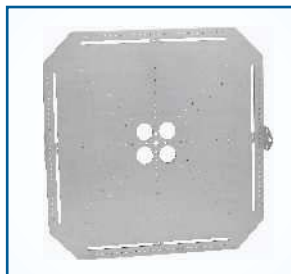

BCHS-12

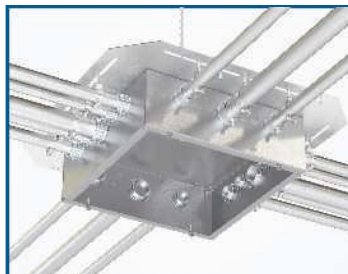

**HANG BOXES & CONDUITS  
WITH ONLY ONE PLATE  
AND ROD!**

*Patented*



Replace the traditional method of suspended conduit installations with the Box & Conduit Hanger Support Plates (BCHS). Installers can now use one piece of all-thread and one plate to support multiple conduits instead of measuring and cutting multiple pieces of rod. The more pieces of conduit involved, the more saving the BCHS plates will provide. BCHS-10, 6, 6S fit up to 8" x 8" Junction boxes, whereas the BCHS-12 fits up to 12" x 12" Junction Boxes or multiple smaller size boxes.

## SIMPLE SUPPORT BRACKETS AND ACCESSORIES

### PRODUCT FEATURES

- ▶ Telescoping bracket adjusts from 15" to 25"
- ▶ SSB assemblies ready to install out of the box with choice of box size and 10" Pigtail, saving time and reducing injuries
- ▶ SSB-TBAR includes two riveted clips for T-bar drop ceiling installation
- ▶ UMA or UMA-LVBS can either mount-to-stud directly or clip onto bracket
- ▶ Rigidity eliminates need for far-side back support
- ▶ Markings on bracket allow for quick and consistent adjustability
- ▶ SSB compatible with all Adjustable Rings (Pg. P17-18)

### NOTE

SSB must be accompanied with either UMA, UMA-LVBS, WBAR1G or WBAR2G mounting brackets to attach a steel box



Video Available  
On Our Website!

Cat. No.	Description	Std. Pkg.
<b>SSB</b>	Simple Support Bracket adjusts from 15" to 25" for mounting boxes horizontally between stud	25
<b>SSB-TBAR</b> <small>NEW</small>	SSB with T-bar Drop Ceiling Mounting Clips	20
<b>UMA</b>	Universal Mounting Adapter for 4" and 4-11/16" Boxes to mount to SSB, USB, and directly to stud	25
<b>UMA-LVBS</b> <small>NEW</small>	Universal Mounting Adapter w/ Back Support, Stud Mounts 4", 4-11/16" & 5" Boxes. ONLY 4" and 4-11/16" snap onto the SSB, USB brackets	25
<b>SSB-4S-MKO</b>	Preassembled SSB with UMA and 4" Sq. 2-1/8" Deep Box with MKO and 10" Ground Pigtail	12
<b>SSB-5S-MKO</b>	Preassembled SSB with UMA and 4-11/16" Sq. 2-1/8" Deep Box with MKO and 10" Ground Pigtail	12
<b>LVSB1</b>	Low Voltage Stud Mounting Bracket 1-Gang, 1/2" raise	50
<b>LVSB2</b>	Low Voltage Stud Mounting Bracket 2-Gang, 1/2" raise	25
<b>UMAB</b>	4" Square Box 3-1/2" Deep Adjustable Up to 1-1/2". Adapter Included	10
<b>FA-UMAB</b>	Fire Alarm 4" Square Box 3-1/2" Deep Adjustable Up to 1-1/2". Adapter Included	10

\*SSB-4S replaced by SSB-4S-MKO



SSB



NEW SSB-TBAR

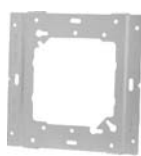

UMA



NEW UMA-LVBS



SSB-4S-MKO  
SSB-5S-MKO



LVSB1



LVSB2



UMAB



FA-UMAB

## FEATURES

UMA:  
4" & 4-11/16" Sq. Box Adapter  
Compatible with all Adjustable Rings

Mounting hole and center cutout  
for a quick, leveled installation

Markings for quick  
and consistent  
adjustability

Adjustable 15" to 25"



**SNAP-IN**

UMA-LVBS easily clips onto SSB



Secure SSB-TBAR to grid using a Tek Screw to comply with NEC 314.23 (D)(1)

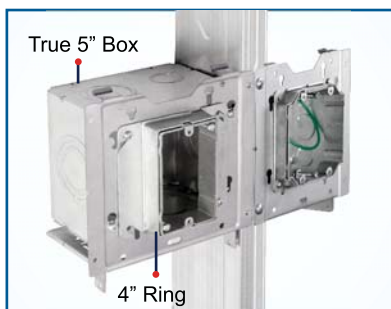

UMA-LVBS mounted directly-to-stud



4" or 4-11/16" Box on UMA-LVBS and Low Voltage Ring

***Almost any combination of box and ring can be installed!***

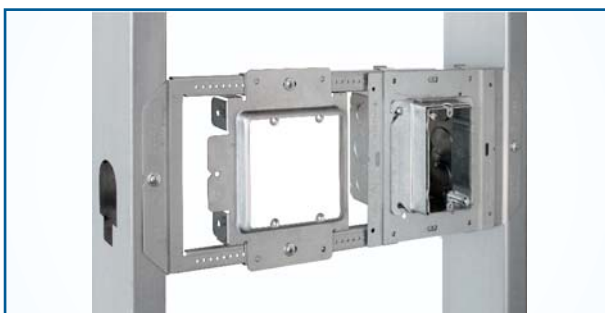

4" or 4-11/16" Box and Low Voltage Ring



Fit up to Three 4" and/or 4-11/16" Boxes and Rings



UMAB Installed for Ceiling Applications

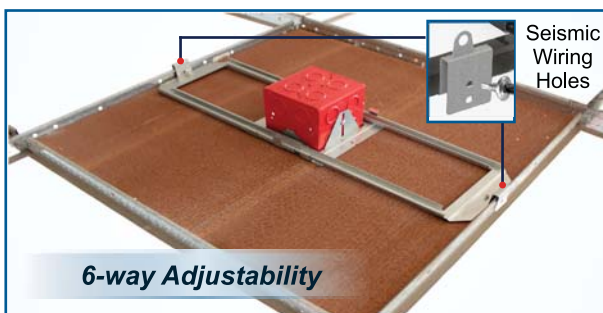

SSB-TBAR with UMAB Installed in Drop Ceiling Grid



Up to 10-Gang Multi-Gang Box Between 24" Studs



4" or 4-11/16" Box/Ring and Multi-Gang Box/Ring

**Endless Variations!**

## TELESCOPING SUPPORT BRACKET

### PRODUCT FEATURES

- ▶ Telescoping bracket adjusts from 16" to 27"
- ▶ Accepts 4", 4-11/16" square, and up to 10-Gang boxes and rings
- ▶ Easily adjust position of boxes in field
- ▶ Packaged preassembled and ready to use.
- ▶ Markings on bracket allow for quick and consistent adjustability
- ▶ Rigidity eliminates need for far-side back support

**SHIPS  
PREASSEMBLED**



**Video Available  
On Our Website!**

Cat. No.	Description	Std. Pkg.
TSB	Telescoping Support Bracket adjusts from 16" to 27" for mounting 4", 4-11/16" square and up to 10-gang boxes between studs.	25

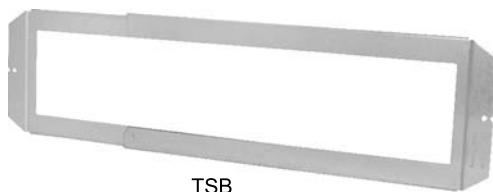

TSB



*Extra bend ensures a sturdy design*

### FEATURES

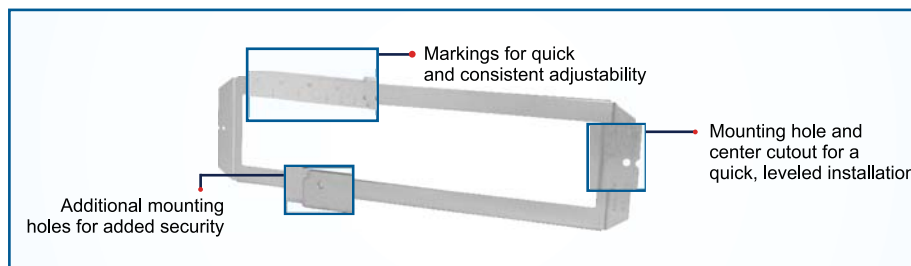

## INSTALLATION



Fits 4", 4-11/16" square, and up to 10-Gang boxes

## ADJUSTABLE BAR HANGER

### PRODUCT FEATURES

- ▶ Ends bend and wrap around stud
- ▶ Can be used with boxes 1-1/2", 2-1/8" or 2-1/2" deep

**SHIPS  
PREASSEMBLED**

Cat. No.	Description	Std. Pkg.
BHA-16	11" to 18" Adjustable Box Bracket - Mount box with self-tapping screws	50
BHA-24	15-3/4" to 26" Adjustable Box Bracket - Mount box with self-tapping screws	50



BHA-16



BHA-24

**NEW DESIGN**

Adjust from 15-3/4" to 26"

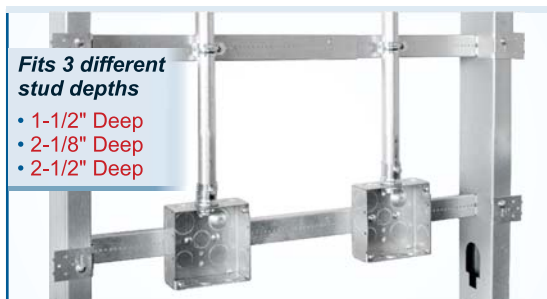

### BOX AND CONDUIT SUPPORT BETWEEN STUDS USING BHA

BHA-16 adjusts from 11" up to 18"  
BHA-24 adjusts from 15-3/4" up to 26"





## DROP-ON-BAR SLIDER BRACKETS

### PRODUCT FEATURES

- ▶ Quickly attach to any 4" or 4-11/16" square box
- ▶ Easily drops onto Orbit's BHA-16 and BHA-24
- ▶ A BARB and box assembly can easily be repositioned along the hanger
- ▶ Multiple BARB assemblies can be added before and after the BHA is installed
- ▶ Can be fully prefabricated and locked onto the BHA without setting final box position
- ▶ BARB-CS comes complete with cable support pin holes



Video Available  
On Our Website!

Cat. No.	Description	Std. Pkg.
<b>BARB</b> <small>NEW</small>	Drop-On-Bar Slider Bracket	50
<b>BARB-CS</b> <small>NEW</small>	Drop-On-Bar Slider Bracket with conduit & cable support pin holes	50



NEW BARB



NEW BARB-CS

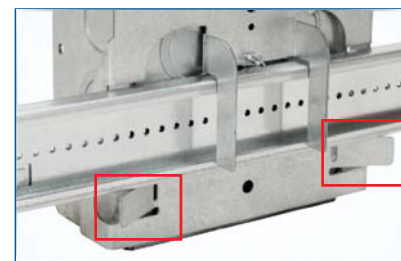

A BARB and box assembly can be locked onto a BHA before arriving on the job site for quick adjustment in the field.

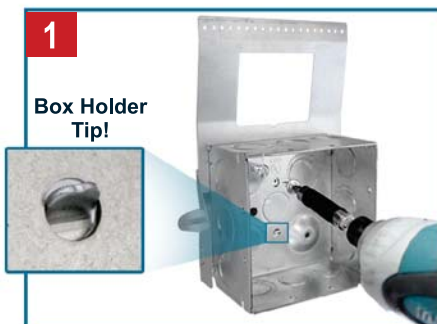

Attach to a 4" or 4-11/16" box with a single tek screw, forming a versatile box assembly



Box assemblies can be prefabricated onto a BHA before arriving to the job site, locking onto the hanger via its bendable tabs

-OR-



For in-field installations, simply drop the box assembly onto a BHA before or after the hanger has been installed

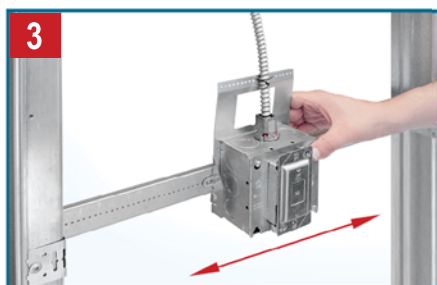

Once the BHA is installed on studs, the box assembly can be adjusted along the hanger

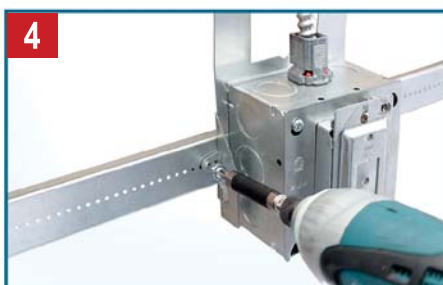

Secure the assembly to the BHA with tek screws, setting the box in place



Multiple box assemblies can be easily added!  
Up to 3 between 16" & 4 between 24" studs

## ULTIMATE SUPPORT BRACKETS AND ACCESSORIES

### PRODUCT FEATURES

- ▶ Can be floor or wall mounted on wooden or metal studs
- ▶ Infinite height and width combinations
- ▶ Provides flexibility at job site
- ▶ Works great with Orbit's Adjustable Rings
- ▶ Markings on bracket allow for quick and consistent adjustability.

### NOTE

USB must be accompanied with either US4SB, UMA, UMA-LVBS, WBAR1G or WBAR2G mounting brackets to attach a steel box

Cat. No.	Description	Std. Pkg.
<b>USB</b>	Ultimate Support Bracket, Adj. 8"-24" as a floor brkt or 14"-24" as a wall brkt between studs	12
<b>US4SB</b>	Mounting Bracket for 4" Square Box, snaps to USB	24
<b>UMA</b>	Universal Mounting Adapter for 4" and 4-11/16" Boxes to mount to USB, and directly to stud	25
<b>USDBM</b>	For use with USB to create a double box in floor mount assembly with built-in back support	50
<b>USTBM</b>	For use with USB to create a triple box in floor mount assembly with built-in back support	50
<b>USTS</b>	USB floor mount stud-to-stud top support	50
<b>USB-4SDB-50/75-PT</b>	Complete Pre-Assembled Floor Bracket with a 4" Square 2-1/8" Deep Box, Includes installed Far-Side Back Support and Ground Pigtail	12
<b>USB-5SDB-50/75-PT</b>	Complete Pre-Assembled Floor Bracket with a 4-11/16" Square 2-1/8" Deep Box, Includes installed Far-Side Back Support and Ground Pigtail	12
<b>LVSB1</b>	Low Voltage Stud Mounting Bracket 1-Gang	50
<b>LVSB2</b>	Low Voltage Stud Mounting Bracket 2-Gang	25

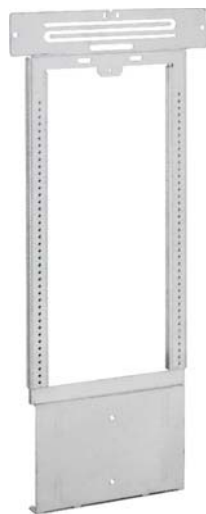

USB



US4SB



UMA



LVSB1



LVSB2



USDBM



USTBM



USTS



Adjustable  
8" to 24"

USB-4SDB-50/75-PT



Complete  
Prefabricated  
Assembly

USB-5SDB-50/75-PT



## INSTALLATION VIEWS

PATENTED REVOLUTIONARY SYSTEM

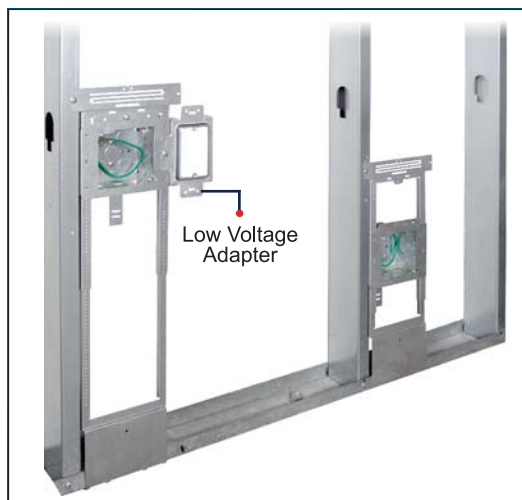

### FLOOR BRACKET

Mount vertically at heights 8" to 24" and allows for the installation of the LVSB for low voltage applications



### USB ASSEMBLY

USB accessories allow for vertical mounting between studs and 3 box applications using the USTBM

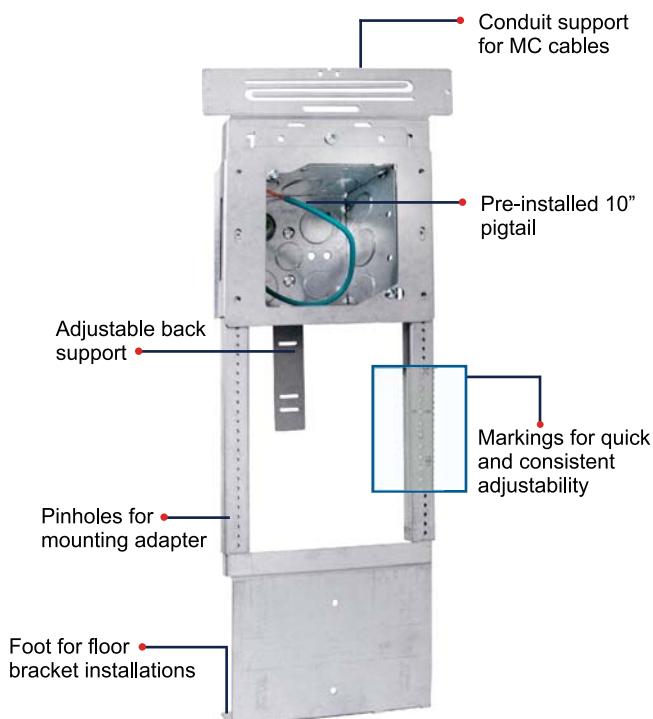

WORKS GREAT WITH  
*Orbit's Exclusive Adjustable Rings!*

### USB WITH ADJUSTABLE RINGS

Use WBAR Series or different adapters to mount boxes to USB  
See Page 18 for more information on WBAR Series



## FLAT BRACKET FAMILY

### PRODUCT FEATURES

- ▶ Compatible with 4", 4-11/16" and 5" square boxes
- ▶ Allows 5" boxes to use 4" rings, reducing material costs
- ▶ 4" rings can be mounted on their own for low voltage applications using 8/32 screws
- ▶ Low profile design accepts up to 2" fittings
- ▶ Additional width and slotted mounting holes allow for extra flexibility on studs

**Fits 5" Square Boxes!**



Cat. No.	Description	Std. Pkg.
<b>FB-3</b> <span style="background-color: red; color: white; padding: 0 2px;">NEW</span>	Flat Box Mounting Bracket, 3-Box Positions for 16" studs	25
<b>FB-4</b> <span style="background-color: red; color: white; padding: 0 2px;">NEW</span>	Flat Box Mounting Bracket, 4-Box Positions for 24" studs	25
<b>KB-18</b> <span style="background-color: red; color: white; padding: 0 2px;">NEW</span>	Kick Bracket 1-Box Position 18" height	10
<b>KFB-318</b> <span style="background-color: red; color: white; padding: 0 2px;">NEW</span>	Flat Bracket 3-Positions with 18" height kick stand for 16" stud	10
<b>KFB-418</b> <span style="background-color: red; color: white; padding: 0 2px;">NEW</span>	Flat Bracket 4-Positions with 18" height kick stand for 24" stud	10

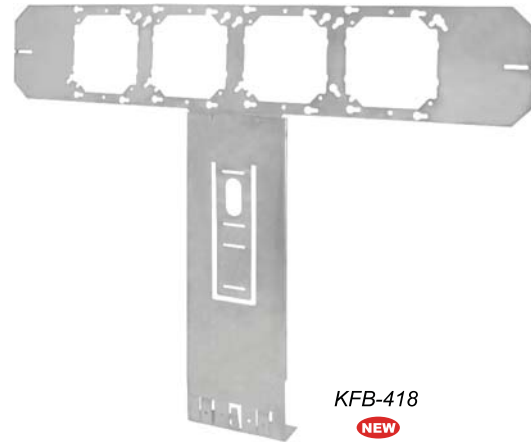
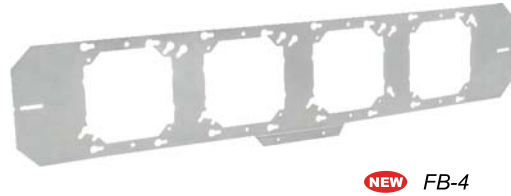
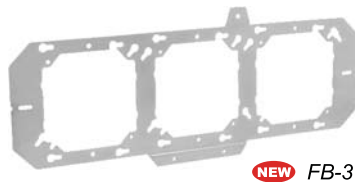

## INSTALLATION

**4" Ring Fits Any Size Box**

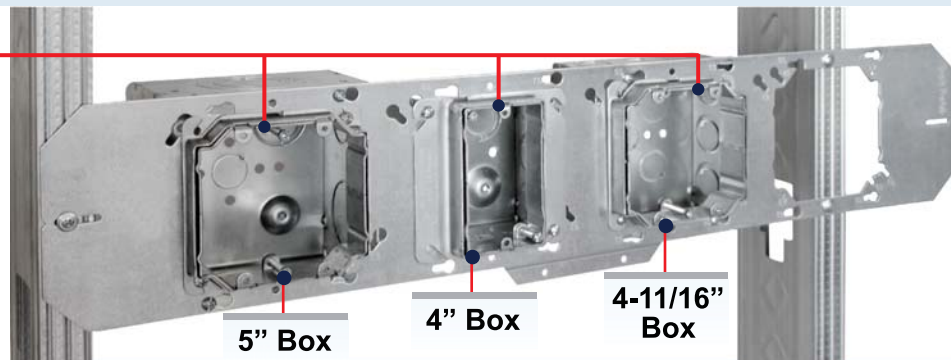

The Flat Bracket can be positioned to accommodate irregular stud spacings



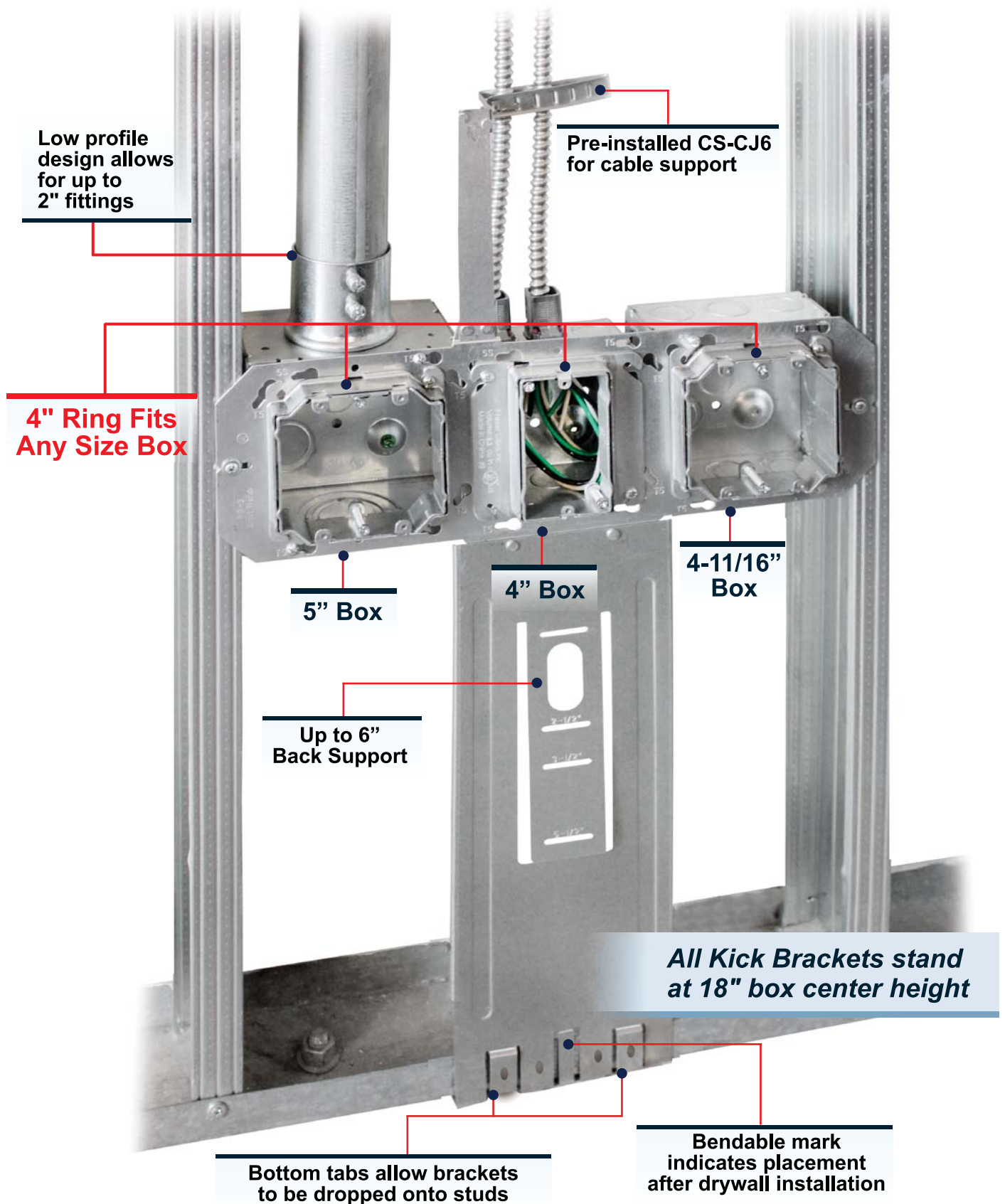



## FIXED POSITION BOX MOUNTING BRACKET

### PRODUCT FEATURES

- ▶ Compatible with 4", 4-11/16" and 5" square boxes
- ▶ 4" rings can be mounted on their own for low voltage applications using 8/32 screws
- ▶ Low profile design limits drywall bulging

**Fits 5" Square Boxes!**

Cat. No.	Description	Std. Pkg.
<b>FMB-16</b>	Fixed Position Box Mounting Bracket for 16" Stud	25
<b>FMB-24</b>	Fixed Position Box Mounting Bracket for 24" Stud	25

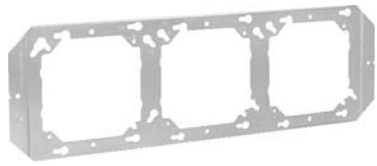

FMB-16

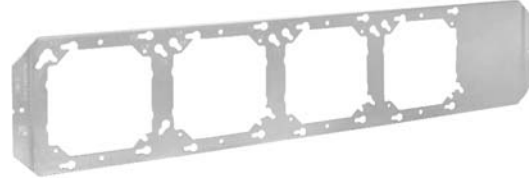

FMB-24

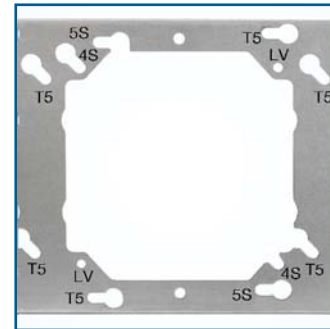
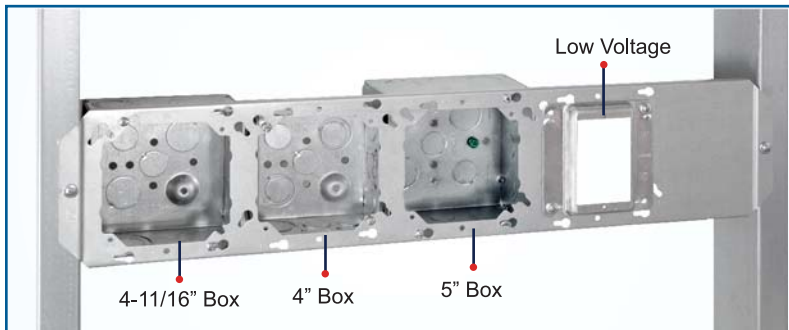

### FMB INSTALLED ON STUDS

Mount up to 3 boxes between 16" studs with FMB-16 and 4 boxes between 24" with FMB-24

### MOUNTING HOLES

Mounting Holes are marked to easily identify box and ring placement

## MULTIPLE-BOX BAR HANGER FLAT

### PRODUCT FEATURES

- ▶ Pre-Galvanized 18 Gauge sheet metal
- ▶ Accommodates 4", 4-11/16" square, and multi-gang boxes
- ▶ Allows steel boxes to adjust easily horizontally along the bracket
- ▶ Reduces assembly time on job site

Cat. No.	Application	Dimensions (W x L)	Std. Pkg.
<b>MBBH-16</b>	For 16" stud spacing	6" x 16"	50
<b>MBBH-24</b>	For 24" stud spacing	6" x 24"	50



MBBH-16

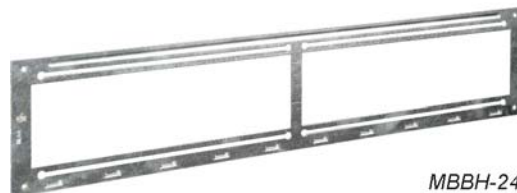

MBBH-24



Shown installed with both 4" and 4-11/16" square boxes

## UNIVERSAL MOUNTING ADJUSTABLE BOX

### PRODUCT FEATURES

- ▶ Adjustable from 0" to 1-1/2"
- ▶ Allows for direct-to-stud installations
- ▶ Compatible with the SSB and SSB-TBAR for between stud and overhead installations (Pg. P1)



**SHIPS  
PREASSEMBLED**

Cat. No.	Description	Std. Pkg.
<b>UMAB</b>	4" Square Box 3-1/2" Deep, Adjustable Up to 1-1/2". Adapter Included	10
<b>FA-UMAB</b>	Fire Alarm 4" Square Box 3-1/2" Deep, Adjustable Up to 1-1/2". Adapter Included	10



UMAB



FA-UMAB

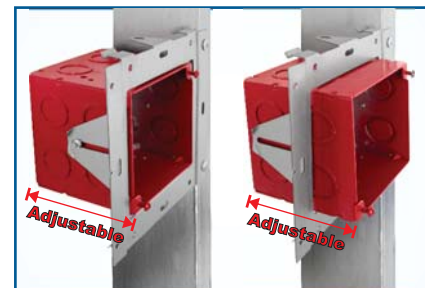

### DIRECT-TO-STUD

Guided-slots on each side allow the box to be easily adjusted by simply loosening the screws.  
**Adjustable 0" to 1-1/2"**

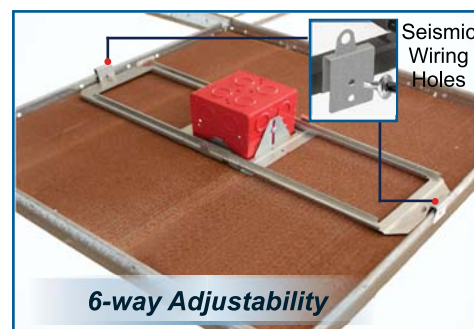

### BETWEEN WALL STUDS

Use SSB to mount **FA-UMAB** anywhere in between wall stud cavities

### BETWEEN DRYWALL CEILING JOISTS

Use SSB to mount **FA-UMAB** between ceiling joists

### SUSPENDED/DROP CEILING GRID

Use SSB-TBAR to mount **FA-UMAB** in T-bar drop ceiling grids

## BOX MOUNTING ADAPTER

### PRODUCT FEATURES

- ▶ Mounts to 4" and 4-11/16" square boxes
- ▶ Adjustable Back Support helps maintain rigidity when installed
- ▶ Low profile design limits drywall bulging
- ▶ For use with metal or wood studs

Cat. No.	Description	Std. Pkg.
<b>BMA-23</b>	Box Mounting Adapter with 3-1/2" & 2-1/2" Far Side Support	25
<b>BMA-4</b>	Box Mounting Adapter with Far Side Support up to 4"	25



BMA-23



BMA-4

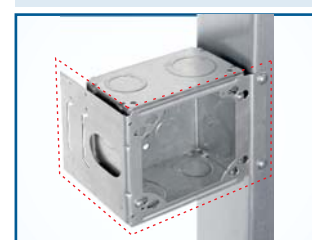

### DIRECT-TO-STUD

BMA allows for boxes to be mounted directly-to-stud





## HEIGHT ADJ. BOX INSTALL TOOL

### PRODUCT FEATURES

- Features an adjustable and magnetic platform
- Platform can be preset at a specific height for a consistent box and bracket installation
- Compatible with all Orbit Stud Brackets

**2017 NECA  
Show  
Stopper**



**ORBIT INDUSTRIES  
EXCLUSIVE**



**Video Available  
On Our Website!**

Cat. No.	Description	Std. Pkg.	Mst. Ctn.
<b>HABIT</b> <small>NEW</small>	Height Adjustable Box Installation Template	1	4



Front View

NEW



Back View

NEW

**Pg.01**



SSB



SSB-4S-MKO



SSB-5S-MKO

**Pg.03**



TSB



BHA

**Pg.07**



FB-3



FB-4

**Pg.09**



FMB



MBBH

*Compatible with all of  
Orbit's Stud Brackets*

## HABIT INSTALLATION

*Tool-free stackability for  
switch and receptacles!*

Adjusts from  
27" up to ~49"  
box center

Adjusts up  
to ~21"  
box center



Bubble Leveler



Adjustable via  
hand nuts



Magnets hold  
box and bracket





## ROOF COUPLING PLATES

### PRODUCT FEATURES

- ▶ Suitable in any type of new or old work roof construction
- ▶ Allows conduit to run below the roof line, eliminating the need to spend time derating
- ▶ Different conduit stubs can be prefabricated to plate
- ▶ Maintains roof integrity by reducing support penetrations
- ▶ Can be used for through floor conduit penetrations



Video Available  
On Our Website!

Cat. No.	Trade Size	Base Plate Size	Base Plate Thickness	Std. Pkg.
RCP-50 <b>NEW</b>	1/2"	6" x 6"	0.064"	20
RCP-75 <b>NEW</b>	3/4"	6" x 6"	0.064"	20
RCP-100 <b>NEW</b>	1"	6" x 6"	0.064"	20
RCP-125 <b>NEW</b>	1-1/4"	6" x 6"	0.064"	10
RCP-150 <b>NEW</b>	1-1/2"	8" x 8"	0.074"	10
RCP-200 <b>NEW</b>	2"	8" x 8"	0.074"	10



## RCP INSTALLATION



### EASY TRANSITION

The RCP Series allows for an easy transition of different conduit types to suit your application

### STEADY SUPPORT

Once fastened, conduit movement is eliminated up to 5' above and below the roof line



*Perfect for control, fire alarm,  
service receptacles and power  
to electrical equipment  
installation on roofs*

## RECESSED LIGHT ADAPTER PLATES

### PRODUCT FEATURES

- ▶ Available for Hard Lid (RAP) and T-Bar (RAP-T) applications
- ▶ Multiple CKOs accommodate most 4" up to 8" round and up to 5-1/4" square downlights
- ▶ Can be easily preassembled for a quicker job site install
- ▶ A faster installation than bar hangers and recessed fixture brackets



Video Available  
On Our Website!

Cat. No.	Description	Std. Pkg.
<b>RAP</b> <small>NEW</small>	Recessed Lighting Fixture Adapter Plate for hard lid applications	10
<b>RAP-T</b> <small>NEW</small>	Recessed Lighting Fixture Adapter Plate for T-Bar	10

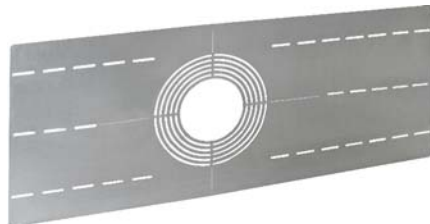

NEW RAP



NEW RAP-T

**Installs up to 4x FASTER than traditional methods!**

### RAP INSTALLATION

Slotted holes for easier installations

Fits most 4" - 8" Downlights

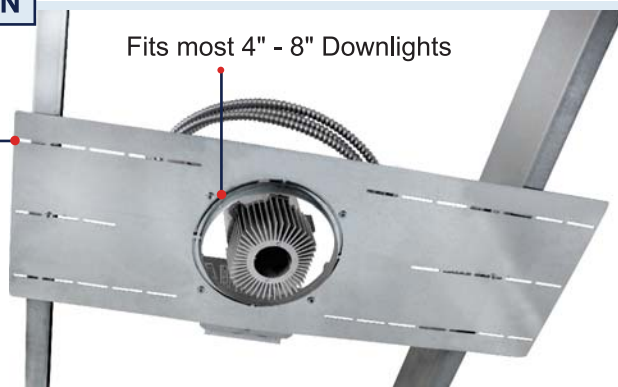

**Offset to account for irregular stud spacing**

**Fits up to 26" stud spacing**

### RAP-T INSTALLATION

Fits most 4" - 8" Downlights

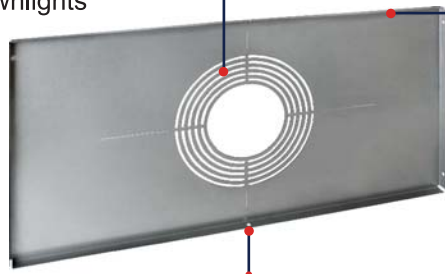

Seismic Wiring Holes on Each Side

Flanges provide extra rigidity and pre-drilled holes for mounting

**Fits most 2' wide T-Bar grids**



RAP-T installed in T-Grid Ceiling

**Flip RAP-T for Oversized Downlights**

## BOX AND CONDUIT HANGER SUPPORT PLATES

### PRODUCT FEATURES

- ▶ Pre-Galvanized 16 Gauge Steel
- ▶ No cutting required
- ▶ Pin holes and slots allow for use of conduit straps
- ▶ Self-reinforcing as more conduit is added
- ▶ Requires only one rod for installation
- ▶ Stamped markings provide guide lines
- ▶ Easy to preassemble to save time and material



Cat. No.	Description	Std. Pkg.
<b>BCHS-10</b>	Fits up to 8" x 8" Box for horizontal mounting	25
<b>BCHS-6</b>	Fits up to 8" x 8" Box for horizontal mounting and provides bent tabs for vertical mounting	10
<b>BCHS-6S</b>	Fits up to 8" x 8" Box for horizontal mounting, provides bent tabs for vertical mounting and offsets allow for use of one-hole straps	10
<b>BCHS-12</b>	Fits up to 12" x 12" Box or multiple small sized boxes for horizontal mounting and provides bent tabs for vertical mounting	5

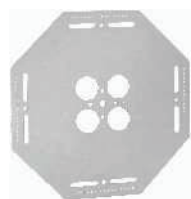

BCHS-10



BCHS-6



BCHS-6S

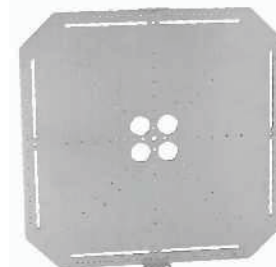

BCHS-12

**Use One Rod to Mount Multiple Boxes and Conduits**

## INSTALLATION

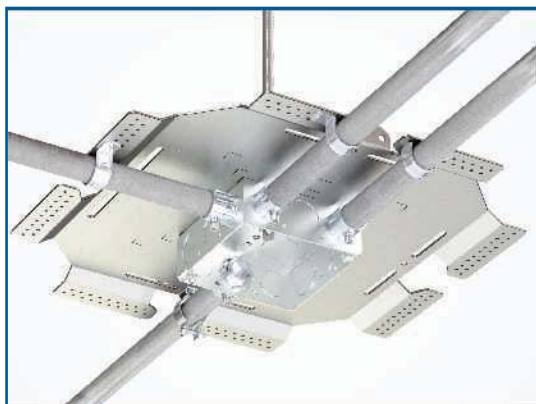

**BCHS-6S**

Allows for use of one-hole strap

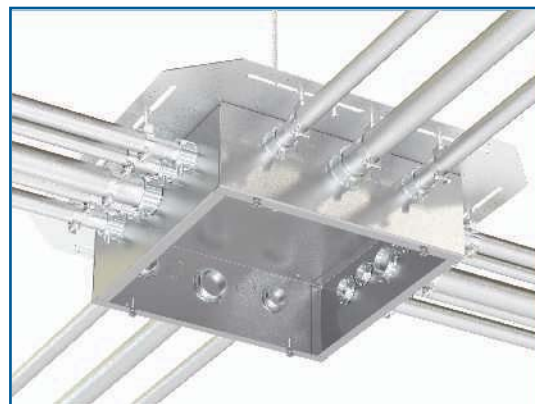

**BCHS-12**

12" x 12" NEMA installed

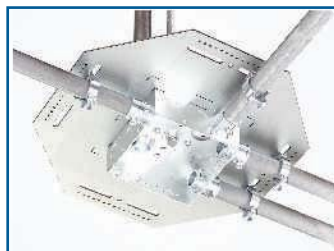

**BCHS-10**

Horizontally mount boxes up to 8" x 8"

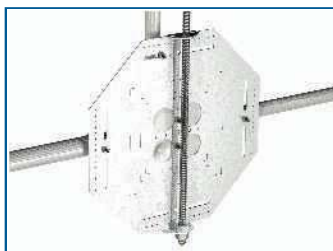

**BCHS-6**

Horizontally or vertically mount boxes up to 8" x 8"

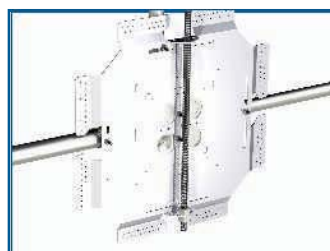

**BCHS-6S**

Horizontally or vertically mount boxes up to 8" x 8" and allows for the use of one-hole straps

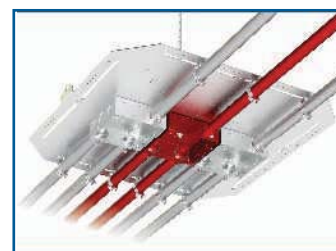

**BCHS-12**

Fits multiple boxes for multi-system installations

## FIXED BAR HANGERS

### PRODUCT FEATURES

- ▶ Steel
- ▶ Electroplated Zinc
- ▶ For Stud and T-Bar

Cat. No.	Description	Std. Pkg.
BHT-1	24" T-Bar bracket for use with boxes 1-1/2" or 2-1/8" deep	50
BHT-1A	24" T-Bar bracket - 8" height adjustable	50
BH-3	Straight bracket for mounting architectural recess lights 25-1/4" long with notches 24" apart for use on T-Bar	50

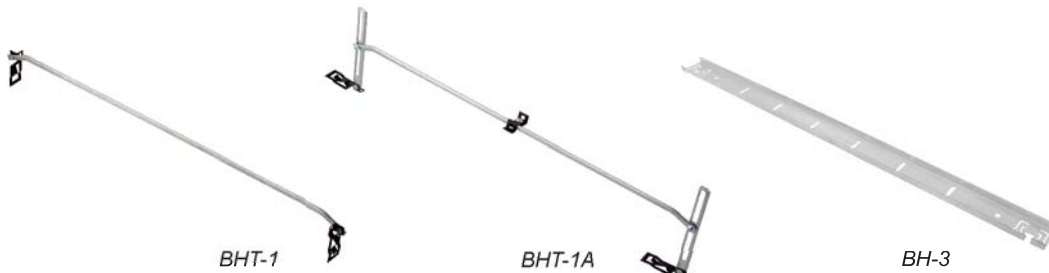

## FEATURES & INSTALLATION

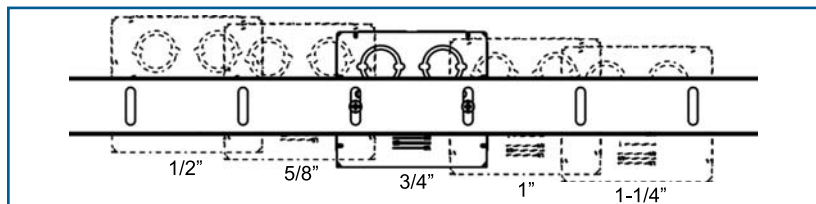

### BH-3 FEATURES

Adjust vertically from 1/2" to 1-1/4" between 5 different positions



### 6-WAY ADJUSTABLE T-BAR HANGER

The BH-3 is ideal for recessed lighting applications, fire alarm device installation, and LED retrofit lighting applications. Compatible with Orbit's 4SEDB-CKO and FA-4SEDB-CKO.

### BH-3 FEATURES

Secure to T-Bar using bending tabs to comply with NEC 314.23 (D)(1)(2)

### 4SDB-BP

### 4" SQUARE DEEP BOX

### WELDED

### 2-1/8" DEEP

42.0 Cu. In.

WITH RAISED GROUND EMBOSS

### PRODUCT FEATURES

- ▶ Can be mounted without having to access the inside of the box itself
- ▶ Flat back plate allows pre-wiring of box with device/cover before shipping to the field

Cat. No.	Description	Knockouts		Std. Pkg.
		Sides	Bottom	
4SDB-BP <b>NEW</b>	4SDB-MKO-PT with Back Plate, 7" Pigtail	1/2" & 3/4" MKOs	-	24



**NEW** 4SDB-BP



Mount to ceilings, walls, corrugated surfaces, or underneath counters



## EASY ACCESS LIGHTING BOXES 2-1/8" DEEP 30.3 Cu. In.

### PRODUCT FEATURES

- ▶ Fast and efficient installations
- ▶ Sliding cover plate for one person installations
- ▶ Available with either standard or swivel sliding cover plate
- ▶ Swivel reduces damage to hanging fixtures when struck
- ▶ Complies with NEC 314.27 (A)(D) for up to 90 lbs. of fixture load

Cat. No.	Description	Dimensions (W x H)	Knockouts		Std. Pkg.
			Sides	Bottom	
<b>EALB</b>	Easy Access Lighting Box	4" X 4"	4 - CKO	3 - 1/2", 1 - 3/4"	50
<b>EALBS</b>	Easy Access Lighting Box with Sliding Swivel	4" X 4"	4 - CKO	3 - 1/2", 1 - 3/4"	10



EALB



EALBS

**Only box UL-Listed for up to 90lbs of fixture load!**

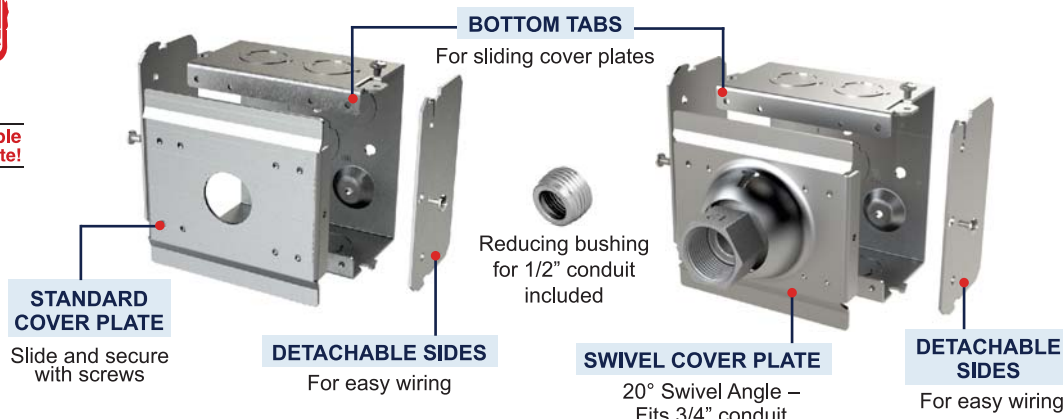

**50%  
LABOR  
SAVINGS**

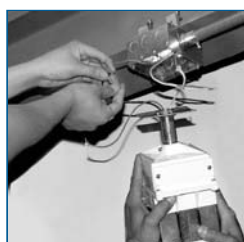

### TRADITIONAL METHOD

Requires two installers



### WITH ORBIT'S EALB/S

Only one installer

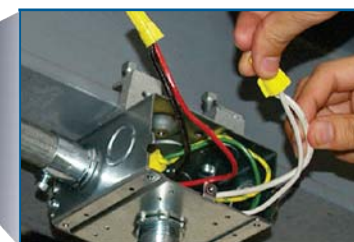

## EZ-HANG BOX 4-11/16" SQUARE BOX DRAWN 2-1/8" DEEP 42.0 Cu. In. WITH RAISED GROUND EMBOSS

### PRODUCT FEATURES

- ▶ Back-center KO is replaced with a 0.27" diameter back-center hole
- ▶ Back-center hole allows for use of 1/4" rod for suspended applications
- ▶ No washer is needed, allowing for a fast and efficient installation

Cat. No.	Description	Knockouts		Std. Pkg.
		Sides	Bottom	
<b>D5SDB-CKO-S</b>	4-11/16" Sq. Drawn Special Box with CKO	2 - 1/2", 10 - CKO	3 - 3/4"	24



D5SDB-CKO-S

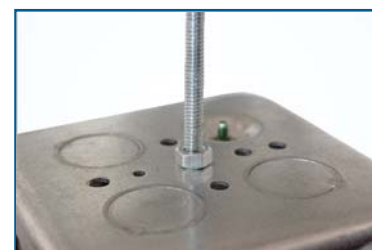

Secure box to ceiling with just a 1/4" rod and locknut



## ADJUSTABLE RINGS

### PRODUCT FEATURES

- ▶ For use with 4" and 4-11/16" square deep boxes
- ▶ 1/4" to 1-1/4" adjustability range
- ▶ Rings achieve a flush finish every time
- ▶ Compatible with exclusive extensions for infinite wall depths

### U.S. PATENT NO.:

7,468,486

**Video Available  
On Our Website!**

Cat. No.	Description	Standard	With One Extension Installed		Std. Pkg.
			+1GX75	+2GX75	
<b>4SAR1G</b>	1-Gang Adjustable Ring for 4" Sq. Deep Boxes	1/4" to 1-1/4"	1" to 2"	-	25
<b>4SAR2G</b>	2-Gang Adjustable Ring for 4" Sq. Deep Boxes	1/4" to 1-1/4"	-	1" to 2"	25
<b>5SAR1G</b>	1-Gang Adjustable Ring for 4-11/16" Sq. Deep Boxes	1/4" to 1-1/4"	1" to 2"	-	25
<b>5SAR2G</b>	2-Gang Adjustable Ring for 4-11/16" Sq. Deep Boxes	1/4" to 1-1/4"	-	1" to 2"	25



4SAR1G



4SAR2G



5SAR1G



5SAR2G



### ACCESSIBLE ADJUSTABILITY

Corner screws are easily accessible for adjustment before and after the device has been installed

## EXTENSIONS AND ACCESSORIES

### PRODUCT FEATURES

- ▶ Extensions ensure flush finish regardless of wall thickness
- ▶ Attach to adjustable ring for additional 3/4" of depth
- ▶ Mount easily to ring with two 8-32 screws
- ▶ Multiple extensions can be installed on one ring

### U.S. PATENT NO.:

7,468,486



Cat. No.	Description	For Use With	Std. Pkg.
<b>1GX75</b>	1-Gang 3/4" Extension	4SAR1G, 5SAR1G, or WBAR1G Only	50
<b>2GX75</b>	2-Gang 3/4" Extension	4SAR2G, 5SAR2G, or WBAR2G Only	50
<b>UPC</b>	Gangable, Steel Universal Protective Cover protects any device during drywall, painting, routing, mudding & plastering		25
<b>UPCTS</b>	Optional Plastic Insert for UPC to protect Toggle Switch		25



1GX75



2GX75



UPC



UPCTS



Complete UPC Assembly Shown  
Installed with Toggle Switch

## STUD MOUNTING ADJUSTABLE RINGS

### PRODUCT FEATURES

- Accepts 4" or 4-11/16" square boxes in line voltage applications
- Mount to any stud, shear wall, 6" X 6" NEMA 1 enclosure, Simple Support Bracket (Pg. P1) or Ultimate Support Bracket (Pg. P5)
- Can be used standalone for low voltage communications applications

### U.S. PATENT NO.:

7,468,486



Cat. No.	Description	Standard	With One Extension Installed		Std. Pkg.
			+1GX75	+2GX75	
WBAR1G	1-Gang Universal Box Bracket	1/4" to 1-1/4"	1" to 2"	-	25
WBAR2G	2-Gang Universal Box Bracket	1/4" to 1-1/4"	-	1" to 2"	25

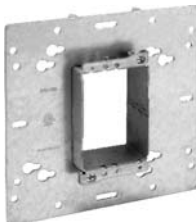

WBAR1G

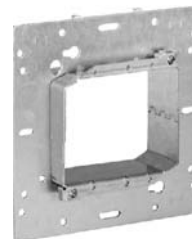

WBAR2G



WBAR on the 6" x 6" NEMA Enclosure



Mount 4" &amp; 4-11/16" Square Boxes directly to stud

## UL-APPROVED ADJUSTABLE RINGS

### PRODUCT FEATURES

- Can be adjusted on the jobsite for a quick installation
- Adjusts to achieve a flush finish every time
- Patented design provides strong electrical and mechanical connections to meet UL requirements
- \*For Fixture/Luminaire Support of 50 lbs or less

INDUSTRY'S ONLY  
**UL LISTED**

4-11/16" SQ.  
ADJ. RINGS

Cat. No.	Description	Adjustability Range	Std. Pkg.
4AR1G-58	1-Gang Adjustable Ring for 4" Square Deep Boxes	5/8" to 1-1/4"	25
4AR1G-34	1-Gang Adjustable Ring for 4" Square Deep Boxes	3/4" to 1-1/2"	25
4AR2G-58	2-Gang Adjustable Ring for 4" Square Deep Boxes	5/8" to 1-1/2"	25
5AR1G-58 <b>NEW</b>	1-Gang Adjustable Ring for 4-11/16" Square Deep Boxes	5/8" to 1-1/4"	25
5AR2G-58 <b>NEW</b>	2-Gang Adjustable Ring for 4-11/16" Square Deep Boxes	5/8" to 1-1/2"	25
*4ARR-34	Round Adjustable Ring for 4" Square Deep Boxes	3/4" to 1-1/2"	25
3GAR-34	3-Gang Adjustable Ring	3/4" to 1-1/2"	25



4AR1G-58



4AR1G-34



4AR2G-58

**NEW** 5AR1G-58**NEW** 5AR2G-58

4ARR-34



3GAR-34

## 4-11/16" SQUARE DEEP BOXES

### WELDED 2-1/8" DEEP

42.0 Cu. In.  
WITH METAL CLAD (BX/MC)  
CABLE CLAMPS

#### BX/MC CLAMP

- ▶ All MC series boxes are suitable for use with MCAP™-Aluminum
- ▶ MCAP is a trademark of Southwire Company

#### METAL STUD BRACKET

- ▶ U.S. Patent No.: 8,262,043
- ▶ Metal Stud (MS) Bracket engages on either side of a Metal Stud
- \*Model Revised Feb. 2008

Acceptable for use in 2-hour fire rated walls

Cat. No.	Bracket & Setback	Knockouts		Std. Pkg.
		Sides	Bottom	
5SDB-MC	-	6 - MKO, 4 - Loom	3 - 1/2", 2 - 3/4"	24
5SDB-MC-FB	FB, Flush	3 - MKO, 4 - Loom	3 - 1/2", 2 - 3/4"	24
5SDB-MC-MS*	MS, Self-Gripping + Box Support Clip	3 - MKO, 4 - Loom	2 - MKO, 3 - 1/2"	24
5SDB-MC2-MS*	MS, Self-Gripping + Box Support Clip	1 - MKO, 8 - Loom	1 - MKO	24



5SDB-MC



5SDB-MC-FB



BX/MC Clamp



5SDB-MC-MS\*



5SDB-MC2-MS\*



5SDB-MC2-MS\* on Metal Stud

## 4" SQUARE DEEP BOXES

### WELDED 2-1/8" DEEP

30.3 Cu. In.  
WITH METAL CLAD (BX/MC)  
CABLE CLAMPS

#### BX/MC CLAMP

- ▶ All MC series boxes are suitable for use with MCAP™-Aluminum
- ▶ MCAP is a trademark of Southwire Company

#### METAL STUD BRACKET

- ▶ U.S. Patent No.: 8,262,043
- ▶ Metal Stud (MS) Bracket engages on either side of a Metal Stud
- \*Model Revised Feb. 2008

#### BOXES WITH PICTAIL

Pre-Assembled 3-Way,  
10-32 Ground Screw and  
Solid Cu #12AWG 7" Pigtail

Acceptable for use in 2-hour fire rated walls

Cat. No.	Bracket & Setback	Knockouts		Std. Pkg.
		Sides	Bottom	
4SDB-MC	-	4 - 1/2", 2 - MKO, 4 - Loom	1 - 1/2"	24
4SDB-MC-PT	-	4 - 1/2", 2 - MKO, 4 - Loom	1 - 1/2"	24
4SDB-MC-B	B, Flush	2 - 1/2", 1 - MKO, 4 - Loom	1 - 1/2"	24
4SDB-MC-FB-PT	FB, Flush	2 - 1/2", 1 - MKO, 4 - Loom	1 - 1/2"	24
4SDB-MC-MS-PT*	MS, Self-Gripping	2 - 1/2", 1 - MKO, 4 - Loom	1 - 1/2"	24
4SDB-MC-WB	WB, Flush	2 - 1/2", 1 - MKO, 4 - Loom	1 - 1/2"	24



4SDB-MC



4SDB-MC-PT



4SDB-MC-B



4SDB-MC-FB-PT



4SDB-MC-MS-PT\*



4SDB-MC-WB



## 4" SQUARE DEEP BOXES

### WELDED

### 1-1/2" DEEP

21 Cu. In.

WITH METAL CLAD (BX/MC)  
CABLE CLAMPS

#### BX/MC CLAMP

- ▶ All MC series boxes are suitable for use with MCAP™-Aluminum
- ▶ MCAP is a trademark of Southwire Company

#### METAL STUD BRACKET

- ▶ U.S. Patent No.: 8,262,043
- ▶ Metal Stud (MS) Bracket engages on either side of a Metal Stud

\*Model Revised Feb. 2008

#### BOXES WITH PICTAIL

Pre-Assembled 3-Way,  
10-32 Ground Screw and  
Solid Cu #12AWG 7" Pigtail

Cat. No.	Bracket & Setback	Knockouts		Std. Pkg.
		Sides	Bottom	
4SB-MC-PT	-	4 - 1/2", 2 - MKO, 4-Loom	1 - 1/2"	50
4SB-MC-B	B, Flush	2 - 1/2", 1 - MKO, 4-Loom	1 - 1/2"	24
4SB-MC-FB-PT	FB, Flush + 7" Pigtail	2 - 1/2", 1 - MKO, 4-Loom	1 - 1/2"	24
4SB-MC-WB	WB, Flush	2 - 1/2", 1 - MKO, 4-Loom	1 - 1/2"	24
4SB-MC-MS-PT*	MS + Box Support Clip + 7" Pigtail	2 - 1/2", 1 - MKO, 4-Loom	1 - 1/2"	24



4SB-MC-PT

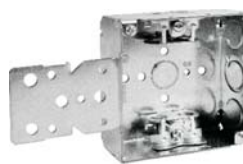

4SB-MC-B

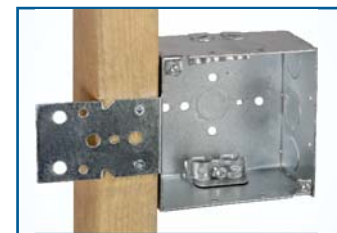

4SB-MC-B on Wood Stud



4SB-MC-FB-PT



4SB-MC-WB



4SB-MC-MS-PT\*

## ADDITIONAL BOXES WITH PIGTAIL

#### BOXES WITH PICTAIL

Pre-Assembled 3-Way,  
10-32 Ground Screw and  
Solid Cu #12AWG 7" Pigtail



Pre-Assembled Ground  
Screw and Pigtail

Cat. No.	Mfg. Process	Dimension WxHxD	Cu. Inch	Knockouts		Std. Pkg.
				Sides	Bottom	
5SDB-MKO-PT	Welded	4-11/16" x 4-11/16" x 2-1/8"	42.0	2 - 1/2", 10 - MKO	2 - 1/2", 2 - MKO	24
4SDB-MKO-PT	Welded	4" x 4" x 2-1/8"	30.3	8 - 1/2", 4 - MKO	2 - 1/2", 2 - MKO	24
4SB-MKO-PT	Welded	4" x 4" x 1-1/2"	21.0	8 - 1/2", 4 - MKO	2 - 1/2", 2 - MKO	50
D4SB-50/75-PT	Drawn	4" x 4" x 1-1/2"	21.0	8 - 1/2", 4 - 3/4"	2 - 1/2", 2 - 3/4"	50
D4SB-75-PT	Drawn	4" x 4" x 1-1/2"	21.0	8 - 3/4"	2 - 1/2", 2 - 3/4"	50
DHB3-PT	Drawn	5-3/4" x 4" x 2-1/8"	44.0	4 - 1/2", 6 - CKO	2 - 1/2", 2 - 3/4"	25



5SDB-MKO-PT



4SDB-MKO-PT

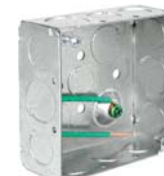

4SB-MKO-PT



D4SB-50/75-PT



D4SB-75-PT



DHB3-PT

- ▶ **600V** MKO's and CKO's suitable for bonding without any additional bonding means up to 600V
- ▶ Acceptable for use in 2-hour fire rated walls

**4-11/16" SQUARE BOXES****WELDED****2-1/8" DEEP**

42.0 Cu. In.

**WITH RAISED GROUND EMBOSS****BOXES WITH PICTAIL**

Pre-Assembled 3-Way,  
10-32 Ground Screw and  
Solid Cu #12AWG 10" Pigtail

**BSA**

- ▶ Pre-installed Back Support Arm provides support for studs up to 6" deep
- ▶ Great for prefab applications

Cat. No.	Bracket & Setback	Knockouts		Std. Pkg.
		Sides	Bottom	
5SDB-50/75-PT-BSA	Back Support Arm	8 - 1/2", 4 - 3/4"	3 - 3/4"	24
5SDB-50/75-AB-PT-BSA	AB, Flush, Back Support Arm	6 - 1/2", 3 - 3/4"	3 - 3/4"	24



5SDB-50/75-PT-BSA



5SDB-50/75-AB-PT-BSA



Adjustable Back Support Arm

**4" SQUARE DEEP BOXES****WELDED****2-1/8" DEEP**

30.3 Cu. In.

**WITH RAISED GROUND EMBOSS****BOXES WITH 10" PICTAIL**

Pre-Assembled 3-Way,  
10-32 Ground Screw and  
Solid Cu #12AWG 10" Pigtail

**BSA**

- ▶ Pre-installed Back Support Arm provides support for studs up to 6" deep
- ▶ Great for prefab applications

Extensions and additional  
Adjustable Rings  
available on page 17-18

Cat. No.	Bracket & Setback	Knockouts		Std. Pkg.
		Sides	Bottom	
4SDB-50/75-PT-BSA	With Back Support	8 - 1/2", 4 - 3/4"	1 - 1/2", 2 - 3/4"	24
4SDB-50/75-AB-PT-BSA	With Back Support + AB Bracket	6 - 1/2", 3 - 3/4"	1 - 1/2", 2 - 3/4"	24
4SDB-MKO-PT-BSA	With Back Support	8 - 1/2", 4 - MKO	1 - 1/2", 2 - MKO	24
4SDB-MKO-AB-PT-BSA	With Back Support + AB Bracket	6 - 1/2", 3 - MKO	1 - 1/2", 2 - MKO	24
4SDB-MKO-AR1G	4SDB-MKO-AB-PT-BSA + 1G Adj. Ring	6 - 1/2", 3 - MKO	1 - 1/2", 2 - MKO	24
4SDB-MKO-AR2G	4SDB-MKO-AB-PT-BSA + 2G Adj. Ring	6 - 1/2", 3 - MKO	1 - 1/2", 2 - MKO	24



4SDB-50/75-PT-BSA



4SDB-MKO-PT-BSA



4SDB-50/75-AB-PT-BSA



4SDB-MKO-AB-PT-BSA



4SDB-MKO-AR1G



4SDB-MKO-AR2G

- ▶ **600V** MKO's and CKO's suitable for bonding without any additional bonding means up to 600V
- ▶ Acceptable for use in 2-hour fire rated walls

## 4-11/16" SQUARE LARGE CAPACITY BOXES

**WELDED**

**2-1/2" DEEP**

49.4 Cu. In.

**WITH RAISED GROUND EMBOSS & TWO #8-32 x 1/2" MOUNTING SCREWS**

### PRODUCT FEATURES

Suitable for Datacom & Electrical Applications

Available in Blue for Data Applications as the B-5SLB. See (Pg. P24)



Cat.  
No.

5SLB-2MKO

### Knockouts

Sides

Bottom

4 - 3/4" & 1" MKO,  
4 - 1" & 1 - 1/4" MKO

2 - 1/2", 2 - 3/4"

Std.  
Pkg.

24



5SLB-2MKO



5SLB-2MKO Shown Installed



5SLB-2MKO, 52058 & 5SLP-200 Shown Installed

## 4-11/16" SQUARE BOXES LOW-VOLTAGE PARTITIONS

### PRODUCT FEATURES

Steel Partitions allows for multi-system installations inside junction box

Cat.  
No.

Description

For Use with  
2-Gang Rings:

Std.  
Pkg.

5SDP-100

For use with 2-1/8" Deep Boxes

Flat, 1/4", 1/2", 3/4", 1"

25

5SDP-200

For use with 2-1/8" Deep Boxes

5/8", 1-1/4", 1-1/2", 1-3/4", 2"

25

5SLP-100

For use with 2-1/2" Deep Boxes

Flat, 1/4", 1/2", 3/4", 1"

25

5SLP-200

For use with 2-1/2" Deep Boxes

5/8", 1-1/4", 1-1/2", 1-3/4", 2"

25

- ▶ **600V** MKO's and CKO's suitable for bonding without any additional bonding means up to 600V
- ▶ Acceptable for use in 2-hour fire rated walls



5SDP-100



5SDP-200



5SLP-100



5SLP-200

# PROFAB

ENGINEERED ELECTRICAL SYSTEMS

**NEW**



For more information on Orbit's Engineered Electrical Systems, email [info@orbitprofab.com](mailto:info@orbitprofab.com)

A Division of **orbit**

## TRUE 5" SQUARE BOXES

### WELDED 3-1/4" DEEP

75.6 Cu. In.  
WITH RAISED GROUND EMBOSS

#### PRODUCT FEATURES

- ▶ More than double capacity compared to 4" square boxes
- ▶ Extra space easily meets minimum bend radius for easier installations
- ▶ Increased space reduces short circuits and ground faults due to space and cable stress
- ▶ Supports all current copper CAT and fiber optic cables as well as predicted increases

Cat. No.	Description	Sides	Bottom	Std. Pkg.
<b>T5B-50/200</b> <b>NEW</b>	True 5" Square Box, 1/2" KO & 2" MKO	2 - 1" to 2" CKOs 4 - 1/2" & 3/4" CKOs 8 - 1/2" KO	1 - 1/2" & 3/4" MKOs 1 - 3/4" & 1" MKOs 1 - 1/2" KO	12
<b>T5B-200</b> <b>NEW</b>	True 5" Square Box	2 - 1" to 2" CKOs 2 - 1" & 1-1/4" MKOs 2 - 1/2" & 3/4" MKOs	1 - 1/2" & 3/4" MKOs 1 - 3/4" & 1" MKOs 1 - 1/2" KO	12



T5B-50/200  
**NEW**

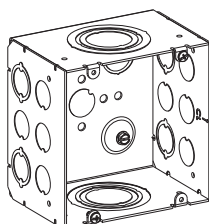

T5B-50/200  
5" x 5" x 3-1/4"



T5B-200  
**NEW**

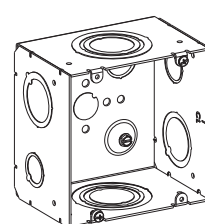

T5B-200  
5" x 5" x 3-1/4"

## INSTALLATION

**Brackets allow for 4" ring compatibility!**



#### INSTALLED ON FMB-16

FMB-16 Shown Installed  
True 5" Sq. Box Brackets on page P7-9



#### INSTALLED ON UMA-LVBS

UMA-LVBS Shown Installed  
Dual-direction Stud Mount Bracket on page P1



#### REDUCER

Use 4" Rings on  
True 5" Boxes with T5R

## 5" SQUARE BOXES ACCESSORIES

#### PRODUCT FEATURES

Steel Partitions allows for multi-system installations inside junction box

Cat. No.	Description	For Use with 2-Gang Rings:	Pkg.
<b>T5C</b> <b>NEW</b>	True 5" Blank Cover		50
<b>T5R</b> <b>NEW</b>	True 5" Reducer Cover, 4" Sq Opening		50
<b>T5P-100</b> <b>NEW</b>	True 5" Square Box Partition For 3-1/4" Deep Boxes	Flat to 1"	25
<b>T5P-200</b> <b>NEW</b>	True 5" Square Box Partition For 3-1/4" Deep Boxes	5/8", 1-1/4" to 2"	25



**NEW** T5C

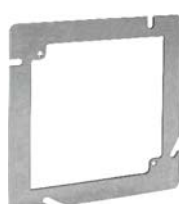

**NEW** T5R



**NEW** T5P-100



**NEW** T5P-200





LARGE CAPACITY  
DATA BOXES  
**WELDED**  
WITH RAISED GROUND EMBOSS

PRODUCT FEATURES

- Provides easy identification of products containing cabling of Data Systems
- Prevents need for repainting
- Increased space reduces short circuits and ground faults due to space and cable stress
- Durable Blue Powder Coat Finish

B-5SLB available unpainted as the 5SLB-2MKO. (Pg.22)

Cat. No.	Description	Sides	Bottom	Std. Pkg.
B-T5B <b>NEW</b>	Blue True 5" Square Box	2 - 1" to 2" CKOs 2 - 1" & 1-1/4" MKOs 2 - 1/2" & 3/4" MKOs	1 - 1/2" & 3/4" MKOs 1 - 3/4" & 1" MKOs 1 - 1/2" KO	12
B-5SLB <b>NEW</b>	Blue 4-11/16" Large Capacity Square Box	4 - 3/4" & 1" MKO 4 - 1" & 1 - 1/4" MKO	2 - 1/2", 2 - 3/4"	24
B-T5C <b>NEW</b>	Blue True 5" Blank Cover	-	-	50
B-5BC <b>NEW</b>	Blue 4-11/16" Blank Cover	-	-	50



B-T5B  
**NEW**



B-5SLB  
**NEW**



B-T5C  
**NEW**



B-5BC  
**NEW**

Prefab Products

**UP TO 100% MORE SPACE**

EASILY FITS CURRENT CABLE BEND RADIUS  
REQUIREMENTS AND FUTURE INCREASES

With the introduction of the Blue Boxes,  
Orbit now features a box for most applications!



DATA



STANDARD



FIRE

## INSTALLATION

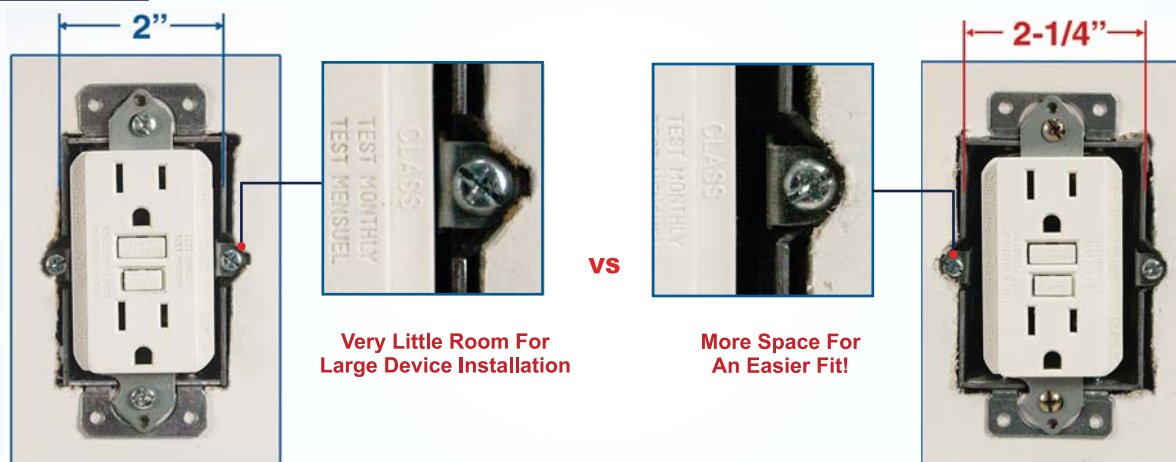

### TRADITIONAL TIGER GRIP WITH GFCI INSTALLED

### TGW SHOWN WITH GFCI INSTALLED

## WIDE OLD-WORK SWITCH BOX WITH GROUNDING "PIGTAIL"

### PRODUCT FEATURES

- ▶ Non-Gangable, Wide Switch Box
- ▶ Pre-Assembled with 10-32 Ground Screw & 7" Solid #12AWG Pigtail
- ▶ Must be used with Mid-Size or Oversized Wall Plate
- ▶ Facilitates GFCI and Controls Installations



Cat. No.	Description	Volume	Knockouts			Std. Pkg.
			Sides	Ends	Bottom	
<b>WMB-PT</b> <small>NEW</small>	3" H x 2-1/4" W x 2-3/4" D	18.5 Cu. In.	4 - 1/2"	2 - MKO	2 - 1/2"	50
<b>SBS</b>	Switch Box Support Brackets, Bendable Tabs	-	-	-	-	100
<b>OWG</b>	Cut in Old-Work Clip	-	-	-	-	100



NEW WMB-PT

Featuring 1/2" & 3/4" MKO



SBS



Shown Installed



OWG



Shown Installed

**1/4" Wider for easy installation of GFCI and other large devices**

## WIDE TIGER GRIP

### PRODUCT FEATURES

- ▶ Non-Gangable Switch Boxes
- ▶ Must be used with Mid-Size or Oversized Wall Plate
- ▶ Facilitates GFCI and Controls Installations
- ▶ Material: Galvanized Steel



Cat. No.	Description	Volume	Knockouts			Std. Pkg.
			Sides	Ends	Bottom	
<b>TGW</b>	3" H x 2-1/4" W x 2-1/2" D	15.0 Cu. In.	4 - 1/2"	2 - 1/2"	2 - 1/2"	50
<b>TGMW</b>	3" H x 2-1/4" W x 2-3/4" D	18.5 Cu. In.	4 - 1/2"	2 - 1/2"	2 - 1/2"	50



TGW



TGMW

**1/4" deeper**

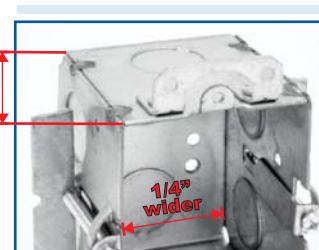

**TGMW SHOWN**



## UNIVERSAL FIREBLOK SUPPRESSION INSERTS FOR METAL ELECTRICAL BOXES

### PRODUCT FEATURES

- ▶ One SKU fits single gang, 4" and 4-11/16" square boxes via break-apart design
- ▶ Non-Conductive
- ▶ Intumescent thermoplastic
- ▶ Pre-molded opening to accommodate raised grounding provisions and wiring access
- ▶ Up to 2 Hour Fire Rated
- ▶ Soundproof with STC Rating of 52\*\*
- ▶ Certified for both Plastic and Metal faceplates in all fire-rated walls
- ▶ 95% labor savings over Putty Pad technology

\* By Fireblok IP Holdings  
\*\* Tested in a UL 411 wall assembly to ASTM E90



**FireBlok**



Cat. No.	Description	Std. Pkg.
UFSI <b>NEW</b>	Universal Firestop Insert for 1G, 4", 4-11/16" Electrical Box, White	120



**NEW** UFSI

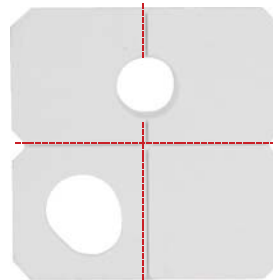

Break-apart Design

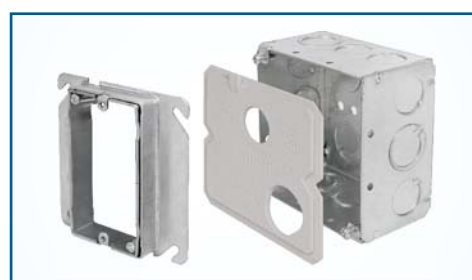

The Universal Firestop Insert adheres to the inside of most 1-Gang, 4", or 4-11/16" electrical boxes



**Call on Orbit to install Firestop Inserts in the box of your choice**

## FIRESTOP PUTTY PADS AND STICKS\*

### PRODUCT FEATURES

- ▶ Applied by hand with no curing time
- ▶ Pad is soundproof with STC Rating of 60\*\*
- ▶ Intumescent at 220°F
- ▶ Will not dry out or crumble
- ▶ Reusable
- ▶ Adheres to all common building surfaces
- ▶ Up to 3 Hour Fire Rated

\* By Metacaulk  
\*\* Tested in a UL 441 wall assembly/section to ASTM E90

Cat. No.	Description	Std. Pkg.
FSPS18 <b>NEW</b>	Firestop Putty Stick, 18 Cu. In., Red	12
FSP67 <b>NEW</b>	Firestop Putty Pad, 6" x 7" x 1/8", Red	20
FSP77 <b>NEW</b>	Firestop Putty Pad, 7" x 7" x 1/8", Red	20



**NEW** FSPS18



**NEW** FSP67  
FSP77



Putty Sticks seal around penetrating items such as cables, conduits and metal pipes.

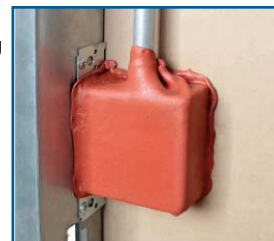

Putty Pads are used on electrical boxes to maintain the hourly rating of fire-rated walls as well as reduce sound transmission.

**PUTTY STICKS**

**PUTTY PADS**



## ZINC DIE CAST DOUBLE-SNAP CABLE CONNECTOR

### PRODUCT FEATURES

- ▶ Zinc Die Cast
- ▶ 105°C rated throat insulator
- ▶ Fast and Tool-free installation
- ▶ Removable and Reusable
- ▶ For FMC, AC, MCI, MCI-A, HCF, RWFC
- ▶ Dry location

Cat. No.	Description	Trade Size	Std. Pkg.	Master Ctn.
DSC-38	<b>DOUBLE-SNAP CABLE CONNECTOR WITH INSULATOR</b> Steel/AL AC: 14/2 (0.40") - 10/3 (0.618") Steel MCI: 0.395" - 0.638"    AL MCI: 0.40" - 0.618" Steel/AL MCI-A: 14/2 (0.395") - 10/3 (0.638") Steel/AL HCF MCI-A: 14/2 (0.395") - 10/3 (0.638") AL RWFC: 3/8"	3/8"	50	500
DSC-38C	<b>CUT-IN DOUBLE-SNAP CABLE CONNECTOR WITH INSULATOR, FOR OLD WORK</b> Steel/AL AC: 14/2 (0.40") - 10/3 (0.618") Steel/AL MCI: 14/2 (0.395") - 10/3 (0.638") Steel/AL MCI-A: 14/2 (0.395") - 10/3 (0.638") Steel/AL HCF MCI-A: 14/2 (0.395") - 10/3 (0.638") Steel/AL FMC: 3/8"	3/8"	50	500



DSC-38



DSC-38C

## STEEL "FASTLOCK" CONNECTOR

### PRODUCT FEATURES

- ▶ Steel
- ▶ Electroplated Zinc
- ▶ Saddle-Base Connector (FLC-50, FLC-50L, FLC-75L)
- ▶ Combo Head Set-Screw
- ▶ For AC, MCI, RWFC, ALFC

### NOTE

Insulated color may vary

Cat. No.	Description	Trade Size	Std. Pkg.	Master Ctn.
FLC-50	<b>STEEL "FASTLOCK" CONNECTOR</b> Steel AC 14/2 (0.440) to 10/3    AL AC 14/2 (0.475) to 10/3 Steel MC Interlocking (MCI) 0.437" to 0.565" O.D. AL MC Interlocking (MCI) 0.525" to 0.629" O.D. AL Corrugated Continuous (MCC) 0.350" to 0.592" O.D. Steel & AL Flex RWFC: 3/8"	1/2"	50	500
FLC-50L	<b>STEEL "FASTLOCK" WIDE-THROAT CONNECTOR</b> Steel AC 10/4 (0.625) to 6/3 (0.842)    AL AC 10/4 (0.625) to 8/4 (0.770) Steel MC Interlocking (MCI) 10/3 (0.594) to 6/2 (0.740) AL MC Interlocking (MCI) 10/3 (0.594) to 8/2 (0.650) Steel RWFC, AL RWFC, AL FMC: 1/2"	1/2"	50	500
FLC-75L	<b>STEEL "FASTLOCK" WIDE-THROAT CONNECTOR</b> Steel AC 10/4 (0.625) to 6/3 (0.840)    AL AC 10/4 (0.622) to 8/4 (0.760) Steel MC Interlocking (MCI) 10/3 (0.594) to 6/2 (0.746) AL MC Interlocking (MCI) 10/3 (0.582) to 8/2 (0.650) Steel RWFC, AL RWFC & AL FMC: 1/2"	3/4"	25	250
FLD-50	<b>STEEL "FASTLOCK" DUPLEX CONNECTOR</b> Steel AC 14/2 (0.454) to 12/4 (0.556) Aluminum AC 14/2 (0.485) to 12/4 (0.565) Steel MC Interlocking (MCI) 14/2 (0.470) to 12/4 (0.520) Aluminum MC Interlocking (MCI) 14/2 (0.460) to 12/4 (0.590) Steel RWFC, AL RWFC, AL FMC: 3/8"	1/2"	25	250



FLC-50



FLC-50/75L



FLD-50



## ANTI-SHORT BUSHINGS THERMOPLASTIC

### PRODUCT FEATURES

- ▶ High-Temperature Plastic
- ▶ Fits BX (AC) and Flex Conduits

## PVC NON-METALLIC (NM) CABLE CONNECTOR

### PRODUCT FEATURES

Heavy-Duty PVC

## NON-METALLIC CABLE CONNECTORS PUSH-IN TYPE

### PRODUCT FEATURES

- ▶ Flame-Retardant Polypropylene
- ▶ Special gripping arrangement for easy cable insertion



## CONDUIT LOCKING CONNECTOR

### PRODUCT FEATURES

- ▶ Steel
- ▶ Fits 4", 4-11/16" sq. and 40 boxes as well as Orbit's patented EALB/S
- ▶ Hooks prevent rotation of fixtures such as security cameras and emergency lighting
- ▶ Holes allow for seismic wiring
- ▶ Includes set-screw and locknut
- ▶ Can replace Rigid Threaded Conduit Fittings



**Video Available  
On Our Website!**

## STUD MOUNTING CABLE SUPPORT

### PRODUCT FEATURES

- ▶ Pre-Galvanized Steel
- ▶ Wood or Metal Stud
- ▶ Easy to Lock



Space Saving Packaging!

Cat. No.	For Use With	Trade Size	Std. Pkg.	Master Ctn.
<b>ASB-516</b>	14/2, 14/3, 12/2	5/16"	35	3500
<b>ASB-38</b>	14/4, 12/3, 6/1, 4/1	3/8"	35	2100
<b>ASB-716</b>	12/4, 10/2, 10/3, 2/1	7/16"	35	700
<b>ASB-50</b>	10/4, 8/2, 8/3, 1/1	1/2"	20	400
<b>ASB-75</b>	8/4, 6/2, 4/2, 4/3, 6/4	3/4"	16	320

Cat. No.	For Use With	Trade Size	Std. Pkg.	Master Ctn.
<b>NM-50</b>	One or Two 14/2, 14/3, 12/2 One 12/3, 10/2, 10/3 One or Two 0.3000" or 0.600" cords	1/2"	50	500

Cat. No.	For Use With	Trade Size	Std. Pkg.	Master Ctn.
<b>NMP-50</b>	One 10, 12, 14 AWG two-conductor cables with or without ground wire	1/2"	100	500



ASB



NM-50



NMP-50

Cat. No.	Trade Size	Std. Pkg.	Master Ctn.
<b>CLCSL-50</b>	1/2"	10	100
<b>CLCSL-75</b>	3/4"	10	100



CLCSL



Locknut  
Included



Before Installation

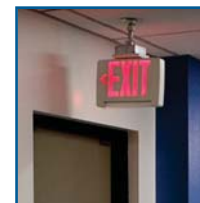

After Installation  
Prevents Rotation

Cat. No.	Description	Non-Metallic	MC/AC/BX	Std. Pkg.
<b>CS-CJ6</b>	Stud Mounting Cable Support with locking tab	Max. 6	Max. 4	100

