



Line Voltage Lighting





2033



2044



HL31-COP



HL31-ARB



S613



P639



LH150-SG



HL16



HL20



FGHL20



HL20S



HL30



HL38



HL38-MH70



FGHL38



HL2



5210



5212



5213



5214



FG5210



FG5213



S710C



S711C



S712C



S713C



S710H-E26



S710H-PLQ13



S710H-LED-120V



7711-A19



7817-A19



7603-A19



7613-A19



7614-A19



7605-A19



7615-A19



7606-A19



7607-A19



VPB2



VPW2



8300



8402



8330



8340



CTL-F



CTL-105



CTL-200



**LCTL-100
LCTL-120**



CFL-105W



CFL-200W



**LCB-100W-CW
LCB-120W-CW**



HHB1-MH400-PS



HHB1-WG



HHB1-WG2

LED 2033

PRODUCT FEATURES

- ▶ 120 Volts
- ▶ Medium Base E26 Socket
Lamp Not Included (60W Max.)
- ▶ Cast Aluminum
- ▶ 3-Tier
- ▶ **Frosted** Glass Lens Standard,
Clear by Request

POWDER COATED FINISHES

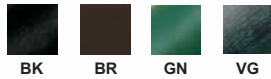

*Also Available in 12 Volts:
2030 on Page G9*

*Replacement Glass
(PG-3 & PG-3-F)
available on Page G40*



Shown In Black

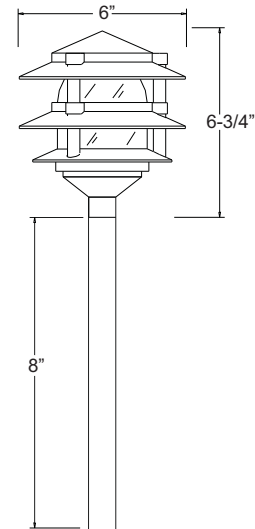

LED 2044

PRODUCT FEATURES

- ▶ 120 Volts
- ▶ Medium Base E26 Socket
Lamp Not Included (60W Max.)
- ▶ Cast Aluminum
- ▶ 4-Tier
- ▶ **Frosted** Glass Lens Standard,
Clear by Request

POWDER COATED FINISHES

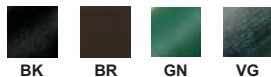

*Also Available in 12 Volts:
2040 on Page G10*

*Replacement Glass
(PG-4 & PG-4-F)
available on Page G40*



Shown In Black

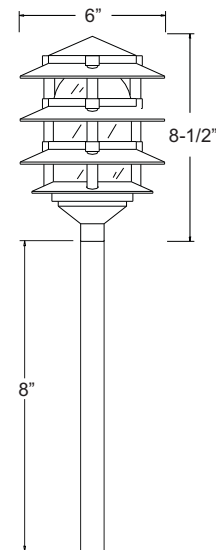



LED HL31-COP
PRODUCT FEATURES

- ▶ Solid Copper Polished
- ▶ 120 Volts
- ▶ PAR30 Lamp
Not Included (75W Max.)

FINISH

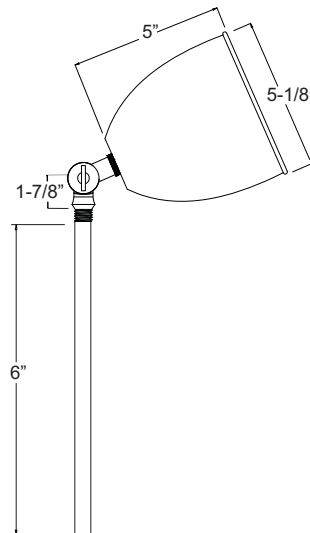

COPPER

LED HL31-ARB
PRODUCT FEATURES

- ▶ Solid Brass
- ▶ 120 Volts
- ▶ PAR30 Lamp
Not Included (75W Max.)

FINISH

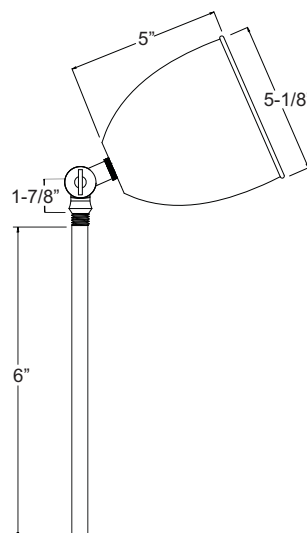
ARB





*S613

PRODUCT FEATURES

- ▶ Cast Aluminum
- ▶ 120 Volts
- ▶ PL13 Lamp Included
- ▶ Tempered Glass Lens

FINISH



GN

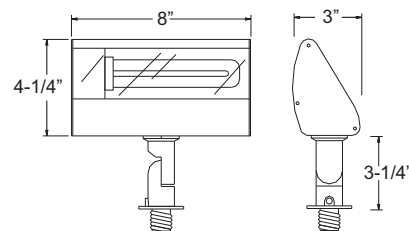

*P639

PRODUCT FEATURES

- ▶ Heavy-Duty ABS Plastic
- ▶ 120 Volts
- ▶ 3 X PL13 Lamp Included
- ▶ Acrylic Lens

FINISH



BK

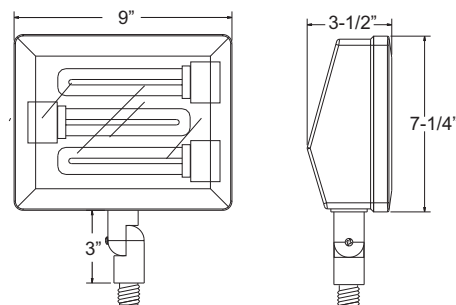

LED LH150-SG

PRODUCT FEATURES

- ▶ Cast Aluminum
- ▶ 120 Volts
- ▶ Black Silicon Gasket Seals Lamp
- ▶ PAR38 Lamp Not Included (90W Max.)
- ▶ Premium Lamp Holder

POWDER COATED FINISHES



BK BR GY WH



Shown In Gray

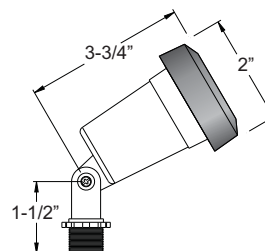

LED *HL16

PRODUCT FEATURES

- ▶ Cast Aluminum
- ▶ 120 Volts
- ▶ PAR16 or JDR16 Lamp Not Included (50W Max.)
- ▶ Tempered Glass Lens
- ▶ O-Ring Silicone Gasket

POWDER COATED FINISHES



BK BR



Shown In Black

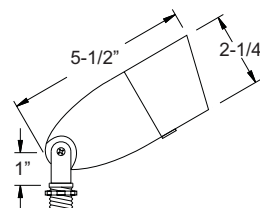

50JDR16 on
Page H20





LED *HL20

PRODUCT FEATURES

- ▶ Cast Aluminum
- ▶ 120 Volts
- ▶ PAR20 Lamp Not Included (50W Max.)
- ▶ Tempered Glass Lens
- ▶ O-Ring Silicone Gasket

POWDER COATED FINISHES

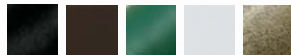

BK BR GN WH SA



Shown In Bronze

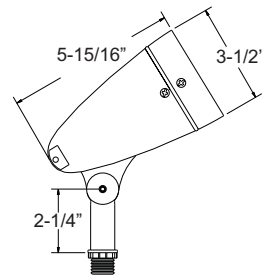

LED FGHL20

PRODUCT FEATURES

- ▶ Composite
- ▶ 120 Volts
- ▶ PAR20 Lamp Not Included (50W Max.)
- ▶ Convex Acrylic Lens
- ▶ O-Ring Silicone Gasket

FINISH



BR

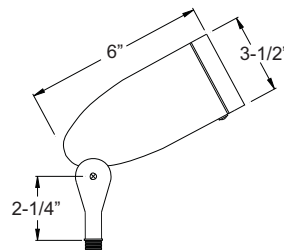

LED *HL20S

PRODUCT FEATURES

- ▶ Cast Aluminum
- ▶ 120 Volts
- ▶ PAR20 Lamp Not Included (50W Max.)
- ▶ Tempered Glass Lens
- ▶ O-Ring Silicone Gasket

POWDER COATED FINISHES



BK GN WH



Shown In Green

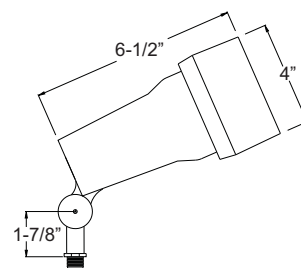

LED *HL30

PRODUCT FEATURES

- ▶ Cast Aluminum
- ▶ 120 Volts
- ▶ PAR30 Lamp Not Included (75W Max.)
- ▶ Tempered Glass Lens
- ▶ O-Ring Silicone Gasket

POWDER COATED FINISHES



BK BR GN WH



Shown In Bronze

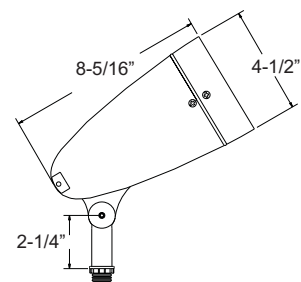

LED *HL38

PRODUCT FEATURES

- ▶ Cast Aluminum
- ▶ 120 Volts
- ▶ PAR38 Lamp
Not Included (90W Max.)
- ▶ Tempered Glass Lens
- ▶ O-Ring Silicone Gasket

POWDER COATED FINISHES



Shown In Bronze

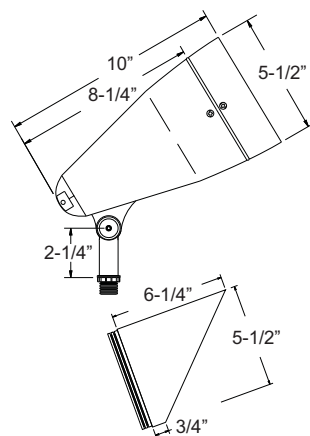

38V
Optional Glare
Shield for HL38

LED *HL38-MH70

PRODUCT FEATURES

- ▶ 120/208/240/277V,
Quad Tap CWA
- ▶ Metal Halide (MH) 70W Lamp
Included, 5500 Lumens, 65 CRI
Color Rendition

POWDER COATED FINISHES



Fixture Shown in
Black

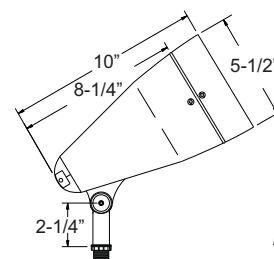

LED FGHL38

PRODUCT FEATURES

- ▶ Composite
- ▶ 120 Volts
- ▶ PAR38 Lamp
Not Included (90W Max.)
- ▶ Tempered Glass Lens
- ▶ O-Ring Silicone Gasket

FINISH

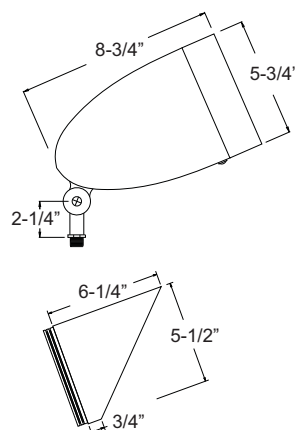

FG38V
Optional Glare
Shield for FGHL38

LED *HL2

PRODUCT FEATURES

- ▶ Cast Aluminum
- ▶ 120 Volts
- ▶ PAR38 Lamp
Not Included (90W Max.)
- ▶ Silicone Gasket

POWDER COATED FINISHES

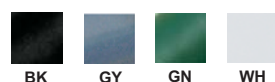

Shown In Green

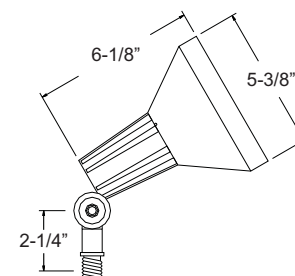

**120V****LED 5200 Series****PRODUCT FEATURES**

- ▶ Cast Aluminum
- ▶ PAR38 Lamp Not Included (75W Max.)
- ▶ Tempered Glass Lens
- ▶ 3 Holes on the Bottom: 1-SJT Cord, 1-Plug and 1-Blank
- ▶ 24" SJT Cord

POWDER COATED FINISHES

BK

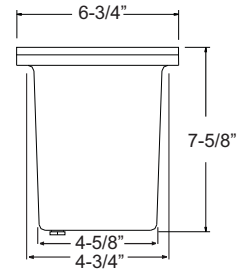
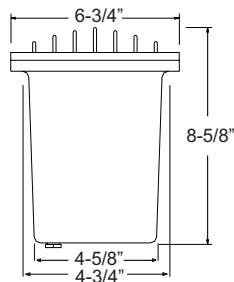
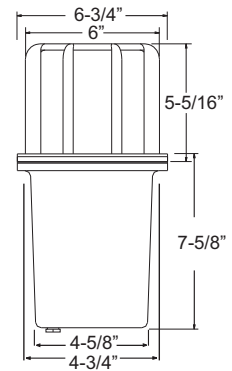
**5210****5213****5212*****5214****LED FG5200 Series****PRODUCT FEATURES**

- ▶ Fiberglass
- ▶ PAR38 Lamp Not Included (75W Max.)
- ▶ Tempered Glass Lens
- ▶ 3 Holes on the Bottom: 1-SJT Cord, 1-Plug and 1-Blank
- ▶ Corrosion Resistant

POWDER COATED FINISHES

BK

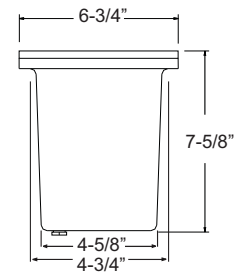
**FG5210****FG5213**



COVER PLATES

S710 Series

PRODUCT FEATURES

- ▶ Cast Aluminum
- ▶ Frosted Glass Lens
- ▶ Silicone Gasket Included

POWDER COATED FINISHES



S710C

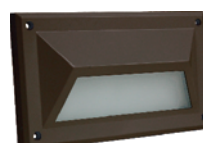
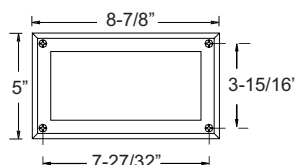

S711C

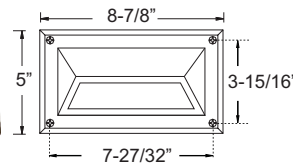

S712C

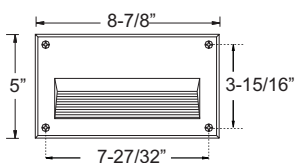

S713C

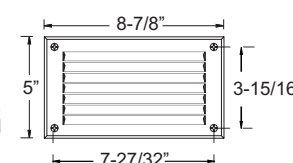

Only Use with S710H-E26

ORDERING GUIDE SAMPLE

Housing: S710H-E26
Coverplate Config.: S713C-BK

Order Housing & Coverplate Separately

HOUSING OPTIONS (120V)

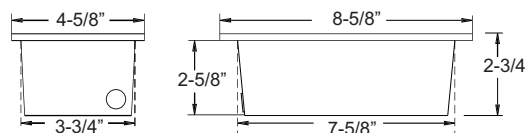

S710H-E26

PRODUCT FEATURES

- ▶ Powder Coated Cast Aluminum
- ▶ 120 Volts
- ▶ T-10 Lamp Not Included (40W Max.)
- ▶ Medium Base Socket
- ▶ Use with S710C, S711C, S712C or S713C Coverplates

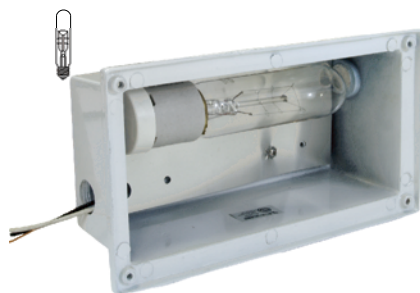

*S710H-PLQ13

PRODUCT FEATURES

- ▶ Powder Coated Cast Aluminum
- ▶ 120 Volts
- ▶ PLQ13 13W Lamp Included
- ▶ Use with S710C, S711C or S713C Coverplates



S710H-LED-120V

PRODUCT FEATURES

- ▶ Powder Coated Cast Aluminum
- ▶ 120 Volts
- ▶ 5.70W Input Power
- ▶ Color Temperature: 4000K
- ▶ Use with S710C, S711C or S713C Coverplates



*Also Available in 12 Volts:
S710H-LED-12V on Page G26*

LED *7711-A19
PRODUCT FEATURES

- ▶ 120 Volts
- ▶ Medium Base E26 Socket
- ▶ Lamp Not Included (100W Max.)
- ▶ Cast Aluminum
- ▶ Silicone Gasket
- ▶ Opal Polycarbonate Lens

POWDER COATED FINISHES

WH

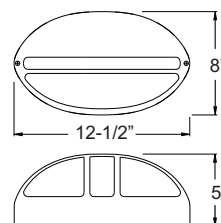
LED *7817-A19
PRODUCT FEATURES

- ▶ 120 Volts
- ▶ Medium Base E26 Socket
- ▶ Lamp Not Included (100W Max.)
- ▶ Cast Aluminum
- ▶ Silicone Gasket
- ▶ Frosted Glass Lens

POWDER COATED FINISHES

BR

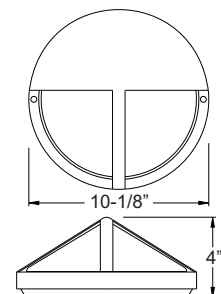

WH

LED *7603-A19
PRODUCT FEATURES

- ▶ 120 Volts
- ▶ Medium Base E26 Socket
- ▶ Lamp Not Included (60W Max.)
- ▶ Cast Aluminum
- ▶ Silicone Gasket
- ▶ Frosted Glass Lens

POWDER COATED FINISHES

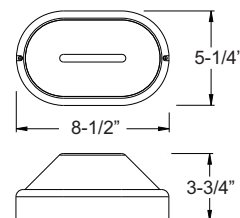

WH

LED *7613-A19
PRODUCT FEATURES

- ▶ 120 Volts
- ▶ Medium Base E26 Socket
- ▶ Lamp Not Included (100W Max.)
- ▶ Cast Aluminum
- ▶ Silicone Gasket
- ▶ Frosted Glass Lens

POWDER COATED FINISHES

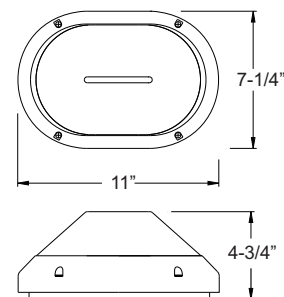
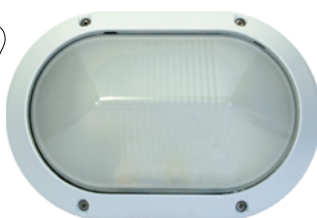

WH

LED *7614-A19
PRODUCT FEATURES

- ▶ 120 Volts
- ▶ Medium Base E26 Socket
- ▶ Lamp Not Included (100W Max.)
- ▶ Cast Aluminum
- ▶ Silicone Gasket
- ▶ Frosted Glass Lens

POWDER COATED FINISHES

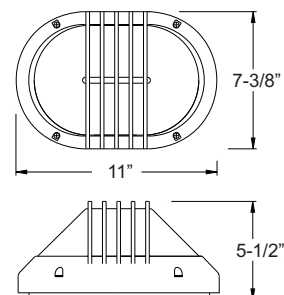
WH





*7605-A19

PRODUCT FEATURES

- ▶ 120 Volts
- ▶ Medium Base E26 Socket
Lamp Not Included (60W Max.)
- ▶ Cast Aluminum
- ▶ Silicone Gasket
- ▶ Frosted Glass Lens

POWDER COATED FINISHES



WH

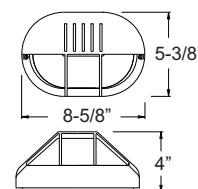

*7615-A19

PRODUCT FEATURES

- ▶ 120 Volts
- ▶ Medium Base E26 Socket
Lamp Not Included (100W Max.)
- ▶ Cast Aluminum
- ▶ Silicone Gasket
- ▶ Frosted Glass Lens

POWDER COATED FINISHES



WH

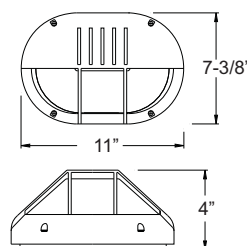

*7606-A19

PRODUCT FEATURES

- ▶ 120 Volts
- ▶ Medium Base E26 Socket
Lamp Not Included (60W Max.)
- ▶ Cast Aluminum
- ▶ Silicone Gasket
- ▶ Opal Polycarbonate Lens

POWDER COATED FINISHES



BR



WH

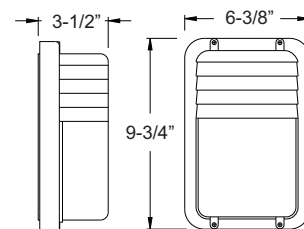

*7607-A19

PRODUCT FEATURES

- ▶ 120 Volts
- ▶ Medium Base E26 Socket
Lamp Not Included (60W Max.)
- ▶ Cast Aluminum
- ▶ Silicone Gasket
- ▶ Opal Polycarbonate Lens

POWDER COATED FINISHES



BR



WH

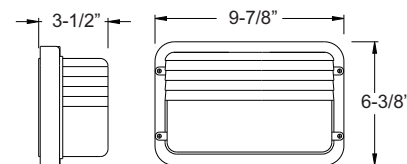

LED 150 Watt Small Jar

PRODUCT FEATURES

- ▶ Die Cast Aluminum with Die Cast Guard
- ▶ Silicone Gasket
- ▶ Medium Base E26 Socket
- ▶ Lamp Not Included (150W Max.)
- ▶ 1/2" NPS Hub Size
- ▶ Clear Glass Jar

Also Available as
LED Fixture (Pg. 14)



VPB2

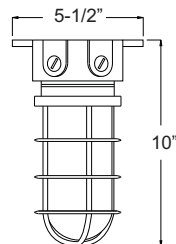

VPW2

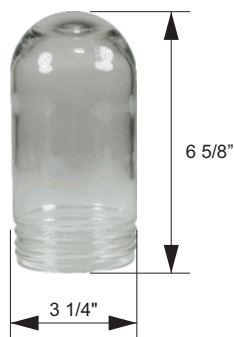
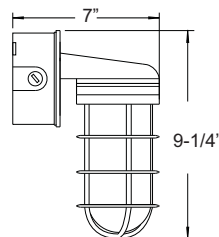

VG20-CL

Replacement Glass



LED Standard Series

PRODUCT FEATURES

- ▶ Cast Aluminum
- ▶ 120V
- ▶ Medium Base E26 Socket, Lamp Not Included
- ▶ Opal Polycarbonate Lens
- ▶ Includes Mounting Hardware and Anchors

POWDER COATED FINISHES

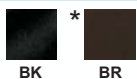

8300

Shown in Black

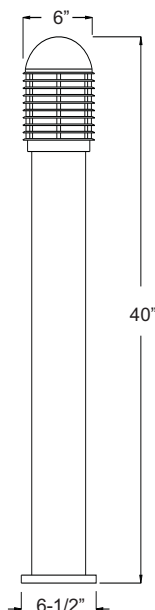

8402

Shown in Black



LED Spec. Series

PRODUCT FEATURES

- ▶ Heavy-Duty Cast Aluminum
- ▶ 6 Levels of Tempered Glass
- ▶ Medium Base E26 Socket, Lamp Not Included
- ▶ Includes Mounting Hardware and Anchors

POWDER COATED FINISHES

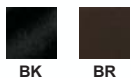

***8330**

Shown in Black

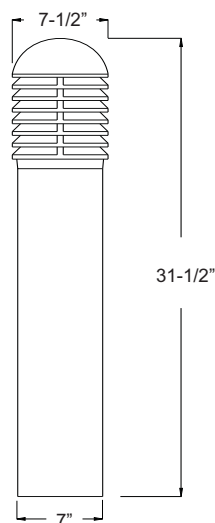

***8340**

Shown in Black

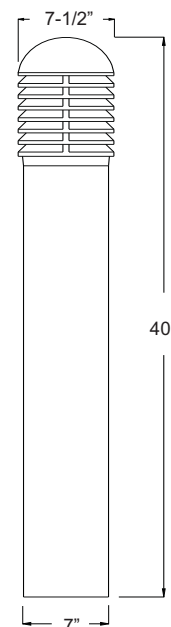

H.I.D. Lighting

CONSTRUCTION TEMP LIGHTS

PRODUCT FEATURES

- ▶ Rugged steel construction
- ▶ 120~277 Volts
- ▶ E39 Mogul Base
- ▶ Stainless steel snap hook easily attaches fixture to any structural member
- ▶ Welded steel cage and Snap-On Shatter Guard ensures maximum workplace safety
- ▶ 6 ft., 3-prong male plug
- ▶ 6 in., 3-prong female plug
- ▶ Orange Powder Coating for high visibility

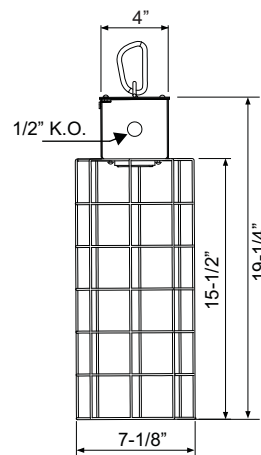

CTL AND LAMP ASSEMBLY

Cat. No.	Lamp	Wattage	Color Temp.	Lumens	Life Hours
CTL-105	105 CFL	105W	6400K	5,250 lm	10,000 hrs
CTL-200	200 CFL	200W	6400K	10,000 lm	10,000 hrs
LCTL-100	100 LED	100W	6000K	13,000 lm	50,000 hrs
LCTL-120	120 LED	120W	5000K	17,500 lm	50,000 hrs



CTL-105



CTL-200

LCTL-100
LCTL-120

LAMPS ONLY

COMPACT FLUORESCENT

Cat. No.	Wattage	Color Temp.	Lumens	Life Hours
CFL-105W	105W	6400K	5,250 lm	10,000 hrs
CFL-200W	200W	6400K	10,000 lm	10,000 hrs



CFL-105W



CFL-200W

LED

Cat. No.	Wattage	Color Temp.	Lumens	Life Hours
LCB-100W-CW	100W	6000K	13,000 lm	50,000 hrs
LCB-120W-CW	120W	5000K	17,500 lm	50,000 hrs

LCB-100W-CW
LCB-120W-CW



*** HHB1-MH400-PS
(Pulse Start)**

BALLAST

- 120/208/240/277V Quad CWA

LAMP

- Mogul Base 400W Metal Halide Lamp Included, 33100 Lumens, 82 CRI Color Rendition

PRODUCT FEATURES

- Cast Aluminum Construction
- High-Bay Light with Wire Guard
- Chrome Steel Wire Guard Protects Bulb
- Hook Included

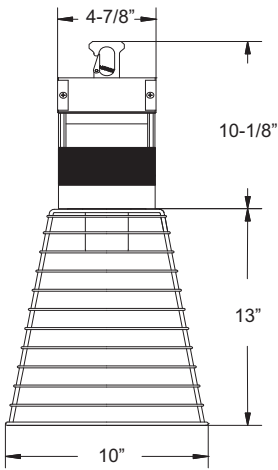

**TEMP LIGHT
ACCESSORIES**

Cat. No.	Description
HHB1-WG	Chrome Steel Wire Guard
HHB1-WG2	Chrome Steel Wire Guard



HHB1-WG



HHB1-WG2

HIGH/LOW BAY ACCESSORIES

ALL ACCESSORIES CAN BE
USED WITH MOST FIXTURES

Cat. No.	Description
EALB	Easy Access Lighting Box 2 1/8" Deep
EALBS	Easy Access Lighting Box 2 1/8" Deep with the Sliding Swivel Cover Plate
SCS-75	Swivel Cover for Square Box, 3/4" Hub with 1/2" Reducing Bushing
SCR-75	Swivel Cover for Round Box, 3/4" Hub with 1/2" Reducing Bushing
HHB2-AR16	16" Aluminum Reflector Dome
HHB2-AR22	22" Aluminum Reflector Dome
HHB2-ACR16	16" Prismatic Acrylic Reflector Dome, Requires HHB2-CO16 Collar for installation (Sold Separately)
HHB2-ACR22	22" Prismatic Acrylic Reflector Dome, Requires HHB2-CO22 Collar for installation (Sold Separately)
HHB2-GL16	16" Tempered Glass Lens with Rubber Gasket (Clamp Band Required for Installation, Sold Separately)
HHB2-GL22	22" Tempered Glass Lens with Rubber Gasket (Clamp Band Required for Installation, Sold Separately)
HHB2-WG16	16" Wire Guard, Chrome Steel
HHB2-WG22	22" Wire Guard, Chrome Steel
HHB2-ACDL16	16" Acrylic Drop Lens (Clamp Band Required for Installation, Sold Separately)
HHB2-ACDL22	22" Acrylic Drop Lens (Clamp Band Required for Installation, Sold Separately)
HHB2-CH	3/4" Cast Hook
HHB2-CB16	16" Clamp Band
HHB2-CB22	22" Clamp Band
HHB2-CO16	Collar for 16" Prismatic Dome
HHB2-CO22	Collar for 22" Prismatic Dome

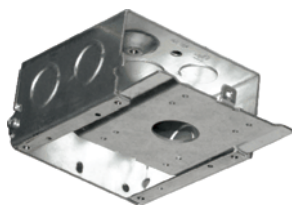

EALB



EALBS



SCS-75

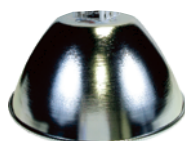

SCR-75

HHB2-AR16
HHB2-AR22HHB2-ACR16
HHB2-ACR22HHB2-GL16
HHB2-GL22HHB2-WG16
HHB2-WG22HHB2-ACDL16
HHB2-ACDL22

HHB2-CH

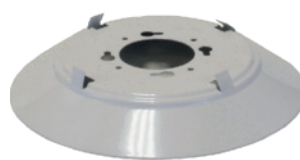
HHB2-CB16
HHB2-CB22

HHB2-CO16

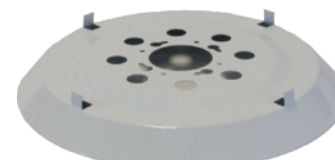

HHB2-CO22

EASY ACCESS LIGHTING BOX 2-1/8" DEEP

30.2 Cu. In.

PRODUCT FEATURES

- ▶ Fast and efficient installations
- ▶ Sliding cover plate for one person installations
- ▶ Available with either standard or swivel sliding cover plate
- ▶ Swivel reduces damage to hanging fixtures when struck
- ▶ Complies with NEC 314.27 (A)(D) for up to 90 lbs. of fixture load (for more information see pg. W14)

Cat. No.	Description	Dimensions (W x H)	Knockouts		Std. Pkg.
			Sides	Bottom	
EALB	Easy Access Lighting Box	4" X 4"	4-CKO	3-1/2", 1-3/4"	50
EALBS	Easy Access Lighting Box with the Sliding Swivel	4" X 4"	4-CKO	3-1/2", 1-3/4"	10

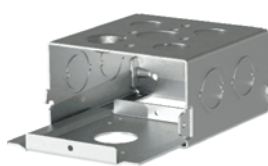

EALB



EALBS

Only box UL-Listed for up to 90lbs of fixture load!

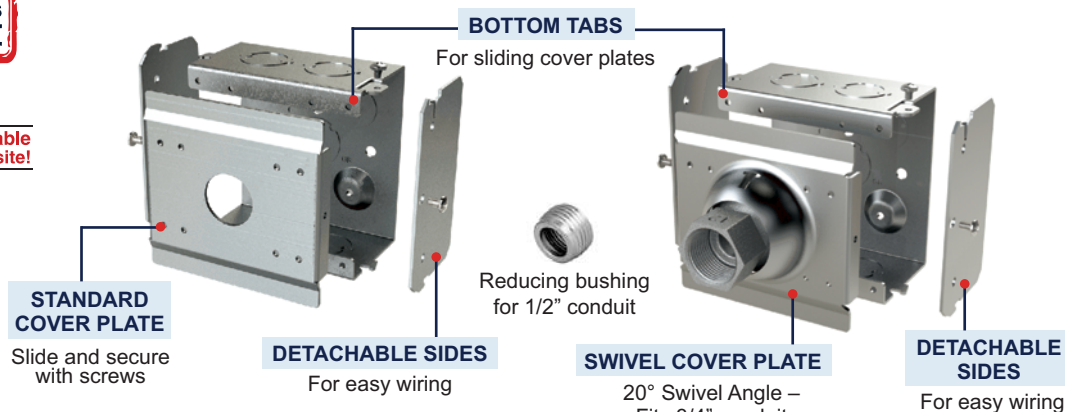

**50%
LABOR
SAVINGS**

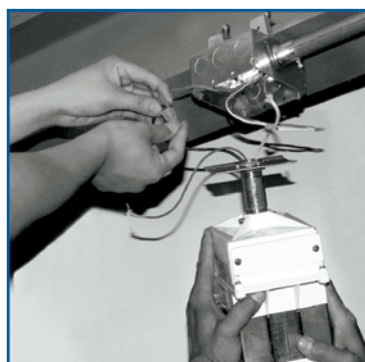

TRADITIONAL METHOD

Requires two installers

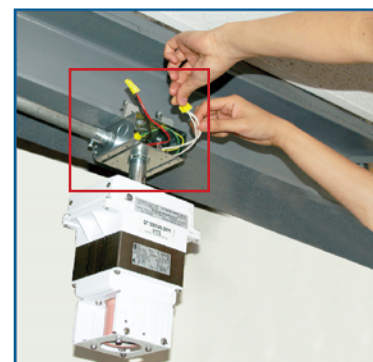

WITH ORBIT'S EALB/S

Only one installer



(1) Install EALB with side plate and cover plate REMOVED

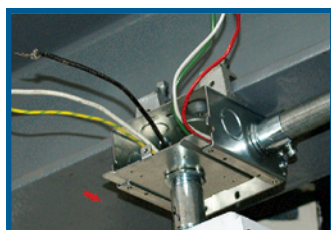

(2) Install cover plate on lighting fixture and slide it back into the box

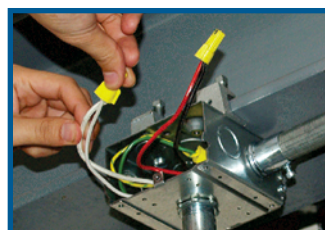

(3) Complete wiring

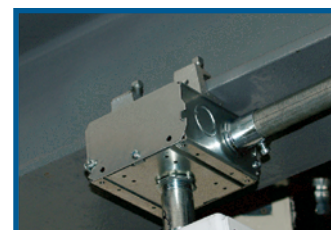

(4) Attach side plate with screws to finish installation

BAL SERIES

FLUORESCENT EMERGENCY LIGHTING BALLASTS LAMP COMPATIBILITY

PRODUCT FEATURES

- ▶ Dual-Voltage Input 120/277VAC Operation
- ▶ UL Listed for Damp Location (0°C – 50°C)
- ▶ Two rate charger initiates battery charging to recharge an empty battery in 24 hours
- ▶ 90 Minutes Minimum Emergency Operation
- ▶ Suitable for installation inside, on top or in remote of the fixture
- ▶ Battery, Charger and Inverter Circuit included
- ▶ White finish (BAL500-1400)
- ▶ Red finish (BAL3000)

Voltage	Max Lumens	Battery
BAL500	500	2.4V
BAL650C	750	3.6V
BAL700	700	3.6V
BAL1400	1400	6.0V
BAL3000	3000	14.4V

BAL 500

PRODUCT FEATURES

- ▶ Compatible with most One-, Two-, Three-, and Four-Lamp Electronic Standard and Dimming AC Ballasts
- ▶ Operates one T5, T5HO, T8, T12, Circular T5/T9, U-bend T8/T12, 4-Pin CFL and long CFL lamp in emergency mode. For the complete compatibility list, visit www.orbitelectric.com

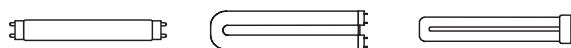
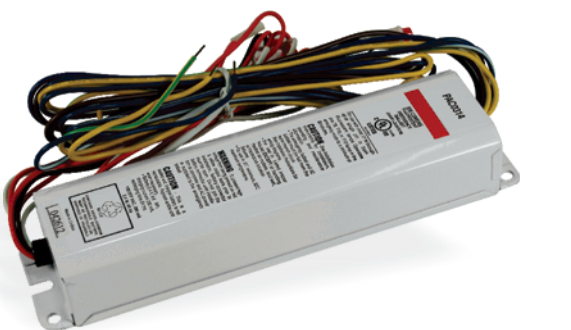
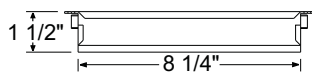
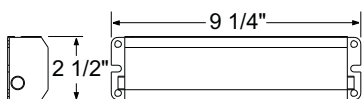

BAL650C-2PIN

PRODUCT FEATURES

- ▶ Compatible with most One-, Two-, Three-, and Four-Lamp Electronic Standard and Dimming AC Ballasts
- ▶ Operates one 13W-26W, 2-pin compact fluorescent lamps with GX23 and G24D bases. For complete compatibility list, visit www.orbitelectric.com

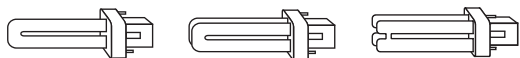

BAL650C-4PIN

PRODUCT FEATURES

- ▶ Compatible with most One-, Two-, Three-, and Four-Lamp Electronic Standard and Dimming AC Ballasts
- ▶ Operates one or two T5, T5HO, T8, T12, Circular T9, U-bend T8/T12, 4-Pin CFL and long CFL lamp in emergency mode. For the complete compatibility list, visit www.orbitelectric.com

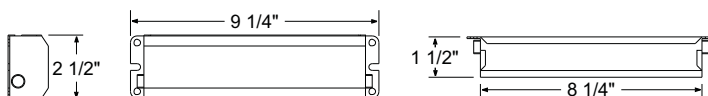

BAL 700

PRODUCT FEATURES

- Compatible with most One-, Two-, Three-, and Four-Lamp Electronic Standard and Dimming AC Ballasts
- Operates one or two T5, T5HO, T8, T12, T8HO, T12HO, Circular T5/T9, U-bend T8/T12, 4-Pin CFL and long CFL lamp in emergency mode. For the complete compatibility list, visit www.orbitelectric.com

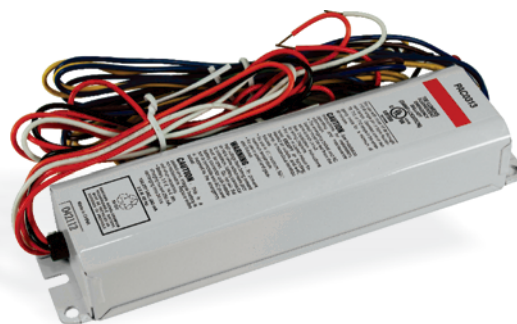
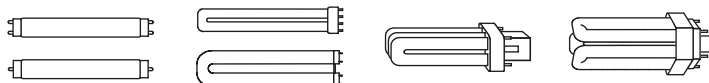
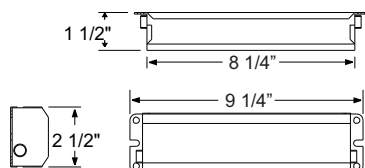

BAL 1400

PRODUCT FEATURES

- Compatible with most One-, Two-, Three-, and Four-Lamp Electronic Standard and Dimming AC Ballasts
- Operates one or two T5, T5HO, T8, T12, T8HO, T12HO, Circular T5/T9, U-bend T8/T12, 4-Pin CFL and long CFL lamp in emergency mode. For the complete compatibility list, visit www.orbitelectric.com

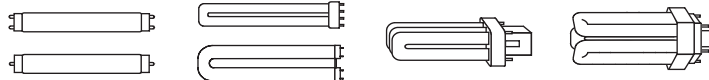
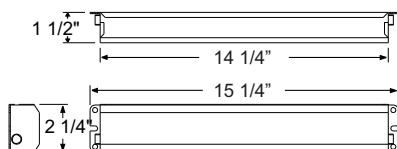

BAL 3000

PRODUCT FEATURES

- Compatible with most One-, Two-, Three-, and Four-Lamp Electronic Standard and Dimming AC Ballasts
- Operates one or two T5, T5HO, T8, T12, T8HO, T12HO, Circular T5/T9, U-bend T8/T12, 4-Pin CFL and long CFL lamp in emergency mode. For the complete compatibility list, visit www.orbitelectric.com

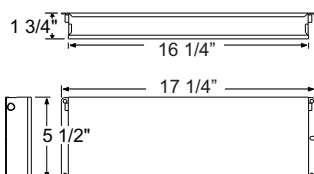

Cat. No.	Type	WATTAGE	DESCRIPTION	VOLTAGE
* BAL50HPSKIT	High Pressure Sodium	50W Non UL	Ballast & Ignitor	120V
* BAL70HPSKIT	High Pressure Sodium	70W	Ballast & Ignitor	120V
* BAL150HPSKIT	High Pressure Sodium	150W	Ballast & Ignitor	120V
* BAL250HPSKIT	High Pressure Sodium	250W	Ballast & Ignitor	120~277V
* BAL400HPSKIT	High Pressure Sodium	400W	Ballast & Ignitor	120~277V
* BAL70MHKIT	Metal Halide	70W	Ballast & Ignitor & Capacitor	120~277V
* BAL175MHKIT	Metal Halide	175W	Ballast & Ignitor & Capacitor	120~277V
* BAL250MHKIT	Metal Halide	250W	Ballast & Ignitor & Capacitor	120~277V
* BAL400MHKIT	Metal Halide	400W	Ballast & Ignitor & Capacitor	120~277V
* BAL150MH-PSKIT	Metal Halide-Pulse Start	150W	Ballast & Ignitor & Capacitor	120~277V
* BAL250MH-PSKIT	Metal Halide-Pulse Start	250W	Ballast & Ignitor & Capacitor	120~277V
* BAL400MH-PSKIT	Metal Halide-Pulse Start	400W	Ballast & Ignitor & Capacitor	120~277V

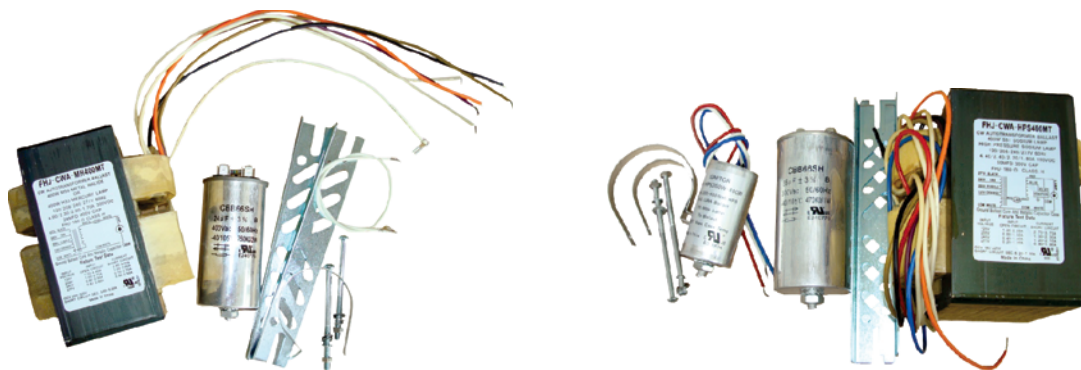

Cat No.

Description

LET-60-LW	LET 60 AC 120 12 CL2 Low Watt has a low minimum connected load requirement of only 2.9 Watts
LET-60-GW	LET 60 AC 120 12 CL2 Ground Wire has a ground wire with lug and double-sided tape attached to the back of the transformer
LVT-60	LVT 60 AC 120 12 CL2 has a 60 Watt transformer mounting within an enclosure, for remote mounting
LET-75	LET 75 AC 120 12 Standard 75 Watt Transformer
LET-75-277	LET 75 AC 277 12 Standard 75 Watt Transformer
LET-151-12	LET 151 AC 120 12R, 150W max, 50W min with 12V Output
LET-151-24	LET 151 AC 120 24R, 150W max, 50W min with 24V Output

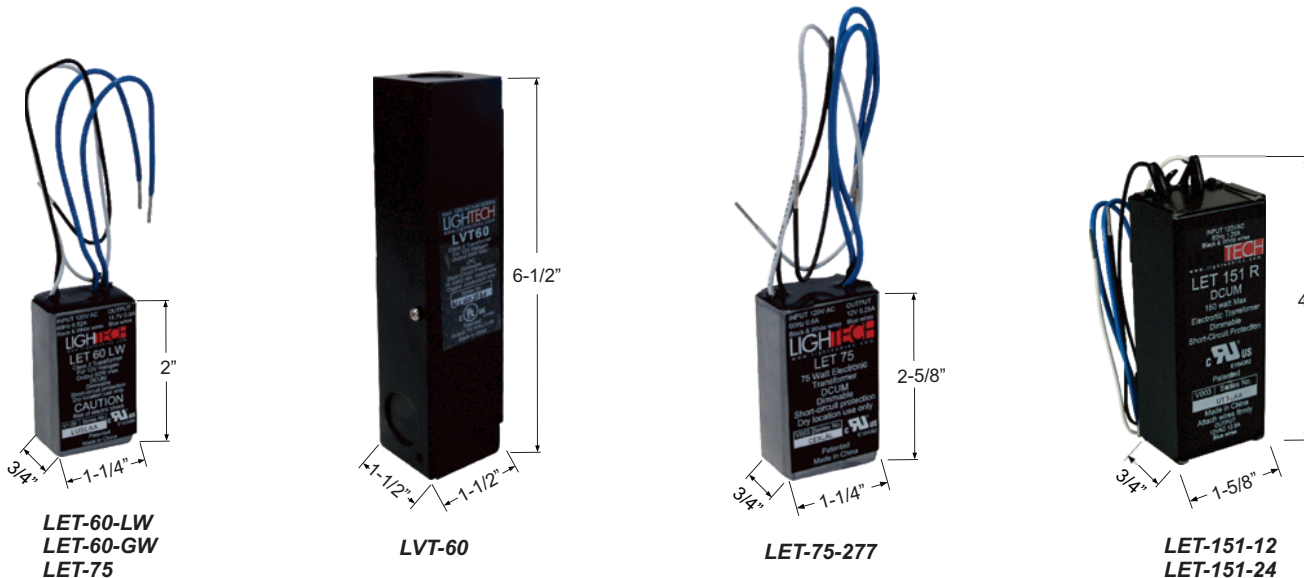



PRODUCT FEATURES

- ▶ 120V
- ▶ T5 Fluorescent Lamp
- ▶ Electronic Class P Ballast
- ▶ Switch Included
- ▶ Heavy Gauge Steel with Flush Ends
- ▶ K.O.s on Top, Sides, and Back
- ▶ Baked White Enamel
- ▶ With Rust Inhibiting Phosphate Coat

Cat No.	Description	Lamp (Included)
*UCL-12	12" Under Cabinet Electronic Ballast	One 8W T5
*UCL-21	21" Under Cabinet Electronic Ballast	One 13W T5
*UCL-24	24" Under Cabinet Electronic Ballast	Two 8W T5



UCL-12

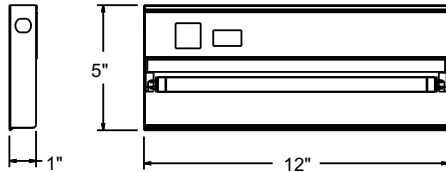

UCL-21

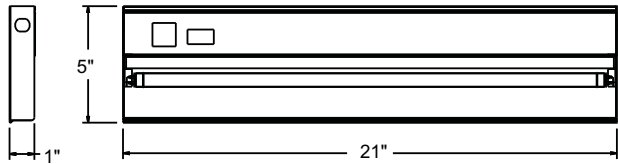

UCL-24

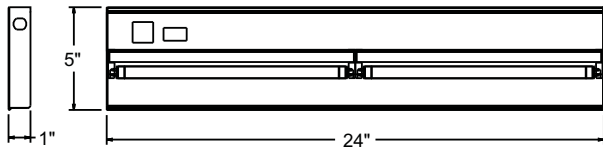



Cat. No.	Description	Voltage	Wattage	Base	Life (Hrs.)	Std. Pkg.
100T4	Halogen Lamp	120V	100W	G8	12000	10
JC-20-120V	JC Halogen	120V	20W	GY6.35	1500	20
JC-50-120V	JC Halogen	120V	20W	GY6.35	1500	20
50JDR16	JDR16 Halogen, 40° Flood	120V	50W	E26	2000	10
40T10	Medium Base Lamp for Step Lights	120V	40W	E26	1000	10
PLQ9-41K	Compact Quad Fluorescent, 4100K	120V	9W	G23.2	10000	20
PL9-41K	Compact Fluorescent, 4100K	120V	9W	G23	10000	10
PLQ13-41K	Compact Quad Fluorescent, 4100K	120V	13W	G23.2	10000	10
PLQ26-41K	Compact Quad Fluorescent, 4100K	120V	26W	G24q-3	10000	10
PL13-41K	Compact Fluorescent, 4100K	120V	13W	GX23	12000	10
MH70/PAR38/FL/4K	Metal Halide PAR38 Lamp	120V~277V	70W	E26	10000	1
MH100/PAR38/FL/4K	Metal Halide PAR38 Lamp	120V~277V	100W	E26	10000	1
MV160/R40/FL/4K	R40 Mercury Vapor, Self-Ballast, Flood 4K	120V	160W	E26	10000	6
*LMR16-3W-EB-WW	LED MR16 Edison Base Bulb, WW (3000K)	120V	3W	E26/E27	50000	10
*LMR16-4W-EB-WW	LED MR16 Edison Base Bulb, WW (3000K)	120V	4W	E26/E27	50000	24
*LMR16-4W-EB-CW	LED MR16 Edison Base Bulb, CW (4700K)	120V	4W	E26/E27	50000	24
LA19-8W-D-WW	LED A19 Edison Base Dimm. Bulb, WW (3000K)	120V	8W	E26/E27	50000	24
LA19-8W-D-CW	LED A19 Edison Base Dimm. Bulb, CW (4700K)	120V	8W	E26/E27	50000	24
LPAR20-8W-D-WW	LED PAR20 Edison Base Dimm. Bulb WW (3000K)	120V	8W	E26/E27	50000	24
LPAR20-8W-D-CW	LED PAR20 Edison Base Dimm. Bulb, CW (4700K)	120V	8W	E26/E27	50000	24
LPAR30-12W-D-WW	LED PAR30 Edison Base Dimm. Bulb, WW (3000K)	120V	12W	E26/E27	50000	24
LPAR30-12W-D-CW	LED PAR30 Edison Base Dimm. Bulb, CW (4700K)	120V	12W	E26/E27	50000	24
LPAR38-16W-D-WW	LED PAR38 Edison Base Dimm. Bulb, WW (3000K)	120V	16W	E26/E27	50000	24
LPAR38-16W-D-CW	LED PAR38 Edison Base Dimm. Bulb, CW (4700K)	120V	16W	E26/E27	50000	24
LPAR38-15W-D-WW-OD	LED PAR38 Edison Base Dimm. Bulb, WW (3000K), Outdoor	120V	15W	E26/E27	25000	1
LPAR38-15W-D-CW-OD	LED PAR38 Edison Base Dimm. Bulb, CW (5000K), Outdoor	120V	15W	E26/E27	25000	1



100T4



**JC-20-120V
JC-50-120V**



50JDR16



40T10



PLQ9-41K



PL9-41K



**PLQ13-41K
PLQ26-41K**



PL13-41K



***LMR16-3W-EB-WW**



***LMR16-4W-EB-WW
*LMR16-4W-EB-CW**



**LA19-8W-D-WW
LA19-8W-D-CW**



**LPAR20-8W-D-WW
LPAR20-8W-D-CW**



**LPAR30-12W-D-WW
LPAR30-12W-D-CW**



**LPAR38-16W-D-WW
LPAR38-16W-D-CW**



**LPAR38-15W-D-WW-OD
LPAR38-15W-D-CW-OD**

Disclaimer: Shape, Design, and Finish may change without prior notice

www.orbitelectric.com

**While Supplies Last*