



# Electrical Fittings | D



Orbit features an extensive variety of Electrical Fittings in sizes and shapes to fit any application. Each fitting is constructed to meet our high standards, resulting in a group of products consisting of a quality found nowhere else. Our vast selection includes EMT, Rigid, Liquid Tight, Conduit Bodies, Elbows, Straps, Groundings and more.

**EMT FITTINGS**

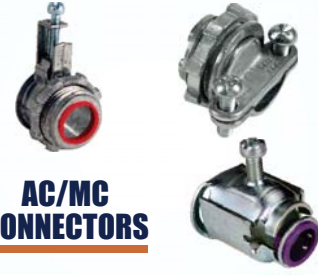
**FLEX CONNECTORS**

**AC/MC  
CONNECTORS**

**LIQUID TIGHT  
CONNECTORS**

**GROUNDINGS**

**CONDUIT  
BODIES**

**STRAPS**

**CONDUIT  
ELBOWS**

**AND MORE...**

## MATERIALS

**STEEL, DIE CAST ZINC,  
MALLEABLE IRON, AND PVC.**



Steel



Die Cast Zinc



Malleable Iron



PVC

Orbit's fittings are available in a variety of sizes and high quality materials.



## EMT Combination Couplings | Pg. D6



### FOR A SMOOTHER TRANSITION

Combination Couplings have been added in the form of Rigid to EMT and EMT to Liquid Tight Combination Couplings. Both fittings are available in 1/2", 3/4" and 1" sizes. Rigid to EMT are available in Set-Screw Type while the EMT to Liquid Tights are available as a Compression Type Fitting.

## Double-Snap Connectors | Pg. D13



### A SIMPLE AND TOOL- FREE INSTALLATION

Double-Snap Connectors make connecting AC/MC cables to enclosures easy and tool-free. Available for new and old-work installations, each connector can be assembled to the cable or box without the need for tools, resulting in a faster installation. Both are also easily removable and can be reused.



## Liquid Tight Lay-In Lugs | Pg. D19~D21



**PERFECT FOR  
SOLAR INSTALLATIONS**

A variety of Liquid Tight Connectors featuring Lay-In Lugs have been added to our Liquid Tight offering. These fittings are available in a range of different sizes in straight, 45° and 90° angles. Each features an aluminum lay-in lug which allows for an easy installation of ground wire.

## Terminal Lugs | Pg. D28~D29



**PERFECT FOR FACILIATING  
MECHANICAL CONNECTIONS**

Terminal Lugs provide an access point for grounding contact points between loads. They quickly connect wires to metal enclosures through the use of a set-screw. Available in Aluminum. Dual rated for Copper and Aluminum conductors





## Intersystem Grounding Bridges | Pg. D29



**FOR A RELIABLE  
BONDING CONNECTION**

Intersystem Ground and Bonding Bridges provide a reliable bonding connection between power and communication ground systems. Each Bridge can accommodate multiple communication system hookups. Available in Zinc Die Cast and Bronze.

## Conduit Clamps | Pg. D53



**PROVIDE A SECURE SUPPORT  
OF HEAVY LOADS**

Available in 3 types - Edge, Right Angle and Parallel Type - Orbit's new Conduit Clamps are used to secure Rigid, IMC and EMT conduits to beams and channels. Featuring a Malleable Iron construction, these Clamps are capable of supporting heavy loads, ensuring protection to the raceway.



## Form 7 & 8 Conduit Bodies

Orbit's Form 7 and 8 Conduit Bodies can be used in wet locations and are perfect for industrial manufacturing facilities. Each Conduit Body features a Gray Iron construction, tapered threads and integral bushings for greater wire protection.

### Form 7 Conduit Bodies | Pg. D44~D47

Electrical Fittings



#### A MORE COMPACT INDUSTRIAL CONDULET

Form 7 Bodies feature a smaller design for a neat and compact installation. A special clip-on cover attachment allows for a quick and simple installation and removal.

### Form 8 Conduit Bodies | Pg. D47~D50



#### LARGER CONDUIT FOR LARGER JOBS

Form 8 Bodies are larger, providing more room for heavier and wide conductors. Similar to Form 7, each Form 8 Conduit Body features tapered threads and integral bushings for greater wire protection.

## STEEL EMT CONNECTORS SET-SCREW TYPE

### PRODUCT FEATURES

- ▶ Electroplated Zinc
- ▶ Concrete-Tight when taped
- ▶ Suitable for applications above 600V

### NOTE

- ▶ Sizes 2-1/2" to 4" are also listed for RIGID and IMC Conduits

Cat. No.	Trade Size	Std. Pkg.	Master Ctn.
OF7701	1/2"	50	500
OF7702	3/4"	25	250
OF7703	1"	10	100
OF7704	1-1/4"	10	100
OF7705	1-1/2"	10	50
OF7706	2"	5	50
OF7707	2-1/2"	-	12
OF7708	3"	-	12
OF7709	3-1/2"	-	6
OF7710	4"	-	6



1/2" to 1"



1-1/4" to 2"



2-1/2" to 4"

## STEEL INSULATED EMT CONNECTORS SET-SCREW TYPE

### PRODUCT FEATURES

- ▶ Electroplated Zinc
- ▶ With Insulated Throat
- ▶ Concrete-Tight when taped
- ▶ Suitable for applications above 600V

### NOTE

- ▶ Sizes 2-1/2" to 4" are also listed for RIGID and IMC Conduits
- ▶ Insulated color may vary

Cat. No.	Trade Size	Std. Pkg.	Master Ctn.
OF7701-S	1/2"	50	500
OF7702-S	3/4"	25	250
OF7703-S	1"	10	100
OF7704-S	1-1/4"	10	100
OF7705-S	1-1/2"	10	50
OF7706-S	2"	5	50
OF7707-S	2-1/2"	-	12
OF7708-S	3"	-	12
OF7709-S	3-1/2"	-	6
OF7710-S	4"	-	6



1/2" to 1"



1-1/4" to 2"



2-1/2" to 4"

## STEEL EMT COUPLINGS SET-SCREW TYPE

### PRODUCT FEATURES

- ▶ Electroplated Zinc
- ▶ Concrete-Tight when taped
- ▶ Suitable for applications above 600V

### NOTE

- ▶ Sizes 2-1/2" to 4" are also listed for RIGID and IMC Conduits

Cat. No.	Trade Size	Std. Pkg.	Master Ctn.
OF7711	1/2"	50	500
OF7712	3/4"	25	250
OF7713	1"	10	100
OF7714	1-1/4"	10	100
OF7715	1-1/2"	10	50
OF7716	2"	5	50
OF7717	2-1/2"	-	12
OF7718	3"	-	12
OF7719	3-1/2"	-	6
OF7720	4"	-	6



1/2" to 1"



1-1/4" to 2"



2-1/2" to 4"

**STEEL EMT CONNECTORS  
COMPRESSION TYPE  
& RAIN-TIGHT**
**PRODUCT FEATURES**

- ▶ Electroplated Zinc
- ▶ Concrete-Tight
- ▶ Suitable for applications above 600V

**NOTE**

- ▶ Sizes 2-1/2" to 4" are also listed for RIGID and IMC Conduits
- ▶ Compression Cap color may vary



Cat. No. Compression	Cat. No. Rain-Tight	Trade Size	Std. Pkg.	Master Ctn.
OF7601	OF7601-W	1/2"	25	250
OF7602	OF7602-W	3/4"	25	250
OF7603	OF7603-W	1"	10	100
OF7604	OF7604-W	1-1/4"	10	100
OF7605	OF7605-W	1-1/2"	10	50
OF7606	OF7606-W	2"	5	50
OF7607	OF7607-W	2-1/2"	-	12
OF7608	OF7608-W	3"	-	12
OF7609	OF7609-W	3-1/2"	-	6
OF7610	OF7610-W	4"	-	6

*Compression Type*

*Rain-Tight*
**STEEL INSULATED EMT  
CONNECTORS  
COMPRESSION TYPE  
& RAIN-TIGHT**
**PRODUCT FEATURES**

- ▶ Electroplated Zinc
- ▶ With Insulated Throat
- ▶ Concrete-Tight
- ▶ Suitable for applications above 600V

**NOTE**

- ▶ Sizes 2-1/2" to 4" are also listed for RIGID and IMC Conduits
- ▶ Insulated and Compression Cap color may vary



Cat. No. Compression	Cat. No. Rain-Tight	Trade Size	Std. Pkg.	Master Ctn.
OF7601-S	OF7601-SW	1/2"	25	250
OF7602-S	OF7602-SW	3/4"	25	250
OF7603-S	OF7603-SW	1"	10	100
OF7604-S	OF7604-SW	1-1/4"	10	100
OF7605-S	OF7605-SW	1-1/2"	10	50
OF7606-S	OF7606-SW	2"	5	50
OF7607-S	OF7607-SW	2-1/2"	-	12
OF7608-S	OF7608-SW	3"	-	12
OF7609-S	OF7609-SW	3-1/2"	-	6
OF7610-S	OF7610-SW	4"	-	6

*Compression Type*

*Rain-Tight*
**STEEL EMT COUPLINGS  
COMPRESSION TYPE  
& RAIN-TIGHT**
**PRODUCT FEATURES**

- ▶ Electroplated Zinc
- ▶ Concrete-Tight
- ▶ Suitable for applications above 600V

**NOTE**

- ▶ Sizes 2-1/2" to 4" are also listed for RIGID and IMC Conduits
- ▶ Compression Cap color may vary



Cat. No. Compression	Cat. No. Rain-Tight	Trade Size	Std. Pkg.	Master Ctn.
OF7611	OF7611-W	1/2"	25	250
OF7612	OF7612-W	3/4"	25	250
OF7613	OF7613-W	1"	10	100
OF7614	OF7614-W	1-1/4"	10	100
OF7615	OF7615-W	1-1/2"	10	50
OF7616	OF7616-W	2"	5	50
OF7617	OF7617-W	2-1/2"	-	12
OF7618	OF7618-W	3"	-	12
OF7619	OF7619-W	3-1/2"	-	6
OF7620	OF7620-W	4"	-	6

*Compression Type*

*Rain-Tight*



## ZINC DIE CAST EMT CONNECTORS SET-SCREW TYPE

### PRODUCT FEATURES

- ▶ Concrete-Tight when taped
- ▶ Combo Head Set-Screw
- ▶ Suitable for applications above 600V

### NOTE

- ▶ Sizes 2-1/2" to 4" are also listed for RIGID and IMC Conduits

Cat. No.	Trade Size	Std. Pkg.	Master Ctn.
OF701	1/2"	100	1000
OF702	3/4"	50	500
OF703	1"	10	100
OF704	1-1/4"	10	100
OF705	1-1/2"	10	50
OF706	2"	5	50
OF707	2-1/2"	-	12
OF708	3"	-	12
OF709	3-1/2"	-	6
OF710	4"	-	6



1/2" to 1"



1-1/4" to 2"



2-1/2" to 4"

## ZINC DIE CAST INSULATED EMT CONNECTORS SET-SCREW TYPE

### PRODUCT FEATURES

- ▶ With Insulated Throat
- ▶ Concrete-Tight when taped
- ▶ Combo Head Set-Screw
- ▶ Suitable for applications above 600V

### NOTE

- ▶ Sizes 2-1/2" to 4" are also listed for RIGID and IMC Conduits
- ▶ Insulated color may vary

Cat. No.	Trade Size	Std. Pkg.	Master Ctn.
OF701-S	1/2"	50	500
OF702-S	3/4"	25	250
OF703-S	1"	10	100
OF704-S	1-1/4"	10	100
OF705-S	1-1/2"	10	50
OF706-S	2"	5	50
OF707-S	2-1/2"	-	12
OF708-S	3"	-	12
OF709-S	3-1/2"	-	6
OF710-S	4"	-	6



1/2" to 1"



1-1/4" to 2"



2-1/2" to 4"

## ZINC DIE CAST EMT COUPLINGS SET-SCREW TYPE

### PRODUCT FEATURES

- ▶ Concrete-Tight when taped
- ▶ Combo Head Set-Screw
- ▶ Suitable for applications above 600V

### NOTE

- ▶ Sizes 2-1/2" to 4" are also listed for RIGID and IMC Conduits

Cat. No.	Trade Size	Std. Pkg.	Master Ctn.
OF711	1/2"	50	500
OF712	3/4"	25	250
OF713	1"	10	100
OF714	1-1/4"	10	100
OF715	1-1/2"	10	50
OF716	2"	5	50
OF717	2-1/2"	-	12
OF718	3"	-	12
OF719	3-1/2"	-	6
OF720	4"	-	6



1/2" to 1"



1-1/4" to 2"



2-1/2" to 4"



## ZINC DIE CAST EMT CONNECTORS COMPRESSION TYPE & RAIN-TIGHT

### PRODUCT FEATURES

- ▶ Concrete-Tight
- ▶ Suitable for applications above 600V

### NOTE

- ▶ Sizes 2-1/2" to 4" are also listed for RIGID and IMC Conduits
- ▶ Compression Cap color may vary



Cat. No. Compression	Cat. No. Rain-Tight	Trade Size	Std. Pkg.	Master Ctn.
OF601	OF601-W	1/2"	50	500
OF602	OF602-W	3/4"	25	250
OF603	OF603-W	1"	10	100
OF604	OF604-W	1-1/4"	10	100
OF605	OF605-W	1-1/2"	10	50
OF606	OF606-W	2"	5	50
OF607	OF607-W	2-1/2"	-	12
OF608	OF608-W	3"	-	12
OF609	OF609-W	3-1/2"	-	6
OF610	OF610-W	4"	-	6



Compression Type



Rain-Tight

## ZINC DIE CAST INSULATED EMT CONNECTORS COMPRESSION TYPE & RAIN-TIGHT

### PRODUCT FEATURES

- ▶ With Insulated Throat
- ▶ Concrete-Tight
- ▶ Suitable for applications above 600V

### NOTE

- ▶ Sizes 2-1/2" to 4" are also listed for RIGID and IMC Conduits
- ▶ Insulated and Compression Cap color may vary



Cat. No. Compression	Cat. No. Rain-Tight	Trade Size	Std. Pkg.	Master Ctn.
OF601-S	OF601-SW	1/2"	50	500
OF602-S	OF602-SW	3/4"	25	250
OF603-S	OF603-SW	1"	10	100
OF604-S	OF604-SW	1-1/4"	10	100
OF605-S	OF605-SW	1-1/2"	10	50
OF606-S	OF606-SW	2"	5	50
OF607-S	OF607-SW	2-1/2"	-	12
OF608-S	OF608-SW	3"	-	12
OF609-S	OF609-SW	3-1/2"	-	6
OF610-S	OF610-SW	4"	-	6



Compression Type



Rain-Tight

## ZINC DIE CAST EMT COUPLINGS COMPRESSION TYPE & RAIN-TIGHT

### PRODUCT FEATURES

- ▶ Concrete-Tight
- ▶ Suitable for applications above 600V

### NOTE

- ▶ Sizes 2-1/2" to 4" are also listed for RIGID and IMC Conduits
- ▶ Compression Cap color may vary



Cat. No. Compression	Cat. No. Rain-Tight	Trade Size	Std. Pkg.	Master Ctn.
OF611	OF611-W	1/2"	50	500
OF612	OF612-W	3/4"	25	250
OF613	OF613-W	1"	10	100
OF614	OF614-W	1-1/4"	10	100
OF615	OF615-W	1-1/2"	10	50
OF616	OF616-W	2"	5	50
OF617	OF617-W	2-1/2"	-	12
OF618	OF618-W	3"	-	12
OF619	OF619-W	3-1/2"	-	6
OF620	OF620-W	4"	-	6



Compression Type



Rain-Tight

## ZINC DIE CAST EMT OFFSET CONNECTORS SET-SCREW TYPE

### PRODUCT FEATURES

- ▶ Concrete-Tight when taped
- ▶ Combo Head Set-Screw
- ▶ Suitable for applications above 600V



Cat. No.	Trade Size	Std. Pkg.	Master Ctn.
OCS-50	1/2"	100	1000
OCS-75	3/4"	50	500

## ZINC DIE CAST EMT OFFSET CONNECTORS COMPRESSION TYPE

### PRODUCT FEATURES

- ▶ Concrete-Tight
- ▶ Suitable for applications above 600V



Cat. No.	Trade Size	Std. Pkg.	Master Ctn.
OCC-50	1/2"	100	1000
OCC-75	3/4"	50	500

## ZINC DIE CAST EMT 90° ANGLE CONNECTOR COMPRESSION TYPE

### PRODUCT FEATURES

- ▶ Concrete-Tight



Cat. No.	Trade Size	Std. Pkg.	Master Ctn.
CC90-50	1/2"	25	100

## ZINC DIE CAST EMT INSIDE CORNER SET-SCREW TYPE

### PRODUCT FEATURES

- ▶ Combo Head Set-Screw
- ▶ Suitable for applications above 600V



Cat. No.	Trade Size	Std. Pkg.	Master Ctn.
ECS-50	1/2"	100	1000
ECS-75	3/4"	50	500

## ZINC DIE CAST EMT TO FLEX COUPLINGS COMPRESSION/SCREW-IN TYPE



Cat. No.	Trade Size	Std. Pkg.	Master Ctn.
OF1611	1/2"	50	500
OF1612	3/4"	25	250
OF1613	1"	10	100



## STEEL RIGID TO EMT COMBINATION COUPLINGS SET-SCREW TYPE

### PRODUCT FEATURES

- ▶ Zinc Electroplated
- ▶ Concrete-Tight when taped

Cat. No.	Rigid Size	EMT Size	Std. Pkg.	Master Ctn.
SRECS-50	1/2"	1/2"	25	250
SRECS-75	3/4"	3/4"	10	100
SRECS-100	1"	1"	10	100



SRECS-50



SRECS-100

## STEEL EMT TO LIQUID TIGHT COMBINATION COUPLINGS COMPRESSION TYPE

### PRODUCT FEATURES

- ▶ Zinc Electroplated
- ▶ Concrete-Tight
- ▶ Rain-Tight

Cat. No.	EMT Size	LT Size	Std. Pkg.	Master Ctn.
SELTC-50	1/2"	1/2"	25	250
SELTC-75	3/4"	3/4"	10	100
SELTC-100	1"	1"	10	100



SELTC-75



SELTC-100

## ZINC DIE CAST EMT "FASTLOCK" CONNECTORS (NO LOCKNUT)

### PRODUCT FEATURES

- ▶ Combo Head Set-Screw
- ▶ Suitable for dry location only

Cat. No.	Trade Size	Std. Pkg.	Master Ctn.
OF1701	1/2"	50	500
OF1702	3/4"	50	500







## ZINC DIE CAST FLEX CONNECTORS SCREW-IN TYPE



Cat. No.	Trade Size	Std. Pkg.	Master Ctn.
OF671	3/8"	100	1000
OF672	1/2"	100	1000
OF673	3/4"	100	500
OF674	1"	25	250
OF675	1-1/4"	10	100
OF681	1-1/2"	5	50
OF682	2"	3	30

## ZINC DIE CAST INSULATED FLEX CONNECTORS SCREW-IN TYPE



### PRODUCT FEATURES

- With Insulated Throat

### NOTE

- Insulated color may vary

Cat. No.	Trade Size	Std. Pkg.	Master Ctn.
OF671-S	3/8"	100	1000
OF672-S	1/2"	100	1000
OF673-S	3/4"	100	500
OF674-S	1"	25	250
OF675-S	1-1/4"	10	100
OF681-S	1-1/2"	5	50
OF682-S	2"	3	30

## ZINC DIE CAST FLEX COUPLINGS SCREW-IN TYPE



Cat. No.	Trade Size	Std. Pkg.	Master Ctn.
OF676	1/2"	100	1000
OF677	3/4"	100	500
OF678	1"	25	250
OF679	1-1/4"	10	100
OF685	1-1/2"	5	50
OF686	2"	3	30

## STEEL FLEX BUSHINGS

### PRODUCT FEATURES

- Electroplated Zinc
- Used to insulate Cut Flex when the conduit is used for data cables without a junction box



Shown Installed

Cat. No.	Trade Size	Std. Pkg.	Master Ctn.
FB-50	1/2"	100	1000
FB-75	3/4"	100	500
FB-100	1"	25	250



## ZINC DIE CAST FLEX CONNECTORS SQUEEZE TYPE

### NOTE

- Sizes 3/8" & 1/2" are also for AC (BX)

Cat. No.	Trade Size	Std. Pkg.	Master Ctn.
OF730	3/8"	50	500
OF731	1/2"	25	250
OF732	3/4"	25	250
OF733	1"	10	100
OF734	1-1/4"	10	100
OF735	1-1/2"	5	50
OF736	2"	4	40
OF737	2-1/2"	2	6
OF738	3"	1	2
OF739	3-1/2"	1	2
OF740	4"	1	2



3/8" to 2"



2-1/2" to 4"

## ZINC DIE CAST INSULATED FLEX CONNECTORS SQUEEZE TYPE

### PRODUCT FEATURES

- With Insulated Throat

### NOTE

- Sizes 3/8" & 1/2" are also for AC(BX)
- Insulated color may vary

Cat. No. Compression	Trade Size	Std. Pkg.	Master Ctn.
OF730-S	3/8"	50	500
OF731-S	1/2"	25	250
OF732-S	3/4"	25	250
OF733-S	1"	10	100
OF734-S	1-1/4"	10	100
OF735-S	1-1/2"	5	50
OF736-S	2"	4	40
OF737-S	2-1/2"	2	6
OF738-S	3"	1	2
OF739-S	3-1/2"	1	2
OF740-S	4"	1	2



3/8" to 2"



2-1/2" to 4"

## ZINC DIE CAST FLEX CONNECTORS SET-SCREW TYPE

### PRODUCT FEATURES

- Steel screw
- For Steel FLEX only

Cat. No.	Trade Size	Std. Pkg.	Master Ctn.
OF654	1/2"	100	500
OF655	3/4"	75	375





## ZINC DIE CAST FLEX CONNECTOR CLAMP TYPE

### PRODUCT FEATURES

- ▶ Combo Head Set-Screw



Cat. No.	Trade Size	Std. Pkg.	Master Ctn.
OF657	1/2"	25	50

## ZINC DIE CAST 90° ANGLE AC (BX) MC/FLEX CONNECTORS SQUEEZE TYPE



Cat. No.	Trade Size	Std. Pkg.	Master Ctn.
OF643	3/8"	25	250
OF644	1/2"	25	250
OF645	3/4"	25	250

## ZINC DIE CAST 90° ANGLE FLEX CONNECTORS SQUEEZE TYPE



1" to 2"



2-1/2" to 4"

Cat. No.	Trade Size	Std. Pkg.	Master Ctn.
OF6463	1"	5	25
OF6464	1-1/4"	-	5
OF6465	1-1/2"	-	5
OF6466	2"	-	5
OF6467	2-1/2"	-	5
OF6468	3"	-	5
OF6469	3-1/2"	-	1
OF6470	4"	-	1

## ZINC DIE CAST 90° ANGLE FLEX CONNECTORS SCREW-IN TYPE

### PRODUCT FEATURES

- ▶ Sliding cover for easy wire pulls



Cat. No.	Trade Size	Std. Pkg.	Master Ctn.
OF9673	3/4"	15	150
OF9674	1"	10	100

## ZINC DIE CAST EMT TO FLEX COUPLINGS COMPRESSION/SCREW-IN TYPE



Cat. No.	Trade Size	Std. Pkg.	Master Ctn.
OF1611	1/2"	50	500
OF1612	3/4"	25	250
OF1613	1"	10	100



**ZINC DIE CAST**  
**EMT TO FLEX COUPLINGS**  
**SET-SCREW/SQUEEZE TYPE**



Cat. No.	Trade Size	Std. Pkg.	Master Ctn.
OF530	1/2" to 3/8"	50	500
OF531	1/2" to 1/2"	25	250
OF532	3/4" to 3/4"	25	100
OF533	1" to 1"	10	40

**ZINC DIE CAST**  
**EMT TO FLEX COUPLINGS**  
**SET-SCREW/CLAMP TYPE**



Cat. No.	Trade Size	Std. Pkg.	Master Ctn.
OF520	1/2" to 3/8"	50	500
OF521	1/2" to 1/2"	25	250
OF522	3/4" to 3/4"	25	250
OF523	1" to 1"	10	40

**ZINC DIE CAST**  
**RIGID TO FLEX COUPLING**  
**CLAMP TYPE**

**PRODUCT FEATURES**

- For Steel FLEX Only



Cat. No.	Trade Size	Std. Pkg.	Master Ctn.
OF697	1/2"	25	250

**ZINC DIE CAST**  
**RIGID TO FLEX COUPLINGS**  
**SET-SCREW TYPE**

**PRODUCT FEATURES**

- For Steel FLEX Only



Cat. No.	Trade Size	Std. Pkg.	Master Ctn.
OF694	1/2"	25	250
OF695	3/4"	25	250



## PVC NON-METALLIC (NM) CABLE CONNECTORS

### PRODUCT FEATURES

- ▶ Heavey-Duty PVC

Cat. No.	For Use With	Trade Size	Std. Pkg.	Master Ctn.
NM-50	One or Two 14/2, 14/3, 12/2 One 12/3, 10/2, 10/3 One or Two 0.300" or 0.600" cords	1/2"	50	500
NM-75	One 8/3, 6/2, 6/3 Two 14/3, 12/2, 12/3, 10/2 Single or Multiple flexible cord in wire range 0.500" to 0.850"	3/4"	50	500



## NON-METALLIC CABLE CONNECTOR PUSH-IN TYPE

### PRODUCT FEATURES

- ▶ Flame-Retardant Polypropylene
- ▶ Special gripping arrangement for easy cable insertion

Cat. No.	For Use With	Trade Size	Std. Pkg.	Master Ctn.
NMP-50	One 10, 12, 14 AWG two-conductor cables with or without ground wire	1/2"	100	300



## ZINC DIE CAST NON-METALLIC CABLE CONNECTORS

### NOTE

- ▶ Sizes 1" to 2" are also suitable for service entrance

Cat. No.	For Use With	Trade Size	Std. Pkg.	Master Ctn.
RX-50	(1) 14/2 to 10/2 NM, (2) 14/2 or (2) 12/2 NM, 0.340" to 0.380" Dia. Flex Cord (Dry Location) 14/3, 16/2, and 16/3 SJO	1/2"	100	1000
RX-75	(2) 14-2 NM, AWG, 0.340" to 0.515" Dia. Flex Cord (Dry Location) 14/3, 14/2 SJO	3/4"	25	250
<b>For Service Entrance</b>				
RX-100	(4) 14/2, (1) 8/3, 8/2, 6/2, 6/3, 4/2, 4/3 NM (1) 2 SE Cable	1"	10	100
RX-125	4/3 or 2/3 NM	1-1/4"	5	50
RX-150	3-2/0 or 3-4/0 NM	1-1/2"	5	50
RX-200	3-2/0 or 3-4/0 NM	2"	5	50





### ZINC DIE CAST METAL CLAD (MC) CONNECTORS SADDLE-TYPE

#### PRODUCT FEATURES

- ▶ Combo Head Set-Screw
- ▶ With Insulated Throat
- ▶ Suitable for Dry Location Only

#### NOTE

- ▶ Insulated color may vary

Cat. No.	Description	Trade Size	Std. Pkg.	Master Ctn.
OF6231	Steel AC: 14/2 (0.457") - 12/4 (0.539") Aluminum AC: 14/2 (0.464") - 10/4 (0.622") Steel MCI-A: 14/2 (0.453") - 10/4 (0.614") Aluminum MCI-A: 14/2 (0.433") - 10/3 (0.630") NM Cable: 12/3, 14/2 & 8/2 with ground. 12/2 without ground Steel/AL FMC/RWFMC: 3/8"	1/2"	100	500
OF6232	Interlocking Steel 0.661 to 0.711 Dia. Interlocking AL 0.775 to 0.825 Dia. AC, AL, & Steel 0.650 to 0.810 Dia. & Flex, 1/2" Steel	3/4"	50	250



Cat. No.	Description	Trade Size	Std. Pkg.	Master Ctn.
OF653	Steel AC: 14/2 (0.453") - 10/4 (0.622") Aluminum AC: 14/2 (0.464") - 14/4 (0.535") Steel MCI-A: 14/2 (0.453") - 10/2 (0.581") Aluminum MCI-A: 14/2 (0.437") - 10/2 (0.535") Steel/AL FMC/RWFMC: 3/8"	1/2"	100	500



### ZINC DIE CAST METAL CLAD (MC) & AC (BX) CONNECTOR

#### PRODUCT FEATURES

- ▶ For AC, MCI-A, NM Cable, FMC/RWFMC

Cat. No.	Description	Trade Size	Std. Pkg.	Master Ctn.
OF6620	Steel AC: 14/2 (0.457") - 12/4 (0.539") Aluminum AC: 14/2 (0.464") - 14/4 (0.534") Steel MCI-A: 14/2 (0.453") - 10/2 (0.531") Aluminum MCI-A: 14/2 (0.433") - 14/4 (0.539") NM Cable: 12/3, 14/2 with ground & 12/2 without ground Steel/AL FMC/RWFMC: 3/8"	1/2"	100	500



### ZINC DIE CAST METAL CLAD (MC) CONNECTORS CLAMP TYPE

#### PRODUCT FEATURES

- ▶ With Insulated Throat
- ▶ Suitable for Dry Location Only

#### NOTE

- ▶ Insulated color may vary

Cat. No.	Cable Size Dia.	Trade Size	Std. Pkg.	Master Ctn.
MC-CL-100	0.83" - 1.04"	1"	10	100
MC-CL-150	1.36" - 1.60"	1-1/2"	10	100
MC-CL-250	1.99" - 2.34"	2-1/2"	-	10
MC-CL-300	2.30" - 2.68"	3"	-	5
MC-CL-350	2.85" - 3.42"	3-1/2"	-	5





## ZINC DIE CAST COMBINATION AC (BX) & NON-METALLIC (NM) CONNECTOR

## ZINC DIE CAST DUPLEX AC (BX) FLEX/MC CONNECTOR

### PRODUCT FEATURES

- For AC, MCI-A, NM Cable, FMC/RWFC

## ZINC DIE CAST 90° ANGLE AC (BX) MC/FLEX CONNECTORS SQUEEZE TYPE

## ZINC DIE CAST INSULATED DOUBLE-SNAP CABLE CONNECTOR

### PRODUCT FEATURES

- 105°C rated throat insulator
- Fast and Tool-free installation
- Removable and Reusable
- For AC, MCI, MCI-A, HCF, RWFC
- Dry location

## ZINC DIE CAST INSULATED CUT-IN DOUBLE-SNAP CABLE CONNECTOR

### PRODUCT FEATURES

- 105°C rated throat insulator
- Fast and Tool-free installation
- Removable and Reusable
- For FMC, AC, MCI, MCI-A, HCF
- Dry location

Cat. No.	Description	Trade Size	Std. Pkg.	Master Ctn.
OF623	14/2 AC(BX), 14/2 NM, 0.340 to 0.380 dia cord 14/3 & 16/3 SJO, 16/2 SO	1/2"	25	250



Cat. No.	Description	Trade Size	Std. Pkg.	Master Ctn.
MC-DX-50	Steel AC: 14/2 (0.457") - 12/4 (0.539") Aluminum AC: 14/2 (0.464") - 10/4 (0.622") Steel MCI-A: 14/2 (0.453") - 10/4 (0.614") Aluminum MCI-A: 14/2 (0.433") - 10/3 (0.630") NM Cable: 12/3, 14/2 with ground & 12/2 without ground Steel/AL FMC/RWFC: 3/8"	1/2"	25	250



Cat. No.	Trade Size	Std. Pkg.	Master Ctn.
OF643	3/8"	25	250
OF644	1/2"	25	250
OF645	3/4"	25	250



Cat. No.	Description	Trade Size	KO Size	Std. Pkg.	Master Ctn.
DSC-38	DOUBLE-SNAP CABLE CONNECTOR WITH INSULATOR Steel/AL AC: 14/2 (0.40") - 10/3 (0.618") Steel MCI: 0.395" - 0.638" AL MCI: 0.40" - 0.618" Steel/AL MCI-A: 14/2 (0.395") - 10/3 (0.638") Steel/AL HCF MCI-A: 14/2 (0.395") - 10/3 (0.638") AL RWFC: 3/8"	3/8"	1/2"	50	500



Cat. No.	Description	Trade Size	KO Size	Std. Pkg.	Master Ctn.
DSC-38C	CUT-IN DOUBLE-SNAP CABLE CONNECTOR WITH INSULATOR, FOR OLD WORK Steel/AL AC: 14/2 (0.40") - 10/3 (0.618") Steel/AL MCI: 14/2 (0.395") - 10/3 (0.638") Steel/AL MCI-A: 14/2 (0.395") - 10/3 (0.638") Steel/AL HCF MCI-A: 14/2 (0.395") - 10/3 (0.638") Steel/AL FMC: 3/8"	3/8"	1/2"	50	500



**STEEL**  
**"FASTLOCK" CONNECTOR**
**PRODUCT FEATURES**

- ▶ Electroplated Zinc
- ▶ Saddle-Base Connector
- ▶ Combo Head Set-Screw
- ▶ For AC, MCI, HCF AC, MCI-A, HCF MCI-A, FMC/RWFMC

**NOTE**

- ▶ Insulated color may vary

Cat. No.	Description	K.O. Size	Std. Pkg.	Master Ctn.
<b>FLC-50</b>	Steel AC 14/2 (0.475") - 10/3 (0.565") AL AC 14/2 (0.464") - 10/3 (0.610") Steel MCI: 14/2 (0.455") - 10/3 (0.565") AL MCI: 14/2 (0.455") - 10/3 (0.600") Steel HCF AC: 14/2 (0.475") - 10/3 (0.565") AL HCF AC: 14/2 (0.464") - 10/3 (0.610") AL MCI-A: 14/2 (0.385") - 10/3 (0.510") HCF MCI-A: 14/2 (0.385") - 10/3 (0.510") Steel/AL FMC/RWFMC: 3/8"	1/2"	50	500

**STEEL "FASTLOCK"**  
**WIDE-THROAT CONNECTORS**
**PRODUCT FEATURES**

- ▶ Electroplated Zinc
- ▶ Saddle-Base Connector
- ▶ Combo Head Set-Screw
- ▶ For AC, MCI, HCF AC, MCI-A, HCF MCI-A, FMC/RWFMC

**NOTE**

- ▶ Insulated color may vary

Cat. No.	Description	K.O. Size	Std. Pkg.	Master Ctn.
<b>FLC-50L</b>	Steel AC 10/4 (0.605") - 6/3 (0.853") AL AC 10/3 (0.610") - 6/3 (0.823") Steel MCI: 10/3 (0.580") - 8/3 (0.690") AL MCI: 10/3 (0.520") - 8/3 (0.690") Steel HCF AC: 10/4 (0.605") - 6/3 (0.853") AL HCF AC: 10/3 (0.610") - 6/3 (0.823") AL MCI-A: 8/3 (0.675") HCF MCI-A: 8/3 (0.675") Steel/AL FMC/RWFMC: 1/2"	1/2"	50	500

<b>FLC-75L</b>	Steel AC 10/3 (0.545") - 6/3 (0.850") AL AC 10/3 (0.600") - 6/3 (0.835") Steel MCI: 10/3 (0.550") - 6/3 (0.850") AL MCI: 10/3 (0.580") - 6/3 (0.850") Steel HCF AC: 10/3 (0.545") - 6/3 (0.850") AL HCF AC: 10/3 (0.600") - 6/3 (0.835") AL MCI-A: 8/3 (0.675") - 6/3 (0.785") HCF MCI-A: 8/3 (0.675") - 6/3 (0.785") Steel/AL FMC/RWFMC: 1/2"	3/4"	25	250
----------------	--	------	----	-----

**STEEL "FASTLOCK"**  
**DUPLEX CONNECTOR**
**PRODUCT FEATURES**

- ▶ Electroplated Zinc
- ▶ Combo Head Set-Screw
- ▶ For AC, MCI, HCF AC, MCI-A, HCF MCI-A, FMC/RWFMC

**NOTE**

- ▶ Insulated color may vary

Cat. No.	Description	K.O. Size	Std. Pkg.	Master Ctn.
<b>FLD-50</b>	Steel AC 14/2 (0.475") - 10/3 (0.565") AL AC 14/2 (0.464") - 12/4 (0.600") Steel MCI: 14/2 (0.455") - 12/4 (0.545") AL MCI: 14/2 (0.455") - 12/4 (0.550") Steel HCF AC: 14/2 (0.475") - 10/3 (0.565") AL HCF AC: 14/2 (0.464") - 12/4 (0.600") AL MCI-A: 14/2 (0.385") - 10/3 (0.520") HCF MCI-A: 14/2 (0.385") - 10/3 (0.520") Steel/AL FMC/RWFMC: 3/8"	1/2"	25	250

**ANTI-SHORT BUSHINGS**  
**THERMOPLASTIC**
**PRODUCT FEATURES**

- ▶ High-Temperature Plastic
- ▶ Fits BX (AC) and Flex Conduits

Cat. No.	For Use With	Trade Size	Std. Pkg.	Master Ctn.
<b>ASB-516</b>	14/2, 14/3, 12/2	5/16"	35	3500
<b>ASB-38</b>	14/4, 12/3, 6/1, 4/1	3/8"	35	2100
<b>ASB-716</b>	12/4, 10/2, 10/3, 2/1	7/16"	35	700
<b>ASB-50</b>	10/4, 8/2, 8/3, 1/1	1/2"	20	400
<b>ASB-75</b>	8/4, 6/2, 4/2, 4/3, 6/4	3/4"	16	320





## ZINC DIE CAST STRAIN RELIEF CORD-GRIP CONNECTORS

### PRODUCT FEATURES

- ▶ Watertight

Cat. No.	Trade Size	Clamping Range	Std. Pkg.	Master Ctn.
CG-50-190/260	1/2"	0.190" - 0.260"	25	100
CG-50-260/375	1/2"	0.260" - 0.375"	25	100
CG-50-375/500	1/2"	0.375" - 0.500"	25	100
CG-75-375/500	3/4"	0.375" - 0.500"	10	50
CG-75-500/625	3/4"	0.500" - 0.625"	10	50
CG-75-625/750	3/4"	0.625" - 0.750"	10	50
CG-100-375/500	1"	0.375" - 0.500"	10	50
CG-100-500/625	1"	0.500" - 0.625"	10	50
CG-100-625/750	1"	0.625" - 0.750"	10	50
CG-100-750/880	1"	0.750" - 0.880"	10	50
CG-100-880/985	1"	0.880" - 0.985"	10	50



## STEEL STRAIN RELIEF CORD-GRIP CONNECTORS

### PRODUCT FEATURES

- ▶ Zinc Electroplated
- ▶ Watertight
- ▶ Connect S, SO, ST, SJ, SJO, SJT Cord to metal box or enclosure
- ▶ Color-coded bushings identify different cord ranges

Cat. No.	Trade Size	Color	Clamping Range	Std. Pkg.	Master Ctn.
SCG-50-125/250	1/2"	Red	0.125" - 0.250"	25	100
SCG-50-250/350	1/2"	White	0.250" - 0.350"	20	100
SCG-50-350/450	1/2"	Blue	0.350" - 0.450"	20	100
SCG-50-450/560	1/2"	Green	0.450" - 0.560"	20	100
SCG-50-560/650	1/2"	Beige	0.560" - 0.650"	20	100
SCG-75-125/250	3/4"	Red	0.125" - 0.250"	10	50
SCG-75-250/350	3/4"	White	0.250" - 0.350"	10	50
SCG-75-350/450	3/4"	Blue	0.350" - 0.450"	10	50
SCG-75-450/560	3/4"	Green	0.450" - 0.560"	10	50
SCG-75-560/650	3/4"	Beige	0.560" - 0.650"	10	50
SCG-75-650/750	3/4"	Yellow	0.650" - 0.750"	10	50
SCG-75-750/850	3/4"	Purple	0.750" - 0.850"	10	50
SCG-100-450/560	1"	Green	0.450" - 0.560"	5	25
SCG-100-560/650	1"	Beige	0.560" - 0.650"	5	25
SCG-100-650/750	1"	Yellow	0.650" - 0.750"	5	25
SCG-100-750/850	1"	Purple	0.750" - 0.850"	5	25
SCG-100-850/950	1"	Gray	0.850" - 0.950"	5	25
SCG-100-950/1050	1"	Black	0.950" - 1.050"	5	25



## NYLON STRAIN RELIEF CORD-GRIP CONNECTORS

### PRODUCT FEATURES

- ▶ Watertight

### NOTE

- ▶ Lock Nut not included



Cat. No.	Trade Size	Clamping Range	Std. Pkg.	Master Ctn.
NGC-38-197/394	3/8"	0.197" - 0.394"	25	100
NGC-50-384/551	1/2"	0.394" - 0.551"	25	100
NGC-75-551/709	3/4"	0.551" - 0.709"	10	50
NGC100-709/984	1"	0.709" - 0.984"	10	50



## ZINC DIE CAST WATERTIGHT SERVICE ENTRANCE CABLE CONNECTORS

### PRODUCT FEATURES

- ▶ Watertight

Cat. No.	Trade Size	Wire Size	Grommet Opening	Std. Pkg.	Master Ctn.
WECC-100-8	1"	#8	0.40" - 0.68"	10	100
WECC-100-6	1"	#6	0.44" - 0.70"	10	100
WECC-100-4	1"	#4	0.52" - 0.84"	10	100
WECC-125-3	1-1/4"	#3	0.56" - 0.92"	10	50
WECC-125-2	1-1/4"	#2	0.60" - 1.00"	10	50
WECC-125-1	1-1/4"	#1	0.65" - 1.09"	10	50
WECC-150-10	1-1/2"	#1/0	0.72" - 1.24"	5	50
WECC-150-20	1-1/2"	#2/0	0.86" - 1.34"	5	50
WECC-150-30	1-1/2"	#3/0	0.87" - 1.37"	5	50
WECC-200-10	2"	#1/0	0.72" - 1.24"	5	25
WECC-200-20	2"	#2/0	0.86" - 1.34"	5	25
WECC-200-30	2"	#3/0	0.87" - 1.34"	5	25
WECC-200-40	2"	#4/0	0.90" - 1.50"	5	25
WECC-200-40N	2"	#4/0	1.11" - 1.73"	5	25



## STEEL LIQUID TIGHT SEALING RINGS

### PRODUCT FEATURES

- ▶ Neoprene Rubber Gasket
- ▶ Steel Retainer
- ▶ Form Liquid tight seal between connector and box

Cat. No.	Trade Size	Std. Pkg.	Master Ctn.
LTSR-50	1/2"	250	2500
LTSR-75	3/4"	200	2000
LTSR-100	1"	150	1500
LTSR-125	1-1/4"	100	1000
LTSR-150	1-1/2"	50	500
LTSR-200	2"	50	500
LTSR-250	2-1/2"	-	100
LTSR-300	3"	-	100
LTSR-350	3-1/2"	-	50
LTSR-400	4"	-	50



## NON-METALLIC (PVC) STRAIGHT LIQUID TIGHT CONNECTORS

### PRODUCT FEATURES

- ▶ PVC Type-B
- ▶ Corrosion-Resistant
- ▶ Zinc Locknut



Cat. No.	Trade Size	Std. Pkg.	Master Ctn.
NMLT-38	3/8"	25	100
NMLT-50	1/2"	25	250
NMLT-75	3/4"	15	150
NMLT-100	1"	8	80
NMLT-125	1-1/4"	5	50
NMLT-150	1-1/2"	4	40
NMLT-200	2"	1	36



## NON-METALLIC (PVC) 90° ANGLE LIQUID TIGHT CONNECTORS

### PRODUCT FEATURES

- ▶ PVC Type-B
- ▶ Corrosion-Resistant
- ▶ Zinc Locknut



Cat. No.	Trade Size	Std. Pkg.	Master Ctn.
NMLT90-38	3/8"	10	100
NMLT90-50	1/2"	15	150
NMLT90-75	3/4"	10	100
NMLT90-100	1"	5	50
NMLT90-125	1-1/4"	4	40
NMLT90-150	1-1/2"	2	20
NMLT90-200	2"	1	10



## STEEL EMT TO LIQUID TIGHT COMBINATION COUPLINGS COMPRESSION TYPE

### PRODUCT FEATURES

- ▶ Zinc Electroplated
- ▶ Concrete-Tight
- ▶ Rain-Tight

Cat. No.	EMT Size	LT Size	Std. Pkg.	Master Ctn.
SELTC-50	1/2"	1/2"	25	250
SELTC-75	3/4"	3/4"	10	100
SELTC-100	1"	1"	10	100



SELTC-75

SELTC-100

## ZINC DIE CAST INSULATED STRAIGHT LIQUID TIGHT CONNECTORS

### NOTE

- ▶ Insulated color may vary



Cat. No.	Trade Size	Std. Pkg.	Master Ctn.
LT-38	3/8"	25	250
LT-50	1/2"	25	250
LT-75	3/4"	15	150
LT-100	1"	8	80
LT-125	1-1/4"	5	50
LT-150	1-1/2"	4	40
LT-200	2"	1	10
LT-250	2-1/2"	1	10
LT-300	3"	1	10
LT-350	3-1/2"	1	6
LT-400	4"	1	6

## ZINC DIE CAST INSULATED STRAIGHT LIQUID TIGHT CONNECTORS

### PRODUCT FEATURES

- ▶ With Insulated Throat

### NOTE

- ▶ Insulated color may vary



Cat. No.	Trade Size	Std. Pkg.	Master Ctn.
LTI-38	3/8"	25	250
LTI-50	1/2"	25	250
LTI-75	3/4"	15	150
LTI-100	1"	8	80
LTI-125	1-1/4"	5	50
LTI-150	1-1/2"	4	40
LTI-200	2"	1	36
LTI-250	2-1/2"	1	10
LTI-300	3"	1	10
LTI-350	3-1/2"	1	6
LTI-400	4"	1	6

## MALLEABLE IRON STRAIGHT LIQUID TIGHT CONNECTORS

### PRODUCT FEATURES

- ▶ Electroplated Zinc

### NOTE

- ▶ Insulated color may vary



Cat. No.	Trade Size	Std. Pkg.	Master Ctn.
MLT-38	3/8"	25	250
MLT-50	1/2"	25	250
MLT-75	3/4"	15	150
MLT-100	1"	8	80
MLT-125	1-1/4"	5	50
MLT-150	1-1/2"	4	40
MLT-200	2"	1	20
MLT-250	2-1/2"	-	1
MLT-300	3"	-	1
MLT-350	3-1/2"	-	1
MLT-400	4"	-	1

## MALLEABLE IRON INSULATED STRAIGHT LIQUID TIGHT CONNECTORS

### PRODUCT FEATURES

- ▶ Electroplated Zinc
- ▶ With Insulated Throat

### NOTE

- ▶ Insulated color may vary



Cat. No.	Trade Size	Std. Pkg.	Master Ctn.
MLTI-38	3/8"	25	250
MLTI-50	1/2"	25	250
MLTI-75	3/4"	15	150
MLTI-100	1"	8	80
MLTI-125	1-1/4"	5	50
MLTI-150	1-1/2"	4	40
MLTI-200	2"	1	20
MLTI-250	2-1/2"	-	1
MLTI-300	3"	-	1
MLTI-350	3-1/2"	-	1
MLTI-400	4"	-	1



## MALLEABLE IRON INSULATED STRAIGHT LIQUID TIGHT CONNECTORS WITH ALUMINUM LAY-IN LUG

### PRODUCT FEATURES

- ▶ Zinc electroplated
- ▶ 105°C rated insulated throat
- ▶ Sealing washer included
- ▶ Aluminum lay-in lug provides easy installation of a ground wire

### NOTE

- ▶ Insulated color may vary



Cat. No.	Trade Size	Lug Range	Std. Pkg.	Master Ctn.
MLTILL-38	3/8"	#14 - #4	25	250
MLTILL-50	1/2"	#14 - #4	25	250
MLTILL-75	3/4"	#14 - #4	10	100
MLTILL-100	1"	#14 - #4	5	50
MLTILL-125	1-1/4"	#14 - #4	5	50
MLTILL-150	1-1/2"	#14 - #4	4	40
MLTILL-200	2"	#14 - #4	2	20
MLTILL-250	2-1/2"	#14 - #1/0	1	10
MLTILL-300	3"	#14 - #1/0	1	10
MLTILL-350	3-1/2"	#6 - #250MCM	-	1
MLTILL-400	4"	#6 - #250MCM	-	1



MLTILL-75



MLTILL-125

## MALLEABLE IRON 45° ANGLE LIQUID TIGHT CONNECTORS

### PRODUCT FEATURES

- ▶ Electroplated Zinc

### NOTE

- ▶ Insulated color may vary



Cat. No.	Trade Size	Std. Pkg.	Master Ctn.
MLT45-38	3/8"	25	150
MLT45-50	1/2"	25	150
MLT45-75	3/4"	10	100
MLT45-100	1"	5	50
MLT45-125	1-1/4"	5	40
MLT45-150	1-1/2"	4	20
MLT45-200	2"	1	15
MLT45-250	2-1/2"	-	1
MLT45-300	3"	-	1
MLT45-350	3-1/2"	-	1
MLT45-400	4"	-	1



## MALLEABLE IRON INSULATED 45° ANGLE LIQUID TIGHT CONNECTORS

### PRODUCT FEATURES

- ▶ Electroplated Zinc
- ▶ With Insulated Throat

### NOTE

- ▶ Insulated color may vary



Cat. No.	Trade Size	Std. Pkg.	Master Ctn.
MLTI45-38	3/8"	25	150
MLTI45-50	1/2"	25	150
MLTI45-75	3/4"	10	100
MLTI45-100	1"	5	50
MLTI45-125	1-1/4"	5	40
MLTI45-150	1-1/2"	4	20
MLTI45-200	2"	1	15
MLTI45-250	2-1/2"	-	1
MLTI45-300	3"	-	1
MLTI45-350	3-1/2"	-	1
MLTI45-400	4"	-	1



## MALLEABLE IRON INSULATED 45° ANGLE LIQUID TIGHT CONNECTORS WITH ALUMINUM LAY-IN LUG

### PRODUCT FEATURES

- ▶ Zinc electroplated
- ▶ 105°C rated insulated throat
- ▶ Sealing washer included
- ▶ Aluminum lay-in lug provides easy installation of a ground wire

### NOTE

- ▶ Insulated color may vary



Cat. No.	Trade Size	Lug Range	Std. Pkg.	Master Ctn.
MLTI45LL-38	3/8"	#14 - #4	10	100
MLTI45LL-50	1/2"	#14 - #4	10	100
MLTI45LL-75	3/4"	#14 - #4	10	100
MLTI45LL-100	1"	#14 - #4	5	50
MLTI45LL-125	1-1/4"	#14 - #4	-	5
MLTI45LL-150	1-1/2"	#14 - #4	-	5
MLTI45LL-200	2"	#14 - #4	-	5
MLTI45LL-250	2-1/2"	#14 - #1/0	-	1
MLTI45LL-300	3"	#14 - #1/0	-	1
MLTI45LL-350	3-1/2"	#6 - #250MCM	-	1
MLTI45LL-400	4"	#6 - #250MCM	-	1



MLTI45LL-75



MLTI45LL-125

## ZINC DIE CAST 90° ANGLE LIQUID TIGHT CONNECTORS

### NOTE

- ▶ Insulated color may vary



Cat. No.	Trade Size	Std. Pkg.	Master Ctn.
LT90-38	3/8"	15	150
LT90-50	1/2"	15	150
LT90-75	3/4"	10	100
LT90-100	1"	5	50
LT90-125	1-1/4"	4	40
LT90-150	1-1/2"	2	20
LT90-200	2"	1	10
LT90-250	2-1/2"	1	10
LT90-300	3"	1	4
LT90-400	4"	1	3



## ZINC DIE CAST INSULATED 90° ANGLE LIQUID TIGHT CONNECTORS

### PRODUCT FEATURES

- ▶ With Insulated Throat

### NOTE

- ▶ Insulated color may vary



Cat. No.	Trade Size	Std. Pkg.	Master Ctn.
LTI90-38	3/8"	15	150
LTI90-50	1/2"	15	150
LTI90-75	3/4"	10	100
LTI90-100	1"	5	50
LTI90-125	1-1/4"	4	40
LTI90-150	1-1/2"	2	20
LTI90-200	2"	1	10
LTI90-250	2-1/2"	1	10
LTI90-300	3"	1	4
LTI90-350	3-1/2"	1	3
LTI90-400	4"	1	3



## MALLEABLE IRON 90° ANGLE LIQUID TIGHT CONNECTORS

### PRODUCT FEATURES

- ▶ Electroplated Zinc

### NOTE

- ▶ Insulated color may vary



Cat. No.	Trade Size	Std. Pkg.	Master Ctn.
MLT90-38	3/8"	25	150
MLT90-50	1/2"	25	150
MLT90-75	3/4"	10	100
MLT90-100	1"	5	50
MLT90-125	1-1/4"	5	40
MLT90-150	1-1/2"	4	20
MLT90-200	2"	1	15
MLT90-250	2-1/2"	-	1
MLT90-300	3"	-	1
MLT90-350	3-1/2"	-	1
MLT90-400	4"	-	1



## MALLEABLE IRON INSULATED 90° ANGLE LIQUID TIGHT CONNECTORS

### PRODUCT FEATURES

- ▶ Electroplated Zinc
- ▶ With Insulated Throat

### NOTE

- ▶ Insulated color may vary



Cat. No.	Trade Size	Std. Pkg.	Master Ctn.
MLTI90-38	3/8"	25	150
MLTI90-50	1/2"	25	150
MLTI90-75	3/4"	10	100
MLTI90-100	1"	5	50
MLTI90-125	1-1/4"	5	40
MLTI90-150	1-1/2"	4	20
MLTI90-200	2"	1	15
MLTI90-250	2-1/2"	-	1
MLTI90-300	3"	-	1
MLTI90-350	3-1/2"	-	1
MLTI90-400	4"	-	1



## MALLEABLE IRON INSULATED 90° ANGLE LIQUID TIGHT CONNECTORS WITH ALUMINUM LAY-IN LUG

### PRODUCT FEATURES

- ▶ Electroplated Zinc
- ▶ 105°C rated insulated throat
- ▶ Sealing washer included
- ▶ Aluminum lay-in lug provides easy installation of a ground wire

### NOTE

- ▶ Insulated color may vary



Cat. No.	Trade Size	Lug Range	Std. Pkg.	Master Ctn.
MLTI90LL-38	3/8"	#14 - #4	10	100
MLTI90LL-50	1/2"	#14 - #4	10	100
MLTI90LL-75	3/4"	#14 - #4	10	100
MLTI90LL-100	1"	#14 - #4	5	50
MLTI90LL-125	1-1/4"	#14 - #4	-	5
MLTI90LL-150	1-1/2"	#14 - #4	-	5
MLTI90LL-200	2"	#14 - #4	-	5
MLTI90LL-250	2-1/2"	#14 - #1/0	-	1
MLTI90LL-300	3"	#14 - #1/0	-	1
MLTI90LL-350	3-1/2"	#6 - #250MCM	-	1
MLTI90LL-400	4"	#6 - #250MCM	-	1



MLTI90LL-75



MLTI90LL-125



## STEEL RIGID CONNECTORS SET-SCREW TYPE

### PRODUCT FEATURES

- ▶ Electroplated Zinc

### NOTE

- ▶ For use in dry location

Cat. No.	Trade Size	Std. Pkg.	Master Ctn.
RS-50	1/2"	25	250
RS-75	3/4"	25	250
RS-100	1"	10	100
RS-125	1-1/4"	1	25
RS-150	1-1/2"	1	25
RS-200	2"	1	10



## STEEL RIGID COUPLINGS SET-SCREW TYPE

### PRODUCT FEATURES

- ▶ Electroplated Zinc
- ▶ For use in dry location

Cat. No.	Trade Size	Std. Pkg.	Master Ctn.
RSC-50	1/2"	25	250
RSC-75	3/4"	25	250
RSC-100	1"	10	100
RSC-125	1-1/4"	1	25
RSC-150	1-1/2"	1	25
RSC-200	2"	1	10



## STEEL RIGID TO EMT COMBINATION COUPLINGS SET-SCREW TYPE

### PRODUCT FEATURES

- ▶ Electroplated Zinc
- ▶ Concrete-Tight when taped

Cat. No.	Rigid Size	EMT Size	Std. Pkg.	Master Ctn.
SRECS-50	1/2"	1/2"	25	250
SRECS-75	3/4"	3/4"	10	100
SRECS-100	1"	1"	10	100



## STEEL THREADLESS RIGID CONNECTORS COMPRESSION TYPE

### PRODUCT FEATURES

- ▶ Electroplated Zinc
- ▶ Concrete-Tight

Cat. No.	Trade Size	Std. Pkg.	Master Ctn.
RT-50	1/2"	25	250
RT-75	3/4"	25	250
RT-100	1"	10	100
RT-125	1-1/4"	1	25
RT-150	1-1/2"	1	25
RT-200	2"	1	10



## MALLEABLE IRON THREADLESS RIGID CONNECTORS COMPRESSION TYPE

### PRODUCT FEATURES

- ▶ Electroplated Zinc
- ▶ Concrete-Tight



Cat. No.	Trade Size	Std. Pkg.	Master Ctn.
MRT-50	1/2"	25	100
MRT-75	3/4"	25	100
MRT-100	1"	5	25
MRT-125	1-1/4"	-	25
MRT-150	1-1/2"	-	25
MRT-200	2"	-	10
MRT-250	2-1/2"	-	10
MRT-300	3"	-	10
MRT-350	3-1/2"	-	6
MRT-400	4"	-	6



## STEEL THREADLESS RIGID COUPLINGS COMPRESSION TYPE

### PRODUCT FEATURES

- ▶ Electroplated Zinc
- ▶ Concrete-Tight

Cat. No.	Trade Size	Std. Pkg.	Master Ctn.
RTC-50	1/2"	25	250
RTC-75	3/4"	25	250
RTC-100	1"	10	100
RTC-125	1-1/4"	1	25
RTC-150	1-1/2"	1	25
RTC-200	2"	1	10



## MALLEABLE IRON THREADLESS RIGID COUPLINGS COMPRESSION TYPE

### PRODUCT FEATURES

- ▶ Electroplated Zinc
- ▶ Concrete-Tight



Cat. No.	Trade Size	Std. Pkg.	Master Ctn.
MRTC-50	1/2"	10	100
MRTC-75	3/4"	10	100
MRTC-100	1"	5	50
MRTC-125	1-1/4"	5	50
MRTC-150	1-1/2"	-	12
MRTC-200	2"	-	5
MRTC-250	2-1/2"	-	5
MRTC-300	3"	-	3
MRTC-350	3-1/2"	-	2
MRTC-400	4"	-	2



MRTC-75



MRTC-125





## MALLEABLE IRON THREE-PIECE RIGID CONDUIT COUPLINGS

### PRODUCT FEATURES

- ▶ Electroplated Zinc



Cat. No.	Trade Size	Std. Pkg.	Master Ctn.
MR3C-50	1/2"	10	100
MR3C-75	3/4"	10	100
MR3C-100	1"	5	50
MR3C-125	1-1/4"	5	50
MR3C-150	1-1/2"	3	30
MR3C-200	2"	-	5
MR3C-250	2-1/2"	-	5
MR3C-300	3"	-	5
MR3C-350	3-1/2"	-	4
MR3C-400	4"	-	4
MR3C-500	5"	-	1
MR3C-600	6"	-	1



MR3C-75



MR3C-125

MR3C-150  
exploded view

## MALLEABLE IRON SPLIT RIGID COUPLINGS

### PRODUCT FEATURES

- ▶ Electroplated Zinc
- ▶ High Density Foam Gasket
- ▶ Easy and fast installation



Cat. No.	Trade Size	Std. Pkg.	Master Ctn.
MSRC-200	2"	5	25
MSRC-250	2-1/2"	2	10
MSRC-300	3"	2	10
MSRC-350	3-1/2"	1	5
MSRC-400	4"	1	5



## CAST STEEL RIGID THREADED COUPLINGS

### PRODUCT FEATURES

- ▶ Electroplated Zinc

Cat. No.	Trade Size	DIMENSIONS		Std. Pkg.
		D	L	
RC-50	1/2"	1.012"	1.626"	100
RC-75	3/4"	1.252"	1.642"	50
RC-100	1"	1.524"	1.969"	30
RC-125	1-1/4"	1.87"	2.031"	20
RC-150	1-1/2"	2.154"	2.063"	20
RC-200	2"	2.65"	2.126"	20
RC-250	2-1/2"	3.252"	3.189"	24
RC-300	3"	3.87"	3.307"	16
RC-350	3-1/2"	4.5"	3.406"	12
RC-400	4"	4.874"	3.516"	10
RC-500	5"	6.0"	3.953"	1
RC-600	6"	7.2"	4.252"	1

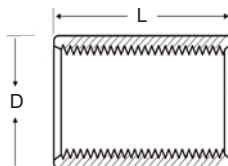



## MALLEABLE IRON 90° ANGLE THREADED SHORT ELBOWS

### PRODUCT FEATURES

- ▶ Electroplated Zinc



Cat. No.	Trade Size	Std. Pkg.	Master Ctn.
MSE90-50	1/2"	50	200
MSE90-75	3/4"	25	100
MSE90-100	1"	25	100

## MALLEABLE IRON RIGID FLOOR FLANGES



Cat. No.	Trade Size	Std. Pkg.
FR-50	1/2"	50
FR-75	3/4"	50
FR-100	1"	50
FR-125	1-1/4"	25
FR-150	1-1/2"	25
FR-200	2"	25

## MALLEABLE IRON CONCRETE SLAB INSERTS STRAIGHT



Cat. No.	Trade Size	Std. Pkg.	Master Ctn.
MCSI-50	1/2"	10	100
MCSI-75	3/4"	10	100
MCSI-100	1"	10	50

## MALLEABLE IRON CONCRETE SLAB INSERTS 90° ANGLE



Cat. No.	Trade Size	Std. Pkg.	Master Ctn.
MCSI90-50	1/2"	10	100
MCSI90-75	3/4"	10	100
MCSI90-100	1"	10	50

## STEEL CONDUIT LOCKING CONNECTORS

### PRODUCT FEATURES

- ▶ With Seismic Wire Holes
- ▶ Locknut Included



Cat. No.	Trade Size	Std. Pkg.	Master Ctn.
CLCSL-50	1/2"	10	100
CLCSL-75	3/4"	10	100

**ZINC DIE CAST**  
**EMT TO FLEX COUPLINGS**  
**COMPRESSION/SCREW-IN TYPE**



Cat. No.	Trade Size	Std. Pkg.	Master Ctn.
OF1611	1/2"	50	500
OF1612	3/4"	25	250
OF1613	1"	10	100

**ZINC DIE CAST**  
**EMT TO FLEX COUPLINGS**  
**SET-SCREW/SQUEEZE TYPE**



Cat. No.	Trade Size	Std. Pkg.	Master Ctn.
OF530	1/2" to 3/8"	50	500
OF531	1/2" to 1/2"	25	250
OF532	3/4" to 3/4"	25	100
OF533	1" to 1"	10	40

**ZINC DIE CAST**  
**EMT TO FLEX COUPLINGS**  
**SET-SCREW/CLAMP TYPE**



Cat. No.	Trade Size	Std. Pkg.	Master Ctn.
OF520	1/2" to 3/8"	50	500
OF521	1/2" to 1/2"	25	250
OF522	3/4" to 3/4"	25	250
OF523	1" to 1"	10	40

**ZINC DIE CAST**  
**RIGID TO FLEX COUPLINGS**  
**SET-SCREW TYPE**



Cat. No.	Trade Size	Std. Pkg.	Master Ctn.
OF694	1/2"	25	250
OF695	3/4"	25	250

**PRODUCT FEATURES**

- For Steel FLEX Only

**ZINC DIE CAST**  
**RIGID TO FLEX COUPLING**  
**CLAMP TYPE**



Cat. No.	Trade Size	Std. Pkg.	Master Ctn.
OF697	1/2"	25	250

**PRODUCT FEATURES**

- For Steel FLEX Only

**STEEL RIGID TO EMT**  
**COMBINATION COUPLINGS**  
**SET-SCREW TYPE**



Cat. No.	Rigid Size	EMT Size	Std. Pkg.	Master Ctn.
SRECS-50	1/2"	1/2"	25	250
SRECS-75	3/4"	3/4"	10	100
SRECS-100	1"	1"	10	100

**PRODUCT FEATURES**

- Zinc Electroplated
- Concrete-Tight when taped

**STEEL EMT TO LIQUID TIGHT**  
**COMBINATION COUPLINGS**  
**COMPRESSION TYPE**



Cat. No.	EMT Size	LT Size	Std. Pkg.	Master Ctn.
SELTC-50	1/2"	1/2"	25	250
SELTC-75	3/4"	3/4"	10	100
SELTC-100	1"	1"	10	100

**PRODUCT FEATURES**

- Zinc Electroplated
- Concrete-Tight
- Rain-Tight



## ZINC DIE CAST GROUND BUSHINGS INSULATED WITH UNIVERSAL LAY-IN LUG

### PRODUCT FEATURES

- ▶ 105°C rated Throat Insulator



Cat. No.	Trade Size	Lug Range	Std. Pkg.	Master Ctn.
GBLL-50	1/2"	#14 - #4	50	500
GBLL-75	3/4"	#14 - #4	40	400
GBLL-100	1"	#14 - #4	15	150
GBLL-125	1-1/4"	#14 - #4	15	150
GBLL-125-10	1-1/4"	#14 - #1/0	20	200
GBLL-150	1-1/2"	#14 - #4	10	100
GBLL-150-10	1-1/2"	#14 - #1/0	10	100
GBLL-200	2"	#14 - #4	5	50
GBLL-200-10	2"	#14 - #1/0	10	100
GBLL-250	2-1/2"	#6 - #250MCM	5	50
GBLL-250-10	2-1/2"	#14 - #1/0	-	50
GBLL-300	3"	#6 - #250MCM	5	50
GBLL-300-10	3"	#14 - #1/0	-	50
GBLL-350	3-1/2"	#6 - #250MCM	4	40
GBLL-350-10	3-1/2"	#14 - #1/0	-	10
GBLL-400	4"	#6 - #250MCM	4	40
GBLL-400-10	4"	#14 - #1/0	-	10



## MALLEABLE IRON GROUND BUSHINGS INSULATED WITH UNIVERSAL LAY-IN LUG

### PRODUCT FEATURES

- ▶ 150°C rated Throat Insulator
- ▶ Full Machine-Cut Internal Threads
- ▶ Meets Federal Spec. A-A-50553



Cat. No.	Trade Size	Lug Range	Std. Pkg.	Master Ctn.
MGBLL-50	1/2"	#14 - #4	50	200
MGBLL-75	3/4"	#14 - #4	25	100
MGBLL-100	1"	#14 - #4	25	100
MGBLL-125	1-1/4"	#14 - #4	10	50
MGBLL-125-10	1-1/4"	#14 - #1/0	20	200
MGBLL-150	1-1/2"	#14 - #4	10	50
MGBLL-150-10	1-1/2"	#14 - #1/0	10	100
MGBLL-200	2"	#14 - #4	10	50
MGBLL-200-10	2"	#14 - #1/0	10	100
MGBLL-250	2-1/2"	#6 - #250MCM	5	25
MGBLL-250-10	2-1/2"	#14 - #1/0	-	50
MGBLL-300	3"	#6 - #250MCM	5	25
MGBLL-300-10	3"	#14 - #1/0	-	25
MGBLL-350	3-1/2"	#6 - #250MCM	-	5
MGBLL-350-10	3-1/2"	#14 - #1/0	-	10
MGBLL-400	4"	#6 - #250MCM	-	5
MGBLL-400-10	4"	#14 - #1/0	-	10
MGBLL-500	5"	#6 - #250MCM	-	5
MGBLL-500-30	5"	#6 - #3/0	-	5
MGBLL-600	6"	#6 - #250MCM	-	5
MGBLL-600-30	6"	#6 - #3/0	-	5





## STEEL GROUNDING (BONDING) RIGID LOCKNUTS

### PRODUCT FEATURES

- ▶ Electroplated Zinc



Cat. No.	Trade Size	Std. Pkg.	Master Ctn.
GL-50	1/2"	50	200
GL-75	3/4"	25	100
GL-100	1"	25	100
GL-125	1-1/4"	10	50
GL-150	1-1/2"	10	50
GL-200	2"	10	50
GL-250	2-1/2"	5	25
GL-300	3"	5	25
GL-350	3-1/2"	-	5
GL-400	4"	-	5
GL-500	5"	-	5
GL-600	6"	-	5

## COPPER DIRECT BURIAL MECHANICAL LUGS

### PRODUCT FEATURES

- ▶ Stainless Steel Screw



Cat. No.	Wire Range	Std. Pkg.	Master Ctn.
MLDB-14/10	#14 - #10	50	400
MLDB-14/6	#14 - #6	50	400
MLDB-14/4	#14 - #4	25	200
MLDB-6/100	#6 - #1/0	10	80

## COPPER DIRECT BURIAL LAY-IN LUGS

### PRODUCT FEATURES

- ▶ Stainless Steel Screw



Cat. No.	Wire Range	Std. Pkg.	Master Ctn.
LLDB-14/4	#14 - #4	25	250

### COPPER TIN PLATED DIRECT BURIAL LAY-IN LUG

LLTDB-14/4	#14 - #4	25	250
------------	----------	----	-----

### COPPER TIN PLATED DIRECT BURIAL LAY-IN LUG FOR SOLAR INSTALLATIONS

LLTDB-SP-14/4	#14 - #4	25	250
---------------	----------	----	-----

## ALUMINUM TERMINAL LUGS SINGLE BARREL ONE HOLE MOUNT

### PRODUCT FEATURES

- ▶ Electro Tinned
- ▶ Single barrel
- ▶ Dual rated for copper and aluminum conductors



Cat. No.	Wire Range	Std. Pkg.	Master Ctn.
FTL-14/4	#14 - #4	50	400
FTL-14/2	#14 - #2	50	400
FTL-14/100	#14 - #1/0	25	200
FTL-14/200	#14 - #2/0	25	200
FTL-6/250	#6 - #250MCM	10	100
FTL-6/300	#6 - #300MCM	10	100
FTL-6/350	#6 - #350MCM	10	100
FTL-4/500	#4 - #500MCM	6	60
FTL-2/600	#2 - #600MCM	6	60
FTL-300/800	#300MCM - #800MCM	4	40
FTL-500/1000	#500MCM - #1000MCM	4	40



## ALUMINUM TERMINAL LUGS DOUBLE BARREL ONE HOLE MOUNT

### PRODUCT FEATURES

- ▶ Electro Tinned
- ▶ Double barrel
- ▶ Dual rated for copper and aluminum conductors



Cat. No.	Wire Range	Std. Pkg.	Master Ctn.
FT2L-14/100	#14 - #1/0	10	100
FT2L-14/200	#14 - #2/0	10	100
FT2L-6/250	#6 - #250MCM	10	100
FT2L-6/350	#6 - #350MCM	4	40
FT2L-2/600	#2 - #600MCM	4	40
FT2L-300/800	#300MCM - #800MCM	2	20
FT2L-500/1000	#500MCM - #1000MCM	2	20

## INTERSYSTEM GROUNDING AND BONDING BRIDGES

### PRODUCT FEATURES

- ▶ Available in Zinc or Bronze
- ▶ Compatible with copper and aluminum wire



Cat. No.	CU/AL Wire Range	Material	Std. Pkg.	Master Ctn.
IGBB-5	#6 - #2 AWG Grounding Conductor for Central Hole #14 - #4 AWG Bonding Conductor for Side Hole	Zinc	10	50
IGBB-5B	#6 - #2 AWG Grounding Conductor for Central Hole #14 - #4 AWG Bonding Conductor for Side Hole	Bronze	10	50

## ZINC DIE CAST BARE GROUND CLAMP

### PRODUCT FEATURES

- ▶ Steel Screw



Cat. No.	Ground Wire Range	Trade Size	Std. Pkg.	Master Ctn.
GCBZ-50/100	#10 - #2	1/2" to 1"	25	200

## BRONZE BARE GROUND CLAMPS

### PRODUCT FEATURES

- ▶ Steel Screw



Cat. No.	Ground Wire Range	Trade Size	Std. Pkg.	Master Ctn.
GCB-50/100	#10 - #2	1/2" to 1"	25	200
GCB-125/200	#10 - #2	1-1/4" to 2"	10	80
GCB-250/400	#10 - #2	2-1/2" to 4"	-	15
GCB-450/600	#10 - #2	4-1/2" to 6"	-	5

## BRONZE BARE GROUND CLAMPS

### PRODUCT FEATURES

- ▶ Brass Screw



Cat. No.	Ground Wire Range	Trade Size	Std. Pkg.	Master Ctn.
GCBR-50/100	#10 - #2	1/2" to 1"	25	200

## BRONZE ARMORED GROUND CLAMPS

### PRODUCT FEATURES

- ▶ Steel Screws
- ▶ For use with #8, #6, #4 AWG Bare Wire or AC (BX) Armored Cable



Cat. No.	Ground Wire Range	Trade Size	Std. Pkg.	Master Ctn.
GCA-50/100	#8 - #4	1/2" to 1"	25	150
GCA-125/200	#8 - #4	1-1/4" to 2"	10	80
GCA-250/400	#8 - #4	2-1/2" to 4"	-	15
GCA-450/600	#8 - #4	4-1/2" to 6"	-	5



## BRONZE DIRECT BURIAL\* BARE GROUND CLAMPS

### PRODUCT FEATURES

- ▶ Bronze Screws



Cat. No.	Ground Wire Range	Trade Size	Std. Pkg.	Master Ctn.
GCB-50/100	#10 - #2	1/2" to 1"	25	200
GCB-125/200	#10 - #2	1-1/4" to 2"	10	80

\*UL Listed for direct burial in earth or concrete.

## BRONZE DIRECT BURIAL\* ARMORED GROUND CLAMPS

### PRODUCT FEATURES

- ▶ Bronze Screws
- ▶ For use with #8, #6, #4 AWG Bare Wire or AC (BX) Armored Cable



Cat. No.	Ground Wire Range	Trade Size	Std. Pkg.	Master Ctn.
GCAB-50/100	#8 - #4	1/2" to 1"	25	200

\*UL Listed for direct burial in earth or concrete.

## BRONZE GROUND CLAMPS WITH ADAPTER

### PRODUCT FEATURES

- ▶ Steel Screws



Cat. No.	Ground Wire Range	Trade Size	Std. Pkg.	Master Ctn.
GCAH-50/100	#8 - #4/0	1/2" to 1"	10	80
GCAH-125/200	#8 - #4/0	1-1/4" to 2"	5	40

## HEAVY DUTY BRONZE DIRECT BURIAL FOR REBAR GROUND CLAMP

### PRODUCT FEATURES

- ▶ Bronze Screws



Cat. No.	Ground Wire Range	Trade Size	Std. Pkg.	Master Ctn.
GCR-50/100	#8 - #2	1/2", 3/4 to 1"	25	200

\*UL Listed for direct burial in earth or concrete.

## BRONZE LAY-IN GROUND CLAMP

### PRODUCT FEATURES

- ▶ Steel Screws



Cat. No.	Ground Wire Range	Trade Size	Std. Pkg.	Master Ctn.
GCRL-38/100	#10 - #2	3/8" to 1" Rebar 1/2" to 1"	25	100

## BRONZE DIRECT BURIAL LAY-IN CLAMP

### PRODUCT FEATURES

- ▶ Stainless Steel Screws



Cat. No.	Ground Wire Range	Trade Size	Std. Pkg.	Master Ctn.
GCRLDB-38/100	#10 - #2	3/8" to 1" Rebar 1/2" to 1"	25	100

## BRONZE CONDUIT CLAMPS FOR RIGID CONDUIT WITH ADAPTER

### PRODUCT FEATURES

- ▶ Steel Screws



Cat. No.	Water Pipe Size	Hub Size	Ground Wire Range	Std. Pkg.	Master Ctn.
GCH-50/100-50	1/2" to 1"	1/2"	#10 - #2/0	10	50
GCH-50/100-75	1/2" to 1"	3/4"	#10 - #2/0	10	50
GCH-50/100-100	1/2" to 1"	1"	#10 - #3/0	10	50



## BRONZE GROUND CLAMPS FOR RIGID CONDUIT WITH FLEXIBLE COPPER STRAP

### PRODUCT FEATURES

- ▶ Steel Screws

#### Cat. No.

	Water Pipe Size	Hub Size	Ground Wire Range	Std. Pkg.
AGS-50	1/2" to 1"	1/2"	#10 - #4	50
AGS-75	1/2" to 1"	3/4"	#10 - #4	50
AGS-100	1/2" to 1"	1"	#10 - #4	50



## BRONZE CONDUIT HUB 360° SWING TYPE

### PRODUCT FEATURES

- ▶ Steel Screws

#### Cat. No.

	Pipe Size	Ground Wire Range	Std. Pkg.	Master Ctn.
H-50	1/2"	#10 - #2/0	25	200
H-75	3/4"	#10 - #2/0	25	200
H-100	1"	#10 - #3/0	20	160



## BRONZE DIRECT BURIAL GROUND ROD CLAMPS

### PRODUCT FEATURES

- ▶ Bronze Screw

#### Cat. No.

	Ground Rod Size	Ground Wire Range	Std. Pkg.	Master Ctn.
GRC-50	1/2"	#10 - #2	35	280
GRC-58	5/8"	#10 - #2	30	240
GRC-75	3/4"	#10 - #2	20	160

\*UL Listed for direct burial in earth or concrete.



## BRASS SPLIT BOLT COPPER TO COPPER CONNECTORS

### PRODUCT FEATURES

- ▶ Copper Plated

#### Cat. No.

	Ground Wire Range	Std. Pkg.	Master Ctn.
SBCC-8	#8 STR - #12 STR	25	200
SBCC-6	#6 SOL - #10 SOL	25	200
SBCC-4	#4 SOL - #8 SOL	25	200
SBCC-2	#2 STR - #6 SOL	10	80
SBCC-2S	#2 SOL - #6 SOL	10	80
SBCC-10	#1/0 STR - #4 SOL	10	80
SBCC-20	#2/0 STR - #2 SOL	5	40
SBCC-30	#3/0 STR - #2 SOL	5	40
SBCC-250	#250MCM - #1/0 SOL	5	40
SBCC-350	#350MCM - #4/0 SOL	1	8
SBCC-500	#500MCM - #250MCM	1	8
SBCC-750	#750MCM - #350MCM	1	8





**DIE CAST COPPER-FREE  
ALUMINUM  
THREADED CONDUIT BODIES  
"LB" SERIES**

**PRODUCT FEATURES**

- ▶ With Die Cast Cover and Neoprene Gasket
- ▶ Gray color



Cat. No.	Trade Size	DIMENSIONS - LB SERIES					Std. Pkg.
		A	B	C	D	E	
LB-50A	1/2"	1-5/16"	3-7/8"	2-3/32"	4-5/16"	1-1/16"	10
LB-75A	3/4"	1-9/16"	4-11/16"	2-3/8"	5-3/32"	1-5/16"	10
LB-100A	1"	1-13/16"	5-3/8"	2-3/4"	5-29/32"	1-9/16"	5
LB-125A	1-1/4"	2-1/2"	7-5/16"	3-1/2"	7-13/16"	1-31/32"	2
LB-150A	1-1/2"	2-1/2"	7-5/16"	3-1/2"	7-13/16"	2-3/16"	2
LB-200A	2"	3-3/16"	9-1/2"	4-1/2"	10-1/16"	2-11/16"	1
LB-250A	2-1/2"	4-1/2"	12-1/16"	5-5/16"	12-13/16"	3-5/16"	1
LB-300A	3"	4-1/2"	12-1/16"	5-29/32"	12-13/16"	3-15/16"	1
LB-350A	3-1/2"	5-9/16"	15-1/16"	7-5/16"	15-5/8"	4-17/32"	1
LB-400A	4"	5-9/16"	15-7/16"	7-5/16"	15-5/8"	4-31/32"	1

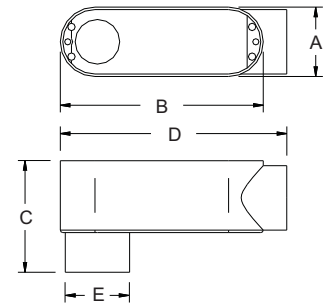
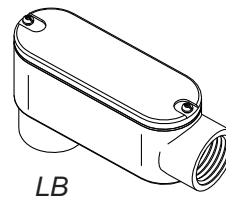

Electrical Fittings

**DIE CAST COPPER-FREE  
ALUMINUM  
THREADED CONDUIT BODIES  
"LL" SERIES**

**PRODUCT FEATURES**

- ▶ With Die Cast Cover and Neoprene Gasket
- ▶ Gray color



Cat. No.	Trade Size	DIMENSIONS - LL SERIES					Std. Pkg.
		A	B	C	D	E	
LL-50A	1/2"	1-5/16"	3-7/8"	2-1/32"	4-5/16"	1-3/8"	10
LL-75A	3/4"	1-9/16"	4-11/16"	2-5/16"	5-3/32"	1-5/8"	10
LL-100A	1"	1-13/16"	5-3/8"	2-11/16"	5-29/32"	1-7/8"	5
LL-125A	1-1/4"	2-1/2"	7-5/16"	3-1/2"	7-13/16"	2-1/2"	2
LL-150A	1-1/2"	2-1/2"	7-5/16"	3-1/2"	7-13/16"	2-1/2"	2
LL-200A	2"	3-3/16"	9-1/2"	4-9/32"	10-1/16"	3-3/8"	1
LL-250A	2-1/2"	4-1/2"	12-1/16"	5-7/8"	12-13/16"	4"	1
LL-300A	3"	4-1/2"	12-1/16"	5-7/8"	12-13/16"	4-1/2"	1
LL-400A	4"	5-9/16"	15-1/16"	7-21/32"	15-5/8"	5-5/8"	1

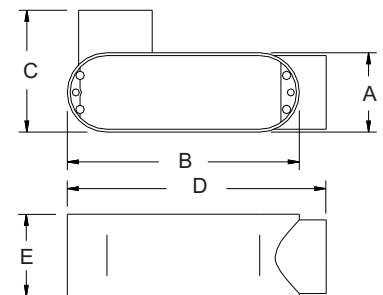
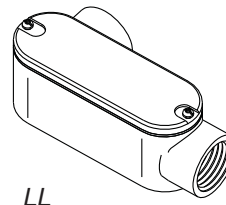



**DIE CAST COPPER-FREE  
ALUMINUM  
THREADED CONDUIT BODIES  
"LR" SERIES**

**PRODUCT FEATURES**

- ▶ With Die Cast Cover and Neoprene Gasket
- ▶ Gray color



Cat. No.	Trade Size	DIMENSIONS - LR SERIES					Std. Pkg.
		A	B	C	D	E	
LR-50A	1/2"	1-5/16"	3-7/8"	2-1/32"	4-5/16"	1-3/8"	10
LR-75A	3/4"	1-9/16"	4-11/16"	2-5/16"	5-3/32"	1-5/8"	10
LR-100A	1"	1-13/16"	5-3/8"	2-11/16"	5-29/32"	1-7/8"	5
LR-125A	1-1/4"	2-1/2"	7-5/16"	3-1/2"	7-13/16"	2-1/2"	2
LR-150A	1-1/2"	2-1/2"	7-5/16"	3-1/2"	7-13/16"	2-1/2"	2
LR-200A	2"	3-3/16"	9-1/2"	4-9/32"	10-1/16"	3-3/8"	1
LR-250A	2-1/2"	4-1/2"	12-1/16"	5-7/8"	12-13/16"	4"	1
LR-300A	3"	4-1/2"	12-1/16"	5-7/8"	12-13/16"	4-1/2"	1
LR-400A	4"	5-9/16"	15-1/16"	7-21/32"	15-5/8"	5-5/8"	1

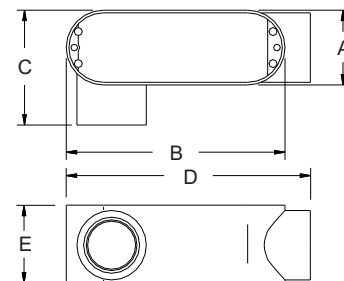
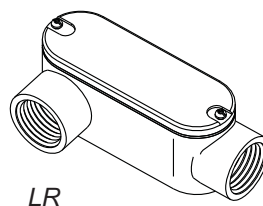

**DIE CAST COPPER-FREE  
ALUMINUM  
THREADED CONDUIT BODIES  
"C" SERIES**

**PRODUCT FEATURES**

- ▶ With Die Cast Cover and Neoprene Gasket
- ▶ Gray color



Cat. No.	Trade Size	DIMENSIONS - C SERIES					Std. Pkg.
		A	B	C	D	E	
C-50A	1/2"	1-5/16"	3-7/8"	1-3/8"	4-11/16"	1-1/16"	10
C-75A	3/4"	1-9/16"	4-11/16"	1-5/8"	5-1/2"	1-5/16"	10
C-100A	1"	1-13/16"	5-3/8"	1-7/8"	6-7/16"	1-9/16"	5
C-125A	1-1/4"	2-1/2"	7-5/16"	2-1/2"	8-3/8"	1-31/32"	2
C-150A	1-1/2"	2-1/2"	7-5/16"	2-1/2"	8-3/8"	2-3/16"	2
C-200A	2"	3-3/16"	9-1/2"	3-3/8"	10-9/16"	2-11/16"	1
C-250A	2-1/2"	4-1/2"	12-1/16"	4"	13-1/2"	3-5/16"	1
C-300A	3"	4-1/2"	12-1/16"	4-1/2"	13-1/2"	3-15/16"	1
C-400A	4"	5-9/16"	15-1/16"	5-5/8"	16-5/16"	4-31/32"	1

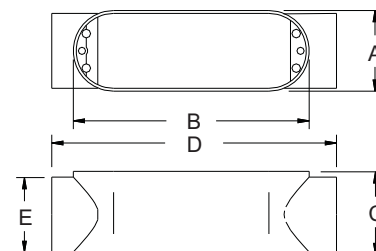
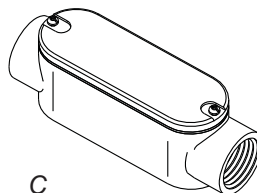

## DIE CAST COPPER-FREE ALUMINUM THREADED CONDUIT BODIES "T" SERIES

### PRODUCT FEATURES

- ▶ With Die Cast Cover and Neoprene Gasket
- ▶ Gray color



Cat. No.	Trade Size	DIMENSIONS - T SERIES					Std. Pkg.
		A	B	C	D	E	
T-50A	1/2"	1-5/16"	3-7/8"	1-3/8"	4-11/16"	2-1/32"	10
T-75A	3/4"	1-9/16"	4-11/16"	1-5/8"	5-1/2"	2-5/16"	10
T-100A	1"	1-13/16"	5-3/8"	1-7/8"	6-7/16"	2-11/16"	5
T-125A	1-1/4"	2-1/2"	7-5/16"	2-1/2"	8-3/8"	3-1/2"	2
T-150A	1-1/2"	2-1/2"	7-5/16"	2-1/2"	8-3/8"	3-1/2"	2
T-200A	2"	3-3/16"	9-1/2"	3-3/8"	10-9/16"	4-9/32"	1
T-250A	2-1/2"	4-1/2"	12-1/16"	4"	13-1/2"	5-7/8"	1
T-300A	3"	4-1/2"	12-1/16"	4-1/2"	13-1/2"	5-7/8"	1
T-400A	4"	5-9/16"	15-1/16"	5-5/8"	16-5/16"	7-21/32"	1

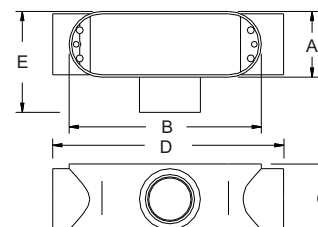
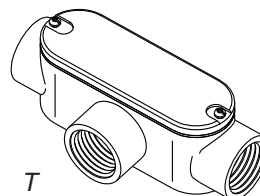

## DIE CAST COPPER-FREE ALUMINUM THREADED SERVICE ENTRANCE CONDUIT BODIES "SLB" SERIES

### PRODUCT FEATURES

- ▶ With Die Cast Cover and Neoprene Gasket
- ▶ Gray color



Cat. No.	Trade Size	DIMENSIONS - SLB SERIES			Std. Pkg.
		A	B	C	
SLB-50	1/2"	1-5/8"	1-3/8"	3-9/32"	20
SLB-75	3/4"	1-27/32"	1-9/16"	3-19/32"	20
SLB-100	1"	2-1/8"	1-31/32"	4-5/16"	10
SLB-125	1-1/4"	2-19/32"	2-7/16"	5-9/16"	10
SLB-150	1-1/2"	2-19/32"	2-5/8"	6-1/4"	6
SLB-200	2"	3-1/8"	3-1/8"	6-3/4"	3

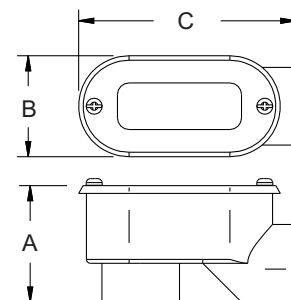
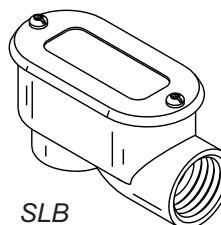

## MOGUL THREADED COPPER-FREE ALUMINUM ALLOY EXTRA-LARGE RIGID CONDUIT BODIES "LB" SERIES

### PRODUCT FEATURES

- ▶ With Die Cast Cover and Neoprene Gasket
- ▶ Gray color

Cat. No.	Trade Size	DIMENSIONS - LB SERIES						Std. Pkg.	Master Ctn.
		A	B	C1	C2	D	E		
LBM-150	1-1/2"	3"	13-7/16"	5"	4"	14-1/4"	2-3/4"	-	1
LBM-200	2"	3"	13-7/16"	5"	4"	14-1/4"	2-3/4"	-	1
LBM-250	2-1/2"	4-17/27"	21-9/10"	8-2/3"	5-3/25"	22-3/4"	4-1/4"	-	1
LBM-300	3"	4-17/27"	21-9/10"	8-2/3"	5-3/25"	22-3/4"	4-1/4"	-	1
LBM-350	3-1/2"	5-17/27"	28-1/2"	10"	6-1/10"	29-1/8"	5-1/8"	-	1
LBM-400	4"	5-17/27"	28-1/2"	10"	6-1/10"	29-1/8"	5-1/8"	-	1

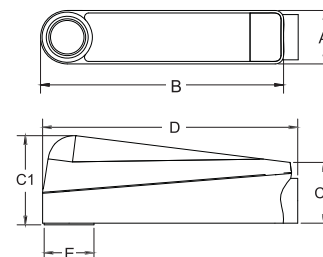

**DIE CAST COPPER-FREE  
ALUMINUM  
THREADED CONDUIT BODIES  
"LB" SERIES  
WITHOUT COVERS**

**PRODUCT FEATURES**

- ▶ Gray color
- ▶ Suitable for wet location when used with gasket and cover



Cat. No.	Trade Size	DIMENSIONS - LB SERIES					Std. Pkg.
		A	B	C	D	E	
LB-50	1/2"	1-5/16"	3-7/8"	2-3/32"	4-5/16"	1-1/16"	10
LB-75	3/4"	1-9/16"	4-11/16"	2-3/8"	5-3/32"	1-5/16"	10
LB-100	1"	1-13/16"	5-3/8"	2-3/4"	5-29/32"	1-9/16"	5
LB-125	1-1/4"	2-1/2"	7-5/16"	3-1/2"	7-13/16"	1-31/32"	2
LB-150	1-1/2"	2-1/2"	7-5/16"	3-1/2"	7-13/16"	2-3/16"	2
LB-200	2"	3-3/16"	9-1/2"	4-1/2"	10-1/16"	2-11/16"	1
LB-250	2-1/2"	4-1/2"	12-1/16"	5-5/16"	12-13/16"	3-5/16"	1
LB-300	3"	4-1/2"	12-1/16"	5-29/32"	12-13/16"	3-15/16"	1
LB-350	3-1/2"	5-9/16"	15-1/16"	7-5/16"	15-5/8"	4-17/32"	1
LB-400	4"	5-9/16"	15-7/16"	7-5/16"	15-5/8"	4-31/32"	1

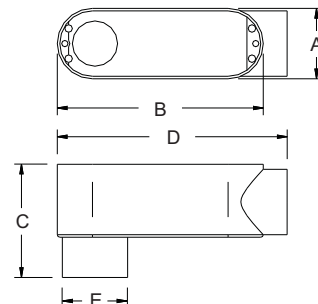
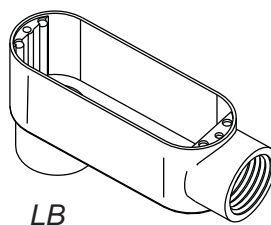

**DIE CAST COPPER-FREE  
ALUMINUM  
THREADED CONDUIT BODIES  
"LL" SERIES  
WITHOUT COVERS**

**PRODUCT FEATURES**

- ▶ Gray color
- ▶ Suitable for wet location when used with gasket and cover



Cat. No.	Trade Size	DIMENSIONS - LL SERIES					Std. Pkg.
		A	B	C	D	E	
LL-50	1/2"	1-5/16"	3-7/8"	2-1/32"	4-5/16"	1-3/8"	10
LL-75	3/4"	1-9/16"	4-11/16"	2-5/16"	5-3/32"	1-5/8"	10
LL-100	1"	1-13/16"	5-3/8"	2-11/16"	5-29/32"	1-7/8"	5
LL-125	1-1/4"	2-1/2"	7-5/16"	3-1/2"	7-13/16"	2-1/2"	2
LL-150	1-1/2"	2-1/2"	7-5/16"	3-1/2"	7-13/16"	2-1/2"	2
LL-200	2"	3-3/16"	9-1/2"	4-9/32"	10-1/16"	3-3/8"	1
LL-250	2-1/2"	4-1/2"	12-1/16"	5-7/8"	12-13/16"	4"	1
LL-300	3"	4-1/2"	12-1/16"	5-7/8"	12-13/16"	4-1/2"	1
LL-400	4"	5-9/16"	15-7/16"	7-21/32"	15-5/8"	5-5/8"	1

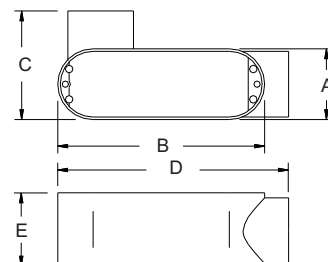
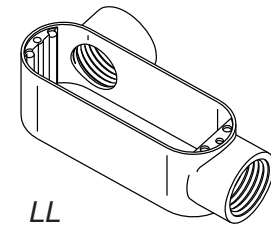

**DIE CAST COPPER-FREE  
ALUMINUM  
THREADED CONDUIT BODIES  
"LR" SERIES  
WITHOUT COVERS**

**PRODUCT FEATURES**

- ▶ Gray color
- ▶ Suitable for wet location when used with gasket and cover

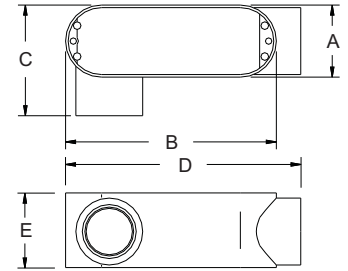
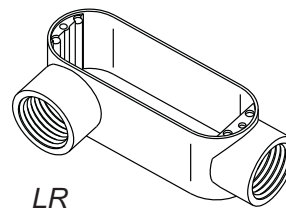

Electrical Fittings

Cat. No.	Trade Size	DIMENSIONS - LR SERIES					Std. Pkg.
		A	B	C	D	E	
LR-50	1/2"	1-5/16"	3-7/8"	2-1/32"	4-5/16"	1-3/8"	10
LR-75	3/4"	1-9/16"	4-11/16"	2-5/16"	5-3/32"	1-5/8"	10
LR-100	1"	1-13/16"	5-3/8"	2-11/16"	5-29/32"	1-7/8"	5
LR-125	1-1/4"	2-1/2"	7-5/16"	3-1/2"	7-13/16"	2-1/2"	2
LR-150	1-1/2"	2-1/2"	7-5/16"	3-1/2"	7-13/16"	2-1/2"	2
LR-200	2"	3-3/16"	9-1/2"	4-9/32"	10-1/16"	3-3/8"	1
LR-250	2-1/2"	4-1/2"	12-1/16"	5-7/8"	12-13/16"	4"	1
LR-300	3"	4-1/2"	12-1/16"	5-7/8"	12-13/16"	4-1/2"	1
LR-400	4"	5-9/16"	15-1/16"	7-21/32"	15-5/8"	5-5/8"	1

**DIE CAST COPPER-FREE  
ALUMINUM  
THREADED CONDUIT BODIES  
"C" SERIES  
WITHOUT COVERS**

**PRODUCT FEATURES**

- ▶ Gray color
- ▶ Suitable for wet location when used with gasket and cover

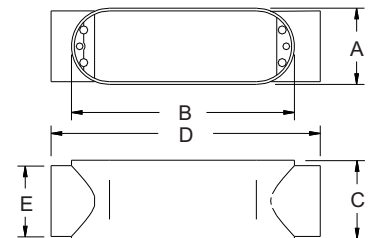
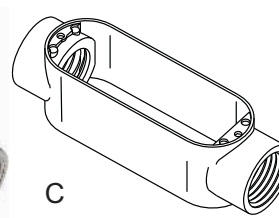

Cat. No.	Trade Size	DIMENSIONS - C SERIES					Std. Pkg.
		A	B	C	D	E	
C-50	1/2"	1-5/16"	3-7/8"	1-3/8"	4-5/16"	1-1/16"	10
C-75	3/4"	1-9/16"	4-11/16"	1-5/8"	5-3/32"	1-5/16"	10
C-100	1"	1-13/16"	5-3/8"	1-7/8"	5-29/32"	1-9/16"	5
C-125	1-1/4"	2-1/2"	7-5/16"	2-1/2"	7-13/16"	1-31/32"	2
C-150	1-1/2"	2-1/2"	7-5/16"	2-1/2"	7-13/16"	2-3/16"	2
C-200	2"	3-3/16"	9-1/2"	3-3/8"	10-1/16"	2-11/16"	1
C-250	2-1/2"	4-1/2"	12-1/16"	4"	12-13/16"	3-5/16"	1
C-300	3"	4-1/2"	12-1/16"	4-1/2"	12-13/16"	3-15/16"	1
C-400	4"	5-9/16"	15-1/16"	5-5/8"	15-5/8"	4-31/32"	1

**DIE CAST COPPER-FREE  
ALUMINUM  
THREADED CONDUIT BODIES  
"T" SERIES  
WITHOUT COVERS**

**PRODUCT FEATURES**

- ▶ Gray color
- ▶ Suitable for wet location when used with gasket and cover



Cat. No.	Trade Size	DIMENSIONS - T SERIES					Std. Pkg.
		A	B	C	D	E	
T-50	1/2"	1-5/16"	3-7/8"	1-3/8"	4-11/16"	2-1/32"	10
T-75	3/4"	1-9/16"	4-11/16"	1-5/8"	5-1/2"	2-5/16"	10
T-100	1"	1-13/16"	5-3/8"	1-7/8"	6-7/16"	2-11/16"	5
T-125	1-1/4"	2-1/2"	7-5/16"	2-1/2"	8-3/8"	3-1/2"	2
T-150	1-1/2"	2-1/2"	7-5/16"	2-1/2"	8-3/8"	3-1/2"	2
T-200	2"	3-3/16"	9-1/2"	3-3/8"	10-9/16"	4-9/32"	1
T-250	2-1/2"	4-1/2"	12-1/16"	4"	13-1/2"	5-7/8"	1
T-300	3"	4-1/2"	12-1/16"	4-1/2"	13-1/2"	5-7/8"	1
T-400	4"	5-9/16"	15-1/16"	5-5/8"	16-5/16"	7-21/32"	1

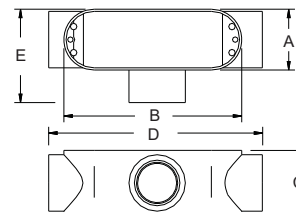
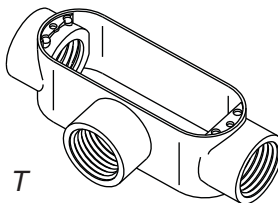

**MALLEABLE IRON  
THREADED CONDUIT BODIES  
"LB" SERIES**

**PRODUCT FEATURES**

- ▶ Electroplated Zinc
- ▶ Suitable for wet location when used with gasket and cover



Cat. No.	Trade Size	DIMENSIONS - LB SERIES					Std. Pkg.
		A	B	C	D	E	
MLB-50	1/2"	1-3/8"	4"	2-3/16"	4-5/8"	1-15/32"	10
MLB-75	3/4"	1-5/8"	4-21/32"	2-3/8"	5-3/8"	1-21/32"	10
MLB-100	1"	1-13/16"	5-3/8"	2-7/8"	6-1/4"	2"	5
MLB-125	1-1/4"	2-1/2"	7-7/32"	3-1/2"	8-1/8"	2-5/8"	2
MLB-150	1-1/2"	2-1/2"	7-7/32"	3-11/16"	8-3/32"	2-13/16"	2
MLB-200	2"	3-1/8"	9-1/2"	4-1/2"	10-1/2"	3-1/2"	1
MLB-250	2-1/2"	4-3/8"	12-1/4"	5-13/32"	13-3/4"	4"	1
MLB-300	3"	4-3/8"	12-1/4"	6-3/16"	13-13/16"	4-5/8"	1
MLB-350	3-1/2"	5-1/2"	15"	7-3/16"	16-5/8"	5-7/16"	1
MLB-400	4"	5-1/2"	15"	7-11/32"	16-23/32"	5-3/4"	1

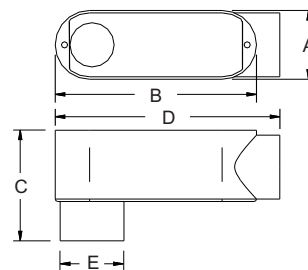
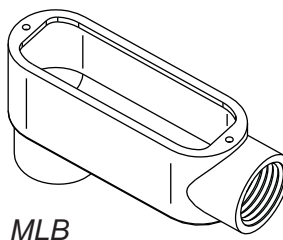



## MALLEABLE IRON THREADED CONDUIT BODIES "LL" SERIES

### PRODUCT FEATURES

- ▶ Electroplated Zinc
- ▶ Suitable for wet location when used with gasket and cover



Cat. No.	Trade Size	DIMENSIONS - LL SERIES					Std. Pkg.
		A	B	C	D	E	
MLL-50	1/2"	1-3/8"	4"	2-1/16"	4-11/16"	1-7/16"	10
MLL-75	3/4"	1-5/8"	4-11/16"	2-1/4"	5-13/32"	1-21/32"	10
MLL-100	1"	1-13/16"	5-3/8"	2-21/32"	6-1/4"	2"	5
MLL-125	1-1/4"	2-1/2"	7-7/32"	3-7/16"	8-1/8"	2-19/32"	2
MLL-150	1-1/2"	2-1/2"	7-7/32"	3-7/16"	8-1/8"	2-13/16"	2
MLL-200	2"	3-1/8"	9-1/2"	4-3/16"	10-1/2"	3-17/32"	1
MLL-250	2-1/2"	4-3/8"	12-1/4"	5-27/32"	13-3/4"	4"	1
MLL-300	3"	4-3/8"	12-1/4"	5-29/32"	13-13/16"	4-21/32"	1
MLL-350	3-1/2"	5-1/2"	15"	7-1/8"	16-5/8"	5-7/16"	1
MLL-400	4"	5-1/2"	15"	7-3/16"	16-5/8"	5-3/4"	1

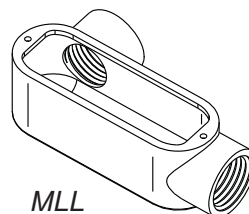

MLL

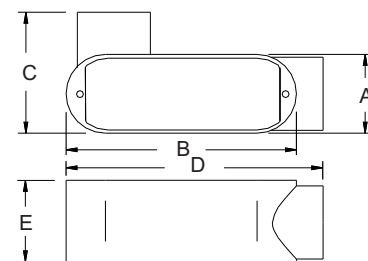

Electrical Fittings

## MALLEABLE IRON THREADED CONDUIT BODIES "LR" SERIES

### PRODUCT FEATURES

- ▶ Electroplated Zinc
- ▶ Suitable for wet location when used with gasket and cover



Cat. No.	Trade Size	DIMENSIONS - LR SERIES					Std. Pkg.
		A	B	C	D	E	
MLR-50	1/2"	1-3/8"	4"	2-1/16"	4-11/16"	1-7/16"	10
MLR-75	3/4"	1-9/16"	4-11/16"	2-1/4"	5-13/32"	1-21/32"	10
MLR-100	1"	1-13/16"	5-3/8"	2-11/16"	6-9/32"	2"	5
MLR-125	1-1/4"	2-1/2"	7-7/32"	3-3/8"	8-1/8"	2-19/32"	2
MLR-150	1-1/2"	2-1/2"	7-7/32"	3-7/16"	8-1/8"	2-13/16"	2
MLR-200	2"	3-5/32"	9-1/2"	4-1/8"	10-1/2"	3-1/2"	1
MLR-250	2-1/2"	4-7/16"	12-1/4"	5-27/32"	13-3/4"	4"	1
MLR-300	3"	4-7/16"	12-1/4"	5-29/32"	13-13/16"	4-21/32"	1
MLR-350	3-1/2"	5-1/2"	15"	7-1/8"	16-5/8"	5-7/16"	1
MLR-400	4"	5-1/2"	15"	7-3/16"	16-5/8"	5-3/4"	1

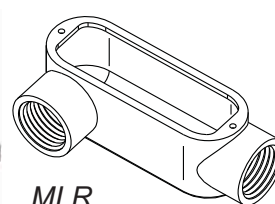

MLR

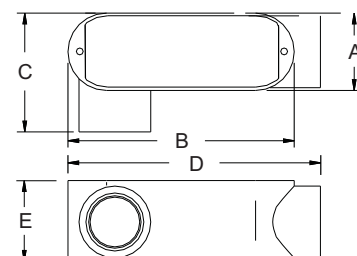

## MALLEABLE IRON THREADED CONDUIT BODIES "C" SERIES

### PRODUCT FEATURES

- ▶ Electroplated Zinc
- ▶ Suitable for wet location when used with gasket and cover



Cat. No.	Trade Size	DIMENSIONS - C SERIES				Std. Pkg.
		A	B	C	D	
MC-50	1/2"	1-3/8"	4"	1-1/2"	5-7/16"	10
MC-75	3/4"	1-9/16"	4-11/16"	1-21/32"	6-5/32"	10
MC-100	1"	1-13/16"	5-13/32"	2"	7-5/32"	5
MC-125	1-1/4"	2-1/2"	7-7/32"	2-19/32"	9-1/16"	2
MC-150	1-1/2"	2-1/2"	7-7/32"	2-13/16"	9-1/16"	2
MC-200	2"	3-5/32"	9-1/2"	3-1/2"	11-1/2"	1
MC-250	2-1/2"	4-7/16"	12-1/4"	4"	15-5/16"	1
MC-300	3"	4-7/16"	12-1/4"	4-5/8"	15-13/32"	1
MC-350	3-1/2"	5-1/2"	15"	5-7/16"	18-5/16"	1
MC-400	4"	5-1/2"	15"	5-3/4"	18-5/16"	1

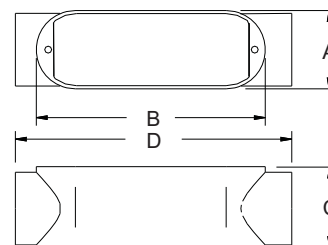
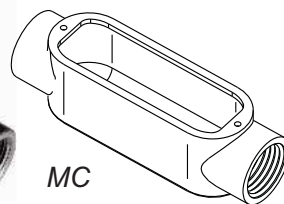

## MALLEABLE IRON THREADED CONDUIT BODIES "T" SERIES

### PRODUCT FEATURES

- ▶ Electroplated Zinc
- ▶ Suitable for wet location when used with gasket and cover



Cat. No.	Trade Size	DIMENSIONS - T SERIES					Std. Pkg.
		A	B	C	D	E	
MT-50	1/2"	1-3/8"	4"	2-1/16"	5-13/32"	1-7/16"	10
MT-75	3/4"	1-5/8"	4-21/32"	2-9/32"	6-5/32"	1-21/32"	10
MT-100	1"	1-13/16"	5-3/8"	2-21/32"	7-5/32"	2"	5
MT-125	1-1/4"	2-1/2"	7-7/32"	3-13/32"	9"	2-11/16"	2
MT-150	1-1/2"	2-1/2"	7-7/32"	3-7/16"	9-1/16"	2-13/16"	2
MT-200	2"	3-5/32"	9-1/2"	4-1/8"	11-1/2"	3-1/2"	1
MT-250	2-1/2"	4-7/16"	12-1/4"	5-27/32"	15-9/32"	4"	1
MT-300	3"	4-7/16"	12-1/4"	5-29/32"	15-13/32"	4-21/32"	1
MT-350	3-1/2"	5-1/2"	15"	7-1/8"	18-9/32"	5-7/16"	1
MT-400	4"	5-1/2"	15"	7-3/16"	18-9/32"	5-3/4"	1

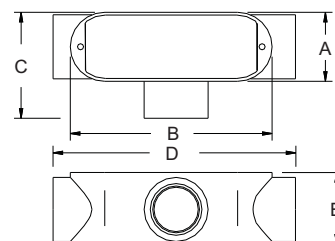
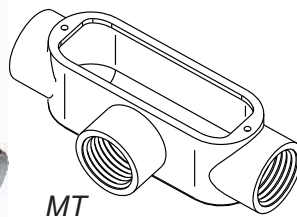

**COPPER-FREE  
ALUMINUM ALLOY  
EMT CONDUIT BODIES  
SET-SCREW TYPE  
"LB" SERIES**

**PRODUCT FEATURES**

- ▶ Plated Steel Set-Screws

Cat. No.	Trade Size	DIMENSIONS - LB SERIES					Std. Master Pkg. Ctn.	
		A	B	C	D	E		
SSLB-50	1/2"	1-5/16"	3-15/16"	2-1/16"	4-3/8"	1-1/16"	10	100
SSLB-75	3/4"	1-17/32"	4-5/8"	2-11/32"	5-1/8"	1-5/16"	10	50
SSLB-100	1"	1-25/32"	5-11/32"	2-7/8"	6"	1-9/16"	5	25
SSLB-125	1-1/4"	2-1/2"	7-1/4"	3-6/16"	7-11/16"	2"	2	10
SSLB-150	1-1/2"	2-1/2"	7-1/4"	3-9/16"	7-11/16"	2-1/4"	2	10
SSLB-200	2"	3-1/8"	9-1/2"	4-11/32"	10"	2-11/16"	1	5
SSLB-250	2-1/2"	4-7/16"	12-1/8"	5-3/16"	12-23/32"	3-3/8"	-	1
SSLB-300	3"	4-7/16"	12-1/8"	5-3/4"	12-23/32"	4"	-	1
SSLB-350	3-1/2"	5-15/32"	15-1/16"	7-1/16"	15-9/16"	5"	-	1
SSLB-400	4"	5-15/32"	15-1/16"	7-1/16"	15-9/16"	5"	-	1

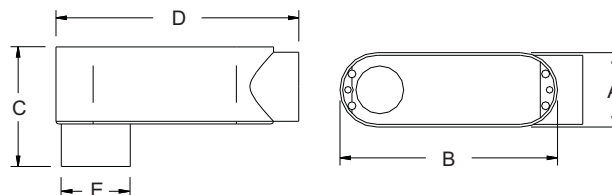

**COPPER-FREE  
ALUMINUM ALLOY  
EMT CONDUIT BODIES  
SET-SCREW TYPE  
"LR" SERIES**

**PRODUCT FEATURES**

- ▶ Plated Steel Set-Screws

Cat. No.	Trade Size	DIMENSIONS - LR SERIES					Std. Master Pkg. Ctn.	
		A	B	C	D	E		
SSLR-50	1/2"	1-5/16"	3-15/16"	2"	4-3/8"	1-5/16"	10	100
SSLR-75	3/4"	1-17/32"	4-5/8"	2-1/4"	5-1/8"	1-19/32"	10	50
SSLR-100	1"	1-25/32"	5-11/32"	2-23/32"	6"	1-29/32"	5	25
SSLR-125	1-1/4"	2-1/2"	7-1/4"	3-13/32"	7-11/16"	2-1/2"	2	10
SSLR-150	1-1/2"	2-1/2"	7-1/4"	3-13/32"	7-11/16"	2-11/16"	2	10
SSLR-200	2"	3-1/8"	9-1/2"	4-3/16"	10"	3-3/8"	1	5

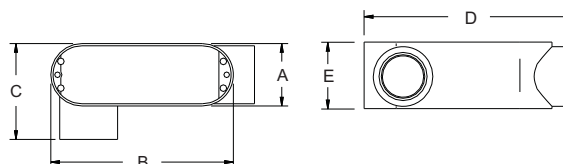

**COPPER-FREE  
ALUMINUM ALLOY  
EMT CONDUIT BODIES  
SET-SCREW TYPE  
"LL" SERIES**

**PRODUCT FEATURES**

- ▶ Plated Steel Set-Screws

Cat. No.	Trade Size	DIMENSIONS - LL SERIES					Std. Master Pkg. Ctn.	
		A	B	C	D	E		
SLL-50	1/2"	1-5/16"	3-15/16"	2"	4-3/8"	1-5/16"	10	100
SLL-75	3/4"	1-17/32"	4-5/8"	2-1/4"	5-1/8"	1-19/32"	10	50
SLL-100	1"	1-25/32"	5-11/32"	2-23/32"	6"	1-29/32"	5	25
SLL-125	1-1/4"	2-1/2"	7-1/4"	3-13/32"	7-11/16"	2-1/2"	2	10
SLL-150	1-1/2"	2-1/2"	7-1/4"	3-13/32"	7-11/16"	2-11/16"	2	10
SLL-200	2"	3-1/8"	9-1/2"	4-3/16"	10"	3-3/8"	1	5

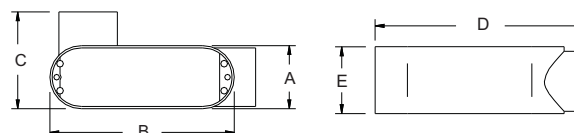



**COPPER-FREE  
ALUMINUM ALLOY  
EMT CONDUIT BODIES  
SET-SCREW TYPE  
"C" SERIES**

**PRODUCT FEATURES**

- ▶ Plated Steel Set-Screws

Cat. No.	Trade Size	DIMENSIONS - C SERIES					Std. Master Pkg. Ctn.	
		A	B	C	D	E		
SSC-50	1/2"	1-5/16"	3-15/16"	1-5/16"	4-3/4"	1-3/32"	10	100
SSC-75	3/4"	1-17/32"	4-5/8"	1-19/32"	5-5/8"	1-5/16"	10	50
SSC-100	1"	1-25/32"	5-11/32"	1-29/32"	6-21/32"	1-1/2"	5	25
SSC-125	1-1/4"	2-1/2"	7-1/4"	2-1/2"	8-3/32"	2"	2	10
SSC-150	1-1/2"	2-1/2"	7-1/4"	2-11/16"	8-3/32"	2-1/4"	2	10
SSC-200	2"	3-1/8"	9-1/2"	3-3/8"	10-17/32"	2-3/4"	1	5

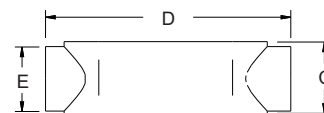
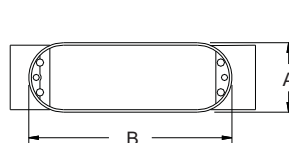

**COPPER-FREE  
ALUMINUM ALLOY  
EMT CONDUIT BODIES  
SET-SCREW TYPE  
"T" SERIES**

**PRODUCT FEATURES**

- ▶ Plated Steel Set-Screws

Cat. No.	Trade Size	DIMENSIONS - LL SERIES					Std. Master Pkg. Ctn.	
		A	B	C	D	E		
SST-50	1/2"	1-5/16"	3-15/16"	1-5/16"	4-3/4"	2"	10	100
SST-75	3/4"	1-17/32"	4-5/8"	1-19/32"	5-5/8"	2-1/4"	10	50
SST-100	1"	1-25/32"	5-11/32"	1-29/32"	6-21/32"	2-23/32"	5	25
SST-125	1-1/4"	2-1/2"	7-1/4"	2-7/16"	8-3/32"	3-13/32"	2	10
SST-150	1-1/2"	2-1/2"	7-1/4"	2-11/16"	8-3/32"	3-13/32"	2	10
SST-200	2"	3-1/8"	9-1/2"	3-3/8"	10-17/32"	4-3/16"	1	5

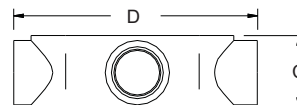
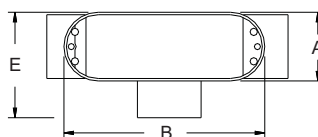

**DIE CAST COPPER-FREE  
ALUMINUM  
COVERS & NEOPRENE  
GASKETS**

**PRODUCT FEATURES**

- ▶ Gray color



Cat. No.	Trade Size	DIMENSION			Std. Pkg.
		L	W	H	
CG-50	1/2"	3-7/8"	1-5/16"	1/4"	100
CG-75	3/4"	4-11/16"	1-9/16"	1/4"	50
CG-100	1"	5-3/8"	1-3/4"	1/4"	50
CG-125/150	1-1/4" - 1-1/2"	7-5/16"	2-1/2"	1/4"	25
CG-200	2"	9-1/2"	3-1/8"	5/16"	10
CG-250/300	2-1/2" - 3"	12-1/16"	4-7/16"	3/8"	10
CG-350/400	3-1/2" - 4"	15-1/16"	5-9/16"	3/8"	5

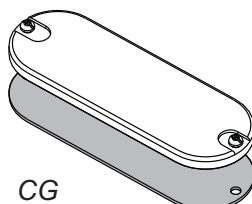

CG

## STEEL

### RAISED DOME COVERS

#### PRODUCT FEATURES

- ▶ Stamped Steel
- ▶ Stainless Steel Screws
- ▶ Gasket Not Included



Cat. No.	Trade Size	DIMENSIONS			Std. Pkg.
		L	W	H	
SC-50	1/2"	4"	1-3/8"	1/4"	100
SC-75	3/4"	4-11/16"	1-9/16"	5/16"	50
SC-100	1"	5-3/8"	1-13/16"	3/8"	50
SC-125/150	1-1/4" - 1-1/2"	7-1/4"	2-1/2"	13/32"	25
SC-200	2"	9-1/2"	3-1/8"	1/2"	10
SC-250/300	2-1/2" - 3"	12-1/4"	4-7/16"	3/4"	10
SC-350/400	3-1/2" - 4"	15"	5-1/2"	3/4"	5

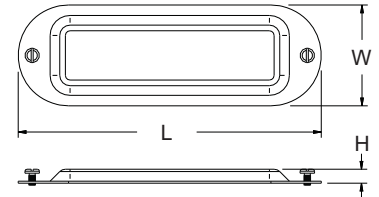
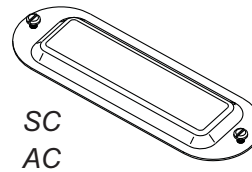

## ALUMINUM

### CONDUIT COVERS

#### PRODUCT FEATURES

- ▶ Stamped Aluminum



Cat. No.	Trade Size	DIMENSIONS			Std. Pkg.
		L	W	H	
AC-50	1/2"	3-15/16"	1-3/8"	1/4"	100
AC-75	3/4"	4-11/16"	1-1/2"	5/16"	50
AC-100	1"	5-3/8"	1-3/4"	3/8"	50
AC-125/150	1-1/4" - 1-1/2"	7-1/4"	2-1/2"	7/16"	25
AC-200	2"	9-1/2"	3-1/8"	1/2"	10
AC-250/300	2-1/2" - 3"	12-1/4"	4-7/16"	3/4"	10
AC-350/400	3-1/2" - 4"	15"	5-1/2"	3/4"	5



## NEOPRENE GASKETS

#### PRODUCT FEATURES

- ▶ For use with Cast Aluminum & Malleable Iron Conduit Bodies
- ▶ Available in Black color



Cat. No.	Trade Size	DIMENSION			Std. Pkg.
		L	W	H	
G-50	1/2"	3-11/16"	1-3/8"	1/16"	100
G-75	3/4"	4-1/4"	1-1/2"	1/16"	100
G-100	1"	5"	1-3/4"	1/16"	50
G-125/150	1-1/4" - 1-1/2"	6"	2-7/16"	1/16"	50
G-200	2"	7"	3"	1/16"	50
G-250/300	2-1/2" - 3"	9"	4-1/4"	1/16"	25
G-350/400	3-1/2" - 4"	11"	5-1/4"	1/16"	25

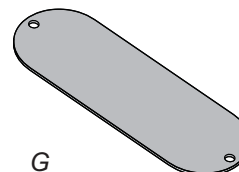

G



**SAND CAST CLASS 30  
GRAY IRON ALLOY  
THREADED CONDUIT BODIES  
"LB" SERIES  
FORM 7**

**PRODUCT FEATURES**

- ▶ Zinc electroplated
- ▶ Flat back design for maximum internal wiring volume
- ▶ Interchangeable with other Form 7 conduit bodies
- ▶ Suitable for wet location when used with gasket and cover
- ▶ Use with easy clip-on covers

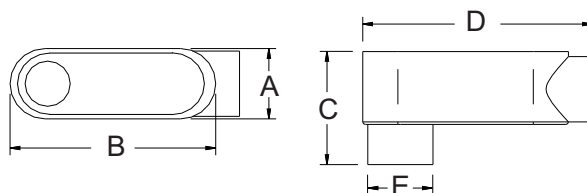

Cat. No.	Trade Size	DIMENSIONS - LB SERIES					Std. Master Pkg. Ctn.	
		A	B	C	D	E		
LB7-50	1/2"	1-7/20"	3-2/3"	2-1/5"	4-1/2"	1-4/17"	10	50
LB7-75	3/4"	1-13/20"	4-7/24"	2-1/2"	5-1/5"	1-1/2"	5	25
LB7-100	1"	1-4/5"	5-1/23"	2-17/20"	6-1/6"	1-19/24"	5	25
LB7-125	1-1/4"	2-1/5"	5-4/7"	3-6/25"	6-1/2"	2-3/14"	1	10
LB7-150	1-1/2"	2-9/20"	6-1/18"	3-13/25"	7-1/11"	2-11/24"	1	10
LB7-200	2"	3"	7-1/13"	4-1/7"	8-1/9"	3"	1	5
LB7-250	2-1/2"	4-1/4"	9-1/18"	5-6/25"	10-5/7"	3-9/20"	-	1
LB7-300	3"	4-1/4"	9-1/18"	6"	10-5/7"	4-1/4"	-	1
LB7-350	3-1/2"	5-3/10"	11"	6-11/19"	12-4/5"	4-3/4"	-	1
LB7-400	4"	5-3/10"	11"	7-1/10"	12-4/5"	5-4/15"	-	1

**SAND CAST CLASS 30  
GRAY IRON ALLOY  
THREADED CONDUIT BODIES  
"LR" SERIES  
FORM 7**

**PRODUCT FEATURES**

- ▶ Zinc electroplated
- ▶ Flat back design for maximum internal wiring volume
- ▶ Interchangeable with other Form 7 conduit bodies
- ▶ Suitable for wet location when used with gasket and cover
- ▶ Use with easy clip-on covers

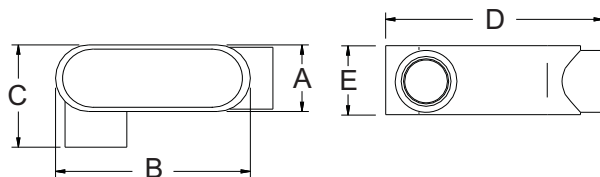

Cat. No.	Trade Size	DIMENSIONS - LR SERIES					Std. Master Pkg. Ctn.	
		A	B	C	D	E		
LR7-50	1/2"	1-6/13"	3-2/3"	1-9/20"	4-1/2"	1-2/5"	10	50
LR7-75	3/4"	1-17/26"	4-7/24"	2-1/2"	5-1/5"	1-13/20"	5	25
LR7-100	1"	1-18/23"	5-1/25"	2-4/5"	6-1/6"	1-4/5"	5	25
LR7-125	1-1/4"	2-3/14"	5-4/7"	3-1/7"	6-1/2"	2-1/5"	1	10
LR7-150	1-1/2"	2-9/20"	6-1/18"	3-2/5"	7-1/11"	2-9/20"	1	10
LR7-200	2"	3"	7-1/13"	4"	8-1/9"	3"	1	5
LR7-250	2-1/2"	4-1/4"	9-1/18"	5-17/20"	10-5/7"	4-1/4"	-	1
LR7-300	3"	4-1/4"	9-1/18"	5-17/20"	10-5/7"	4-1/4"	-	1
LR7-350	3-1/2"	5-3/10"	11"	7"	12-4/5"	5-3/10"	-	1
LR7-400	4"	5-3/10"	11"	7"	12-4/5"	5-3/10"	-	1

**SAND CAST CLASS 30  
GRAY IRON ALLOY  
THREADED CONDUIT BODIES  
"LL" SERIES  
FORM 7**

**PRODUCT FEATURES**

- ▶ Zinc electroplated
- ▶ Flat back design for maximum internal wiring volume
- ▶ Interchangeable with other Form 7 conduit bodies
- ▶ Suitable for wet location when used with gasket and cover
- ▶ Use with easy clip-on covers

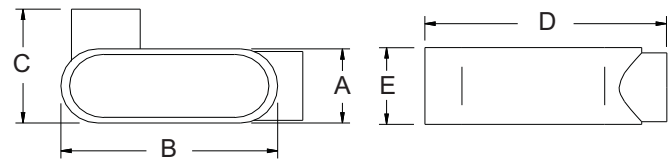

Cat. No.	Trade Size	DIMENSIONS - LL SERIES					Std. Master Pkg. Ctn.	
		A	B	C	D	E		
LL7-50	1/2"	1-6/13"	3-2/3"	1-9/20"	4-1/2"	1-2/5"	10	50
LL7-75	3/4"	1-17/26"	4-7/24"	2-1/2"	5-1/5"	1-13/20"	5	25
LL7-100	1"	1-18/23"	5-1/25"	2-4/5"	6-1/6"	1-4/5"	5	25
LL7-125	1-1/4"	2-3/14"	5-4/7"	3-1/7"	6-1/2"	2-1/5"	1	10
LL7-150	1-1/2"	2-9/20"	6-1/18"	3-2/5"	7-1/11"	2-9/20"	1	10
LL7-200	2"	3"	7-1/13"	4"	8-1/9"	3"	1	5
LL7-250	2-1/2"	4-1/4"	9-1/18"	5-17/20"	10-5/7"	4-1/4"	-	1
LL7-300	3"	4-1/4"	9-1/18"	5-17/20"	10-5/7"	4-1/4"	-	1
LL7-350	3-1/2"	5-3/10"	11"	7"	12-4/5"	5-3/10"	-	1
LL7-400	4"	5-3/10"	11"	7"	12-4/5"	5-3/10"	-	1

Electrical Fittings

**SAND CAST CLASS 30  
GRAY IRON ALLOY  
THREADED CONDUIT BODIES  
"C" SERIES  
FORM 7**

**PRODUCT FEATURES**

- ▶ Zinc electroplated
- ▶ Flat back design for maximum internal wiring volume
- ▶ Interchangeable with other Form 7 conduit bodies
- ▶ Suitable for wet location when used with gasket and cover
- ▶ Use with easy clip-on covers

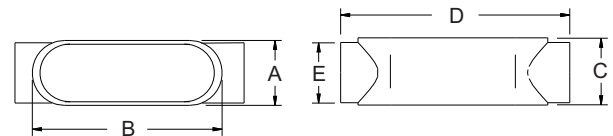

Cat. No.	Trade Size	DIMENSIONS - C SERIES					Std. Master Pkg. Ctn.	
		A	B	C	D	E		
C7-50	1/2"	1-7/20"	3-2/3"	1-2/5"	5-3/10"	1-1/5"	10	50
C7-75	3/4"	1-13/20"	4-7/24"	1-13/20"	6-4/25"	1-1/2"	5	25
C7-100	1"	1-4/5"	5-1/25"	1-4/5"	7-3/10"	1-18/23"	5	25
C7-125	1-1/4"	2-1/5"	5-4/7"	2-1/5"	7-3/7"	2-3/14"	1	10
C7-150	1-1/2"	2-9/20"	6-1/18"	2-9/20"	8-4/25"	2-9/20"	1	10
C7-200	2"	3"	7-1/13"	3"	9-3/23"	3"	1	5
C7-250	2-1/2"	4-1/4"	9-1/18"	4-1/4"	12-9/25"	3-9/20"	-	1
C7-300	3"	4-1/4"	9-1/18"	4-1/4"	12-9/25"	4-1/4"	-	1

**SAND CAST CLASS 30  
GRAY IRON ALLOY  
THREADED CONDUIT BODIES  
"T" SERIES  
FORM 7**

**PRODUCT FEATURES**

- ▶ Zinc electroplated
- ▶ Flat back design for maximum internal wiring volume
- ▶ Interchangeable with other Form 7 conduit bodies
- ▶ Suitable for wet location when used with gasket and cover
- ▶ Use with easy clip-on covers

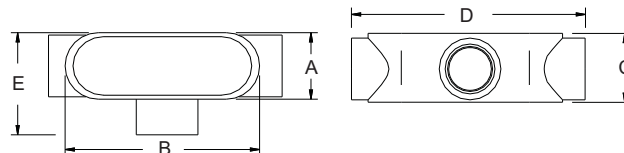

Cat. No.	Trade Size	DIMENSIONS - T SERIES					Std. Master Pkg. Ctn.	
		A	B	C	D	E		
T7-50	1/2"	1-3/5"	3-2/3"	1-3/4"	5-3/10"	2-12/25"	5	50
T7-75	3/4"	1-9/11"	4-7/24"	2"	6-4/25"	2-18/25"	5	25
T7-100	1"	2"	5-1/25"	2-7/25"	7-3/10"	3"	2	20
T7-125	1-1/4"	2-3/14"	5-4/7"	2-3/10"	7-3/7"	3-1/7"	1	10
T7-150	1-1/2"	2-9/20"	6-1/18"	2-3/5"	8-4/25"	3-2/5"	1	10
T7-200	2"	3"	7-1/13"	3-1/7"	9-3/23"	4"	1	5
T7-250	2-1/2"	4-1/4"	9-1/18"	3-16/25"	12-9/25"	5-17/20"	-	1
T7-300	3"	4-1/4"	9-1/18"	4-9/20"	12-9/25"	5-17/20"	-	1
T7-350	3-1/2"	5-3/10"	11"	4-23/25"	14-1/2"	7"	-	1
T7-400	4"	5-3/10"	11"	4-23/25"	14-1/2"	7"	-	1

**STAMPED STEEL  
WEDGENUT COVERS  
WITH INTEGRAL GASKETS  
FORM 7**

**PRODUCT FEATURES**

- ▶ Zinc electroplated
- ▶ Usable with all other Form 7 conduit bodies
- ▶ Integral sealing gaskets
- ▶ Easy installation and removal

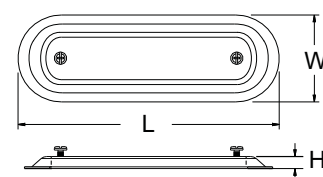

Cat. No.	Trade Size				Std. Master Pkg. Ctn.	
		L	W	H		
SCG7-50	1/2"	3-2/3"	1-9/26"	2/7"	50	250
SCG7-75	3/4"	4-7/24"	1-5/9"	2/7"	50	250
SCG7-100	1"	5-1/25"	1-18/23"	2/7"	25	200
SCG7-125	1-1/4"	5-4/7"	2-5/27"	2/7"	20	100
SCG7-150	1-1/2"	6-1/18"	2-9/20"	2/7"	20	100
SCG7-200	2"	7-1/13"	3"	2/7"	10	50
SCG7-250/300	2-1/2" - 3"	9-1/18"	4-1/4"	1/2"	-	10
SCG7-350/400	3-1/2" - 4"	11"	5-3/10"	1/2"	-	10

**GRAY IRON  
WEDGENUT COVERS  
WITH INTEGRAL GASKETS  
FORM 7**

**PRODUCT FEATURES**

- ▶ Zinc electroplated
- ▶ Usable with all other Form 7 conduit bodies
- ▶ Integral sealing gaskets
- ▶ Easy installation and removal



Cat. No.	Trade Size	L	W	H	Std. Pkg.	Master Ctn.
GICG7-50	1/2"	3-2/3"	1-9/26"	5/9"	25	125
GICG7-75	3/4"	4-7/24"	1-5/9"	5/9"	25	125
GICG7-100	1"	5-1/25"	1-18/23"	9/14"	10	100
GICG7-125	1-1/4"	5-4/7"	2-5/27"	2/3"	10	50
GICG7-150	1-1/2"	6-1/18"	2-1/3"	2/3"	10	50
GICG7-200	2"	7-1/13"	3"	3/4"	-	10
GICG7-250/300	2-1/2" - 3"	9-1/18"	4-1/4"	3/4"	-	10
GICG7-350/400	3-1/2" - 4"	11"	5-1/3"	5/6"	-	10

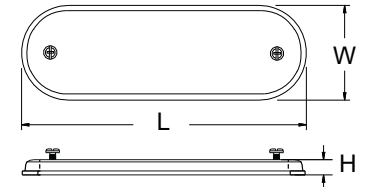

**SAND CAST CLASS 30  
GRAY IRON ALLOY  
THREADED CONDUIT BODIES  
"LB" SERIES  
FORM 8**

**PRODUCT FEATURES**

- ▶ Zinc electroplated
- ▶ Flat back design for maximum internal wiring volume
- ▶ Interchangeable with other Form 8 conduit bodies
- ▶ Suitable for wet location when used with gasket and cover



Cat. No.	Trade Size	DIMENSIONS - LB SERIES					Std. Master Pkg. Ctn.	
		A	B	C	D	E		
LB8-50	1/2"	1-6/13"	4-8/29"	2-3/11"	5-1/8"	1-1/4"	10	50
LB8-75	3/4"	1-13/20"	4-9/10"	2-15/28"	5-4/5"	1-1/2"	5	25
LB8-100	1"	1-17/20"	5-5/8"	2-9/10"	6-3/5"	1-3/4"	5	25
LB8-125	1-1/4"	2-6/25"	6-2/3"	3-1/4"	7-3/4"	2-1/5"	1	10
LB8-150	1-1/2"	2-22/27"	7-15/16"	3-2/3"	9-1/6"	2-9/20"	1	10
LB8-200	2"	3-9/11"	9-4/5"	4-2/3"	11-2/25"	2-9/10"	1	5
LB8-250	2-1/2"	5-1/17"	12-1/3"	6-3/20"	14-3/10"	3-9/26"	-	1
LB8-300	3"	5-1/17"	12-1/3"	6-5/27"	14-3/10"	4-1/10"	-	1
LB8-350	3-1/2"	6-3/10"	15-1/10"	7-1/5"	16-9/10"	4-3/5"	-	1
LB8-400	4"	6-3/10"	15-1/10"	7-1/4"	16-13/15"	5-1/4"	-	1

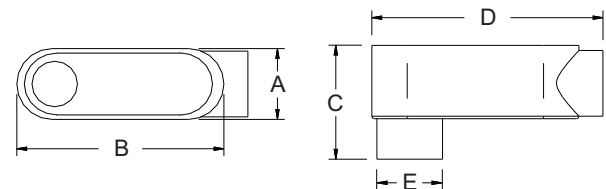

**SAND CAST CLASS 30  
GRAY IRON ALLOY  
THREADED CONDUIT BODIES  
"LR" SERIES  
FORM 8**

**PRODUCT FEATURES**

- ▶ Zinc electroplated
- ▶ Flat back design for maximum internal wiring volume
- ▶ Interchangeable with other Form 8 conduit bodies
- ▶ Suitable for wet location when used with gasket and cover

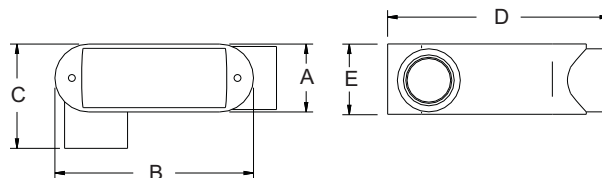

Cat. No.	Trade Size	DIMENSIONS - LR SERIES					Std. Pkg.	Master Ctn.
		A	B	C	D	E		
LR8-50	1/2"	1-6/13"	4-8/29"	2-6/25"	5-1/8"	1-9/20"	10	50
LR8-75	3/4"	1-13/20"	4-9/10"	2-9/20"	5-4/5"	1-7/10"	5	25
LR8-100	1"	1-17/20"	5-5/8"	2-19/25"	6-3/5"	2"	5	25
LR8-125	1-1/4"	2-6/25"	6-2/3"	3-1/6"	7-3/4"	2-3/10"	1	10
LR8-150	1-1/2"	2-22/27"	7-15/16"	3-4/5"	9-1/16"	2-2/3"	1	10
LR8-200	2"	3-9/11"	9-4/5"	4-13/14"	11-1/13"	3-13/23"	1	5
LR8-250	2-1/2"	5-1/17"	12-1/3"	6-17/26"	14-3/10"	4-11/20"	-	1
LR8-300	3"	5-1/17"	12-1/3"	6-17/26"	14-3/10"	4-11/20"	-	1

**SAND CAST CLASS 30  
GRAY IRON ALLOY  
THREADED CONDUIT BODIES  
"LL" SERIES  
FORM 8**

**PRODUCT FEATURES**

- ▶ Zinc electroplated
- ▶ Flat back design for maximum internal wiring volume
- ▶ Interchangeable with other Form 8 conduit bodies
- ▶ Suitable for wet location when used with gasket and cover

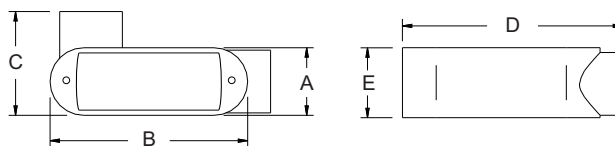

Cat. No.	Trade Size	DIMENSIONS - LL SERIES					Std. Pkg.	Master Ctn.
		A	B	C	D	E		
LL8-50	1/2"	1-6/13"	4-8/29"	2-6/25"	5-1/8"	1-9/20"	10	50
LL8-75	3/4"	1-13/20"	4-9/10"	2-9/20"	5-4/5"	1-7/10"	5	25
LL8-100	1"	1-17/20"	5-5/8"	2-19/25"	6-3/5"	2"	5	25
LL8-125	1-1/4"	2-6/25"	6-2/3"	3-1/6"	7-3/4"	2-3/10"	1	10
LL8-150	1-1/2"	2-22/27"	7-15/16"	3-4/5"	9-1/16"	2-2/3"	1	10
LL8-200	2"	3-9/11"	9-4/5"	4-13/14"	11-1/13"	3-13/23"	1	5
LL8-250	2-1/2"	5-1/17"	12-1/3"	6-17/26"	14-3/10"	4-11/20"	-	1
LL8-300	3"	5-1/17"	12-1/3"	6-17/26"	14-3/10"	4-11/20"	-	1



**SAND CAST CLASS 30  
GRAY IRON ALLOY  
THREADED CONDUIT BODIES  
"C" SERIES  
FORM 8**

**PRODUCT FEATURES**

- ▶ Zinc electroplated
- ▶ Flat back design for maximum internal wiring volume
- ▶ Interchangeable with other Form 8 conduit bodies
- ▶ Suitable for wet location when used with gasket and cover



Cat. No.	Trade Size	DIMENSIONS - C SERIES					Std. Master Pkg. Ctn.	
		A	B	C	D	E		
C8-50	1/2"	1-6/13"	4-8/29"	1-9/20"	6"	1-1/4"	10	50
C8-75	3/4"	1-13/20"	4-9/10"	1-7/10"	6-2/3"	1-1/2"	5	25
C8-100	1"	1-17/20"	5-5/8"	2"	7-11/20"	1-3/4"	5	25
C8-125	1-1/4"	2-6/25"	6-2/3"	2-3/10"	8-4/5"	2-1/5"	1	10
C8-150	1-1/2"	2-22/27"	7-15/16"	2-2/3"	10-1/5"	2-3/7"	1	10
C8-200	2"	3-9/11"	9-4/5"	3-13/23"	12-7/19"	2-9/10"	1	5
C8-250	2-1/2"	5-1/17"	12-1/3"	4-11/20"	16-8/35"	3-9/26"	-	1
C8-300	3"	5-1/17"	12-1/3"	4-11/20"	16-8/35"	4-1/11"	-	1

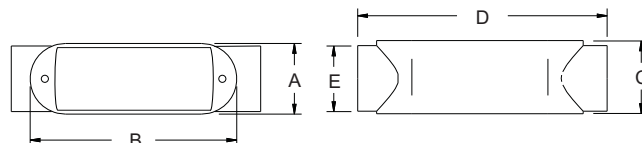

**SAND CAST CLASS 30  
GRAY IRON ALLOY  
THREADED CONDUIT BODIES  
"T" SERIES  
FORM 8**

**PRODUCT FEATURES**

- ▶ Zinc electroplated
- ▶ Flat back design for maximum internal wiring volume
- ▶ Interchangeable with other Form 8 conduit bodies
- ▶ Suitable for wet location when used with gasket and cover



Cat. No.	Trade Size	DIMENSIONS - T SERIES					Std. Master Pkg. Ctn.	
		A	B	C	D	E		
T8-50	1/2"	1-9/20"	4-8/29"	1-3/4"	6"	2-1/4"	5	25
T8-75	3/4"	1-13/20"	4-9/10"	2"	6-2/3"	2-9/20"	5	25
T8-100	1"	1-17/20"	5-5/8"	2-3/11"	7-11/20"	2-3/4"	2	20
T8-125	1-1/4"	2-6/25"	6-2/3"	2-3/10"	8-4/5"	3-1/6"	1	10
T8-150	1-1/2"	2-22/27"	7-15/16"	2-2/3"	10-1/5"	3-4/5"	1	10
T8-200	2"	3-9/11"	9-4/5"	3-14/25"	12-7/20"	4-13/14"	1	5
T8-250	2-1/2"	5-1/17"	12-1/3"	4-11/20"	16-1/5"	6-17/26"	-	1
T8-300	3"	5-1/17"	12-1/3"	4-11/20"	16-1/5"	6-17/26"	-	1

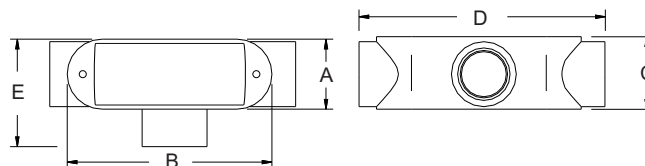

## STAMPED STEEL COVERS WITH INTEGRAL GASKETS FORM 8

### PRODUCT FEATURES

- ▶ Stainless Screws
- ▶ Zinc electroplated
- ▶ Integral sealing gaskets
- ▶ Usable with all other Form 8 conduit bodies



Cat. No.	Trade Size	L	W	H	Std. Pkg.
SCG8-50	1/2"	4-8/29"	1-9/20"	1/4"	50
SCG8-75	3/4"	4-15/17"	1-3/5"	1/4"	50
SCG8-100	1"	5-5/8"	1-17/20"	1/4"	25
SCG8-125	1-1/4"	6-3/5"	2-1/5"	1/4"	20
SCG8-150	1-1/2"	7-10/11"	2-3/4"	1/3"	20
SCG8-200	2"	9-3/4"	3-3/4"	2/5"	10
SCG8-250/300	2-1/2" - 3"	12-1/4"	5-1/23"	13/22"	5
SCG8-350/400	3-1/2" - 4"	15"	6-8/29"	17/24"	5

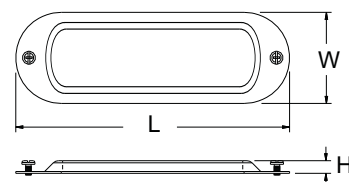

## GRAY IRON COVERS WITH INTEGRAL GASKETS FORM 8

### PRODUCT FEATURES

- ▶ Stainless Screws
- ▶ Zinc electroplated
- ▶ Integral sealing gaskets
- ▶ Usable with all other Form 8 conduit bodies



Cat. No.	Trade Size	L	W	H	Std. Pkg.
GICG8-50	1/2"	4-8/29"	1-9/20"	2/5"	50
GICG8-75	3/4"	4-15/17"	1-13/20"	2/5"	50
GICG8-100	1"	5-5/8"	1-17/20"	2/5"	25
GICG8-125	1-1/4"	6-9/13"	2-1/5"	9/16"	20
GICG8-150	1-1/2"	7-15/16"	2-22/27"	9/10"	20
GICG8-200	2"	9-7/9"	3-9/11"	1-1/8"	10
GICG8-250/300	2-1/2" - 3"	12-7/20"	5-1/18"	1-1/2"	5
GICG8-350/400	3-1/2" - 4"	15"	6-3/10"	1-1/2"	5

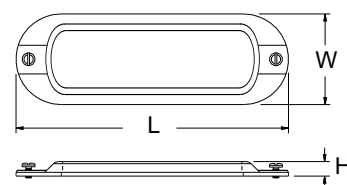

## MALLEABLE IRON

### 1-GANG CAST DEVICE BOXES DEAD END 2" DEEP

#### PRODUCT FEATURES

- ▶ Zinc electroplated
- ▶ Dead-end configurations
- ▶ For both outdoor and indoor use



Cat. No.	Trade Size	Std. Pkg.	Master Ctn.
1MFS-50	1/2"	1	5
1MFS-75	3/4"	1	5
1MFS-100	1"	1	5



## MALLEABLE IRON

### 1-GANG DEEP CAST DEVICE BOXES DEAD END 2-7/10" DEEP

#### PRODUCT FEATURES

- ▶ Zinc electroplated
- ▶ Dead-end configurations
- ▶ For both outdoor and indoor use



Cat. No.	Trade Size	Std. Pkg.	Master Ctn.
1MFD-50	1/2"	1	5
1MFD-75	3/4"	1	5
1MFD-100	1"	1	5



## MALLEABLE IRON

### 1-GANG CAST DEVICE BOXES FEED THROUGH 2" DEEP

#### PRODUCT FEATURES

- ▶ Zinc electroplated
- ▶ Feed Through configurations
- ▶ For both outdoor and indoor use



Cat. No.	Trade Size	Std. Pkg.	Master Ctn.
1MFSC-50	1/2"	1	5
1MFSC-75	3/4"	1	5
1MFSC-100	1"	1	5



## MALLEABLE IRON

### 1-GANG DEEP CAST DEVICE BOXES FEED THROUGH 2-7/10" DEEP

#### PRODUCT FEATURES

- ▶ Zinc electroplated
- ▶ Feed Through configurations
- ▶ For both outdoor and indoor use



Cat. No.	Trade Size	Std. Pkg.	Master Ctn.
1MFDC-50	1/2"	1	5
1MFDC-75	3/4"	1	5
1MFDC-100	1"	1	5



## MALLEABLE IRON

### 1-GANG CAST DEVICE BOX COVERS

#### PRODUCT FEATURES

- ▶ Zinc electroplated
- ▶ For use with FS&FD cast device box



Cat. No.	Description	Std. Pkg.
1MFC-B		20
1MFC-D	Duplex	20
1MFC-TS	Guarded Toggle Switch	20



## STEEL

### 1-GANG CAST DEVICE BOX COVERS

#### PRODUCT FEATURES

- ▶ Zinc electroplated
- ▶ For use with FS&FD cast device box

Cat. No.	Description	Std. Pkg.
1SFC-B		25
1SFC-D	Duplex	25
1SFC-TS	Unguarded Toggle Switch	25
1SFC-G	GFI	25



## NEOPRENE

### 1-GANG CAST DEVICE BOX GASKET

#### PRODUCT FEATURES

- ▶ For use with FS&FD cast device box

Cat. No.	Description	Std. Pkg.
FG-1	Neoprene Gasket	50





## MALLEABLE IRON CONDUIT CLAMPS EDGE TYPE

### PRODUCT FEATURES

- ▶ Electroplated Zinc



Cat. No.	Trade Size	Std. Pkg.
MCCE-50	1/2"	50
MCCE-75	3/4"	50
MCCE-100	1"	25
MCCE-125	1-1/4"	25
MCCE-150	1-1/2"	25
MCCE-200	2"	25
MCCE-250	2-1/2"	10
MCCE-300	3"	10



MCCE-50



MCCE-100

## MALLEABLE IRON CONDUIT CLAMPS RIGHT ANGLE TYPE

### PRODUCT FEATURES

- ▶ Electroplated Zinc



Cat. No.	Trade Size	Std. Pkg.
MCCR-50	1/2"	50
MCCR-75	3/4"	50
MCCR-100	1"	50
MCCR-125	1-1/4"	50
MCCR-150	1-1/2"	50
MCCR-200	2"	50
MCCR-250	2-1/2"	25
MCCR-300	3"	25
MCCR-350	3-1/2"	25
MCCR-400	4"	25



MCCR-50



MCCR-100

## MALLEABLE IRON CONDUIT CLAMPS PARALLEL TYPE

### PRODUCT FEATURES

- ▶ Electroplated Zinc



Cat. No.	Trade Size	Std. Pkg.
MCCP-50	1/2"	50
MCCP-75	3/4"	50
MCCP-100	1"	50
MCCP-125	1-1/4"	25
MCCP-150	1-1/2"	25
MCCP-200	2"	25
MCCP-250	2-1/2"	10
MCCP-300	3"	10
MCCP-350	3-1/2"	10
MCCP-400	4"	10



MCCP-50



MCCP-100





## STEEL

### U-BOLTS WITH HEX NUTS

#### PRODUCT FEATURES

- ▶ Electroplated Zinc



Cat. No.	Trade Size	Std. Pkg.	Master Ctn.
SUB-50	1/2"	25	250
SUB-75	3/4"	25	250
SUB-100	1"	25	250
SUB-125	1-1/4"	20	200
SUB-150	1-1/2"	20	200
SUB-200	2"	20	200
SUB-250	2-1/2"	-	10
SUB-300	3"	-	10
SUB-350	3-1/2"	-	10
SUB-400	4"	-	10

## MALLEABLE IRON

### 1-HOLE RIGID STRAPS

#### PRODUCT FEATURES

- ▶ Electroplated Zinc



Cat. No.	Trade Size	Std. Pkg.	Master Ctn.
SRM1-50	1/2"	100	1000
SRM1-75	3/4"	50	500
SRM1-100	1"	25	250
SRM1-125	1-1/4"	20	200
SRM1-150	1-1/2"	10	100
SRM1-200	2"	10	50
SRM1-250	2-1/2"	-	25
SRM1-300	3"	-	25
SRM1-350	3-1/2"	-	10
SRM1-400	4"	-	10

## MALLEABLE IRON

### CLAMP BACK SPACERS



Cat. No.	Trade Size	Std. Pkg.	Master Ctn.
CBS-50	1/2"	25	250
CBS-75	3/4"	25	250
CBS-100	1"	25	250
CBS-125	1-1/4"	10	100
CBS-150	1-1/2"	10	100
CBS-200	2"	5	50
CBS-250	2-1/2"	-	25
CBS-300	3"	-	10
CBS-350	3-1/2"	-	10
CBS-400	4"	-	10

## MALLEABLE IRON

### BEAM CLAMPS

#### PRODUCT FEATURES

- ▶ Single Screw
- ▶ 2 Threaded Holes



Cat. No.	Description	Std. Pkg.	Master Ctn.
BCM-25	1/4"-20 Tap, 3/4" Jaw, 125 lb. Load	50	250
BCM-38	3/8"-16 Tap, 7/8" Jaw, 300 lb. Load	25	100
BCM-50	1/2"-13 Tap, 1" Jaw, 600 lb. Load	10	50

## STEEL BEAM CLAMPS

### PRODUCT FEATURES

- ▶ Single Screw
- ▶ 2 Threaded Holes



Cat. No.	Description	Std. Pkg.	Master Ctn.
BC-25	1/4"-20 Tap, 3/4" Jaw, 100 lb. Load	50	250
BC-38	3/8"-16 Tap, 7/8" Jaw, 200 lb. Load	25	100

## STEEL UNIVERSAL STRUT CLAMPS

### PRODUCT FEATURES

- ▶ Electroplated Zinc
- ▶ Listed for EMT, IMC and RIGID



Cat. No.	EMT/RIGID Size	Std. Pkg.
ST-50	1/2"	100
ST-75	3/4"	100
ST-100	1"	100
ST-125	1-1/4"	100
ST-150	1-1/2"	50
ST-200	2"	50
ST-250	2-1/2"	50
ST-300	3"	25
ST-350	3-1/2"	25
ST-400	4"	25

## STEEL SADDLE TYPE STRUT CLAMPS

### PRODUCT FEATURES

- ▶ Electroplated Zinc
- ▶ Single-Screw-Tight Clamping Action
- ▶ Wide Saddle Design



Cat. No.	EMT/RIGID Conduit Size	Std. Pkg.
STS-50	5/16" - 1/2"	100
STS-75	3/4"	100
STS-100	1"	100
STS-125	1-1/4"	50
STS-150	1-1/2"	50
STS-200	2"	50
STS-250	2-1/2"	25
STS-300	3"	25
STS-350	3-1/2"	25
STS-400	4"	25

## STEEL CONDUIT HANGERS WITH BOLTS

### PRODUCT FEATURES

- ▶ Electroplated Zinc



Cat. No.	Trade Size	EMT Size	Rigid Size	Std. Pkg.	Master Ctn.
PH-50B	#0B	1/2"	1/2" & 3/8"	50	500
PH-75B	#1B	3/4"	3/4"	50	500
PH-100B	#2B	1"	1"	25	250
PH-105B	#2-1/2B	1-1/4"	-	25	250
PH-125B	#3B	1-1/2"	1-1/4"	50	250
PH-150B	#4B	-	1-1/2"	50	250
PH-200B	#5B	2"	2"	20	100
PH-250B	#6B	2-1/2"	2-1/2"	10	50
PH-300B	#7B	3"	3"	10	50
PH-350B	#8B	3-1/2"	3-1/2"	10	50
PH-400B	#9B	4"	4"	5	25



## STAMPED STEEL 1-HOLE RG6U CABLE STRAP

### PRODUCT FEATURES

- ▶ Electroplated Zinc

Cat. No.	Description	Std. Pkg.	Master Ctn.
S1-25	RG6U (Coaxial Cable) 1-Hole Strap	100	1000



## STAMPED STEEL 1-HOLE MC(BX) CABLE STRAP

### PRODUCT FEATURES

- ▶ Electroplated Zinc
- ▶ Corrosion-resistant

Cat. No.	Description	Std. Pkg.	Master Ctn.
S1-38	12-2, 12-3, 10-2, 10-3 MC (BX) 1-Hole Strap	100	1000



## STAMPED STEEL 1-HOLE EMT STRAPS

### PRODUCT FEATURES

- ▶ Electroplated Zinc

### NOTES

- ▶ Sizes 2-1/2" to 4" are also listed for RIGID and IMC Conduits

Cat. No.	Description	Trade Size	Std. Pkg.	Master Ctn.
SE1-50	14GA, Heavy-Duty	1/2"	100	1000
SE1-75	14GA, Heavy-Duty	3/4"	100	1000
SE1-100	14GA, Heavy-Duty	1"	100	500
SE1-125	12GA, Heavy-Duty	1-1/4"	100	500
SE1-150	12GA, Heavy-Duty	1-1/2"	50	500
SE1-200	12GA, Heavy-Duty	2"	50	500
SU1-250	9GA, Heavy-Duty	2-1/2"	25	100
SU1-300	9GA, Heavy-Duty	3"	25	100
SU1-350	7GA, Heavy-Duty	3-1/2"	25	100
SU1-400	7GA, Heavy-Duty	4"	25	100



SE1-50L



SE1-50 to SE1-200



SU1-250 to SU1-400

## STAMPED STEEL 2-HOLE EMT STRAPS

### PRODUCT FEATURES

- ▶ Electroplated Zinc

### NOTES

- ▶ Sizes 2-1/2" to 4" are also listed for RIGID and IMC Conduits

Cat. No.	Description	Trade Size	Std. Pkg.	Master Ctn.
SE2-50	18GA, Heavy-Duty	1/2"	100	1000
SE2-75	18GA, Heavy-Duty	3/4"	100	1000
SE2-100	16GA, Heavy-Duty	1"	100	500
SE2-125	16GA, Heavy-Duty	1-1/4"	100	500
SE2-150	16GA, Heavy-Duty	1-1/2"	50	500
SE2-200	14GA, Heavy-Duty	2"	50	500
SU2-250	13GA, Heavy-Duty	2-1/2"	25	100
SU2-300	13GA, Heavy-Duty	3"	25	100
SU2-350	10GA, Heavy-Duty	3-1/2"	25	100
SU2-400	10GA, Heavy-Duty	4"	25	100



## STAMPED STEEL 1-HOLE RIGID STRAPS

### PRODUCT FEATURES

- ▶ Electroplated Zinc

### NOTES

- ▶ Sizes 2-1/2" to 4" are also listed for EMT and IMC Conduits



Cat. No.	Description	Trade Size	Std. Pkg.	Master Ctn.
SR1-50	14GA, Heavy-Duty	1/2"	100	1000
SR1-75	12GA, Heavy-Duty	3/4"	100	1000
SR1-100	12GA, Heavy-Duty	1"	100	500
SR1-125	12GA, Heavy-Duty	1-1/4"	100	500
SR1-150	10GA, Heavy-Duty	1-1/2"	50	500
SR1-200	10GA, Heavy-Duty	2"	50	500
SU1-250	9GA, Heavy-Duty	2-1/2"	25	100
SU1-300	9GA, Heavy-Duty	3"	25	100
SU1-350	7GA, Heavy-Duty	3-1/2"	25	100
SU1-400	7GA, Heavy-Duty	4"	25	100



## STAMPED STEEL 2-HOLE RIGID STRAPS

### PRODUCT FEATURES

- ▶ Electroplated Zinc

### NOTES

- ▶ Sizes 2-1/2" to 4" are also listed for EMT and IMC Conduits

Cat. No.	Description	Trade Size	Std. Pkg.	Master Ctn.
SR2-50	20GA, Heavy-Duty	1/2"	100	1000
SR2-75	20GA, Heavy-Duty	3/4"	100	1000
SR2-100	20GA, Heavy-Duty	1"	100	500
SR2-125	19GA, Heavy-Duty	1-1/4"	100	500
SR2-150	16GA, Heavy-Duty	1-1/2"	50	500
SR2-200	16GA, Heavy-Duty	2"	50	500
SU2-250	13GA, Heavy-Duty	2-1/2"	25	100
SU2-300	13GA, Heavy-Duty	3"	25	100
SU2-350	10GA, Heavy-Duty	3-1/2"	25	100
SU2-400	10GA, Heavy-Duty	4"	25	100



## MALLEABLE IRON 1-HOLE RIGID STRAPS



Cat. No.	Trade Size	Std. Pkg.	Master Ctn.
SRM1-50	1/2"	100	1000
SRM1-75	3/4"	50	500
SRM1-100	1"	25	250
SRM1-125	1-1/4"	20	200
SRM1-150	1-1/2"	10	100
SRM1-200	2"	10	50
SRM1-250	2-1/2"	-	25
SRM1-300	3"	-	25
SRM1-350	3-1/2"	-	10
SRM1-400	4"	-	10



## STAMPED STEEL 1-HOLE SERVICE ENTRANCE STRAPS

### PRODUCT FEATURES

- ▶ Corrosion-Resistant

Cat. No.	Description	Std. Pkg.	Master Ctn.
SES1-50	Three #8, #6, #4	100	500
SES1-75	Three #3, #2	100	500
SES1-100	Three #1, #1/0, #2/0	50	250
SES1-200	Three #3/0, #4/0	25	250



## STAMPED STEEL 2-HOLE SERVICE ENTRANCE STRAPS

### PRODUCT FEATURES

- ▶ Corrosion-Resistant

Cat. No.	Description	Std. Pkg.	Master Ctn.
SES2-50	Three #8, #6, #4	20	100
SES2-75	Three #3, #2	20	100
SES2-100	Three #1, #1/0, #2/0	20	100
SES2-200	Three #3/0, #4/0	20	100



## STAMPED STEEL NAIL STRAPS

### PRODUCT FEATURES

- ▶ Electroplated Zinc

### NOTES

- ▶ Varies according to sizes

Cat. No.	EMT Size	FLEX Size	Std. Pkg.	Master Ctn.
NS-50	1/2"	N/A	100	1000
NS-50/75	3/4"	1/2"	100	1000
NS-100	1"	3/4"	100	1000



## PRE-GALVANIZED STEEL STUD MOUNTING CABLE SUPPORT

### PRODUCT FEATURES

- ▶ Wood or Metal Stud
- ▶ Easy to Lock

Cat. No.	Description	Non-Metallic	MC/AC/BX	Std. Pkg.
CS-CJ6	Stud Mounting Cable Support with locking tab	Max. 6	Max. 4	100



**Space Saving Packaging!**





**COPPER-FREE ALUMINUM**  
**SERVICE ENTRANCE CAPS**  
**CLAMP TYPE**

Cat. No.	Trade Size	Std. Pkg.	Master Ctn.
EC-50	1/2"	15	90
EC-75	3/4"	10	60
EC-100	1"	7	42
EC-125	1-1/4"	5	30
EC-150	1-1/2"	4	24
EC-200	2"	4	8
EC-250	2-1/2"	1	3
EC-300	3"	1	3
EC-300L (Large Body)	3"	1	3
EC-350	3-1/2"	1	2
EC-400	4"	1	2



**HEAVY-DUTY PVC**  
**SERVICE ENTRANCE HEADS**

**PRODUCT FEATURES**

- ▶ Snap-on Covers

Cat. No.	Trade Size	Std. Pkg.	Master Ctn.
ECP-50	1/2"	5	10
ECP-75	3/4"	2	10
ECP-100	1"	2	10
ECP-125	1-1/4"	-	5
ECP-150	1-1/2"	2	10
ECP-200	2"	2	10



**HEAVY-DUTY PVC**  
**SERVICE ENTRANCE**  
**CABLE CAPS**

**PRODUCT FEATURES**

- ▶ Snap-on Covers

Cat. No.	Description	Std. Pkg.
ECCP-50	#8, #6, #4, #2	10
ECCP-100	#1/0, #2/0	10
ECCP-200	#3/0, #4/0	10



**HEAVY-DUTY PVC**  
**SILL PLATE**

Cat. No.	Description	Std. Pkg.	Master Ctn.
SPP	Fit (3) - #4 to (3) - #0, and 1" EMT	5	15





## ZINC DIE CAST WATERTIGHT HUBS

### PRODUCT FEATURES

- ▶ 105°C rated Throat Insulator

### NOTES

- ▶ Insulated color may vary



Cat. No.	Trade Size	Std. Pkg.	Master Ctn.
WH-50	1/2"	25	125
WH-75	3/4"	25	125
WH-100	1"	25	125
WH-125	1-1/4"	10	50
WH-150	1-1/2"	10	50
WH-200	2"	10	50
WH-250	2-1/2"	5	25
WH-300	3"	2	10
WH-350	3-1/2"	2	10
WH-400	4"	2	10



## ZINC DIE CAST GROUNDED WATERTIGHT HUBS

### PRODUCT FEATURES

- ▶ 105°C rated Throat Insulator
- ▶ Grounding Post & Screw

### NOTES

- ▶ Insulated color may vary



Cat. No.	Trade Size	Std. Pkg.	Master Ctn.
WHG-50	1/2"	25	125
WHG-75	3/4"	25	125
WHG-100	1"	25	125
WHG-125	1-1/4"	10	50
WHG-150	1-1/2"	10	50
WHG-200	2"	10	50
WHG-250	2-1/2"	5	25
WHG-300	3"	2	10
WHG-350	3-1/2"	2	10
WHG-400	4"	2	10



## MALLEABLE IRON GROUNDED WATERTIGHT HUBS

### PRODUCT FEATURES

- ▶ 105°C rated Throat Insulator
- ▶ Grounding Screw
- ▶ Zinc Electroplated

### NOTES

- ▶ Insulated color may vary



Cat. No.	Trade Size	Std. Pkg.	Master Ctn.
MWHG-50	1/2"	25	250
MWHG-75	3/4"	25	100
MWHG-100	1"	10	100
MWHG-125	1-1/4"	5	50
MWHG-150	1-1/2"	2	20
MWHG-200	2"	2	20
MWHG-250	2-1/2"	-	10
MWHG-300	3"	-	5
MWHG-350	3-1/2"	-	5
MWHG-400	4"	-	5



MWHG-50

MWHG-150





## DIE CAST ALUMINUM METER HUBS

### PRODUCT FEATURES

- ▶ Electroplated Zinc
- ▶ Rain-tight

Cat. No.	Trade Size	Std. Pkg.
AMH-100	1"	10
AMH-125	1-1/4"	10
AMH-150	1-1/2"	10
AMH-200	2"	10
AMH-250	2-1/2"	10



## STAMPED STEEL SNAP-IN KNOCKOUT SEALS

### PRODUCT FEATURES

- ▶ Electroplated Zinc
- ▶ Held by spring tension
- ▶ For capping unused knockout holes

Cat. No.	Trade Size	Std. Pkg.	Master Ctn.
KO-50	1/2"	100	1000
KO-75	3/4"	100	1000
KO-100	1"	100	500
KO-125	1-1/4"	50	100
KO-150	1-1/2"	-	50
KO-200	2"	-	25



## STAMPED STEEL THREE-PIECE KNOCKOUT SEALS

### PRODUCT FEATURES

- ▶ Electroplated Zinc
- ▶ For capping unused knockout holes
- ▶ Embossed for quick self centering
- ▶ Installed using the screw and back strap

Cat. No.	Trade Size	Std. Pkg.	Master Ctn.
KO3P-50	1/2"	100	500
KO3P-75	3/4"	50	500
KO3P-100	1"	25	500
KO3P-125	1-1/4"	25	250
KO3P-150	1-1/2"	10	300
KO3P-200	2"	10	300
KO3P-250	2-1/2"	10	100
KO3P-300	3"	10	100
KO3P-350	3-1/2"	10	100
KO3P-400	4"	10	100





## ZINC DIE CAST 3/4" OFFSET NIPPLES

### PRODUCT FEATURES

- Meets Federal Spec. A-A-50553



Cat. No.	Trade Size	Std. Pkg.	Master Ctn.
ON-50	1/2"	25	250
ON-75	3/4"	20	200
ON-100	1"	10	100
ON-125	1-1/4"	5	50
ON-150	1-1/2"	5	50
ON-200	2"	3	30

## ZINC DIE CAST 1" LONG CONDUIT CHASE NIPPLES

### PRODUCT FEATURES

- Meets Federal Spec. A-A-50553



Cat. No.	Trade Size	Std. Pkg.	Master Ctn.
CN-50L	1/2"	100	1000
CN-75L	3/4"	50	500
CN-100L	1"	25	250

## ZINC DIE CAST CONDUIT CHASE NIPPLES

### PRODUCT FEATURES

- Meets Federal Spec. A-A-50553



Cat. No.	Trade Size	Std. Pkg.	Master Ctn.
CN-50	1/2"	100	1000
CN-75	3/4"	100	1000
CN-100	1"	50	500
CN-125	1-1/4"	25	250
CN-150	1-1/2"	25	250
CN-200	2"	15	90

## ZINC DIE CAST INSULATED CONDUIT CHASE NIPPLES

### PRODUCT FEATURES

- With Insulated Throat
- Meets Federal Spec. A-A-50553

### NOTE

- Insulated color may vary



Cat. No.	Trade Size	Std. Pkg.	Master Ctn.
CNI-50	1/2"	100	1000
CNI-75	3/4"	100	1000
CNI-100	1"	50	500
CNI-125	1-1/4"	25	250
CNI-150	1-1/2"	25	250
CNI-200	2"	15	90
CNI-250	2-1/2"	2	10
CNI-300	3"	2	10
CNI-350	3-1/2"	-	5
CNI-400	4"	-	5

## ZINC DIE CAST BOX TO BOX CONNECTOR

### PRODUCT FEATURES

- Meets Federal Spec. A-A-50553



Cat. No.	Trade Size	Std. Pkg.	Master Ctn.
OF781	1/2"	100	500

## ZINC DIE CAST INSULATED BOX TO BOX CONNECTOR

### PRODUCT FEATURES

- With Insulated Throat
- Meets Federal Spec. A-A-50553

### NOTE

- Insulated color may vary



Cat. No.	Trade Size	Std. Pkg.	Master Ctn.
OF781-S	1/2"	100	500



## **GALVANIZED STEEL** **RIGID CONDUIT NIPPLES**

### **PRODUCT FEATURES**

- ▶ Meet UL 6 and ANSI C80.1
- ▶ NPT Thread



Cat. No.	Trade Size	Length	Std. Pkg.
RN-50-C	1/2"	1-1/8"	25
RN-50-150	1/2"	1-1/2"	25
RN-50-200	1/2"	2"	25
RN-50-250	1/2"	2-1/2"	25
RN-50-300	1/2"	3"	25
RN-50-350	1/2"	3-1/2"	25
RN-50-400	1/2"	4"	25
RN-50-500	1/2"	5"	25
RN-50-600	1/2"	6"	25
RN-50-800	1/2"	8"	25
RN-50-1000	1/2"	10"	25
RN-50-1200	1/2"	12"	25
RN-75-C	3/4"	1-3/8"	25
RN-75-150	3/4"	1-1/2"	25
RN-75-200	3/4"	2"	25
RN-75-250	3/4"	2-1/2"	25
RN-75-300	3/4"	3"	25
RN-75-350	3/4"	3-1/2"	25
RN-75-400	3/4"	4"	25
RN-75-500	3/4"	5"	25
RN-75-600	3/4"	6"	25
RN-75-800	3/4"	8"	25
RN-75-1000	3/4"	10"	25
RN-75-1200	3/4"	12"	25
RN-100-C	1"	1-1/2"	25
RN-100-200	1"	2"	25
RN-100-250	1"	2-1/2"	25
RN-100-300	1"	3"	25
RN-100-350	1"	3-1/2"	25
RN-100-400	1"	4"	25
RN-100-500	1"	5"	25
RN-100-600	1"	6"	25
RN-100-800	1"	8"	25
RN-100-1000	1"	10"	25
RN-100-1200	1"	12"	25
RN-125-C	1-1/4"	1-5/8"	25
RN-125-200	1-1/4"	2"	25
RN-125-250	1-1/4"	2-1/2"	25
RN-125-300	1-1/4"	3"	25
RN-125-350	1-1/4"	3-1/2"	25
RN-125-400	1-1/4"	4"	25
RN-125-500	1-1/4"	5"	25
RN-125-600	1-1/4"	6"	25
RN-125-800	1-1/4"	8"	25
RN-125-1000	1-1/4"	10"	25
RN-125-1200	1-1/4"	12"	25
RN-150-C	1-1/2"	1-3/4"	25
RN-150-200	1-1/2"	2"	25
RN-150-250	1-1/2"	2-1/2"	25
RN-150-300	1-1/2"	3"	25
RN-150-350	1-1/2"	3-1/2"	25
RN-150-400	1-1/2"	4"	25
RN-150-500	1-1/2"	5"	25
RN-150-600	1-1/2"	6"	25
RN-150-800	1-1/2"	8"	25
RN-150-1000	1-1/2"	10"	25
RN-150-1200	1-1/2"	12"	25
RN-200-C	2"	2"	25
RN-200-250	2"	2-1/2"	25
RN-200-300	2"	3"	25
RN-200-350	2"	3-1/2"	25



**GALVANIZED STEEL  
RIGID CONDUIT NIPPLES**
**PRODUCT FEATURES**

- ▶ Meet UL 6 and ANSI C80.1
- ▶ NPT Thread



Cat. No.	Trade Size	Length	Std. Pkg.
RN-200-400	2"	4"	25
RN-200-500	2"	5"	25
RN-200-600	2"	6"	25
RN-200-800	2"	8"	25
RN-200-1000	2"	10"	25
RN-200-1200	2"	12"	25
RN-250-C	2-1/2"	2-1/2"	30
RN-250-300	2-1/2"	3"	25
RN-250-350	2-1/2"	3-1/2"	15
RN-250-400	2-1/2"	4"	15
RN-250-500	2-1/2"	5"	15
RN-250-600	2-1/2"	6"	10
RN-250-800	2-1/2"	8"	5
RN-250-1000	2-1/2"	10"	5
RN-250-1200	2-1/2"	12"	5
RN-300-C	3"	2-5/8"	9
RN-300-300	3"	3"	9
RN-300-350	3"	3-1/2"	9
RN-300-400	3"	4"	9
RN-300-500	3"	5"	9
RN-300-600	3"	6"	9
RN-300-800	3"	8"	9
RN-300-1000	3"	10"	9
RN-300-1200	3"	12"	9
RN-350-C	3-1/2"	2-3/4"	9
RN-350-400	3-1/2"	4"	9
RN-350-500	3-1/2"	5"	9
RN-350-600	3-1/2"	6"	9
RN-350-800	3-1/2"	8"	9
RN-350-1000	3-1/2"	10"	9
RN-350-1200	3-1/2"	12"	9
RN-400-C	4"	2-7/8"	9
RN-400-400	4"	4"	9
RN-400-500	4"	5"	9
RN-400-600	4"	6"	9
RN-400-800	4"	8"	4
RN-400-1000	4"	10"	4
RN-400-1200	4"	12"	4
RN-500-C	5"	3"	4
RN-500-500	5"	5"	4
RN-500-600	5"	6"	4
RN-500-800	5"	8"	4
RN-500-1000	5"	10"	4
RN-500-1200	5"	12"	4
RN-600-C	6"	3-1/8"	4
RN-600-500	6"	5"	4
RN-600-600	6"	6"	4
RN-600-800	6"	8"	4
RN-600-1000	6"	10"	4
RN-600-1200	6"	12"	4

## **GALVANIZED STEEL** **22.5° ANGLE** **EMT CONDUIT ELBOWS**

### **PRODUCT FEATURES**

- Meet UL 797 and ANSI C80.3

Cat. No.	Trade Size	DIMENSIONS			Std. Pkg.
		Min. UL Radius (A)	Offset (B)	Straight Length (C)	
EEL22-50	1/2"	4"	1-5/16"	2-5/8"	50
EEL22-75	3/4"	4-1/2"	1-7/16"	2-3/4"	50
EEL22-100	1"	5-3/4"	1-9/16"	2-7/8"	25
EEL22-125	1-1/4"	7-1/4"	1-3/4"	3-1/16"	20
EEL22-150	1-1/2"	8-1/4"	2"	3-1/2"	15
EEL22-200	2"	9-1/2"	2-5/16"	4-1/8"	10
EEL22-250	2-1/2"	10-1/2"	2-3/4"	5-1/16"	BULK
EEL22-300	3"	13"	3-1/4"	5-15/16"	BULK
EEL22-350	3-1/2"	15"	3-11/16"	6-11/16"	BULK
EEL22-400	4"	16"	3-15/16"	7"	BULK

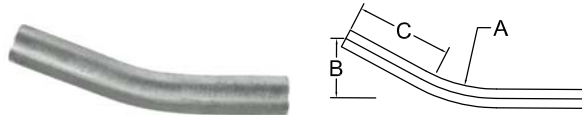

## **GALVANIZED STEEL** **45° ANGLE** **EMT CONDUIT ELBOWS**

### **PRODUCT FEATURES**

- Meet UL 797 and ANSI C80.3

Cat. No.	Trade Size	DIMENSIONS			Std. Pkg.
		Min. UL Radius (A)	Offset (B)	Straight Length (C)	
EEL45-50	1/2"	4"	3-1/16"	2-11/16"	50
EEL45-75	3/4"	4-1/2"	3-1/4"	2-3/4"	50
EEL45-100	1"	5-3/4"	3-13/16"	3"	25
EEL45-125	1-1/4"	7-1/4"	4-7/16"	3-1/4"	20
EEL45-150	1-1/2"	8-1/4"	4-15/16"	3-1/2"	15
EEL45-200	2"	9-1/2"	5-13/16"	4-5/16"	10
EEL45-250	2-1/2"	10-1/2"	6-11/16"	5-1/8"	BULK
EEL45-300	3"	13"	8-1/8"	6-1/8"	BULK
EEL45-350	3-1/2"	15"	9-3/16"	6-3/4"	BULK
EEL45-400	4"	16"	9-3/4"	7-1/16"	BULK



## **GALVANIZED STEEL** **90° ANGLE** **EMT CONDUIT ELBOWS**

### **PRODUCT FEATURES**

- Meet UL 797 and ANSI C80.3

Cat. No.	Trade Size	DIMENSIONS			Std. Pkg.
		Min. UL Radius (A)	Offset (B)	Straight Length (C)	
EEL90-50	1/2"	4"	6-7/8"	2-7/8"	50
EEL90-75	3/4"	4-1/2"	7-7/16"	2-15/16"	50
EEL90-100	1"	5-3/4"	8-3/4"	3"	25
EEL90-125	1-1/4"	7-1/4"	10-9/16"	3-5/16"	20
EEL90-150	1-1/2"	8-1/4"	11-15/16"	3-5/8"	15
EEL90-200	2"	9-1/2"	13-3/4"	4-1/4"	10
EEL90-250	2-1/2"	10-1/2"	15-3/4"	5-1/4"	BULK
EEL90-300	3"	13"	19-1/8"	6-1/8"	BULK
EEL90-350	3-1/2"	15"	21-3/4"	6-3/4"	BULK
EEL90-400	4"	16"	23-1/8"	7-1/8"	BULK

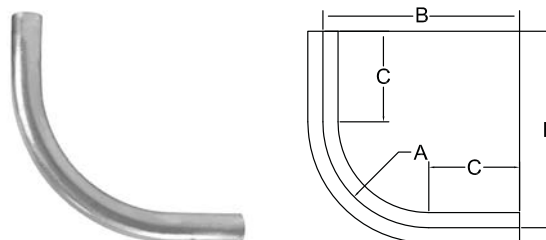



## GALVANIZED STEEL

### 22.5° ANGLE RIGID CONDUIT ELBOWS

#### PRODUCT FEATURES

- ▶ Meet UL 6 and ANSI C80.1
- ▶ NPT Thread

Cat. No.	Trade Size	DIMENSIONS			Std. Pkg.
		Min. UL Radius (A)	Offset (B)	Straight Length (C)	
REL22-50	1/2"	4"	1-5/16"	2-5/8"	50
REL22-75	3/4"	4-1/2"	1-7/16"	2-3/4"	50
REL22-100	1"	5-3/4"	1-9/16"	2-7/8"	25
REL22-125	1-1/4"	7-1/4"	1-3/4"	3-1/16"	20
REL22-150	1-1/2"	8-1/4"	2"	3-1/2"	15
REL22-200	2"	9-1/2"	2-5/16"	4-1/8"	10
REL22-250	2-1/2"	10-1/2"	2-3/4"	5-1/16"	BULK
REL22-300	3"	13"	3-1/4"	5-15/16"	BULK
REL22-350	3-1/2"	15"	3-11/16"	6-11/16"	BULK
REL22-400	4"	16"	3-15/16"	7"	BULK

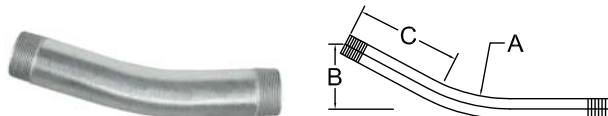

## GALVANIZED STEEL

### 45° ANGLE RIGID CONDUIT ELBOWS

#### PRODUCT FEATURES

- ▶ Meet UL 6 and ANSI C80.1
- ▶ NPT Thread

Cat. No.	Trade Size	DIMENSIONS			Std. Pkg.
		Min. UL Radius (A)	Offset (B)	Straight Length (C)	
REL45-50	1/2"	4"	3-1/16"	2-11/16"	50
REL45-75	3/4"	4-1/2"	3-1/4"	2-3/4"	50
REL45-100	1"	5-3/4"	3-13/16"	3"	25
REL45-125	1-1/4"	7-1/4"	4-7/16"	3-1/4"	20
REL45-150	1-1/2"	8-1/4"	4-15/16"	3-1/2"	15
REL45-200	2"	9-1/2"	5-13/16"	4-5/16"	10
REL45-250	2-1/2"	10-1/2"	6-11/16"	5-1/8"	BULK
REL45-300	3"	13"	8-1/8"	6-1/8"	BULK
REL45-350	3-1/2"	15"	9-3/16"	6-3/4"	BULK
REL45-400	4"	16"	9-3/4"	7-1/16"	BULK



## GALVANIZED STEEL

### 90° ANGLE RIGID CONDUIT ELBOWS

#### PRODUCT FEATURES

- ▶ Meet UL 6 and ANSI C80.1
- ▶ NPT Thread

Cat. No.	Trade Size	DIMENSIONS			Std. Pkg.
		Min. UL Radius (A)	Offset (B)	Straight Length (C)	
REL90-50	1/2"	4"	6-7/8"	2-7/8"	50
REL90-75	3/4"	4-1/2"	7-7/16"	2-15/16"	50
REL90-100	1"	5-3/4"	8-3/4"	3"	25
REL90-125	1-1/4"	7-1/4"	10-9/16"	3-5/16"	20
REL90-150	1-1/2"	8-1/4"	11-15/16"	3-5/8"	15
REL90-200	2"	9-1/2"	13-3/4"	4-1/4"	10
REL90-250	2-1/2"	10-1/2"	15-3/4"	5-1/4"	BULK
REL90-300	3"	13"	19-1/8"	6-1/8"	BULK
REL90-350	3-1/2"	15"	21-3/4"	6-3/4"	BULK
REL90-400	4"	16"	23-1/8"	7-1/8"	BULK

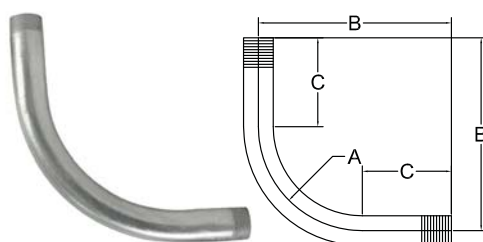

## MACHINED STEEL REDUCING BUSHINGS

### PRODUCT FEATURES

- ▶ Electroplated Zinc
- ▶ Meets Federal Spec. A-A-50553

Cat. No.	Trade Size	Std. Pkg.	Master Ctn.
RB-50/38	1/2" to 3/8"	100	500
RB-75/50	3/4" to 1/2"	100	500
RB-100/50	1" to 1/2"	50	250
RB-100/75	1" to 3/4"	50	250
RB-125/50	1-1/4" to 1/2"	20	100
RB-125/75	1-1/4" to 3/4"	20	100
RB-125/100	1-1/4" to 1"	20	100
RB-150/50	1-1/2" to 1/2"	10	50
RB-150/75	1-1/2" to 3/4"	10	50
RB-150/100	1-1/2" to 1"	10	50
RB-150/125	1-1/2" to 1-1/4"	10	50
RB-200/50	2" to 1/2"	10	50
RB-200/75	2" to 3/4"	10	50
RB-200/100	2" to 1"	10	50
RB-200/125	2" to 1-1/4"	10	50
RB-200/150	2" to 1-1/2"	10	50
RB-250/200*	2-1/2" to 2"	10	50
RB-300/200*	3" to 2"	10	50
RB-300/250*	3" to 2-1/2"	10	50
RB-350/250*	3-1/2" to 2-1/2"	5	20

\*Malleable Iron



## MALLEABLE IRON REDUCING BUSHINGS

### PRODUCT FEATURES

- ▶ Electroplated Zinc



Cat. No.	Trade Size	Std. Pkg.	Master Ctn.
MRB-350/300	3-1/2" to 3"	5	20
MRB-400/350	4" to 3-1/2"	5	20



## STEEL RIGID MALE ENLARGERS

### PRODUCT FEATURES

- ▶ Electroplated Zinc

Cat. No.	Male Size	Female Size	Std. Pkg.	Master Ctn.
SME-50/75	1/2"	3/4"	25	250
SME-75/100	3/4"	1"	10	100
SME-100/125	1"	1-1/4"	10	100



SME-50/75



SME-100/125

## PVC PLASTIC INSULATING BUSHINGS

### PRODUCT FEATURES

- ▶ 105°C Rated
- ▶ Meets Federal Spec. A-A-50553

### NOTE

- ▶ Color may vary

Cat. No.	Trade Size	Std. Pkg.	Master Ctn.
PB-50	1/2"	100	1000
PB-75	3/4"	100	1000
PB-100	1"	50	500
PB-125	1-1/4"	25	250
PB-150	1-1/2"	25	250
PB-200	2"	10	100
PB-250	2-1/2"	10	100
PB-300	3"	-	20
PB-350	3-1/2"	-	20
PB-400	4"	-	10
PB-500	5"	-	10
PB-600	6"	-	10





## ZINC DIE CAST CONDUIT BUSHINGS

### PRODUCT FEATURES

- ▶ Full Machine-Cut Internal Threads
- ▶ Meets Federal Spec. A-A-50553

Cat. No.	Trade Size	Std. Pkg.	Master Ctn.
CB-50	1/2"	100	1000
CB-75	3/4"	50	500
CB-100	1"	50	500
CB-125	1-1/4"	25	250
CB-150	1-1/2"	25	250
CB-200	2"	15	90
CB-250	2-1/2"	2	10
CB-300	3"	2	10
CB-350	3-1/2"	-	5
CB-400	4"	-	5



## ZINC DIE CAST CONDUIT BUSHINGS INSULATED

### PRODUCT FEATURES

- ▶ Full Machine-Cut Internal Threads
- ▶ Insulated Throat
- ▶ Meets Federal Spec. A-A-50553

### NOTE

- ▶ Insulated color may vary

Cat. No.	Trade Size	Std. Pkg.	Master Ctn.
CBI-50	1/2"	100	1000
CBI-75	3/4"	50	500
CBI-100	1"	50	500
CBI-125	1-1/4"	25	250
CBI-150	1-1/2"	25	250
CBI-200	2"	15	90
CBI-250	2-1/2"	2	10
CBI-300	3"	2	10
CBI-350	3-1/2"	-	5
CBI-400	4"	-	5



## MALLEABLE IRON INSULATED CONDUIT BUSHINGS

### PRODUCT FEATURES

- ▶ Zinc Electroplated
- ▶ 105°C rated insulated throat

### NOTE

- ▶ Insulated color may vary



Cat. No.	Trade Size	Std. Pkg.	Master Ctn.
MCBI-50	1/2"	100	1000
MCBI-75	3/4"	50	500
MCBI-100	1"	50	500
MCBI-125	1-1/4"	25	250
MCBI-150	1-1/2"	25	100
MCBI-200	2"	10	100
MCBI-250	2-1/2"	-	50
MCBI-300	3"	-	25
MCBI-350	3-1/2"	-	25
MCBI-400	4"	-	10
MCBI-500	5"	-	10
MCBI-600	6"	-	10



MCBI-75



MCBI-125





## ZINC DIE CAST GROUND BUSHINGS INSULATED WITH UNIVERSAL LAY-IN LUG

### PRODUCT FEATURES

- ▶ 105°C rated Throat Insulator



Cat. No.	Trade Size	Lug Range	Std. Pkg.	Master Ctn.
GBLL-50	1/2"	#14 - #4	50	500
GBLL-75	3/4"	#14 - #4	40	400
GBLL-100	1"	#14 - #4	15	150
GBLL-125	1-1/4"	#14 - #4	15	150
GBLL-125-10	1-1/4"	#14 - #1/0	20	200
GBLL-150	1-1/2"	#14 - #4	10	100
GBLL-150-10	1-1/2"	#14 - #1/0	10	100
GBLL-200	2"	#14 - #4	5	50
GBLL-200-10	2"	#14 - #1/0	10	100
GBLL-250	2-1/2"	#6 - #250MCM	5	50
GBLL-250-10	2-1/2"	#14 - #1/0	-	50
GBLL-300	3"	#6 - #250MCM	5	50
GBLL-300-10	3"	#14 - #1/0	-	50
GBLL-350	3-1/2"	#6 - #250MCM	4	40
GBLL-350-10	3-1/2"	#14 - #1/0	-	10
GBLL-400	4"	#6 - #250MCM	4	40
GBLL-400-10	4"	#14 - #1/0	-	10

## MALLEABLE IRON GROUND BUSHINGS INSULATED WITH UNIVERSAL LAY-IN LUG

### PRODUCT FEATURES

- ▶ 150°C rated Throat Insulator
- ▶ Full Machine-Cut Internal Threads
- ▶ Meets Federal Spec. A-A-50553



Cat. No.	Trade Size	Lug Range	Std. Pkg.	Master Ctn.
MGBLL-50	1/2"	#14 - #4	50	200
MGBLL-75	3/4"	#14 - #4	25	100
MGBLL-100	1"	#14 - #4	25	100
MGBLL-125	1-1/4"	#14 - #4	10	50
MGBLL-125-10	1-1/4"	#14 - #1/0	20	200
MGBLL-150	1-1/2"	#14 - #4	10	50
MGBLL-150-10	1-1/2"	#14 - #1/0	10	100
MGBLL-200	2"	#14 - #4	10	50
MGBLL-200-10	2"	#14 - #1/0	10	100
MGBLL-250	2-1/2"	#6 - #250MCM	5	25
MGBLL-250-10	2-1/2"	#14 - #1/0	-	50
MGBLL-300	3"	#6 - #250MCM	5	25
MGBLL-300-10	3"	#14 - #1/0	-	25
MGBLL-350	3-1/2"	#6 - #250MCM	-	5
MGBLL-350-10	3-1/2"	#14 - #1/0	-	10
MGBLL-400	4"	#6 - #250MCM	-	5
MGBLL-400-10	4"	#14 - #1/0	-	10
MGBLL-500	5"	#6 - #250MCM	-	5
MGBLL-500-30	5"	#6 - #3/0	-	5
MGBLL-600	6"	#6 - #250MCM	-	5
MGBLL-600-30	6"	#6 - #3/0	-	5



## PLASTIC EMT BUSHINGS

### PRODUCT FEATURES

- Protects wires from damage by sharp edges of EMT
- Size 2-1/2" to 4" can be also used for Rigid, IMC and PVC conduit

### NOTE

- Color may vary



Cat. No.	Trade Size	Std. Pkg.	Master Ctn.
TPB-50	1/2"	100	1000
TPB-75	3/4"	100	1000
TPB-100	1"	50	500
TPB-125	1-1/4"	25	250
TPB-150	1-1/2"	25	250
TPB-200	2"	10	100
TPB-250	2-1/2"	10	100
TPB-300	3"	-	20
TPB-350	3-1/2"	-	20
TPB-400	4"	-	10

## PLASTIC NON-METALLIC CABLE QUICK-LOCK CONNECTORS

### PRODUCT FEATURES

- Easy and fast installation
- Simply remove with screwdriver if necessary



PQLC-38



PQLC-75

Cat. No.	NM Cable Range	Trade Size	KO Size	Std. Pkg.	Master Ctn.
PQLC-38	14/2 - 10/3	3/8"	1/2"	100	1000
PQLC-75	14/3 - 6/3	3/4"	3/4"	50	500

## PLASTIC UNIVERSAL METAL STUD GROMMET

### PRODUCT FEATURES

- High Strength, non-conductive polypropylene
- Universal design fits into a standard 1" Trade Size hole and all factory-punched stud holes
- Lightweight material eases installation



Cat. No.	Description	Std. Pkg.
PUSG	Universal Snap-in type bushings for Metal Stud, fit all factory punched metal stud holes	100

### INSTALLATION INSTRUCTION:

- Step1:** Separate the two halves  
**Step2:** Snap the bushing end and the washer end together through the hole  
**Step3:** Install cable through the grommet

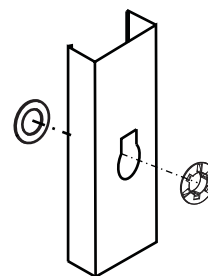

### COMMON HOLE SHAPES IN METAL STUDS:

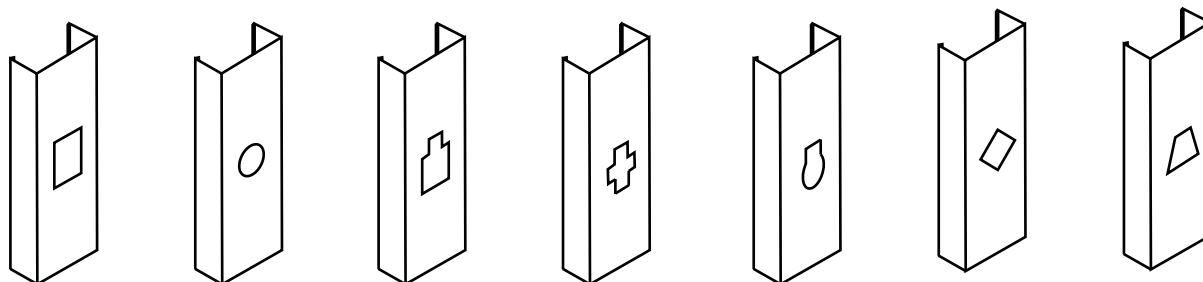

## ZINC DIE CAST CONDUIT LOCKNUTS

### PRODUCT FEATURES

- ▶ Full-Cut Internal Threads
- ▶ Meets Federal Spec. A-A-50553

Cat. No.	Trade Size	Std. Pkg.	Master Ctn.
LN-50	1/2"	100	1000
LN-75	3/4"	100	1000
LN-100	1"	100	1000
LN-125	1-1/4"	50	500
LN-150	1-1/2"	50	500
LN-200	2"	25	250
LN-250	2-1/2"	10	100
LN-300	3"	5	50
LN-350	3-1/2"	5	50
LN-400	4"	-	25



## STEEL CONDUIT LOCKNUTS

### PRODUCT FEATURES

- ▶ Electroplated Zinc
- ▶ Full-Cut Internal Threads
- ▶ Meets Federal Spec. A-A-50553

Cat. No.	Trade Size	Std. Pkg.	Master Ctn.
SLN-50	1/2"	100	1000
SLN-75	3/4"	100	1000
SLN-100	1"	100	1000
SLN-125	1-1/4"	50	500
SLN-150	1-1/2"	50	500
SLN-200	2"	25	250
SLN-250	2-1/2"	10	100
SLN-300	3"	5	50
SLN-350	3-1/2"	5	50
SLN-400	4"	-	25
SLN-500	5"	-	10
SLN-600	6"	-	10



## STEEL SEALING LOCKNUTS

### PRODUCT FEATURES

- ▶ Electroplated Zinc
- ▶ Bonded with Molten Sealing Material
- ▶ Meets Federal Spec. A-A-50553



Cat. No.	Trade Size	Std. Pkg.	Master Ctn.
SSLN-50	1/2"	100	1000
SSLN-75	3/4"	100	1000
SSLN-100	1"	100	1000
SSLN-125	1-1/4"	50	500
SSLN-150	1-1/2"	50	500
SSLN-200	2"	25	250
SSLN-250	2-1/2"	10	100
SSLN-300	3"	5	50
SSLN-350	3-1/2"	5	50
SSLN-400	4"	-	25
SSLN-500	5"	-	10
SSLN-600	6"	-	10





## STEEL GROUNDING (BONDING) RIGID LOCKNUTS

### PRODUCT FEATURES

- ▶ Electroplated Zinc

Cat. No.	Trade Size	Std. Pkg.	Master Ctn.
GL-50	1/2"	50	200
GL-75	3/4"	25	100
GL-100	1"	25	100
GL-125	1-1/4"	10	50
GL-150	1-1/2"	10	50
GL-200	2"	10	50
GL-250	2-1/2"	5	25
GL-300	3"	5	25
GL-350	3-1/2"	-	5
GL-400	4"	-	5
GL-500	5"	-	5
GL-600	6"	-	5



## NYLON PLASTIC LOCKNUT

### PRODUCT FEATURES

- ▶ Full-cut internal threads
- ▶ Meets Federal Spec. A-A-50553

Cat. No.	Trade Size	Std. Pkg.	Master Ctn.
PLN-38	3/8"	50	-
PLN-50	1/2"	50	-
PLN-75	3/4"	50	-
PLN-100	1"	100	-



## STEEL LIQUID TIGHT SEALING RINGS

### PRODUCT FEATURES

- ▶ Neoprene Rubber Gasket
- ▶ Steel Retainer
- ▶ Form Liquid tight seal between connector and box

Cat. No.	Trade Size	Std. Pkg.	Master Ctn.
LTSR-50	1/2"	250	2500
LTSR-75	3/4"	200	2000
LTSR-100	1"	150	1500
LTSR-125	1-1/4"	100	1000
LTSR-150	1-1/2"	50	500
LTSR-200	2"	50	500
LTSR-250	2-1/2"	-	100
LTSR-300	3"	-	100
LTSR-350	3-1/2"	-	50
LTSR-400	4"	-	50



**GALVANIZED STAMPED STEEL  
REDUCING WASHERS**

Cat. No.	Trade Size	Std. Pkg.	Master Ctn.
RW-75/50	3/4" to 1/2"	250	1000
RW-100/50	1" to 1/2"	250	1000
RW-100/75	1" to 3/4"	250	1000
RW-125/50	1-1/4" to 1/2"	100	400
RW-125/75	1-1/4" to 3/4"	100	400
RW-125/100	1-1/4" to 1"	100	400
RW-150/50	1-1/2" to 1/2"	-	100
RW-150/75	1-1/2" to 3/4"	-	100
RW-150/100	1-1/2" to 1"	-	100
RW-150/125	1-1/2" to 1-1/4"	-	100
RW-200/50	2" to 1/2"	-	50
RW-200/75	2" to 3/4"	-	50
RW-200/100	2" to 1"	-	50
RW-200/125	2" to 1-1/4"	-	50
RW-200/150	2" to 1-1/2"	-	50
RW-250/50	2-1/2" to 1/2"	25	100
RW-250/75	2-1/2" to 3/4"	25	100
RW-250/100	2-1/2" to 1"	25	100
RW-250/125	2-1/2" to 1-1/4"	25	100
RW-250/150	2-1/2" to 1-1/2"	25	100
RW-250/200	2-1/2" to 2"	25	100
RW-300/50	3" to 1/2"	-	25
RW-300/75	3" to 3/4"	-	25
RW-300/100	3" to 1"	-	25
RW-300/125	3" to 1-1/4"	-	25
RW-300/150	3" to 1-1/2"	-	25
RW-300/200	3" to 2"	-	25
RW-300/250	3" to 2-1/2"	-	25
RW-350/50	3-1/2" to 1/2"	-	10
RW-350/75	3-1/2" to 3/4"	-	10
RW-350/100	3-1/2" to 1"	-	10
RW-350/125	3-1/2" to 1-1/4"	-	10
RW-350/150	3-1/2" to 1-1/2"	-	10
RW-350/200	3-1/2" to 2"	-	10
RW-350/250	3-1/2" to 2-1/2"	-	10
RW-350/300	3-1/2" to 3"	-	10
RW-400/50	4" to 1/2"	-	10
RW-400/75	4" to 3/4"	-	10
RW-400/100	4" to 1"	-	10
RW-400/125	4" to 1-1/4"	-	10
RW-400/150	4" to 1-1/2"	-	10
RW-400/200	4" to 2"	-	10
RW-400/250	4" to 2-1/2"	-	10
RW-400/300	4" to 3"	-	10
RW-400/350	4" to 3-1/2"	-	10





## STEEL FIXED BAR HANGERS

### PRODUCT FEATURES

- ▶ Electroplated Zinc
- ▶ For Stud and T-Bar

Cat. No.	Description	Master Ctn.
<b>BHT-1</b>	24" T-Bar bracket for use with boxes 1-1/2" or 2-1/8" Deep with BHT-C Box Clip	50
<b>BHT-1A</b>	24" T-Bar bracket - 8" height adjustable, with BHT-C Box Clip	50
<b>BH-1</b>	24" Straight bar hanger for mounting ceiling boxes, Slotted, Includes 2 Stove Bolt / Unit	50
<b>BH-1C</b>	24" Straight bar hanger for mounting ceiling boxes with BH-C Box Clip	50
<b>BH-1S</b>	20" Straight bar hanger for mounting ceiling boxes, Slotted, Includes 2 Stove Bolt / Unit	50
<b>BH-1SC</b>	20" Straight bar hanger for mounting ceiling boxes with BH-C Box Clip	50
<b>BH-2NC</b>	21" Offset (1-1/2") bar hanger for mounting boxes with ring, Slotted	50
<b>BH-C</b>	Additional box clip & screw set for use with BH-1, BH-1S & BH-2NC	100
<b>BH-3</b>	Straight bracket for architectural recess lights 25-1/4" long with notches 24" apart for use on T-Bar	50
<b>BHT-C</b>	Additional box clip & set screw for use with BHT-1 & BHT-1A	100

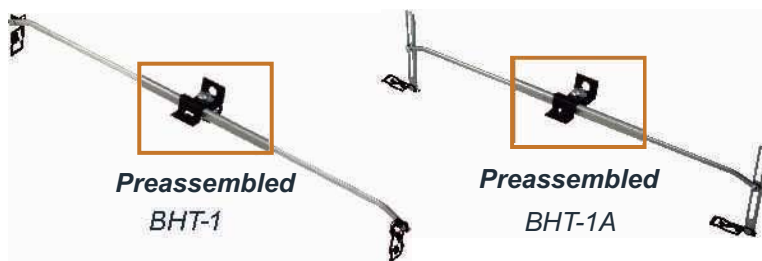
**BHT-1 INSTALLATION VIEW**

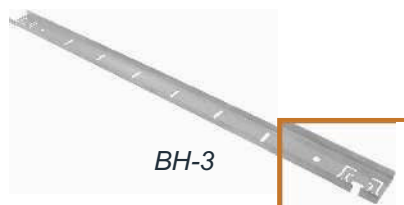
**BH-2NC**

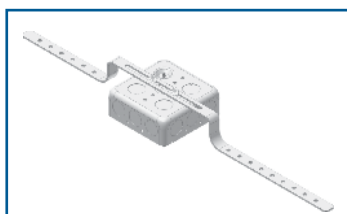
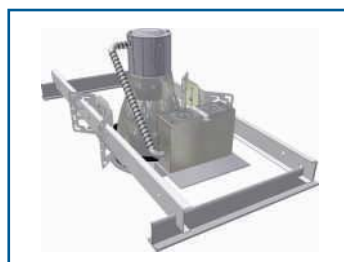
**BH-3**

**BH-C**

**BH-2NC INSTALLATION VIEW**

**BH-3 INSTALLATION VIEW**

**BHT-C**



**STEEL**  
**ADJUSTABLE BAR HANGERS**

**PRODUCT FEATURES**

- ▶ Electroplated Zinc
- ▶ For Stud and T-Bar
- ▶ \*For Fixture/Luminaire Support of 50 lbs or less at 16 in. Span

Cat. No.	Description	Master Ctn.
*BHA-1	Adjustable bar hanger with stud for joist spacing 16" to 24" with #3/8-18 NPS Threaded Stud	50
*BHA-1C	Adjustable bar hanger with stud for joist spacing 16" to 24" with Box Clip	50
BHA-16	11" to 18" Adjustable box bracket - Mount Box with self-tapping screws on notches Ends bend and wrap around stud - Can be used with boxes 1-1/2", 2-1/8" or 2-1/2" Deep	50
BHA-24	15-3/4" to 26" Adjustable box bracket - Mount Box with self-tapping screws on notches Ends bend and wrap around stud - Can be used with boxes 1-1/2", 2-1/8" or 2-1/2" Deep	50
ABS	Far-Side Box Support for 1-1/2" & 2-1/8" Deep Boxes, For use with 4" Metal Studs	50
ABS-6	Far-Side Box Support for 1-1/2" & 2-1/8" Deep Boxes, For use with 6" Metal Studs	50
OWG	Clips and locks old-work steel boxes tightly to wall. 2 required per box.	100



Adjusts 11" - 18"

ABS



ABS-6



OWG



Adjusts 15-3/4" - 26"

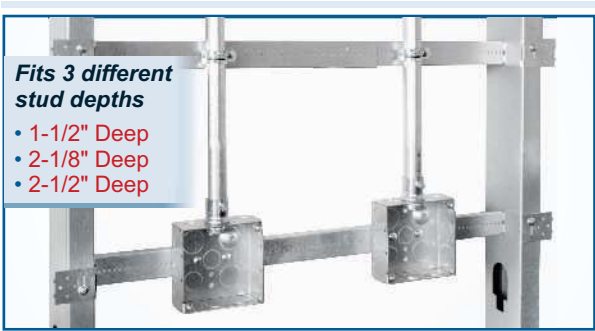

BHA-24 SHOWN INSTALLED



## NAIL SAFETY PLATES

### PRODUCT FEATURES

- Provides protection from nail and screw penetration

Cat. No.	Description	Trade Size	Std. Pkg.
SP-1	16GA Safety Plate with prongs	1.5" x 2.75"	100
SP-1-500	16GA Safety Plate with prongs	1.5" x 2.75"	500
SP-35	16GA Safety Plate with prongs	3" x 5"	100
SP-6	16GA Safety Plate with prongs	1.5" x 6"	100
SP-9	16GA Safety Plate with nail holes	1.5" x 9"	50
SP-12	16GA Safety Plate with nail holes	1.5" x 12"	50
SP-18	16GA Safety Plate with nail holes	1.5" x 18"	50
SP-24	16GA Safety Plate with nail holes	1.5" x 24"	50
SPH-9	12GA Safety Plate with nail holes	1.5" x 9"	50
SPH-12	12GA Safety Plate with nail holes	1.5" x 12"	50
SPH-18	12GA Safety Plate with nail holes	1.5" x 18"	50
SPH-24	12GA Safety Plate with nail holes	1.5" x 24"	50

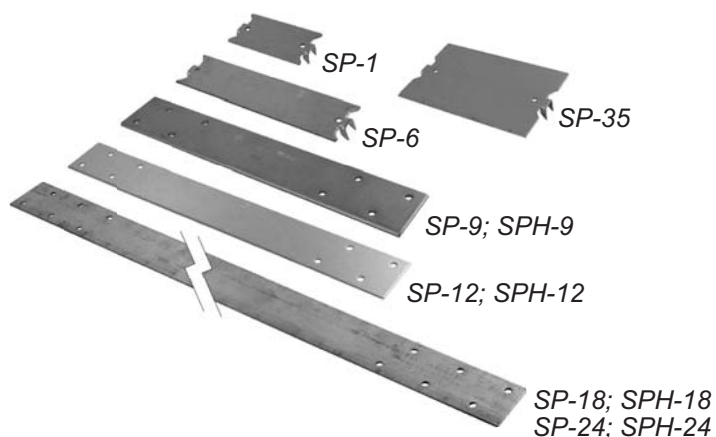

## SWITCH BOX SUPPORT

### PRODUCT FEATURES

- Bendable Tabs

Cat. No.	Description	Std. Pkg.
SBS	20GA	100



## ROOF COUPLING PLATES

### PRODUCT FEATURES

- Suitable in any type of new or old work roof construction
- Allows conduit to run below the roof line, eliminating the need to spend time derating
- Different conduit stubs can be prefabricated to plate
- Maintains roof integrity by reducing support penetrations
- Can be used for through floor conduit penetrations



**Video Available  
On Our Website!**

Cat. No.	Trade Size	Base Plate Size	Base Plate Thickness	Std. Pkg.
<b>RCP-50</b> <small>NEW</small>	1/2"	6" x 6"	0.064"	20
<b>RCP-75</b> <small>NEW</small>	3/4"	6" x 6"	0.064"	20
<b>RCP-100</b> <small>NEW</small>	1"	6" x 6"	0.064"	20
<b>RCP-125</b> <small>NEW</small>	1-1/4"	6" x 6"	0.064"	10
<b>RCP-150</b> <small>NEW</small>	1-1/2"	8" x 8"	0.074"	10
<b>RCP-200</b> <small>NEW</small>	2"	8" x 8"	0.074"	10



**NEW** RCP-75



**NEW** RCP-125

## RCP INSTALLATION



### EASY TRANSITION

The RCP Series allows for an easy transition of different conduit types to suit your application

### STEADY SUPPORT

Once fastened, conduit movement is eliminated up to 5' above and below the roof line



**Perfect for control, fire alarm,  
service receptacles and power  
to electrical equipment  
installation on roofs**



## 24GA GALVANIZED STEEL ROOF JACKS

### PRODUCT FEATURES

- ▶ Uninsulated
- ▶ For Service Entrance Conduit or Ventilation Pipe
- ▶ Fits Flat to 40°



Cat. No.	Trade Size	Std. Pkg.
RJ-50	1/2"	24
RJ-75	3/4"	24
RJ-100	1"	24
RJ-125	1-1/4"	24
RJ-150	1-1/2"	24
RJ-200	2"	24
RJ-300	3"	12
RJ-400	4"	12



## SCREW KITS, PLASTIC ANCHOR KIT, & EASY ANCHOR KIT

### PRODUCT FEATURES

- ▶ In Plastic Partition Kits

Cat. No.	Description	Trade Size	Screw Count/Kit	Std. Pkg.
KIT-632FH	6-32 Flat Head, 1/2" to 2", Slot	#6-32	370	10
KIT-632RH	6-32 Round Head, 1/2" to 2", Slot/Phillips	#6-32	370	10
KIT-832RH	8-32 Round Head, 1/2" to 2", Slot/Phillips	#8-32	370	10
KIT-10PAK	#10 x 1" Screws & Plastic Anchors, with Masonry Drill Bit	#10 x 1"	110	10
KIT-8EZ	#8 x 1-1/2" Zinc Dry Wall Easy Anchor Kit	#8 x 1-1/2"	50	10
KIT-1032TC	#10 x 1-1/4" Tri-Combo Screw (Hex/Phillips/Slot) Self-Tapping Screw & #8-10 x 1-1/4" Anchors (One 1/4" Masonry drill bit)	#10-32 x 1-1/4"	100	10

### Machine Screw Kits Screw Count

Size	Qty.
1/2"	100
3/4"	75
1"	75
1-1/4"	50
1-1/2"	40
2"	30
<b>Total</b>	<b>370</b>



KIT-632FH



KIT-632RH



KIT-832RH



KIT-10PAK



KIT-8EZ



KIT-1032TC

## STEEL HANGER SCREW WITH SINGLE HOLE

### PRODUCT FEATURES

- ▶ Wood Screw Thread

Cat. No.	Description	Dimension	Std. Pkg.	Master Ctn.
H-SCREW	Flat Hanger Screw	1/4" x 3"	100	500





## STEEL BEAM CLAMPS

### PRODUCT FEATURES

- ▶ Single Screw
- ▶ 2 Threaded Holes



Cat. No.	Description	Std. Pkg.	Master Ctn.
BC-25	1/4"-20 Tap, 3/4" Jaw, 100 lb. Load	50	250
BC-38	3/8"-16 Tap, 7/8" Jaw, 200 lb. Load	25	100

## MALLEABLE IRON BEAM CLAMPS

### PRODUCT FEATURES

- ▶ Single Screw
- ▶ 2 Threaded Holes



Cat. No.	Description	Std. Pkg.	Master Ctn.
BCM-25	1/4"-20 Tap, 3/4" Jaw, 125 lb. Load	50	250
BCM-38	3/8"-16 Tap, 7/8" Jaw, 300 lb. Load	25	100
BCM-50	1/2"-13 Tap, 1" Jaw, 600 lb. Load	10	50

## STEEL REGULAR SPRING NUTS

### PRODUCT FEATURES

- ▶ Electroplated Zinc



SNR-1420

SNR-3816

Cat. No.	Trade Size	Std. Pkg.	Master Ctn.
SNR-1420	1/4" - 20	100	600
SNR-3816	3/8" - 16	100	600
SNR-1213	1/2" - 13	100	600

## STEEL JACK CHAIN

### PRODUCT FEATURES

- ▶ Electroplated Zinc
- ▶ 25 lbs. Max. Load
- ▶ In Steel Reel



Cat. No.	Trade Size	Std. Pkg.
JC-12	12GA	100

## STEEL "S" HOOK

### PRODUCT FEATURES

- ▶ Electroplated Zinc
- ▶ 25 lbs. Max. Load



Cat. No.	Trade Size	Std. Pkg.	Master Ctn.
SH-2	12GA, 1-1/4"	100	1000

## STEEL FIXTURE HANGERS

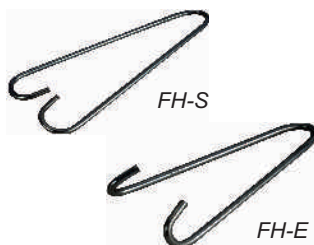

FH-S

FH-E

Cat. No.	For Use With	Mount Position	Std. Pkg.	Master Ctn.
FH-E	2, 3, or 4 Light Fixtures	End Mount	100	500
FH-S	2, 3, or 4 Light Fixtures	Side Mount	100	500



### SERVICE ENTRANCE WEDGE GRIP CLAMPS

#### PRODUCT FEATURES

- Designed to make quick sag adjustments.
- For use with ACSR, AAC, AAAC Service cables
- Aluminum Body
- Stainless Steel Solid Bail



Cat. No.	ACSR Wire Size	Std. Pkg.	Master Ctn.
SEWG-1	#6 - #2	10	50
SEWG-2	#4 - 1/0	5	25
SEWG-3	2/0 - 4/0	5	25

### PORCELAIN WIRE HOLDERS

#### PRODUCT FEATURES

- Porcelain & Galvanized Steel
- Varies According to Sizes



PWH-L



PWH-M

Cat. No.	Description	Trade Size	Std. Pkg.	Master Ctn.
PWH-L	With 2-1/4" Lag Bolt	2-3/4"	5	20
PWH-M	With Steel Clip for 1-1/4" to 3" Mast	1-1/4" to 3"	5	20

### BLACK ANNEALED STEEL TIE WIRE

#### PRODUCT FEATURES

- 16-1/2GA



Cat. No.	Description	Trade Size	Std. Pkg.
TW	Tie Wire	16GA, 400'	20

### MALLEABLE IRON RIGID FLOOR FLANGES



Cat. No.	Trade Size	Std. Pkg.
FR-50	1/2"	50
FR-75	3/4"	50
FR-100	1"	50
FR-125	1-1/4"	25
FR-150	1-1/2"	25
FR-200	2"	25

### MALLEABLE IRON CONCRETE SLAB INSERTS STRAIGHT



Cat. No.	Trade Size	Std. Pkg.	Master Ctn.
MCSI-50	1/2"	10	100
MCSI-75	3/4"	10	100
MCSI-100	1"	10	50

### MALLEABLE IRON CONCRETE SLAB INSERTS 90° ANGLE



Cat. No.	Trade Size	Std. Pkg.	Master Ctn.
MCSI90-50	1/2"	10	100
MCSI90-75	3/4"	10	100
MCSI90-100	1"	10	50

## Structural Attachments



FAF14



FVF14



FM24  
FM58  
FM912



*With Stud*

FM24S  
FM58S  
FM912S



F2H4  
F4H24  
F4H58  
F4H912



F4TI24  
F4TI58  
F4TI912



FAF144TI



BCSS



AB4  
AB6



F4TI  
F6TI  
F6T



F4TIB  
F6TIB



F4Z34  
F6Z34



HOSP

## Stud Wall Attachments



FFXC20



F6MF  
F812MF  
F16MF  
F20MF



FMAC2



MSC



SOSP

## Cable & Conduit Supports



F8P24  
F8P58  
F8P912  
F12P24  
F12P58  
F12P912  
F16P24  
F16P58  
F16P912



F8P24SM  
F8P58SM  
F8P912SM  
F12P24SM  
F12P58SM  
F12P912SM  
F16P24SM  
F16P58SM  
F16P912SM



F812M24  
F812M58  
F812M912



F812M24SM  
F812M58SM



CC



CC-8  
CC-12  
CC-16  
CC-20



F4Z34812M  
F6Z34812M



F4Z348P  
F6Z348P  
F4Z3412P  
F6Z3412P  
F4Z3416P  
F6Z3416P



F8P  
F12P  
F16P



Threaded Hole

F6M4I  
F812M4I  
F16M4I  
F20M4I  
F24M4I  
F32M4I



Plain Hole

F6M  
F812M  
F16M  
F20M  
F24M  
F32M

## Datacom & Low Voltage



MPC



FCAT12  
FCAT21  
FCAT32  
FCAT64



FCAT124Z34  
FCAT126Z34

Visit [www.orbitelectric.com](http://www.orbitelectric.com) for our full line of Fasteners & Straps