

DIE CAST COPPER-FREE ALUMINUM THREADED CONDUIT BODIES "T" SERIES

PRODUCT FEATURES

- ▶ With Die Cast Cover and Neoprene Gasket
- ▶ Gray color



Cat. No.	Trade Size	DIMENSIONS - T SERIES					Std. Pkg.
		A	B	C	D	E	
T-50A	1/2"	1-5/16"	3-7/8"	1-3/8"	4-11/16"	2-1/32"	10
T-75A	3/4"	1-9/16"	4-11/16"	1-5/8"	5-1/2"	2-5/16"	10
T-100A	1"	1-13/16"	5-3/8"	1-7/8"	6-7/16"	2-11/16"	5
T-125A	1-1/4"	2-1/2"	7-5/16"	2-1/2"	8-3/8"	3-1/2"	2
T-150A	1-1/2"	2-1/2"	7-5/16"	2-1/2"	8-3/8"	3-1/2"	2
T-200A	2"	3-3/16"	9-1/2"	3-3/8"	10-9/16"	4-9/32"	1
T-250A	2-1/2"	4-1/2"	12-1/16"	4"	13-1/2"	5-7/8"	1
T-300A	3"	4-1/2"	12-1/16"	4-1/2"	13-1/2"	5-7/8"	1
T-400A	4"	5-9/16"	15-1/16"	5-5/8"	16-5/16"	7-21/32"	1

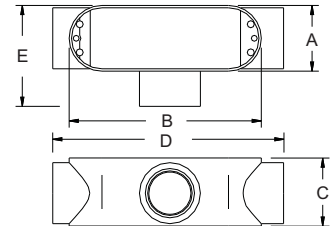
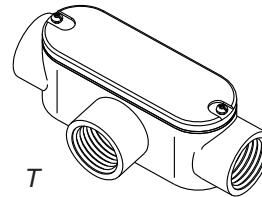

DIE CAST COPPER-FREE ALUMINUM THREADED SERVICE ENTRANCE CONDUIT BODIES "SLB" SERIES

PRODUCT FEATURES

- ▶ With Die Cast Cover and Neoprene Gasket
- ▶ Gray color



Cat. No.	Trade Size	DIMENSIONS - SLB SERIES			Std. Pkg.
		A	B	C	
SLB-50	1/2"	1-5/8"	1-3/8"	3-9/32"	20
SLB-75	3/4"	1-27/32"	1-9/16"	3-19/32"	20
SLB-100	1"	2-1/8"	1-31/32"	4-5/16"	10
SLB-125	1-1/4"	2-19/32"	2-7/16"	5-9/16"	10
SLB-150	1-1/2"	2-19/32"	2-5/8"	6-1/4"	6
SLB-200	2"	3-1/8"	3-1/8"	6-3/4"	3

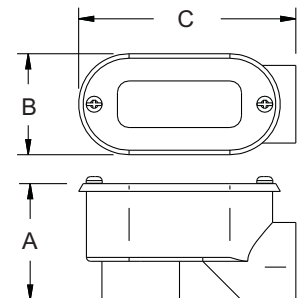
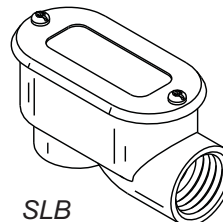

MOGUL THREADED COPPER-FREE ALUMINUM ALLOY EXTRA-LARGE RIGID CONDUIT BODIES "LB" SERIES

PRODUCT FEATURES

- ▶ With Die Cast Cover and Neoprene Gasket
- ▶ Gray color

Cat. No.	Trade Size	DIMENSIONS - LB SERIES						Std. Pkg.	Master Ctn.
		A	B	C1	C2	D	E		
LBM-150	1-1/2"	3"	13-7/16"	5"	4"	14-1/4"	2-3/4"	-	1
LBM-200	2"	3"	13-7/16"	5"	4"	14-1/4"	2-3/4"	-	1
LBM-250	2-1/2"	4-17/27"	21-9/10"	8-2/3"	5-3/25"	22-3/4"	4-1/4"	-	1
LBM-300	3"	4-17/27"	21-9/10"	8-2/3"	5-3/25"	22-3/4"	4-1/4"	-	1
LBM-350	3-1/2"	5-17/27"	28-1/2"	10"	6-1/10"	29-1/8"	5-1/8"	-	1
LBM-400	4"	5-17/27"	28-1/2"	10"	6-1/10"	29-1/8"	5-1/8"	-	1

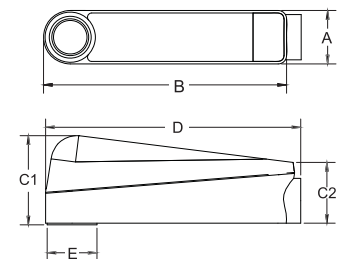

Electrical Fittings

