

Orbit stocks a complete line of Electrical Conduit Bodies, available in LB, LL, LR, C, T and SLB configurations. Made with set screws for use with EMT conduit in dry locations; or threaded hubs for Rigid/IMC conduit in wet or dry locations. Body materials include Die-Cast Aluminum, Malleable Iron, and Gray Iron (Form 7 and Form 8). Orbit also offers Conduit Body Covers to fit every body type, many which include a watertight gasket and captive screws. Covers available in Die-Cast, Stamped Steel or Aluminum, Malleable Iron, and Gray Iron materials. (Select Conduit Body models include Covers.)



## **Threaded Aluminum Conduit Bodies with Covers**

| **Pg. E1-E4**

Orbit offers a line of Threaded Aluminum Conduit Bodies which include a Cover Set, making it easier to order and manage parts. Threaded Aluminum Conduit bodies are available 1/2" thru 4" (SLB max is 2") trade sizes and they include a removable Stamped Aluminum Cover and Neoprene gasket. Suitable for threaded Rigid or IMC conduit in wet or dry locations. Most threaded Aluminum Conduit Bodies may also be ordered without Covers.

## **Mogul Conduit Bodies | Pg. E5**



Extra Large Aluminum Mogul Conduit Bodies feature an angled body that helps give wire pulls a soft bend radius. Perfect for 90° turns and hard-to-pull service entrance cables. Moguls also provide a large chamber for splices and taps. Powder-coated with an epoxy finish for corrosion resistance. Bodies include Aluminum Cover and watertight gasket. Mogul Conduit Bodies are available in 1-1/2" thru 4" trade sizes. Suitable for threaded Rigid or IMC conduit, in wet or dry locations.

## Form 7 Conduit Bodies | Pg. E12-E13



Form 7 Gray Iron Conduit Bodies provide slightly more cubic content than traditional malleable iron conduit bodies, allowing more room for conductor splicing. Form 7 Conduit Bodies are also more compact, and feature a flat-back for more stable installations. Threaded hubs are tapered and include integral bushings for easier wire pulls. Stamped Steel and Gray Iron Covers with integral gaskets are sold separate. Form 7 Covers feature captive wedgenuts that provide superior screwdriver seating and torque compared to traditional screws. Covers are easy to remove later, and interchangeable with Form 7 Conduit Bodies offered by most other brands.

Conduit Bodies

## Form 8 Conduit Bodies | Pg. E14-E15



Form 8 Gray Iron Conduit Bodies feature longer bodies and larger wire-pull openings than Form 7 Bodies of the same trade size. This greater size accommodates heavier, larger gauge conductors. Form 8 Conduit Bodies also feature a flat-back design and tapered conduit hubs. Stamped Steel and Gray Iron Covers with integral gaskets are sold separate, and include stainless steel screws.



## Aluminum Conduit Bodies



LB-A



LL-A



LR-A



C-A



T-A



SLB



LB-AS



LL-AS



LR-AS



C-AS



T-AS



LBM



LB



LL



LR



C



T



SSLB



SSLR



SSLL



SSC



SST



CG



SC

STEEL



AC



G

Conduit Bodies

## Malleable Iron Conduit Bodies



MLB



MLL



MLR



MC



MT



MIC

## Form 7 Gray Iron Conduit Bodies



LB7



LL7



LR7



C7



T7



SCG7



GICG7

## Form 8 Gray Iron Conduit Bodies



LB8



LL8



LR8



C8



T8



SCG8



GICG8

# E1 Rigid Assembled Conduit Bodies - Aluminum

## DIE CAST COPPER-FREE ALUMINUM THREADED CONDUIT BODIES "LB" SERIES

### PRODUCT FEATURES

- ▶ Die Cast Cover and Neoprene Gasket included
- ▶ Gray color
- ▶ Suitable for wet location when used with Gasket and Cover
- ▶ NPT Thread Hubs

While supplies last. Will be superseded by LB-AS Series.

| Cat. No. | Trade Size | DIMENSIONS - LB SERIES |          |          |           |          | Std. Pkg. |
|----------|------------|------------------------|----------|----------|-----------|----------|-----------|
|          |            | A                      | B        | C        | D         | E        |           |
| LB-50A   | 1/2"       | 1-5/16"                | 3-7/8"   | 2-1/8"   | 4-5/16"   | 1-1/16"  | 10        |
| LB-75A   | 3/4"       | 1-9/16"                | 4-11/16" | 2-3/8"   | 5-1/8"    | 1-5/16"  | 10        |
| LB-100A  | 1"         | 1-13/16"               | 5-3/8"   | 2-3/4"   | 5-15/16"  | 1-9/16"  | 5         |
| LB-125A  | 1-1/4"     | 2-1/2"                 | 7-5/16"  | 3-1/2"   | 7-13/16"  | 2"       | 2         |
| LB-150A  | 1-1/2"     | 2-1/2"                 | 7-5/16"  | 3-1/2"   | 7-13/16"  | 2-3/16"  | 2         |
| LB-200A  | 2"         | 3-3/16"                | 9-1/2"   | 4-1/2"   | 10-1/16"  | 2-11/16" | 1         |
| LB-250A  | 2-1/2"     | 4-1/2"                 | 12-1/16" | 5-5/16"  | 12-13/16" | 3-5/16"  | 1         |
| LB-300A  | 3"         | 4-1/2"                 | 12-1/16" | 5-15/16" | 12-13/16" | 3-15/16" | 1         |
| LB-350A  | 3-1/2"     | 5-9/16"                | 15-1/16" | 7-5/16"  | 15-5/8"   | 4-9/16"  | 1         |
| LB-400A  | 4"         | 5-9/16"                | 15-7/16" | 7-5/16"  | 15-5/8"   | 5"       | 1         |

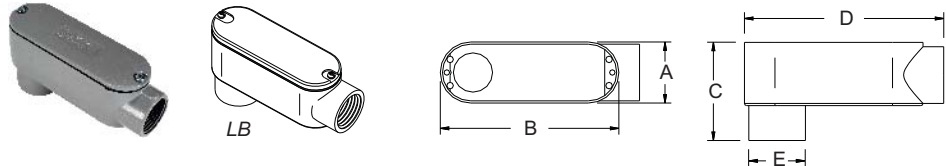

## DIE CAST COPPER-FREE ALUMINUM THREADED CONDUIT BODIES "LL" SERIES

### PRODUCT FEATURES

- ▶ Die Cast Cover and Neoprene Gasket included
- ▶ Gray color
- ▶ Suitable for wet location when used with Gasket and Cover
- ▶ NPT Thread Hubs

While supplies last. Will be superseded by LL-AS Series.

| Cat. No. | Trade Size | DIMENSIONS - LL SERIES |          |          |           |        | Std. Pkg. |
|----------|------------|------------------------|----------|----------|-----------|--------|-----------|
|          |            | A                      | B        | C        | D         | E      |           |
| LL-50A   | 1/2"       | 1-5/16"                | 3-7/8"   | 2-1/16"  | 4-5/16"   | 1-3/8" | 10        |
| LL-75A   | 3/4"       | 1-9/16"                | 4-11/16" | 2-5/16"  | 5-1/8"    | 1-5/8" | 10        |
| LL-100A  | 1"         | 1-13/16"               | 5-3/8"   | 2-11/16" | 5-15/16"  | 1-7/8" | 5         |
| LL-125A  | 1-1/4"     | 2-1/2"                 | 7-5/16"  | 3-1/2"   | 7-13/16"  | 2-1/2" | 2         |
| LL-150A  | 1-1/2"     | 2-1/2"                 | 7-5/16"  | 3-1/2"   | 7-13/16"  | 2-1/2" | 2         |
| LL-200A  | 2"         | 3-3/16"                | 9-1/2"   | 4-5/16"  | 10-1/16"  | 3-3/8" | 1         |
| LL-250A  | 2-1/2"     | 4-1/2"                 | 12-1/16" | 5-7/8"   | 12-13/16" | 4"     | 1         |
| LL-300A  | 3"         | 4-1/2"                 | 12-1/16" | 5-7/8"   | 12-13/16" | 4-1/2" | 1         |
| LL-400A  | 4"         | 5-9/16"                | 15-1/16" | 7-11/16" | 15-5/8"   | 5-5/8" | 1         |

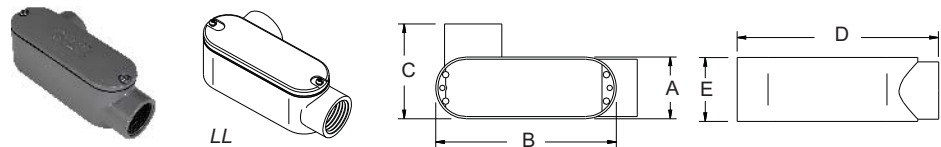

## DIE CAST COPPER-FREE ALUMINUM THREADED CONDUIT BODIES "LR" SERIES

### PRODUCT FEATURES

- ▶ Die Cast Cover and Neoprene Gasket included
- ▶ Gray color
- ▶ Suitable for wet location when used with Gasket and Cover
- ▶ NPT Thread Hubs

While supplies last. Will be superseded by LR-AS Series.

| Cat. No. | Trade Size | DIMENSIONS - LR SERIES |          |          |           |        | Std. Pkg. |
|----------|------------|------------------------|----------|----------|-----------|--------|-----------|
|          |            | A                      | B        | C        | D         | E      |           |
| LR-50A   | 1/2"       | 1-5/16"                | 3-7/8"   | 2-1/16"  | 4-5/16"   | 1-3/8" | 10        |
| LR-75A   | 3/4"       | 1-9/16"                | 4-11/16" | 2-5/16"  | 5-1/8"    | 1-5/8" | 10        |
| LR-100A  | 1"         | 1-13/16"               | 5-3/8"   | 2-11/16" | 5-15/16"  | 1-7/8" | 5         |
| LR-125A  | 1-1/4"     | 2-1/2"                 | 7-5/16"  | 3-1/2"   | 7-13/16"  | 2-1/2" | 2         |
| LR-150A  | 1-1/2"     | 2-1/2"                 | 7-5/16"  | 3-1/2"   | 7-13/16"  | 2-1/2" | 2         |
| LR-200A  | 2"         | 3-3/16"                | 9-1/2"   | 4-5/16"  | 10-1/16"  | 3-3/8" | 1         |
| LR-250A  | 2-1/2"     | 4-1/2"                 | 12-1/16" | 5-7/8"   | 12-13/16" | 4"     | 1         |
| LR-300A  | 3"         | 4-1/2"                 | 12-1/16" | 5-7/8"   | 12-13/16" | 4-1/2" | 1         |
| LR-400A  | 4"         | 5-9/16"                | 15-1/16" | 7-11/16" | 15-5/8"   | 5-5/8" | 1         |

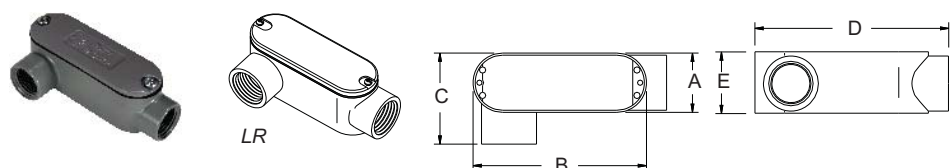



## DIE CAST COPPER-FREE ALUMINUM THREADED CONDUIT BODIES "C" SERIES

### PRODUCT FEATURES

- ▶ Die Cast Cover and Neoprene Gasket included
- ▶ Gray color
- ▶ Suitable for wet location when used with Gasket and Cover
- ▶ NPT Thread Hubs

While supplies last. Will be superseded by C-AS Series.

| Cat. No. | Trade Size | DIMENSIONS - C SERIES |          |        |          |          | Std. Pkg. |
|----------|------------|-----------------------|----------|--------|----------|----------|-----------|
|          |            | A                     | B        | C      | D        | E        |           |
| C-50A    | 1/2"       | 1-5/16"               | 3-7/8"   | 1-3/8" | 4-11/16" | 1-1/16"  | 10        |
| C-75A    | 3/4"       | 1-9/16"               | 4-11/16" | 1-5/8" | 5-1/2"   | 1-5/16"  | 10        |
| C-100A   | 1"         | 1-13/16"              | 5-3/8"   | 1-7/8" | 6-7/16"  | 1-9/16"  | 5         |
| C-125A   | 1-1/4"     | 2-1/2"                | 7-5/16"  | 2-1/2" | 8-3/8"   | 2"       | 2         |
| C-150A   | 1-1/2"     | 2-1/2"                | 7-5/16"  | 2-1/2" | 8-3/8"   | 2-3/16"  | 2         |
| C-200A   | 2"         | 3-3/16"               | 9-1/2"   | 3-3/8" | 10-9/16" | 2-11/16" | 1         |
| C-250A   | 2-1/2"     | 4-1/2"                | 12-1/16" | 4"     | 13-1/2"  | 3-5/16"  | 1         |
| C-300A   | 3"         | 4-1/2"                | 12-1/16" | 4-1/2" | 13-1/2"  | 3-15/16" | 1         |
| C-400A   | 4"         | 5-9/16"               | 15-1/16" | 5-5/8" | 16-5/16" | 5"       | 1         |

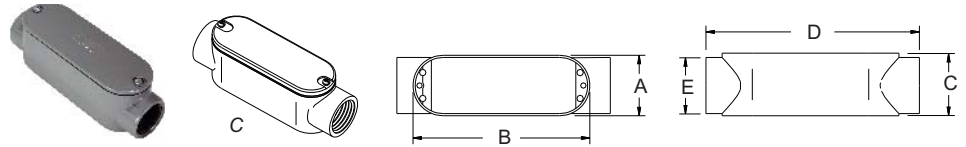

## DIE CAST COPPER-FREE ALUMINUM THREADED CONDUIT BODIES "T" SERIES

### PRODUCT FEATURES

- ▶ Die Cast Cover and Neoprene Gasket included
- ▶ Gray color
- ▶ Suitable for wet location when used with Gasket and Cover
- ▶ NPT Thread Hubs

While supplies last. Will be superseded by T-AS Series.

| Cat. No. | Trade Size | DIMENSIONS - T SERIES |          |        |          |          | Std. Pkg. |
|----------|------------|-----------------------|----------|--------|----------|----------|-----------|
|          |            | A                     | B        | C      | D        | E        |           |
| T-50A    | 1/2"       | 1-5/16"               | 3-7/8"   | 1-3/8" | 4-11/16" | 2-1/16"  | 10        |
| T-75A    | 3/4"       | 1-9/16"               | 4-11/16" | 1-5/8" | 5-1/2"   | 2-5/16"  | 10        |
| T-100A   | 1"         | 1-13/16"              | 5-3/8"   | 1-7/8" | 6-7/16"  | 2-11/16" | 5         |
| T-125A   | 1-1/4"     | 2-1/2"                | 7-5/16"  | 2-1/2" | 8-3/8"   | 3-1/2"   | 2         |
| T-150A   | 1-1/2"     | 2-1/2"                | 7-5/16"  | 2-1/2" | 8-3/8"   | 3-1/2"   | 2         |
| T-200A   | 2"         | 3-3/16"               | 9-1/2"   | 3-3/8" | 10-9/16" | 4-5/16"  | 1         |
| T-250A   | 2-1/2"     | 4-1/2"                | 12-1/16" | 4"     | 13-1/2"  | 5-7/8"   | 1         |
| T-300A   | 3"         | 4-1/2"                | 12-1/16" | 4-1/2" | 13-1/2"  | 5-7/8"   | 1         |
| T-400A   | 4"         | 5-9/16"               | 15-1/16" | 5-5/8" | 16-5/16" | 7-11/16" | 1         |

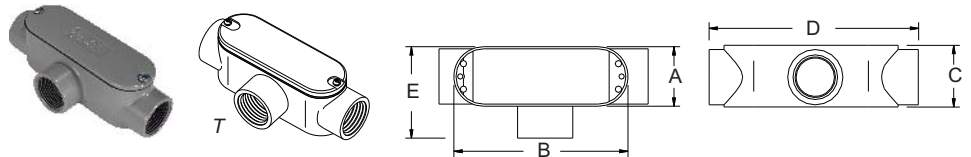

## DIE CAST COPPER-FREE ALUMINUM THREADED SERVICE ENTRANCE CONDUIT BODIES "SLB" SERIES

### PRODUCT FEATURES

- ▶ Die Cast Cover and Neoprene Gasket included
- ▶ Gray color
- ▶ Suitable for wet location when used with Gasket and Cover
- ▶ NPT Thread Hubs

| Cat. No. | Trade Size | DIMENSIONS - SLB SERIES |         |         | Std. Pkg. |
|----------|------------|-------------------------|---------|---------|-----------|
|          |            | A                       | B       | C       |           |
| SLB-50   | 1/2"       | 1-5/8"                  | 1-3/8"  | 3-5/16" | 20        |
| SLB-75   | 3/4"       | 1-7/8"                  | 1-9/16" | 3-5/8"  | 20        |
| SLB-100  | 1"         | 2-1/8"                  | 2"      | 4-5/16" | 10        |
| SLB-125  | 1-1/4"     | 2-5/8"                  | 2-7/16" | 5-9/16" | 10        |
| SLB-150  | 1-1/2"     | 2-5/8"                  | 2-5/8"  | 6-1/4"  | 6         |
| SLB-200  | 2"         | 3-1/8"                  | 3-1/8"  | 6-3/4"  | 3         |

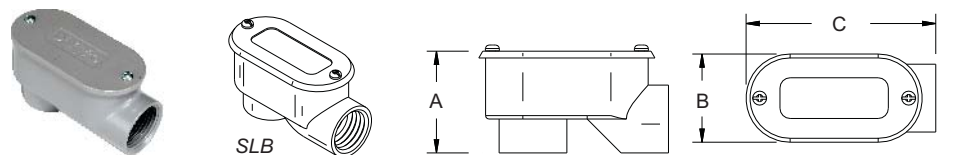

# E3 Rigid Assembled Conduit Bodies - Aluminum

## DIE CAST COPPER-FREE ALUMINUM THREADED CONDUIT BODIES "LB" SERIES

### PRODUCT FEATURES

- ▶ Stamped Aluminum Cover and Neoprene Gasket included
- ▶ Gray color
- ▶ Suitable for wet location when used with Gasket and Cover
- ▶ NPT Thread Hubs

| Cat. No.            | Trade Size | DIMENSIONS - LB SERIES |          |          |           |          | Std. Pkg. |
|---------------------|------------|------------------------|----------|----------|-----------|----------|-----------|
|                     |            | A                      | B        | C        | D         | E        |           |
| LB-50AS <b>NEW</b>  | 1/2"       | 1-5/16"                | 3-7/8"   | 2-1/8"   | 4-5/16"   | 1-1/16"  | 10        |
| LB-75AS <b>NEW</b>  | 3/4"       | 1-9/16"                | 4-11/16" | 2-3/8"   | 5-1/8"    | 1-5/16"  | 10        |
| LB-100AS <b>NEW</b> | 1"         | 1-13/16"               | 5-3/8"   | 2-3/4"   | 5-15/16"  | 1-9/16"  | 5         |
| LB-125AS <b>NEW</b> | 1-1/4"     | 2-1/2"                 | 7-5/16"  | 3-1/2"   | 7-13/16"  | 2"       | 2         |
| LB-150AS <b>NEW</b> | 1-1/2"     | 2-1/2"                 | 7-5/16"  | 3-1/2"   | 7-13/16"  | 2-3/16"  | 2         |
| LB-200AS <b>NEW</b> | 2"         | 3-3/16"                | 9-1/2"   | 4-1/2"   | 10-1/16"  | 2-11/16" | 1         |
| LB-250AS <b>NEW</b> | 2-1/2"     | 4-1/2"                 | 12-1/16" | 5-5/16"  | 12-13/16" | 3-5/16"  | 1         |
| LB-300AS <b>NEW</b> | 3"         | 4-1/2"                 | 12-1/16" | 5-15/16" | 12-13/16" | 3-15/16" | 1         |
| LB-350AS <b>NEW</b> | 3-1/2"     | 5-9/16"                | 15-1/16" | 7-5/16"  | 15-5/8"   | 4-9/16"  | 1         |
| LB-400AS <b>NEW</b> | 4"         | 5-9/16"                | 15-7/16" | 7-5/16"  | 15-5/8"   | 5"       | 1         |

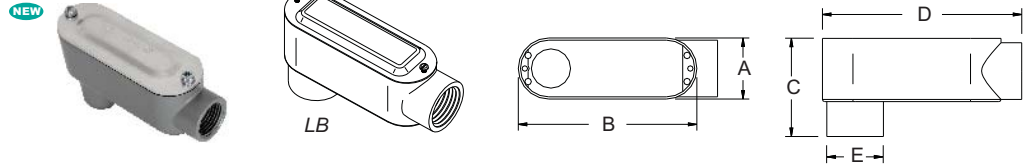

## DIE CAST COPPER-FREE ALUMINUM THREADED CONDUIT BODIES "LL" SERIES

### PRODUCT FEATURES

- ▶ Stamped Aluminum Cover and Neoprene Gasket included
- ▶ Gray color
- ▶ Suitable for wet location when used with Gasket and Cover
- ▶ NPT Thread Hubs

| Cat. No.            | Trade Size | DIMENSIONS - LL SERIES |          |          |           |        | Std. Pkg. |
|---------------------|------------|------------------------|----------|----------|-----------|--------|-----------|
|                     |            | A                      | B        | C        | D         | E      |           |
| LL-50AS <b>NEW</b>  | 1/2"       | 1-5/16"                | 3-7/8"   | 2-1/16"  | 4-5/16"   | 1-3/8" | 10        |
| LL-75AS <b>NEW</b>  | 3/4"       | 1-9/16"                | 4-11/16" | 2-5/16"  | 5-1/8"    | 1-5/8" | 10        |
| LL-100AS <b>NEW</b> | 1"         | 1-13/16"               | 5-3/8"   | 2-11/16" | 5-15/16"  | 1-7/8" | 5         |
| LL-125AS <b>NEW</b> | 1-1/4"     | 2-1/2"                 | 7-5/16"  | 3-1/2"   | 7-13/16"  | 2-1/2" | 2         |
| LL-150AS <b>NEW</b> | 1-1/2"     | 2-1/2"                 | 7-5/16"  | 3-1/2"   | 7-13/16"  | 2-1/2" | 2         |
| LL-200AS <b>NEW</b> | 2"         | 3-3/16"                | 9-1/2"   | 4-5/16"  | 10-1/16"  | 3-3/8" | 1         |
| LL-250AS <b>NEW</b> | 2-1/2"     | 4-1/2"                 | 12-1/16" | 5-7/8"   | 12-13/16" | 4"     | 1         |
| LL-300AS <b>NEW</b> | 3"         | 4-1/2"                 | 12-1/16" | 5-7/8"   | 12-13/16" | 4-1/2" | 1         |
| LL-400AS <b>NEW</b> | 4"         | 5-9/16"                | 15-1/16" | 7-11/16" | 15-5/8"   | 5-5/8" | 1         |

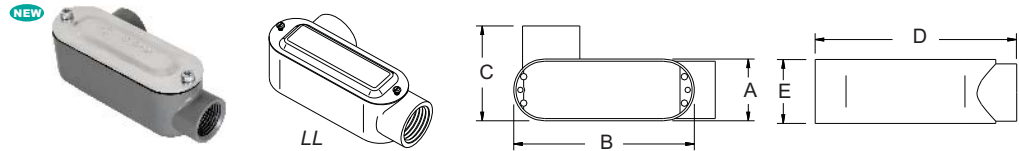

## DIE CAST COPPER-FREE ALUMINUM THREADED CONDUIT BODIES "LR" SERIES

### PRODUCT FEATURES

- ▶ Stamped Aluminum Cover and Neoprene Gasket included
- ▶ Gray color
- ▶ Suitable for wet location when used with Gasket and Cover
- ▶ NPT Thread Hubs

| Cat. No.            | Trade Size | DIMENSIONS - LR SERIES |          |          |           |        | Std. Pkg. |
|---------------------|------------|------------------------|----------|----------|-----------|--------|-----------|
|                     |            | A                      | B        | C        | D         | E      |           |
| LR-50AS <b>NEW</b>  | 1/2"       | 1-5/16"                | 3-7/8"   | 2-1/16"  | 4-5/16"   | 1-3/8" | 10        |
| LR-75AS <b>NEW</b>  | 3/4"       | 1-9/16"                | 4-11/16" | 2-5/16"  | 5-1/8"    | 1-5/8" | 10        |
| LR-100AS <b>NEW</b> | 1"         | 1-13/16"               | 5-3/8"   | 2-11/16" | 5-15/16"  | 1-7/8" | 5         |
| LR-125AS <b>NEW</b> | 1-1/4"     | 2-1/2"                 | 7-5/16"  | 3-1/2"   | 7-13/16"  | 2-1/2" | 2         |
| LR-150AS <b>NEW</b> | 1-1/2"     | 2-1/2"                 | 7-5/16"  | 3-1/2"   | 7-13/16"  | 2-1/2" | 2         |
| LR-200AS <b>NEW</b> | 2"         | 3-3/16"                | 9-1/2"   | 4-5/16"  | 10-1/16"  | 3-3/8" | 1         |
| LR-250AS <b>NEW</b> | 2-1/2"     | 4-1/2"                 | 12-1/16" | 5-7/8"   | 12-13/16" | 4"     | 1         |
| LR-300AS <b>NEW</b> | 3"         | 4-1/2"                 | 12-1/16" | 5-7/8"   | 12-13/16" | 4-1/2" | 1         |
| LR-400AS <b>NEW</b> | 4"         | 5-9/16"                | 15-1/16" | 7-11/16" | 15-5/8"   | 5-5/8" | 1         |

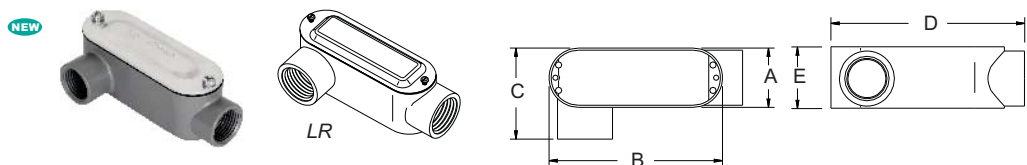

**DIE CAST COPPER-FREE ALUMINUM THREADED CONDUIT BODIES "C" SERIES**

**PRODUCT FEATURES**

- ▶ Stamped Aluminum Cover and Neoprene Gasket included
- ▶ Gray color
- ▶ Suitable for wet location when used with Gasket and Cover
- ▶ NPT Thread Hubs

| Cat. No.                   | Trade Size | DIMENSIONS - C SERIES |          |        |          |          | Std. Pkg. |
|----------------------------|------------|-----------------------|----------|--------|----------|----------|-----------|
|                            |            | A                     | B        | C      | D        | E        |           |
| C-50AS <small>NEW</small>  | 1/2"       | 1-5/16"               | 3-7/8"   | 1-3/8" | 4-11/16" | 1-1/16"  | 10        |
| C-75AS <small>NEW</small>  | 3/4"       | 1-9/16"               | 4-11/16" | 1-5/8" | 5-1/2"   | 1-5/16"  | 10        |
| C-100AS <small>NEW</small> | 1"         | 1-13/16"              | 5-3/8"   | 1-7/8" | 6-7/16"  | 1-9/16"  | 5         |
| C-125AS <small>NEW</small> | 1-1/4"     | 2-1/2"                | 7-5/16"  | 2-1/2" | 8-3/8"   | 2"       | 2         |
| C-150AS <small>NEW</small> | 1-1/2"     | 2-1/2"                | 7-5/16"  | 2-1/2" | 8-3/8"   | 2-3/16"  | 2         |
| C-200AS <small>NEW</small> | 2"         | 3-3/16"               | 9-1/2"   | 3-3/8" | 10-9/16" | 2-11/16" | 1         |
| C-250AS <small>NEW</small> | 2-1/2"     | 4-1/2"                | 12-1/16" | 4"     | 13-1/2"  | 3-5/16"  | 1         |
| C-300AS <small>NEW</small> | 3"         | 4-1/2"                | 12-1/16" | 4-1/2" | 13-1/2"  | 3-15/16" | 1         |
| C-400AS <small>NEW</small> | 4"         | 5-9/16"               | 15-1/16" | 5-5/8" | 16-5/16" | 5"       | 1         |

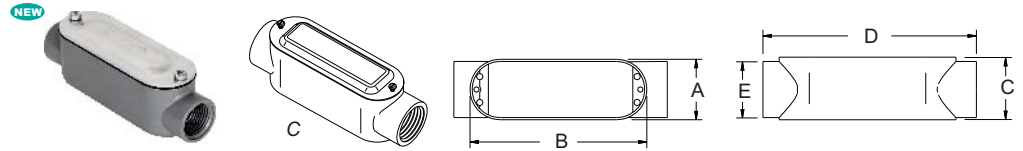

**DIE CAST COPPER-FREE ALUMINUM THREADED CONDUIT BODIES "T" SERIES**

**PRODUCT FEATURES**

- ▶ Stamped Aluminum Cover and Neoprene Gasket included
- ▶ Gray color
- ▶ Suitable for wet location when used with Gasket and Cover
- ▶ NPT Thread Hubs

| Cat. No.                   | Trade Size | DIMENSIONS - T SERIES |          |        |          |          | Std. Pkg. |
|----------------------------|------------|-----------------------|----------|--------|----------|----------|-----------|
|                            |            | A                     | B        | C      | D        | E        |           |
| T-50AS <small>NEW</small>  | 1/2"       | 1-5/16"               | 3-7/8"   | 1-3/8" | 4-11/16" | 2-1/16"  | 10        |
| T-75AS <small>NEW</small>  | 3/4"       | 1-9/16"               | 4-11/16" | 1-5/8" | 5-1/2"   | 2-5/16"  | 10        |
| T-100AS <small>NEW</small> | 1"         | 1-13/16"              | 5-3/8"   | 1-7/8" | 6-7/16"  | 2-11/16" | 5         |
| T-125AS <small>NEW</small> | 1-1/4"     | 2-1/2"                | 7-5/16"  | 2-1/2" | 8-3/8"   | 3-1/2"   | 2         |
| T-150AS <small>NEW</small> | 1-1/2"     | 2-1/2"                | 7-5/16"  | 2-1/2" | 8-3/8"   | 3-1/2"   | 2         |
| T-200AS <small>NEW</small> | 2"         | 3-3/16"               | 9-1/2"   | 3-3/8" | 10-9/16" | 4-5/16"  | 1         |
| T-250AS <small>NEW</small> | 2-1/2"     | 4-1/2"                | 12-1/16" | 4"     | 13-1/2"  | 5-7/8"   | 1         |
| T-300AS <small>NEW</small> | 3"         | 4-1/2"                | 12-1/16" | 4-1/2" | 13-1/2"  | 5-7/8"   | 1         |
| T-400AS <small>NEW</small> | 4"         | 5-9/16"               | 15-1/16" | 5-5/8" | 16-5/16" | 7-11/16" | 1         |

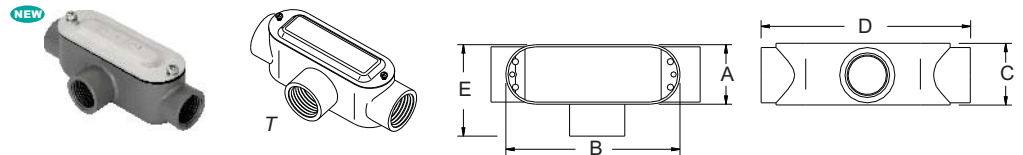

## FULL LINE OF WEATHERPROOF PRODUCTS

AVAILABLE ON OUR WEBSITE OR IN THE **C** SECTION



# E5 | Rigid Conduit Bodies - Aluminum

## MOGUL THREADED COPPER-FREE ALUMINUM ALLOY EXTRA-LARGE RIGID CONDUIT BODIES "LB" SERIES

### PRODUCT FEATURES

- ▶ Die Cast Aluminum Cover included
- ▶ Fiber Gasket included
- ▶ Suitable for wet location when used with Gasket and Cover
- ▶ NPT Thread Hubs



| Cat. No. | Trade Size | DIMENSIONS - LB SERIES |          |          |        |         |        | Std. Pkg. |
|----------|------------|------------------------|----------|----------|--------|---------|--------|-----------|
|          |            | A                      | B        | C1       | C2     | D       | E      |           |
| LBM-150  | 1-1/2"     | 3"                     | 13-7/16" | 5"       | 4"     | 14-1/4" | 2-3/4" | 1         |
| LBM-200  | 2"         | 3"                     | 13-7/16" | 5"       | 4"     | 14-1/4" | 2-3/4" | 1         |
| LBM-250  | 2-1/2"     | 4-5/8"                 | 21-7/8"  | 8-11/16" | 5-1/8" | 22-3/4" | 4-1/4" | 1         |
| LBM-300  | 3"         | 4-5/8"                 | 21-7/8"  | 8-11/16" | 5-1/8" | 22-3/4" | 4-1/4" | 1         |
| LBM-350  | 3-1/2"     | 5-5/8"                 | 28-1/2"  | 10"      | 6-1/8" | 29-1/8" | 5-1/8" | 1         |
| LBM-400  | 4"         | 5-5/8"                 | 28-1/2"  | 10"      | 6-1/8" | 29-1/8" | 5-1/8" | 1         |

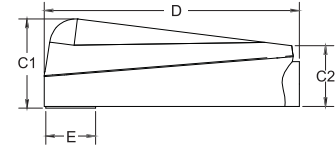
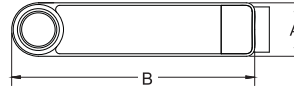

## DIE CAST COPPER-FREE ALUMINUM THREADED CONDUIT BODIES "LB" SERIES WITHOUT COVERS

### PRODUCT FEATURES

- ▶ Gray color
- ▶ Suitable for wet location when used with Gasket and Cover
- ▶ NPT Thread Hubs

| Cat. No. | Trade Size | DIMENSIONS - LB SERIES |          |          |           |          | Std. Pkg. |
|----------|------------|------------------------|----------|----------|-----------|----------|-----------|
|          |            | A                      | B        | C        | D         | E        |           |
| LB-50    | 1/2"       | 1-5/16"                | 3-7/8"   | 2-1/8"   | 4-5/16"   | 1-1/16"  | 10        |
| LB-75    | 3/4"       | 1-9/16"                | 4-11/16" | 2-3/8"   | 5-1/8"    | 1-5/16"  | 10        |
| LB-100   | 1"         | 1-13/16"               | 5-3/8"   | 2-3/4"   | 5-15/16"  | 1-9/16"  | 5         |
| LB-125   | 1-1/4"     | 2-1/2"                 | 7-5/16"  | 3-1/2"   | 7-13/16"  | 2"       | 2         |
| LB-150   | 1-1/2"     | 2-1/2"                 | 7-5/16"  | 3-1/2"   | 7-13/16"  | 2-3/16"  | 2         |
| LB-200   | 2"         | 3-3/16"                | 9-1/2"   | 4-1/2"   | 10-1/16"  | 2-11/16" | 1         |
| LB-250   | 2-1/2"     | 4-1/2"                 | 12-1/16" | 5-5/16"  | 12-13/16" | 3-5/16"  | 1         |
| LB-300   | 3"         | 4-1/2"                 | 12-1/16" | 5-15/16" | 12-13/16" | 3-15/16" | 1         |
| LB-350   | 3-1/2"     | 5-9/16"                | 15-1/16" | 7-5/16"  | 15-5/8"   | 4-9/16"  | 1         |
| LB-400   | 4"         | 5-9/16"                | 15-7/16" | 7-5/16"  | 15-5/8"   | 5"       | 1         |

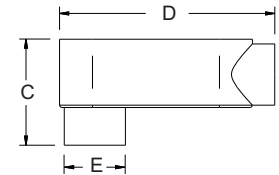
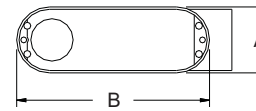
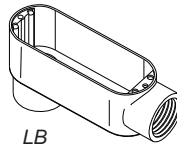

## DIE CAST COPPER-FREE ALUMINUM THREADED CONDUIT BODIES "LL" SERIES WITHOUT COVERS

### PRODUCT FEATURES

- ▶ Gray color
- ▶ Suitable for wet location when used with Gasket and Cover
- ▶ NPT Thread Hubs

| Cat. No. | Trade Size | DIMENSIONS - LL SERIES |          |          |           |        | Std. Pkg. |
|----------|------------|------------------------|----------|----------|-----------|--------|-----------|
|          |            | A                      | B        | C        | D         | E      |           |
| LL-50    | 1/2"       | 1-5/16"                | 3-7/8"   | 2-1/16"  | 4-5/16"   | 1-3/8" | 10        |
| LL-75    | 3/4"       | 1-9/16"                | 4-11/16" | 2-5/16"  | 5-1/8"    | 1-5/8" | 10        |
| LL-100   | 1"         | 1-13/16"               | 5-3/8"   | 2-11/16" | 5-15/16"  | 1-7/8" | 5         |
| LL-125   | 1-1/4"     | 2-1/2"                 | 7-5/16"  | 3-1/2"   | 7-13/16"  | 2-1/2" | 2         |
| LL-150   | 1-1/2"     | 2-1/2"                 | 7-5/16"  | 3-1/2"   | 7-13/16"  | 2-1/2" | 2         |
| LL-200   | 2"         | 3-3/16"                | 9-1/2"   | 4-5/16"  | 10-1/16"  | 3-3/8" | 1         |
| LL-250   | 2-1/2"     | 4-1/2"                 | 12-1/16" | 5-7/8"   | 12-13/16" | 4"     | 1         |
| LL-300   | 3"         | 4-1/2"                 | 12-1/16" | 5-7/8"   | 12-13/16" | 4-1/2" | 1         |
| LL-400   | 4"         | 5-9/16"                | 15-7/16" | 7-11/16" | 15-5/8"   | 5-5/8" | 1         |

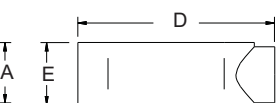
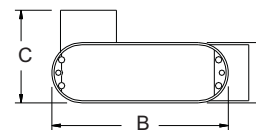
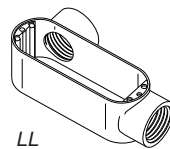

**DIE CAST COPPER-FREE ALUMINUM THREADED CONDUIT BODIES "LR" SERIES WITHOUT COVERS**

**PRODUCT FEATURES**

- ▶ Gray color
- ▶ Suitable for wet location when used with Gasket and Cover
- ▶ NPT Thread Hubs

| Cat. No. | Trade Size | DIMENSIONS - LR SERIES |          |          |           |        | Std. Pkg. |
|----------|------------|------------------------|----------|----------|-----------|--------|-----------|
|          |            | A                      | B        | C        | D         | E      |           |
| LR-50    | 1/2"       | 1-5/16"                | 3-7/8"   | 2-1/16"  | 4-5/16"   | 1-3/8" | 10        |
| LR-75    | 3/4"       | 1-9/16"                | 4-11/16" | 2-5/16"  | 5-1/8"    | 1-5/8" | 10        |
| LR-100   | 1"         | 1-13/16"               | 5-3/8"   | 2-11/16" | 5-15/16"  | 1-7/8" | 5         |
| LR-125   | 1-1/4"     | 2-1/2"                 | 7-5/16"  | 3-1/2"   | 7-13/16"  | 2-1/2" | 2         |
| LR-150   | 1-1/2"     | 2-1/2"                 | 7-5/16"  | 3-1/2"   | 7-13/16"  | 2-1/2" | 2         |
| LR-200   | 2"         | 3-3/16"                | 9-1/2"   | 4-5/16"  | 10-1/16"  | 3-3/8" | 1         |
| LR-250   | 2-1/2"     | 4-1/2"                 | 12-1/16" | 5-7/8"   | 12-13/16" | 4"     | 1         |
| LR-300   | 3"         | 4-1/2"                 | 12-1/16" | 5-7/8"   | 12-13/16" | 4-1/2" | 1         |
| LR-400   | 4"         | 5-9/16"                | 15-1/16" | 7-11/16" | 15-5/8"   | 5-5/8" | 1         |

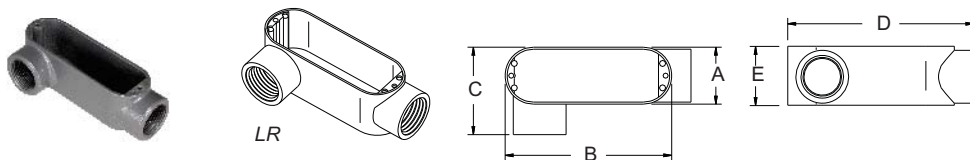

**DIE CAST COPPER-FREE ALUMINUM THREADED CONDUIT BODIES "C" SERIES WITHOUT COVERS**

**PRODUCT FEATURES**

- ▶ Gray color
- ▶ Suitable for wet location when used with Gasket and Cover
- ▶ NPT Thread Hubs

| Cat. No. | Trade Size | DIMENSIONS - C SERIES |          |        |          |          | Std. Pkg. |
|----------|------------|-----------------------|----------|--------|----------|----------|-----------|
|          |            | A                     | B        | C      | D        | E        |           |
| C-50     | 1/2"       | 1-5/16"               | 3-7/8"   | 1-3/8" | 4-11/16" | 1-1/16"  | 10        |
| C-75     | 3/4"       | 1-9/16"               | 4-11/16" | 1-5/8" | 5-1/2"   | 1-5/16"  | 10        |
| C-100    | 1"         | 1-13/16"              | 5-3/8"   | 1-7/8" | 6-7/16"  | 1-9/16"  | 5         |
| C-125    | 1-1/4"     | 2-1/2"                | 7-5/16"  | 2-1/2" | 8-3/8"   | 2"       | 2         |
| C-150    | 1-1/2"     | 2-1/2"                | 7-5/16"  | 2-1/2" | 8-3/8"   | 2-3/16"  | 2         |
| C-200    | 2"         | 3-3/16"               | 9-1/2"   | 3-3/8" | 10-9/16" | 2-11/16" | 1         |
| C-250    | 2-1/2"     | 4-1/2"                | 12-1/16" | 4"     | 13-1/2"  | 3-5/16"  | 1         |
| C-300    | 3"         | 4-1/2"                | 12-1/16" | 4-1/2" | 13-1/2"  | 3-15/16" | 1         |
| C-400    | 4"         | 5-9/16"               | 15-1/16" | 5-5/8" | 16-5/16" | 4-9/16"  | 1         |

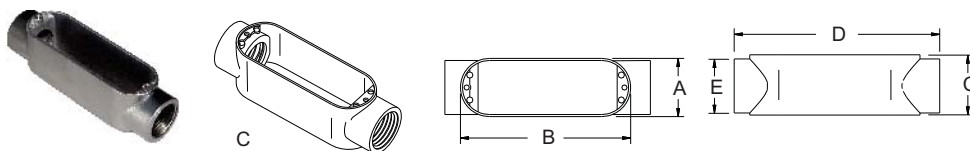

**DIE CAST COPPER-FREE ALUMINUM THREADED CONDUIT BODIES "T" SERIES WITHOUT COVERS**

**PRODUCT FEATURES**

- ▶ Gray color
- ▶ Suitable for wet location when used with Gasket and Cover
- ▶ NPT Thread Hubs

| Cat. No. | Trade Size | DIMENSIONS - T SERIES |          |        |          |          | Std. Pkg. |
|----------|------------|-----------------------|----------|--------|----------|----------|-----------|
|          |            | A                     | B        | C      | D        | E        |           |
| T-50     | 1/2"       | 1-5/16"               | 3-7/8"   | 1-3/8" | 4-11/16" | 2-1/16"  | 10        |
| T-75     | 3/4"       | 1-9/16"               | 4-11/16" | 1-5/8" | 5-1/2"   | 2-5/16"  | 10        |
| T-100    | 1"         | 1-13/16"              | 5-3/8"   | 1-7/8" | 6-7/16"  | 2-11/16" | 5         |
| T-125    | 1-1/4"     | 2-1/2"                | 7-5/16"  | 2-1/2" | 8-3/8"   | 3-1/2"   | 2         |
| T-150    | 1-1/2"     | 2-1/2"                | 7-5/16"  | 2-1/2" | 8-3/8"   | 3-1/2"   | 2         |
| T-200    | 2"         | 3-3/16"               | 9-1/2"   | 3-3/8" | 10-9/16" | 4-5/16"  | 1         |
| T-250    | 2-1/2"     | 4-1/2"                | 12-1/16" | 4"     | 13-1/2"  | 5-7/8"   | 1         |
| T-300    | 3"         | 4-1/2"                | 12-1/16" | 4-1/2" | 13-1/2"  | 5-7/8"   | 1         |
| T-400    | 4"         | 5-9/16"               | 15-1/16" | 5-5/8" | 16-5/16" | 7-11/16" | 1         |

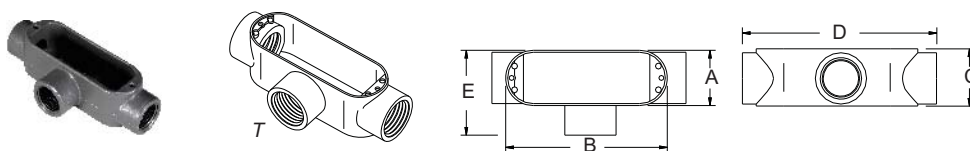

Conduit Bodies

# E7 | Rigid Conduit Bodies - Malleable Iron

## MALLEABLE IRON THREADED CONDUIT BODIES "LB" SERIES

### PRODUCT FEATURES

- ▶ Electroplated Zinc
- ▶ Suitable for wet location when used with Gasket and Cover
- ▶ NPT Thread Hubs

| Cat. No. | Trade Size | DIMENSIONS - LB SERIES |          |          |           |          | Std. Pkg. |
|----------|------------|------------------------|----------|----------|-----------|----------|-----------|
|          |            | A                      | B        | C        | D         | E        |           |
| MLB-50   | 1/2"       | 1-3/8"                 | 4"       | 2-3/16"  | 4-5/8"    | 1-1/2"   | 10        |
| MLB-75   | 3/4"       | 1-5/8"                 | 4-11/16" | 2-3/8"   | 5-3/8"    | 1-11/16" | 10        |
| MLB-100  | 1"         | 1-13/16"               | 5-3/8"   | 2-7/8"   | 6-1/4"    | 2"       | 5         |
| MLB-125  | 1-1/4"     | 2-1/2"                 | 7-1/4"   | 3-1/2"   | 8-1/8"    | 2-5/8"   | 2         |
| MLB-150  | 1-1/2"     | 2-1/2"                 | 7-1/4"   | 3-11/16" | 8-1/8"    | 2-13/16" | 2         |
| MLB-200  | 2"         | 3-1/8"                 | 9-1/2"   | 4-1/2"   | 10-1/2"   | 3-1/2"   | 1         |
| MLB-250  | 2-1/2"     | 4-3/8"                 | 12-1/4"  | 5-7/16"  | 13-3/4"   | 4"       | 1         |
| MLB-300  | 3"         | 4-3/8"                 | 12-1/4"  | 6-3/16"  | 13-13/16" | 4-5/8"   | 1         |
| MLB-350  | 3-1/2"     | 5-1/2"                 | 15"      | 7-3/16"  | 16-5/8"   | 5-7/16"  | 1         |
| MLB-400  | 4"         | 5-1/2"                 | 15"      | 7-3/8"   | 16-3/4"   | 5-3/4"   | 1         |

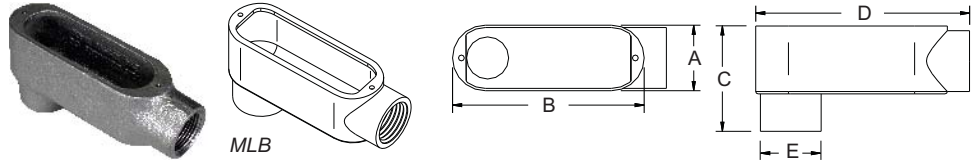

## MALLEABLE IRON THREADED CONDUIT BODIES "LL" SERIES

### PRODUCT FEATURES

- ▶ Electroplated Zinc
- ▶ Suitable for wet location when used with Gasket and Cover
- ▶ NPT Thread Hubs

| Cat. No. | Trade Size | DIMENSIONS - LL SERIES |          |          |           |          | Std. Pkg. |
|----------|------------|------------------------|----------|----------|-----------|----------|-----------|
|          |            | A                      | B        | C        | D         | E        |           |
| MLL-50   | 1/2"       | 1-3/8"                 | 4"       | 2-1/16"  | 4-11/16"  | 1-7/16"  | 10        |
| MLL-75   | 3/4"       | 1-5/8"                 | 4-11/16" | 2-1/4"   | 5-7/16"   | 1-11/16" | 10        |
| MLL-100  | 1"         | 1-13/16"               | 5-3/8"   | 2-11/16" | 6-1/4"    | 2"       | 5         |
| MLL-125  | 1-1/4"     | 2-1/2"                 | 7-1/4"   | 3-7/16"  | 8-1/8"    | 2-5/8"   | 2         |
| MLL-150  | 1-1/2"     | 2-1/2"                 | 7-1/4"   | 3-7/16"  | 8-1/8"    | 2-13/16" | 2         |
| MLL-200  | 2"         | 3-1/8"                 | 9-1/2"   | 4-3/16"  | 10-1/2"   | 3-9/16"  | 1         |
| MLL-250  | 2-1/2"     | 4-3/8"                 | 12-1/4"  | 5-7/8"   | 13-3/4"   | 4"       | 1         |
| MLL-300  | 3"         | 4-3/8"                 | 12-1/4"  | 5-15/16" | 13-13/16" | 4-11/16" | 1         |
| MLL-350  | 3-1/2"     | 5-1/2"                 | 15"      | 7-1/8"   | 16-5/8"   | 5-7/16"  | 1         |
| MLL-400  | 4"         | 5-1/2"                 | 15"      | 7-3/16"  | 16-5/8"   | 5-3/4"   | 1         |

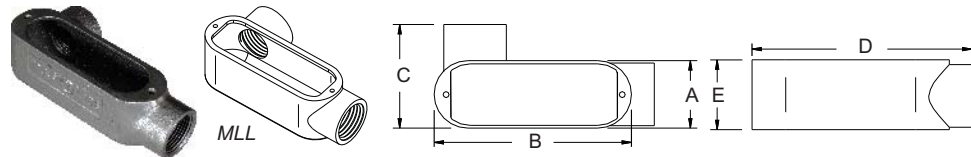

## MALLEABLE IRON THREADED CONDUIT BODIES "LR" SERIES

### PRODUCT FEATURES

- ▶ Electroplated Zinc
- ▶ Suitable for wet location when used with Gasket and Cover
- ▶ NPT Thread Hubs

| Cat. No. | Trade Size | DIMENSIONS - LR SERIES |          |          |           |          | Std. Pkg. |
|----------|------------|------------------------|----------|----------|-----------|----------|-----------|
|          |            | A                      | B        | C        | D         | E        |           |
| MLR-50   | 1/2"       | 1-3/8"                 | 4"       | 2-1/16"  | 4-11/16"  | 1-7/16"  | 10        |
| MLR-75   | 3/4"       | 1-9/16"                | 4-11/16" | 2-1/4"   | 5-7/16"   | 1-11/16" | 10        |
| MLR-100  | 1"         | 1-13/16"               | 5-3/8"   | 2-11/16" | 6-5/16"   | 2"       | 5         |
| MLR-125  | 1-1/4"     | 2-1/2"                 | 7-1/4"   | 3-3/8"   | 8-1/8"    | 2-5/8"   | 2         |
| MLR-150  | 1-1/2"     | 2-1/2"                 | 7-1/4"   | 3-7/16"  | 8-1/8"    | 2-13/16" | 2         |
| MLR-200  | 2"         | 3-3/16"                | 9-1/2"   | 4-1/8"   | 10-1/2"   | 3-1/2"   | 1         |
| MLR-250  | 2-1/2"     | 4-7/16"                | 12-1/4"  | 5-7/8"   | 13-3/4"   | 4"       | 1         |
| MLR-300  | 3"         | 4-7/16"                | 12-1/4"  | 5-15/16" | 13-13/16" | 4-11/16" | 1         |
| MLR-350  | 3-1/2"     | 5-1/2"                 | 15"      | 7-1/8"   | 16-5/8"   | 5-7/16"  | 1         |
| MLR-400  | 4"         | 5-1/2"                 | 15"      | 7-3/16"  | 16-5/8"   | 5-3/4"   | 1         |

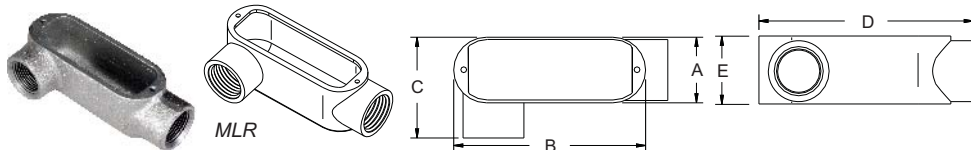

## MALLEABLE IRON THREADED CONDUIT BODIES "C" SERIES

### PRODUCT FEATURES

- ▶ Electroplated Zinc
- ▶ Suitable for wet location when used with Gasket and Cover
- ▶ NPT Thread Hubs

| Cat. No. | Trade Size | DIMENSIONS - C SERIES |          |          |          | Std. Pkg. |
|----------|------------|-----------------------|----------|----------|----------|-----------|
|          |            | A                     | B        | C        | D        |           |
| MC-50    | 1/2"       | 1-3/8"                | 4"       | 1-1/2"   | 5-7/16"  | 10        |
| MC-75    | 3/4"       | 1-9/16"               | 4-11/16" | 1-11/16" | 6-3/16"  | 10        |
| MC-100   | 1"         | 1-13/16"              | 5-7/16"  | 2"       | 7-3/16"  | 5         |
| MC-125   | 1-1/4"     | 2-1/2"                | 7-1/4"   | 2-5/8"   | 9-1/16"  | 2         |
| MC-150   | 1-1/2"     | 2-1/2"                | 7-1/4"   | 2-13/16" | 9-1/16"  | 2         |
| MC-200   | 2"         | 3-3/16"               | 9-1/2"   | 3-1/2"   | 11-1/2"  | 1         |
| MC-250   | 2-1/2"     | 4-7/16"               | 12-1/4"  | 4"       | 15-5/16" | 1         |
| MC-300   | 3"         | 4-7/16"               | 12-1/4"  | 4-5/8"   | 15-7/16" | 1         |
| MC-350   | 3-1/2"     | 5-1/2"                | 15"      | 5-7/16"  | 18-5/16" | 1         |
| MC-400   | 4"         | 5-1/2"                | 15"      | 5-3/4"   | 18-5/16" | 1         |

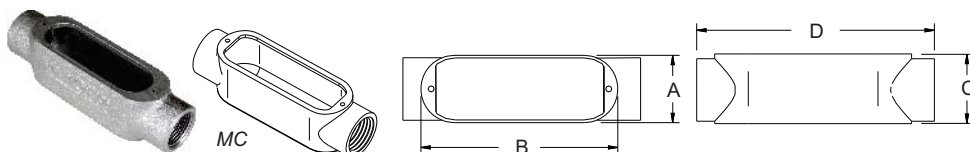

## MALLEABLE IRON THREADED CONDUIT BODIES "T" SERIES

### PRODUCT FEATURES

- ▶ Electroplated Zinc
- ▶ Suitable for wet location when used with Gasket and Cover
- ▶ NPT Thread Hubs

| Cat. No. | Trade Size | DIMENSIONS - T SERIES |          |          |          |          | Std. Pkg. |
|----------|------------|-----------------------|----------|----------|----------|----------|-----------|
|          |            | A                     | B        | C        | D        | E        |           |
| MT-50    | 1/2"       | 1-3/8"                | 4"       | 2-1/16"  | 5-7/16"  | 1-7/16"  | 10        |
| MT-75    | 3/4"       | 1-5/8"                | 4-11/16" | 2-5/16"  | 6-3/16"  | 1-11/16" | 10        |
| MT-100   | 1"         | 1-13/16"              | 5-3/8"   | 2-11/16" | 7-3/16"  | 2"       | 5         |
| MT-125   | 1-1/4"     | 2-1/2"                | 7-1/4"   | 3-7/16"  | 9"       | 2-11/16" | 2         |
| MT-150   | 1-1/2"     | 2-1/2"                | 7-1/4"   | 3-7/16"  | 9-1/16"  | 2-13/16" | 2         |
| MT-200   | 2"         | 3-3/16"               | 9-1/2"   | 4-1/8"   | 11-1/2"  | 3-1/2"   | 1         |
| MT-250   | 2-1/2"     | 4-7/16"               | 12-1/4"  | 5-7/8"   | 15-5/16" | 4"       | 1         |
| MT-300   | 3"         | 4-7/16"               | 12-1/4"  | 5-15/16" | 15-7/16" | 4-11/16" | 1         |
| MT-350   | 3-1/2"     | 5-1/2"                | 15"      | 7-1/8"   | 18-5/16" | 5-7/16"  | 1         |
| MT-400   | 4"         | 5-1/2"                | 15"      | 7-3/16"  | 18-5/16" | 5-3/4"   | 1         |

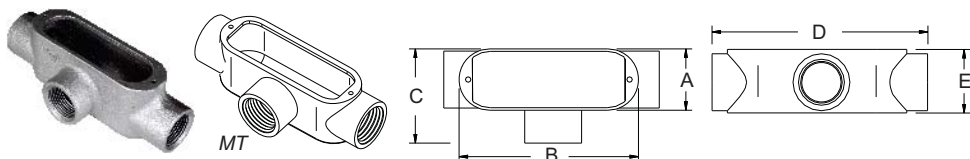

## MALLEABLE IRON CONDUIT BODY COVERS

### PRODUCT FEATURES

- ▶ Electroplated Zinc
- ▶ Stainless Steel Screws
- ▶ For use with Malleable Iron Conduit Bodies
- ▶ Gasket not included (see pg. E11 for gaskets)

| Cat. No.    | Trade Size          | DIMENSIONS |          |         | Std. Pkg. |
|-------------|---------------------|------------|----------|---------|-----------|
|             |                     | L          | W        | H       |           |
| MIC-50      | NEW 1/2"            | 3-15/16"   | 1-5/16"  | 3/16"   | 10        |
| MIC-75      | NEW 3/4"            | 4-11/16"   | 1-9/16"  | 3/16"   | 10        |
| MIC-100     | NEW 1"              | 5-3/8"     | 1-13/16" | 1/4"    | 5         |
| MIC-125/150 | NEW 1-1/4" - 1-1/2" | 9-1/2"     | 3-3/16"  | 5/16"   | 25        |
| MIC-200     | NEW 2"              | 7-1/4"     | 2-1/2"   | 5/16"   | 25        |
| MIC-250/300 | NEW 2-1/2" - 3"     | 12-1/4"    | 4-7/16"  | 1-1/16" | 10        |
| MIC-350/400 | NEW 3-1/2" - 4"     | 15"        | 5-1/2"   | 1-1/8"  | 10        |



# E9 | EMT Conduit Bodies - Aluminum

## COPPER-FREE ALUMINUM ALLOY EMT CONDUIT BODIES SET-SCREW TYPE "LB" SERIES

### PRODUCT FEATURES

- ▶ Plated Steel Set-Screws

| Cat. No. | Trade Size | DIMENSIONS - LB SERIES |          |         |          |          | Std. Pkg. | Master Ctn. |
|----------|------------|------------------------|----------|---------|----------|----------|-----------|-------------|
|          |            | A                      | B        | C       | D        | E        |           |             |
| SSLB-50  | 1/2"       | 1-5/16"                | 3-15/16" | 2-1/16" | 4-3/8"   | 1-1/16"  | 10        | 100         |
| SSLB-75  | 3/4"       | 1-9/16"                | 4-5/8"   | 2-3/8"  | 5-1/8"   | 1-5/16"  | 10        | 50          |
| SSLB-100 | 1"         | 1-13/16"               | 5-3/8"   | 2-7/8"  | 6"       | 1-9/16"  | 5         | 25          |
| SSLB-125 | 1-1/4"     | 2-1/2"                 | 7-1/4"   | 3-6/16" | 7-11/16" | 2"       | 2         | 10          |
| SSLB-150 | 1-1/2"     | 2-1/2"                 | 7-1/4"   | 3-9/16" | 7-11/16" | 2-1/4"   | 2         | 10          |
| SSLB-200 | 2"         | 3-1/8"                 | 9-1/2"   | 4-3/8"  | 10"      | 2-11/16" | 1         | 5           |
| SSLB-250 | 2-1/2"     | 4-7/16"                | 12-1/8"  | 5-3/16" | 12-3/4"  | 3-3/8"   | -         | 1           |
| SSLB-300 | 3"         | 4-7/16"                | 12-1/8"  | 5-3/4"  | 12-3/4"  | 4"       | -         | 1           |
| SSLB-350 | 3-1/2"     | 5-1/2"                 | 15-1/16" | 7-1/16" | 15-9/16" | 5"       | -         | 1           |
| SSLB-400 | 4"         | 5-1/2"                 | 15-1/16" | 7-1/16" | 15-9/16" | 5"       | -         | 1           |

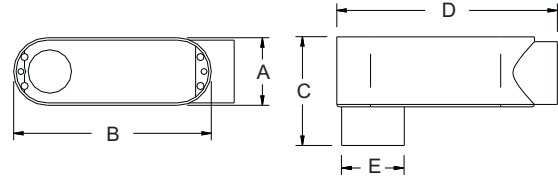

## COPPER-FREE ALUMINUM ALLOY EMT CONDUIT BODIES SET-SCREW TYPE "LR" SERIES

### PRODUCT FEATURES

- ▶ Plated Steel Set-Screws

| Cat. No. | Trade Size | DIMENSIONS - LR SERIES |          |         |          |          | Std. Pkg. | Master Ctn. |
|----------|------------|------------------------|----------|---------|----------|----------|-----------|-------------|
|          |            | A                      | B        | C       | D        | E        |           |             |
| SSLR-50  | 1/2"       | 1-5/16"                | 3-15/16" | 2"      | 4-3/8"   | 1-5/16"  | 10        | 100         |
| SSLR-75  | 3/4"       | 1-9/16"                | 4-5/8"   | 2-1/4"  | 5-1/8"   | 1-5/8"   | 10        | 50          |
| SSLR-100 | 1"         | 1-13/16"               | 5-3/8"   | 2-3/4"  | 6"       | 1-15/16" | 5         | 25          |
| SSLR-125 | 1-1/4"     | 2-1/2"                 | 7-1/4"   | 3-7/16" | 7-11/16" | 2-1/2"   | 2         | 10          |
| SSLR-150 | 1-1/2"     | 2-1/2"                 | 7-1/4"   | 3-7/16" | 7-11/16" | 2-11/16" | 2         | 10          |
| SSLR-200 | 2"         | 3-1/8"                 | 9-1/2"   | 4-3/16" | 10"      | 3-3/8"   | 1         | 5           |

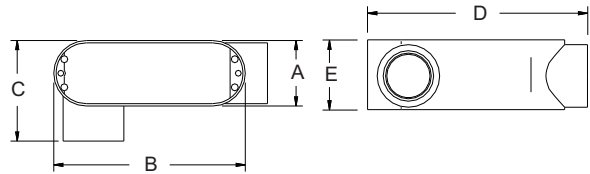

## COPPER-FREE ALUMINUM ALLOY EMT CONDUIT BODIES SET-SCREW TYPE "LL" SERIES

### PRODUCT FEATURES

- ▶ Plated Steel Set-Screws

| Cat. No. | Trade Size | DIMENSIONS - LL SERIES |          |         |          |          | Std. Pkg. | Master Ctn. |
|----------|------------|------------------------|----------|---------|----------|----------|-----------|-------------|
|          |            | A                      | B        | C       | D        | E        |           |             |
| SLL-50   | 1/2"       | 1-5/16"                | 3-15/16" | 2"      | 4-3/8"   | 1-5/16"  | 10        | 100         |
| SLL-75   | 3/4"       | 1-9/16"                | 4-5/8"   | 2-1/4"  | 5-1/8"   | 1-5/8"   | 10        | 50          |
| SLL-100  | 1"         | 1-13/16"               | 5-3/8"   | 2-3/4"  | 6"       | 1-15/16" | 5         | 25          |
| SLL-125  | 1-1/4"     | 2-1/2"                 | 7-1/4"   | 3-7/16" | 7-11/16" | 2-1/2"   | 2         | 10          |
| SLL-150  | 1-1/2"     | 2-1/2"                 | 7-1/4"   | 3-7/16" | 7-11/16" | 2-11/16" | 2         | 10          |
| SLL-200  | 2"         | 3-1/8"                 | 9-1/2"   | 4-3/16" | 10"      | 3-3/8"   | 1         | 5           |

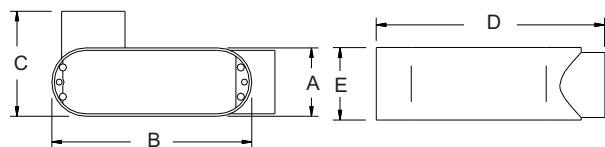



**COPPER-FREE ALUMINUM ALLOY**  
**EMT CONDUIT BODIES**  
**SET-SCREW TYPE**  
**"C" SERIES**

**PRODUCT FEATURES**

- ▶ Plated Steel Set-Screws

| Cat. No. | Trade Size | DIMENSIONS - C SERIES |          |          |          |         | Std. Pkg. | Master Ctn. |
|----------|------------|-----------------------|----------|----------|----------|---------|-----------|-------------|
|          |            | A                     | B        | C        | D        | E       |           |             |
| SSC-50   | 1/2"       | 1-5/16"               | 3-15/16" | 1-5/16"  | 4-3/4"   | 1-1/8"  | 10        | 100         |
| SSC-75   | 3/4"       | 1-9/16"               | 4-5/8"   | 1-5/8"   | 5-5/8"   | 1-5/16" | 10        | 50          |
| SSC-100  | 1"         | 1-13/16"              | 5-3/8"   | 1-15/16" | 6-11/16" | 1-1/2"  | 5         | 25          |
| SSC-125  | 1-1/4"     | 2-1/2"                | 7-1/4"   | 2-1/2"   | 8-1/8"   | 2"      | 2         | 10          |
| SSC-150  | 1-1/2"     | 2-1/2"                | 7-1/4"   | 2-11/16" | 8-1/8"   | 2-1/4"  | 2         | 10          |
| SSC-200  | 2"         | 3-1/8"                | 9-1/2"   | 3-3/8"   | 10-9/16" | 2-3/4"  | 1         | 5           |

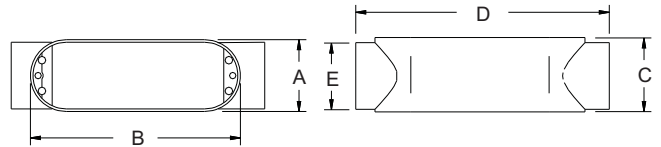

**COPPER-FREE ALUMINUM ALLOY**  
**EMT CONDUIT BODIES**  
**SET-SCREW TYPE**  
**"T" SERIES**

**PRODUCT FEATURES**

- ▶ Plated Steel Set-Screws

| Cat. No. | Trade Size | DIMENSIONS - T SERIES |          |          |          |         | Std. Pkg. | Master Ctn. |
|----------|------------|-----------------------|----------|----------|----------|---------|-----------|-------------|
|          |            | A                     | B        | C        | D        | E       |           |             |
| SST-50   | 1/2"       | 1-5/16"               | 3-15/16" | 1-5/16"  | 4-3/4"   | 2"      | 10        | 100         |
| SST-75   | 3/4"       | 1-9/16"               | 4-5/8"   | 1-5/8"   | 5-5/8"   | 2-1/4"  | 10        | 50          |
| SST-100  | 1"         | 1-13/16"              | 5-3/8"   | 1-15/16" | 6-11/16" | 2-3/4"  | 5         | 25          |
| SST-125  | 1-1/4"     | 2-1/2"                | 7-1/4"   | 2-7/16"  | 8-1/8"   | 3-7/16" | 2         | 10          |
| SST-150  | 1-1/2"     | 2-1/2"                | 7-1/4"   | 2-11/16" | 8-1/8"   | 3-7/16" | 2         | 10          |
| SST-200  | 2"         | 3-1/8"                | 9-1/2"   | 3-3/8"   | 10-9/16" | 4-3/16" | 1         | 5           |

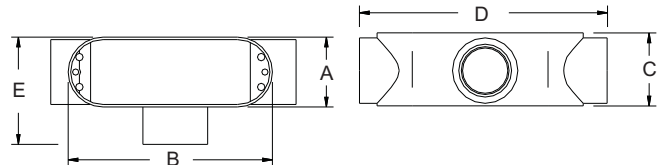

# E11 | Conduit Body Covers and Gaskets

## DIE CAST COPPER-FREE ALUMINUM COVERS & NEOPRENE GASKETS

### PRODUCT FEATURES

- ▶ Gray color
- ▶ For use with Cast Aluminum & Malleable Iron Conduit Bodies



| Cat. No.   | Trade Size      | DIMENSIONS |         |       | Std. Pkg. |
|------------|-----------------|------------|---------|-------|-----------|
|            |                 | L          | W       | H     |           |
| CG-50      | 1/2"            | 3-7/8"     | 1-5/16" | 1/4"  | 100       |
| CG-75      | 3/4"            | 4-11/16"   | 1-9/16" | 1/4"  | 50        |
| CG-100     | 1"              | 5-3/8"     | 1-3/4"  | 1/4"  | 50        |
| CG-125/150 | 1-1/4" - 1-1/2" | 7-5/16"    | 2-1/2"  | 1/4"  | 25        |
| CG-200     | 2"              | 9-1/2"     | 3-1/8"  | 5/16" | 10        |
| CG-250/300 | 2-1/2" - 3"     | 12-1/16"   | 4-7/16" | 3/8"  | 10        |
| CG-350/400 | 3-1/2" - 4"     | 15-1/16"   | 5-9/16" | 3/8"  | 5         |



## NEOPRENE GASKETS

### PRODUCT FEATURES

- ▶ For use with Cast Aluminum & Malleable Iron Conduit Bodies
- ▶ Black color



| Cat. No.  | Trade Size      | DIMENSIONS |         |       | Std. Pkg. |
|-----------|-----------------|------------|---------|-------|-----------|
|           |                 | L          | W       | H     |           |
| G-50      | 1/2"            | 3-11/16"   | 1-3/8"  | 1/16" | 100       |
| G-75      | 3/4"            | 4-1/4"     | 1-1/2"  | 1/16" | 100       |
| G-100     | 1"              | 5"         | 1-3/4"  | 1/16" | 50        |
| G-125/150 | 1-1/4" - 1-1/2" | 6"         | 2-7/16" | 1/16" | 50        |
| G-200     | 2"              | 7"         | 3"      | 1/16" | 50        |
| G-250/300 | 2-1/2" - 3"     | 9"         | 4-1/4"  | 1/16" | 25        |
| G-350/400 | 3-1/2" - 4"     | 11"        | 5-1/4"  | 1/16" | 25        |



## STEEL RAISED DOME COVERS

### PRODUCT FEATURES

- ▶ Stamped Steel
- ▶ Stainless Steel Screws
- ▶ Gasket not included
- ▶ For use with Cast Aluminum & Malleable Iron Conduit Bodies

| Cat. No.   | Trade Size      | DIMENSIONS |          |       | Std. Pkg. |
|------------|-----------------|------------|----------|-------|-----------|
|            |                 | L          | W        | H     |           |
| SC-50      | 1/2"            | 4"         | 1-3/8"   | 1/4"  | 100       |
| SC-75      | 3/4"            | 4-11/16"   | 1-9/16"  | 5/16" | 50        |
| SC-100     | 1"              | 5-3/8"     | 1-13/16" | 3/8"  | 50        |
| SC-125/150 | 1-1/4" - 1-1/2" | 7-1/4"     | 2-1/2"   | 7/16" | 25        |
| SC-200     | 2"              | 9-1/2"     | 3-1/8"   | 1/2"  | 10        |
| SC-250/300 | 2-1/2" - 3"     | 12-1/4"    | 4-7/16"  | 3/4"  | 10        |
| SC-350/400 | 3-1/2" - 4"     | 15"        | 5-1/2"   | 3/4"  | 5         |

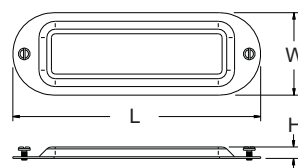
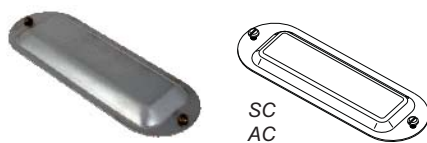

## ALUMINUM CONDUIT BODY COVERS

### PRODUCT FEATURES

- ▶ Stamped Aluminum
- ▶ Stainless Steel Screws
- ▶ Gasket not included
- ▶ For use with Cast Aluminum & Malleable Iron Conduit Bodies

| Cat. No.   | Trade Size      | DIMENSIONS |         |       | Std. Pkg. |
|------------|-----------------|------------|---------|-------|-----------|
|            |                 | L          | W       | H     |           |
| AC-50      | 1/2"            | 3-15/16"   | 1-3/8"  | 1/4"  | 100       |
| AC-75      | 3/4"            | 4-11/16"   | 1-1/2"  | 5/16" | 50        |
| AC-100     | 1"              | 5-3/8"     | 1-3/4"  | 3/8"  | 50        |
| AC-125/150 | 1-1/4" - 1-1/2" | 7-1/4"     | 2-1/2"  | 7/16" | 25        |
| AC-200     | 2"              | 9-1/2"     | 3-1/8"  | 1/2"  | 10        |
| AC-250/300 | 2-1/2" - 3"     | 12-1/4"    | 4-7/16" | 3/4"  | 10        |
| AC-350/400 | 3-1/2" - 4"     | 15"        | 5-1/2"  | 3/4"  | 5         |



**SAND CAST CLASS 30 GRAY IRON ALLOY**  
**THREADED CONDUIT BODIES**  
**"LB" SERIES**  
**FORM 7**

**PRODUCT FEATURES**

- ▶ Electroplated Zinc
- ▶ Flat back design for maximum internal wiring volume
- ▶ Interchangeable with other Form 7 conduit bodies
- ▶ Suitable for wet location when used with Gasket and Cover
- ▶ Use with easy Clip-on Covers
- ▶ NPT Thread Hubs

| Cat. No. | Trade Size | DIMENSIONS - LB SERIES |          |         |           |          | Std. Pkg. | Master Ctn. |
|----------|------------|------------------------|----------|---------|-----------|----------|-----------|-------------|
|          |            | A                      | B        | C       | D         | E        |           |             |
| LB7-50   | 1/2"       | 1-3/8"                 | 3-11/16" | 2-3/16" | 4-1/2"    | 1-1/4"   | 10        | 50          |
| LB7-75   | 3/4"       | 1-5/8"                 | 4-5/16"  | 2-1/2"  | 5-1/4"    | 1-1/2"   | 5         | 25          |
| LB7-100  | 1"         | 1-13/16"               | 5-1/16"  | 2-7/8"  | 6-3/16"   | 1-13/16" | 5         | 25          |
| LB7-125  | 1-1/4"     | 2-3/16"                | 5-9/16"  | 3-1/4"  | 6-1/2"    | 2-3/16"  | 1         | 10          |
| LB7-150  | 1-1/2"     | 2-7/16"                | 6-1/16"  | 3-9/16" | 7-1/16"   | 2-7/16"  | 1         | 10          |
| LB7-200  | 2"         | 3"                     | 7-1/16"  | 4-1/8"  | 8-1/8"    | 3"       | 1         | 5           |
| LB7-250  | 2-1/2"     | 4-1/4"                 | 9-1/16"  | 5-1/4"  | 10-11/16" | 3-7/16"  | -         | 1           |
| LB7-300  | 3"         | 4-1/4"                 | 9-1/16"  | 6"      | 10-11/16" | 4-1/4"   | -         | 1           |
| LB7-350  | 3-1/2"     | 5-5/16"                | 11"      | 6-9/16" | 12-3/4"   | 4-3/4"   | -         | 1           |
| LB7-400  | 4"         | 5-5/16"                | 11"      | 7-1/8"  | 12-3/4"   | 5-1/4"   | -         | 1           |

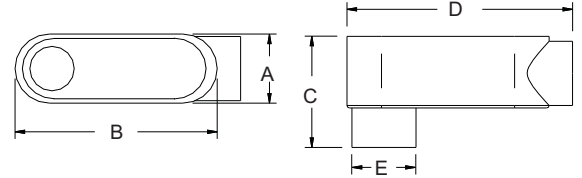

**SAND CAST CLASS 30 GRAY IRON ALLOY**  
**THREADED CONDUIT BODIES**  
**"LR" SERIES**  
**FORM 7**

**PRODUCT FEATURES**

- ▶ Electroplated Zinc
- ▶ Flat back design for maximum internal wiring volume
- ▶ Interchangeable with other Form 7 conduit bodies
- ▶ Suitable for wet location when used with Gasket and Cover
- ▶ Use with easy Clip-on Covers
- ▶ NPT Thread Hubs

| Cat. No. | Trade Size | DIMENSIONS - LR SERIES |          |         |           |          | Std. Pkg. | Master Ctn. |
|----------|------------|------------------------|----------|---------|-----------|----------|-----------|-------------|
|          |            | A                      | B        | C       | D         | E        |           |             |
| LR7-50   | 1/2"       | 1-7/16"                | 3-11/16" | 1-7/16" | 4-1/2"    | 1-3/8"   | 10        | 50          |
| LR7-75   | 3/4"       | 1-5/8"                 | 4-5/16"  | 2-1/2"  | 5-1/4"    | 1-5/8"   | 5         | 25          |
| LR7-100  | 1"         | 1-13/16"               | 5-1/16"  | 2-3/4"  | 6-3/16"   | 1-13/16" | 5         | 25          |
| LR7-125  | 1-1/4"     | 2-3/16"                | 5-9/16"  | 3-1/8"  | 6-1/2"    | 2-3/16"  | 1         | 10          |
| LR7-150  | 1-1/2"     | 2-7/16"                | 6-1/16"  | 3-3/8"  | 7-1/16"   | 2-7/16"  | 1         | 10          |
| LR7-200  | 2"         | 3"                     | 7-1/16"  | 4"      | 8-1/8"    | 3"       | 1         | 5           |
| LR7-250  | 2-1/2"     | 4-1/4"                 | 9-1/16"  | 5-7/8"  | 10-11/16" | 4-1/4"   | -         | 1           |
| LR7-300  | 3"         | 4-1/4"                 | 9-1/16"  | 5-7/8"  | 10-11/16" | 4-1/4"   | -         | 1           |
| LR7-400  | 4"         | 5-5/16"                | 11"      | 7"      | 12-3/4"   | 5-5/16"  | -         | 1           |

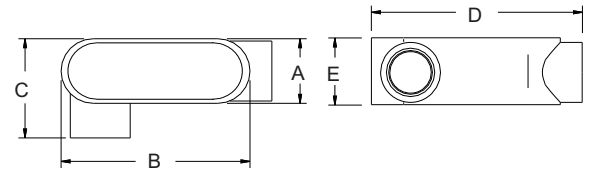

**SAND CAST CLASS 30 GRAY IRON ALLOY**  
**THREADED CONDUIT BODIES**  
**"LL" SERIES**  
**FORM 7**

**PRODUCT FEATURES**

- ▶ Electroplated Zinc
- ▶ Flat back design for maximum internal wiring volume
- ▶ Interchangeable with other Form 7 conduit bodies
- ▶ Suitable for wet location when used with Gasket and Cover
- ▶ Use with easy Clip-on Covers
- ▶ NPT Thread Hubs

| Cat. No. | Trade Size | DIMENSIONS - LL SERIES |          |         |           |          | Std. Pkg. | Master Ctn. |
|----------|------------|------------------------|----------|---------|-----------|----------|-----------|-------------|
|          |            | A                      | B        | C       | D         | E        |           |             |
| LL7-50   | 1/2"       | 1-7/16"                | 3-11/16" | 1-7/16" | 4-1/2"    | 1-3/8"   | 10        | 50          |
| LL7-75   | 3/4"       | 1-5/8"                 | 4-5/16"  | 2-1/2"  | 5-1/4"    | 1-5/8"   | 5         | 25          |
| LL7-100  | 1"         | 1-13/16"               | 5-1/16"  | 2-3/4"  | 6-3/16"   | 1-13/16" | 5         | 25          |
| LL7-125  | 1-1/4"     | 2-3/16"                | 5-9/16"  | 3-1/8"  | 6-1/2"    | 2-3/16"  | 1         | 10          |
| LL7-150  | 1-1/2"     | 2-7/16"                | 6-1/16"  | 3-3/8"  | 7-1/16"   | 2-7/16"  | 1         | 10          |
| LL7-200  | 2"         | 3"                     | 7-1/16"  | 4"      | 8-1/8"    | 3"       | 1         | 5           |
| LL7-250  | 2-1/2"     | 4-1/4"                 | 9-1/16"  | 5-7/8"  | 10-11/16" | 4-1/4"   | -         | 1           |
| LL7-300  | 3"         | 4-1/4"                 | 9-1/16"  | 5-7/8"  | 10-11/16" | 4-1/4"   | -         | 1           |
| LL7-400  | 4"         | 5-5/16"                | 11"      | 7"      | 12-3/4"   | 5-5/16"  | -         | 1           |

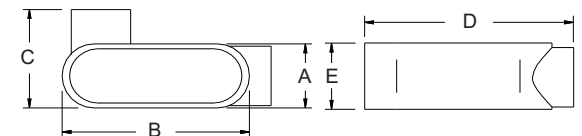

Conduit Bodies



# E13 | Rigid Conduit Bodies - Form 7

## SAND CAST CLASS 30 GRAY IRON ALLOY THREADED CONDUIT BODIES "C" SERIES FORM 7

### PRODUCT FEATURES

- ▶ Electroplated Zinc
- ▶ Flat back design for maximum internal wiring volume
- ▶ Interchangeable with other Form 7 conduit bodies
- ▶ Suitable for wet location when used with Gasket and Cover
- ▶ Use with easy Clip-on Covers
- ▶ NPT Thread Hubs

| Cat. No. | Trade Size | DIMENSIONS - C SERIES |          |          |         |          | Std. Pkg. | Master Ctn. |
|----------|------------|-----------------------|----------|----------|---------|----------|-----------|-------------|
|          |            | A                     | B        | C        | D       | E        |           |             |
| C7-50    | 1/2"       | 1-3/8"                | 3-11/16" | 1-3/8"   | 5-5/16" | 1-1/4"   | 10        | 50          |
| C7-75    | 3/4"       | 1-5/8"                | 4-5/16"  | 1-5/8"   | 6-3/16" | 1-1/2"   | 5         | 25          |
| C7-100   | 1"         | 1-13/16"              | 5-1/16"  | 1-13/16" | 7-5/16" | 1-13/16" | 5         | 25          |
| C7-125   | 1-1/4"     | 2-3/16"               | 5-9/16"  | 2-3/16"  | 7-7/16" | 2-3/16"  | 1         | 10          |
| C7-150   | 1-1/2"     | 2-7/16"               | 6-1/16"  | 2-7/16"  | 8-3/16" | 2-7/16"  | 1         | 10          |
| C7-200   | 2"         | 3"                    | 7-1/16"  | 3"       | 9-1/8"  | 3"       | 1         | 5           |
| C7-250   | 2-1/2"     | 4-1/4"                | 9-1/16"  | 4-1/4"   | 12-3/8" | 3-7/16"  | -         | 1           |
| C7-300   | 3"         | 4-1/4"                | 9-1/16"  | 4-1/4"   | 12-3/8" | 4-1/4"   | -         | 1           |

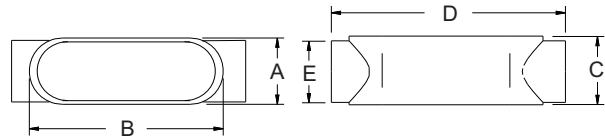

## SAND CAST CLASS 30 GRAY IRON ALLOY THREADED CONDUIT BODIES "T" SERIES FORM 7

### PRODUCT FEATURES

- ▶ Electroplated Zinc
- ▶ Flat back design for maximum internal wiring volume
- ▶ Interchangeable with other Form 7 conduit bodies
- ▶ Suitable for wet location when used with Gasket and Cover
- ▶ Use with easy Clip-on Covers
- ▶ NPT Thread Hubs

| Cat. No. | Trade Size | DIMENSIONS - T SERIES |          |          |         |        | Std. Pkg. | Master Ctn. |
|----------|------------|-----------------------|----------|----------|---------|--------|-----------|-------------|
|          |            | A                     | B        | C        | D       | E      |           |             |
| T7-50    | 1/2"       | 1-5/8"                | 3-11/16" | 1-3/4"   | 5-5/16" | 2-1/2" | 5         | 50          |
| T7-75    | 3/4"       | 1-13/16"              | 4-5/16"  | 2"       | 6-3/16" | 2-3/4" | 5         | 25          |
| T7-100   | 1"         | 1-15/16"              | 5-1/16"  | 2-1/4"   | 7-5/16" | 3"     | 2         | 20          |
| T7-125   | 1-1/4"     | 2-3/16"               | 5-9/16"  | 2-5/16"  | 7-7/16" | 3-1/8" | 1         | 10          |
| T7-150   | 1-1/2"     | 2-7/16"               | 6-1/16"  | 2-5/8"   | 8-3/16" | 3-3/8" | 1         | 10          |
| T7-200   | 2"         | 3"                    | 7-1/16"  | 3-1/8"   | 9-1/8"  | 4"     | 1         | 5           |
| T7-250   | 2-1/2"     | 4-1/4"                | 9-1/16"  | 3-11/16" | 12-3/8" | 5-7/8" | -         | 1           |
| T7-300   | 3"         | 4-1/4"                | 9-1/16"  | 4-7/16"  | 12-3/8" | 5-7/8" | -         | 1           |
| T7-400   | 4"         | 5-5/16"               | 11"      | 4-15/16" | 14-1/2" | 7"     | -         | 1           |

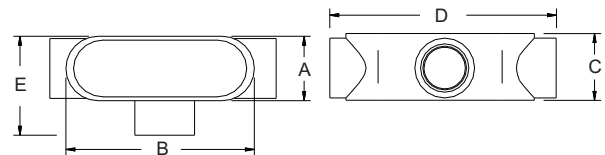

## STAMPED STEEL WEDGENUT COVERS WITH INTEGRAL GASKETS FORM 7

### PRODUCT FEATURES

- ▶ Electroplated Zinc
- ▶ Usable with all other Form 7 conduit bodies
- ▶ Integral Sealing Gaskets
- ▶ Easy installation and removal

| Cat. No.     | Trade Size  | L        | W        | H     | Std. Pkg. | Master Ctn. |
|--------------|-------------|----------|----------|-------|-----------|-------------|
| SCG7-50      | 1/2"        | 3-11/16" | 1-3/8"   | 1/4"  | 50        | 250         |
| SCG7-75      | 3/4"        | 4-5/16"  | 1-9/16"  | 1/4"  | 50        | 250         |
| SCG7-100     | 1"          | 5-1/16"  | 1-13/16" | 1/4"  | 25        | 200         |
| SCG7-125     | 1-1/4"      | 5-9/16"  | 2-3/16"  | 1/4"  | 20        | 100         |
| SCG7-150     | 1-1/2"      | 6-1/16"  | 2-7/16"  | 5/16" | 20        | 100         |
| SCG7-200     | 2"          | 7-1/16"  | 3"       | 5/16" | 10        | 50          |
| SCG7-250/300 | 2-1/2" - 3" | 9-1/16"  | 4-1/4"   | 1/2"  | -         | 10          |
| SCG7-350/400 | 3-1/2" - 4" | 11"      | 5-5/16"  | 1/2"  | -         | 10          |

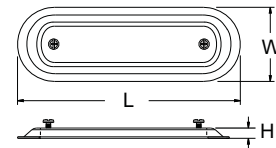

## GRAY IRON WEDGENUT COVERS WITH INTEGRAL GASKETS FORM 7

### PRODUCT FEATURES

- ▶ Electroplated Zinc
- ▶ Usable with all other Form 7 conduit bodies
- ▶ Integral Sealing Gaskets
- ▶ Easy installation and removal

| Cat. No.      | Trade Size  | L        | W        | H      | Std. Pkg. | Master Ctn. |
|---------------|-------------|----------|----------|--------|-----------|-------------|
| GICG7-50      | 1/2"        | 3-11/16" | 1-3/8"   | 9/16"  | 25        | 125         |
| GICG7-75      | 3/4"        | 4-5/16"  | 1-9/16"  | 9/16"  | 25        | 125         |
| GICG7-100     | 1"          | 5-1/16"  | 1-13/16" | 5/8"   | 10        | 100         |
| GICG7-125     | 1-1/4"      | 5-9/16"  | 2-3/16"  | 11/16" | 10        | 50          |
| GICG7-150     | 1-1/2"      | 6-1/16"  | 2-7/16"  | 11/16" | 10        | 50          |
| GICG7-200     | 2"          | 7-1/16"  | 3"       | 3/4"   | -         | 10          |
| GICG7-250/300 | 2-1/2" - 3" | 9-1/16"  | 4-1/4"   | 3/4"   | -         | 10          |
| GICG7-350/400 | 3-1/2" - 4" | 11"      | 5-5/16"  | 13/16" | -         | 10          |

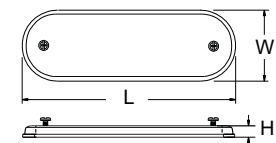

**SAND CAST CLASS 30 GRAY IRON ALLOY**  
**THREADED CONDUIT BODIES**  
**"LB" SERIES**  
**FORM 8**

**PRODUCT FEATURES**

- ▶ Electroplated Zinc
- ▶ Flat back design for maximum internal wiring volume
- ▶ Interchangeable with other Form 8 conduit bodies
- ▶ Suitable for wet location when used with Gasket and Cover
- ▶ NPT Thread Hubs

| Cat. No. | Trade Size | DIMENSIONS - LB SERIES |          |          |           |         | Std. Pkg. | Master Ctn. |
|----------|------------|------------------------|----------|----------|-----------|---------|-----------|-------------|
|          |            | A                      | B        | C        | D         | E       |           |             |
| LB8-50   | 1/2"       | 1-7/16"                | 4-1/4"   | 2-1/4"   | 5-1/8"    | 1-1/4"  | 10        | 50          |
| LB8-75   | 3/4"       | 1-5/8"                 | 4-15/16" | 2-9/16"  | 5-13/16"  | 1-1/2"  | 5         | 25          |
| LB8-100  | 1"         | 1-7/8"                 | 5-5/8"   | 2-7/8"   | 6-5/8"    | 1-3/4"  | 5         | 25          |
| LB8-125  | 1-1/4"     | 2-1/4"                 | 6-11/16" | 3-1/4"   | 7-3/4"    | 2-3/16" | 1         | 10          |
| LB8-150  | 1-1/2"     | 2-13/16"               | 7-15/16" | 3-11/16" | 9-1/16"   | 2-7/16" | 1         | 10          |
| LB8-200  | 2"         | 3-13/16"               | 9-13/16" | 4-11/16" | 11-1/16"  | 2-7/8"  | 1         | 5           |
| LB8-250  | 2-1/2"     | 5-1/16"                | 12-5/16" | 6-1/8"   | 14-5/16"  | 3-3/8"  | -         | 1           |
| LB8-300  | 3"         | 5-1/16"                | 12-5/16" | 6-3/16"  | 14-5/16"  | 4-1/8"  | -         | 1           |
| LB8-350  | 3-1/2"     | 6-5/16"                | 15-1/8"  | 7-3/16"  | 16-14/16" | 4-9/16" | -         | 1           |
| LB8-400  | 4"         | 6-5/16"                | 15-1/8"  | 7-1/4"   | 16-14/16" | 5-1/4"  | -         | 1           |

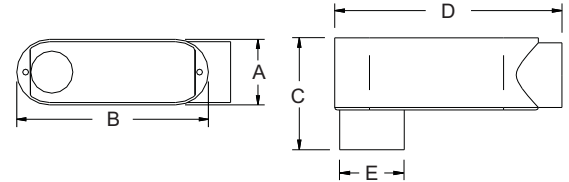

**SAND CAST CLASS 30 GRAY IRON ALLOY**  
**THREADED CONDUIT BODIES**  
**"LR" SERIES**  
**FORM 8**

**PRODUCT FEATURES**

- ▶ Electroplated Zinc
- ▶ Flat back design for maximum internal wiring volume
- ▶ Interchangeable with other Form 8 conduit bodies
- ▶ Suitable for wet location when used with Gasket and Cover
- ▶ NPT Thread Hubs

| Cat. No. | Trade Size | DIMENSIONS - LR SERIES |          |          |          |          | Std. Pkg. | Master Ctn. |
|----------|------------|------------------------|----------|----------|----------|----------|-----------|-------------|
|          |            | A                      | B        | C        | D        | E        |           |             |
| LR8-50   | 1/2"       | 1-7/16"                | 4-1/4"   | 2-1/4"   | 5-1/8"   | 1-7/16"  | 10        | 50          |
| LR8-75   | 3/4"       | 1-5/8"                 | 4-15/16" | 2-7/16"  | 5-13/16" | 1-11/16" | 5         | 25          |
| LR8-100  | 1"         | 1-7/8"                 | 5-5/8"   | 2-3/4"   | 6-5/8"   | 2"       | 5         | 25          |
| LR8-125  | 1-1/4"     | 2-1/4"                 | 6-11/16" | 3-3/16"  | 7-3/4"   | 2-5/16"  | 1         | 10          |
| LR8-150  | 1-1/2"     | 2-13/16"               | 7-15/16" | 3-13/16" | 9-1/16"  | 2-11/16" | 1         | 10          |
| LR8-200  | 2"         | 3-13/16"               | 9-13/16" | 4-15/16" | 11-1/16" | 3-9/16"  | 1         | 5           |
| LR8-250  | 2-1/2"     | 5-1/16"                | 12-5/16" | 6-5/8"   | 14-5/16" | 4-9/16"  | -         | 1           |
| LR8-300  | 3"         | 5-1/16"                | 12-5/16" | 6-5/8"   | 14-5/16" | 4-9/16"  | -         | 1           |

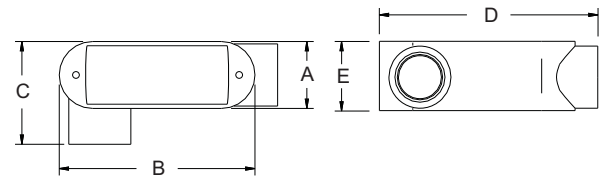

**SAND CAST CLASS 30 GRAY IRON ALLOY**  
**THREADED CONDUIT BODIES**  
**"LL" SERIES**  
**FORM 8**

**PRODUCT FEATURES**

- ▶ Electroplated Zinc
- ▶ Flat back design for maximum internal wiring volume
- ▶ Interchangeable with other Form 8 conduit bodies
- ▶ Suitable for wet location when used with Gasket and Cover
- ▶ NPT Thread Hubs

| Cat. No. | Trade Size | DIMENSIONS - LL SERIES |          |          |          |          | Std. Pkg. | Master Ctn. |
|----------|------------|------------------------|----------|----------|----------|----------|-----------|-------------|
|          |            | A                      | B        | C        | D        | E        |           |             |
| LL8-50   | 1/2"       | 1-7/16"                | 4-1/4"   | 2-1/4"   | 5-1/8"   | 1-7/16"  | 10        | 50          |
| LL8-75   | 3/4"       | 1-5/8"                 | 4-15/16" | 2-7/16"  | 5-13/16" | 1-11/16" | 5         | 25          |
| LL8-100  | 1"         | 1-7/8"                 | 5-5/8"   | 2-3/4"   | 6-5/8"   | 2"       | 5         | 25          |
| LL8-125  | 1-1/4"     | 2-1/4"                 | 6-11/16" | 3-3/16"  | 7-3/4"   | 2-5/16"  | 1         | 10          |
| LL8-150  | 1-1/2"     | 2-13/16"               | 7-15/16" | 3-13/16" | 9-1/16"  | 2-11/16" | 1         | 10          |
| LL8-200  | 2"         | 3-13/16"               | 9-13/16" | 4-15/16" | 11-1/16" | 3-9/16"  | 1         | 5           |
| LL8-250  | 2-1/2"     | 5-1/16"                | 12-5/16" | 6-5/8"   | 14-5/16" | 4-9/16"  | -         | 1           |
| LL8-300  | 3"         | 5-1/16"                | 12-5/16" | 6-5/8"   | 14-5/16" | 4-9/16"  | -         | 1           |

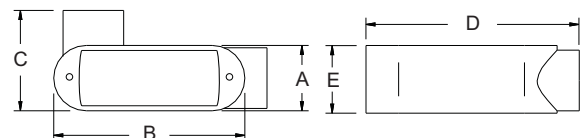



# E15 | Rigid Conduit Bodies - Form 8

## SAND CAST CLASS 30 GRAY IRON ALLOY THREADED CONDUIT BODIES "C" SERIES FORM 8

### PRODUCT FEATURES

- ▶ Electroplated Zinc
- ▶ Flat back design for maximum internal wiring volume
- ▶ Interchangeable with other Form 8 conduit bodies
- ▶ Suitable for wet location when used with Gasket and Cover
- ▶ NPT Thread Hubs

| Cat. No. | Trade Size | DIMENSIONS - C SERIES |          |          |          |         | Std. Pkg. | Master Ctn. |
|----------|------------|-----------------------|----------|----------|----------|---------|-----------|-------------|
|          |            | A                     | B        | C        | D        | E       |           |             |
| C8-50    | 1/2"       | 1-7/16"               | 4-1/4"   | 1-7/16"  | 6"       | 1-1/4"  | 10        | 50          |
| C8-75    | 3/4"       | 1-5/8"                | 4-15/16" | 1-11/16" | 6-11/16" | 1-1/2"  | 5         | 25          |
| C8-100   | 1"         | 1-7/8"                | 5-5/8"   | 2"       | 7-9/16"  | 1-3/4"  | 5         | 25          |
| C8-125   | 1-1/4"     | 2-1/4"                | 6-11/16" | 2-5/16"  | 8-13/16" | 2-3/16" | 1         | 10          |
| C8-150   | 1-1/2"     | 2-13/16"              | 7-15/16" | 2-11/16" | 10-3/16" | 2-7/16" | 1         | 10          |
| C8-200   | 2"         | 3-13/16"              | 9-13/16" | 3-9/16"  | 12-3/8"  | 2-7/8"  | 1         | 5           |
| C8-250   | 2-1/2"     | 5-1/16"               | 12-5/16" | 4-9/16"  | 16-1/4"  | 3-3/8"  | -         | 1           |
| C8-300   | 3"         | 5-1/16"               | 12-5/16" | 4-9/16"  | 16-1/4"  | 4-1/8"  | -         | 1           |

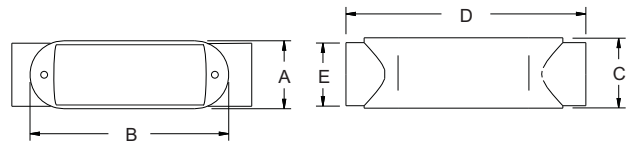

## SAND CAST CLASS 30 GRAY IRON ALLOY THREADED CONDUIT BODIES "T" SERIES FORM 8

### PRODUCT FEATURES

- ▶ Electroplated Zinc
- ▶ Flat back design for maximum internal wiring volume
- ▶ Interchangeable with other Form 8 conduit bodies
- ▶ Suitable for wet location when used with Gasket and Cover
- ▶ NPT Thread Hubs

| Cat. No. | Trade Size | DIMENSIONS - T SERIES |          |          |          |          | Std. Pkg. | Master Ctn. |
|----------|------------|-----------------------|----------|----------|----------|----------|-----------|-------------|
|          |            | A                     | B        | C        | D        | E        |           |             |
| T8-50    | 1/2"       | 1-7/16"               | 4-1/4"   | 1-3/4"   | 6"       | 2-1/4"   | 5         | 25          |
| T8-75    | 3/4"       | 1-5/8"                | 4-15/16" | 2"       | 6-11/16" | 2-7/16"  | 5         | 25          |
| T8-100   | 1"         | 1-7/8"                | 5-5/8"   | 2-1/4"   | 7-9/16"  | 2-3/4"   | 2         | 20          |
| T8-125   | 1-1/4"     | 2-1/4"                | 6-11/16" | 2-5/16"  | 8-13/16" | 3-3/16"  | 1         | 10          |
| T8-150   | 1-1/2"     | 2-13/16"              | 7-15/16" | 2-11/16" | 10-3/16" | 3-13/16" | 1         | 10          |
| T8-200   | 2"         | 3-13/16"              | 9-13/16" | 3-9/16"  | 12-3/8"  | 4-15/16" | 1         | 5           |
| T8-250   | 2-1/2"     | 5-1/16"               | 12-5/16" | 4-9/16"  | 16-1/4"  | 6-5/8"   | -         | 1           |
| T8-300   | 3"         | 5-1/16"               | 12-5/16" | 4-9/16"  | 16-1/4"  | 6-5/8"   | -         | 1           |

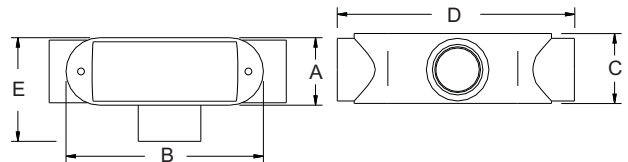

## STAMPED STEEL COVERS WITH INTEGRAL GASKETS FORM 8

### PRODUCT FEATURES

- ▶ Stainless Steel Screws
- ▶ Electroplated Zinc
- ▶ Integral Sealing Gaskets
- ▶ Usable with all other Form 8 conduit bodies

| Cat. No.     | Trade Size  | L        | W        | H      | Std. Pkg. |
|--------------|-------------|----------|----------|--------|-----------|
| SCG8-50      | 1/2"        | 4-1/4"   | 1-7/16"  | 1/4"   | 50        |
| SCG8-75      | 3/4"        | 4-7/8"   | 1-5/8"   | 1/4"   | 50        |
| SCG8-100     | 1"          | 5-5/8"   | 1-7/8"   | 1/4"   | 25        |
| SCG8-125     | 1-1/4"      | 6-11/16" | 2-3/16"  | 1/4"   | 20        |
| SCG8-150     | 1-1/2"      | 7-15/16" | 2-13/16" | 5/16"  | 20        |
| SCG8-200     | 2"          | 9-13/16" | 3-13/16" | 3/8"   | 10        |
| SCG8-250/300 | 2-1/2" - 3" | 12-5/16" | 5-1/16"  | 9/16"  | 5         |
| SCG8-350/400 | 3-1/2" - 4" | 15"      | 6-5/16"  | 11/16" | 5         |

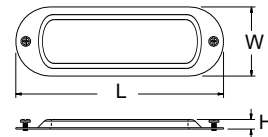

## GRAY IRON COVERS WITH INTEGRAL GASKETS FORM 8

### PRODUCT FEATURES

- ▶ Stainless Steel Screws
- ▶ Electroplated Zinc
- ▶ Integral Sealing Gaskets
- ▶ Usable with all other Form 8 conduit bodies

| Cat. No.      | Trade Size  | L        | W        | H      | Std. Pkg. |
|---------------|-------------|----------|----------|--------|-----------|
| GICG8-50      | 1/2"        | 4-1/4"   | 1-7/16"  | 3/8"   | 50        |
| GICG8-75      | 3/4"        | 4-7/8"   | 1-5/8"   | 3/8"   | 50        |
| GICG8-100     | 1"          | 5-5/8"   | 1-7/8"   | 3/8"   | 25        |
| GICG8-125     | 1-1/4"      | 6-11/16" | 2-3/16"  | 9/16"  | 20        |
| GICG8-150     | 1-1/2"      | 7-15/16" | 2-13/16" | 7/8"   | 20        |
| GICG8-200     | 2"          | 9-13/16" | 3-13/16" | 1-1/8" | 10        |
| GICG8-250/300 | 2-1/2" - 3" | 12-5/16" | 5-1/16"  | 1-1/2" | 5         |
| GICG8-350/400 | 3-1/2" - 4" | 15"      | 6-5/16"  | 1-1/2" | 5         |

