

**SAND CAST CLASS 30 GRAY IRON ALLOY**  
**THREADED CONDUIT BODIES**  
**"LB" SERIES**  
**FORM 8**

**PRODUCT FEATURES**

- ▶ Electroplated Zinc
- ▶ Flat back design for maximum internal wiring volume
- ▶ Interchangeable with other Form 8 conduit bodies
- ▶ Suitable for wet location when used with Gasket and Cover
- ▶ NPT Thread Hubs

Cat. No.	Trade Size	DIMENSIONS - LB SERIES					Std. Pkg.	Master Ctn.
		A	B	C	D	E		
LB8-50	1/2"	1-7/16"	4-1/4"	2-1/4"	5-1/8"	1-1/4"	10	50
LB8-75	3/4"	1-5/8"	4-15/16"	2-9/16"	5-13/16"	1-1/2"	5	25
LB8-100	1"	1-7/8"	5-5/8"	2-7/8"	6-5/8"	1-3/4"	5	25
LB8-125	1-1/4"	2-1/4"	6-11/16"	3-1/4"	7-3/4"	2-3/16"	1	10
LB8-150	1-1/2"	2-13/16"	7-15/16"	3-11/16"	9-1/16"	2-7/16"	1	10
LB8-200	2"	3-13/16"	9-13/16"	4-11/16"	11-1/16"	2-7/8"	1	5
LB8-250	2-1/2"	5-1/16"	12-5/16"	6-1/8"	14-5/16"	3-3/8"	-	1
LB8-300	3"	5-1/16"	12-5/16"	6-3/16"	14-5/16"	4-1/8"	-	1
LB8-350	3-1/2"	6-5/16"	15-1/8"	7-3/16"	16-14/16"	4-9/16"	-	1
LB8-400	4"	6-5/16"	15-1/8"	7-1/4"	16-14/16"	5-1/4"	-	1

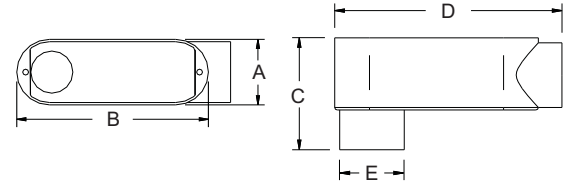

**SAND CAST CLASS 30 GRAY IRON ALLOY**  
**THREADED CONDUIT BODIES**  
**"LR" SERIES**  
**FORM 8**

**PRODUCT FEATURES**

- ▶ Electroplated Zinc
- ▶ Flat back design for maximum internal wiring volume
- ▶ Interchangeable with other Form 8 conduit bodies
- ▶ Suitable for wet location when used with Gasket and Cover
- ▶ NPT Thread Hubs

Cat. No.	Trade Size	DIMENSIONS - LR SERIES					Std. Pkg.	Master Ctn.
		A	B	C	D	E		
LR8-50	1/2"	1-7/16"	4-1/4"	2-1/4"	5-1/8"	1-7/16"	10	50
LR8-75	3/4"	1-5/8"	4-15/16"	2-7/16"	5-13/16"	1-11/16"	5	25
LR8-100	1"	1-7/8"	5-5/8"	2-3/4"	6-5/8"	2"	5	25
LR8-125	1-1/4"	2-1/4"	6-11/16"	3-3/16"	7-3/4"	2-5/16"	1	10
LR8-150	1-1/2"	2-13/16"	7-15/16"	3-13/16"	9-1/16"	2-11/16"	1	10
LR8-200	2"	3-13/16"	9-13/16"	4-15/16"	11-1/16"	3-9/16"	1	5
LR8-250	2-1/2"	5-1/16"	12-5/16"	6-5/8"	14-5/16"	4-9/16"	-	1
LR8-300	3"	5-1/16"	12-5/16"	6-5/8"	14-5/16"	4-9/16"	-	1

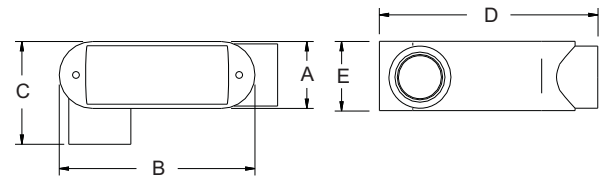

**SAND CAST CLASS 30 GRAY IRON ALLOY**  
**THREADED CONDUIT BODIES**  
**"LL" SERIES**  
**FORM 8**

**PRODUCT FEATURES**

- ▶ Electroplated Zinc
- ▶ Flat back design for maximum internal wiring volume
- ▶ Interchangeable with other Form 8 conduit bodies
- ▶ Suitable for wet location when used with Gasket and Cover
- ▶ NPT Thread Hubs

Cat. No.	Trade Size	DIMENSIONS - LL SERIES					Std. Pkg.	Master Ctn.
		A	B	C	D	E		
LL8-50	1/2"	1-7/16"	4-1/4"	2-1/4"	5-1/8"	1-7/16"	10	50
LL8-75	3/4"	1-5/8"	4-15/16"	2-7/16"	5-13/16"	1-11/16"	5	25
LL8-100	1"	1-7/8"	5-5/8"	2-3/4"	6-5/8"	2"	5	25
LL8-125	1-1/4"	2-1/4"	6-11/16"	3-3/16"	7-3/4"	2-5/16"	1	10
LL8-150	1-1/2"	2-13/16"	7-15/16"	3-13/16"	9-1/16"	2-11/16"	1	10
LL8-200	2"	3-13/16"	9-13/16"	4-15/16"	11-1/16"	3-9/16"	1	5
LL8-250	2-1/2"	5-1/16"	12-5/16"	6-5/8"	14-5/16"	4-9/16"	-	1
LL8-300	3"	5-1/16"	12-5/16"	6-5/8"	14-5/16"	4-9/16"	-	1

