

BOX MOUNTING ADAPTER

PRODUCT FEATURES

- ▶ Mount 4" and 4-11/16" square boxes
- ▶ Adjustable Back Support helps maintain rigidity when installed
- ▶ Low profile design limits drywall bulging
- ▶ For use with metal or wood studs
- ▶ 4" Ring can be mounted without box for low voltage applications with #8-32 screws

Cat. No.	Description	Std. Pkg.
BMA-23	Box Mounting Adapter with up to 3-1/2" Far Side Support	25
BMA-4	Box Mounting Adapter with up to 4" Far Side Support	25
FS-456-EXT	Far-side Support Extender for up to 6" Studs, Compatible with BMA-23 & BMA-4, tool-less	50

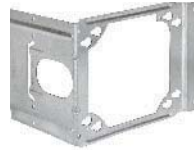

BMA-23



BMA-4



FS-456-EXT

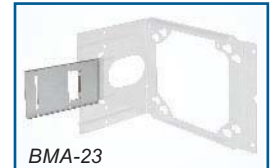

BMA-23

Fold FS-456-EXT onto BMA's for up to 6" far-side support

HEIGHT ADJ. BOX INSTALL TOOL

PRODUCT FEATURES

- ▶ Adjustable and magnetic platform
- ▶ Platform can be preset at a specific height for a consistent box and bracket installation
- ▶ Compatible with all Orbit Stud Brackets

Cat. No.	Description	Std. Pkg.	Mst. Ctn.
HABILIT	Height Adjustable Box Installation Template	1	4



Front View

Back View

Compatible with all Orbit Stud Brackets

PATENTED

ORBIT INDUSTRIES EXCLUSIVE



Video Available On Our Website!

IMPROVED MAGNET DESIGN!

HABILIT FEATURES

Tool-free stackability for switch and receptacles!

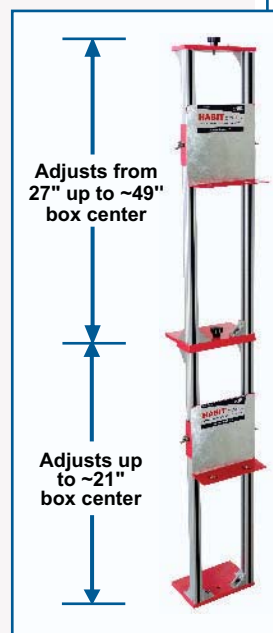

Bubble Level



Adjustable via hand nuts

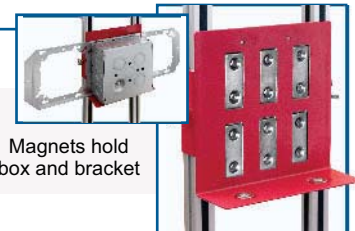

Magnets hold box and bracket