

PVC FLOOR BOX

PRODUCT FEATURES

- ▶ PVC for Concrete Slab Installations
- ▶ Minimum Depth 3.75"
- ▶ PFLB-R-C includes cap and plugs
- ▶ Adapter ring, PFLB-AR, (sold separately) allows for installation of 1-Gang Round Pop-Up Floor Box Covers

| Cat. No. | Sides Openings | Description | Use With | Cu. In. | Std. Pkg. |
|------------------------------------|-----------------|---|------------------|---------|-----------|
| PFLB-R-C <small>NEW</small> | (4) - 1" x 3/4" | Round PVC Floor Box for concrete slab installations | PFLB-AR | 90 | 10 |
| PFLB-AR <small>NEW</small> | - | PVC Adapter Ring for Round Floor Box Pop-up Covers (Sold Separately) | PFLB-R-C | - | 10 |
| *FLBPU-AR | - | PVC Adapter Ring for Round Floor Box Pop-up Covers (Sold Separately) | E971FB (Carlton) | - | 10 |

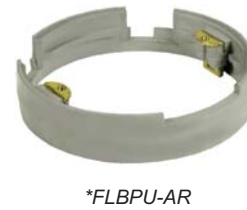

FLOOR BOX COMPATIBILITY TABLE

See Page G5 for Details on Orbit's Full Line of Pop-Up Floor Boxes



EXPLODED VIEW OF ASSEMBLY
(Sold Separately)

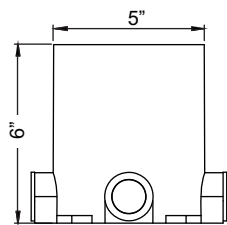

PFLB-R-C

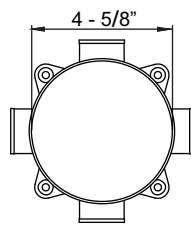

PFLB-AR

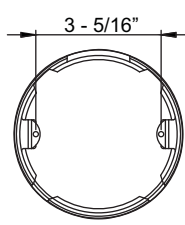

*FLBPU-AR

