

E5 | Rigid Conduit Bodies - Aluminum

MOGUL THREADED COPPER-FREE ALUMINUM ALLOY EXTRA-LARGE RIGID CONDUIT BODIES "LB" SERIES

PRODUCT FEATURES

- ▶ Die Cast Aluminum Cover included
- ▶ Fiber Gasket included
- ▶ Suitable for wet location when used with Gasket and Cover
- ▶ NPT Thread Hubs



Cat. No.	Trade Size	DIMENSIONS - LB SERIES						Std. Pkg.
		A	B	C1	C2	D	E	
LBM-150	1-1/2"	3"	13-7/16"	5"	4"	14-1/4"	2-3/4"	1
LBM-200	2"	3"	13-7/16"	5"	4"	14-1/4"	2-3/4"	1
LBM-250	2-1/2"	4-5/8"	21-7/8"	8-11/16"	5-1/8"	22-3/4"	4-1/4"	1
LBM-300	3"	4-5/8"	21-7/8"	8-11/16"	5-1/8"	22-3/4"	4-1/4"	1
LBM-350	3-1/2"	5-5/8"	28-1/2"	10"	6-1/8"	29-1/8"	5-1/8"	1
LBM-400	4"	5-5/8"	28-1/2"	10"	6-1/8"	29-1/8"	5-1/8"	1

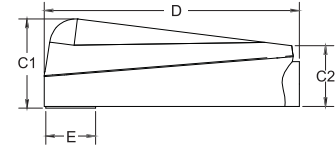
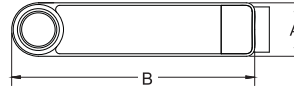

DIE CAST COPPER-FREE ALUMINUM THREADED CONDUIT BODIES "LB" SERIES WITHOUT COVERS

PRODUCT FEATURES

- ▶ Gray color
- ▶ Suitable for wet location when used with Gasket and Cover
- ▶ NPT Thread Hubs

Cat. No.	Trade Size	DIMENSIONS - LB SERIES					Std. Pkg.
		A	B	C	D	E	
LB-50	1/2"	1-5/16"	3-7/8"	2-1/8"	4-5/16"	1-1/16"	10
LB-75	3/4"	1-9/16"	4-11/16"	2-3/8"	5-1/8"	1-5/16"	10
LB-100	1"	1-13/16"	5-3/8"	2-3/4"	5-15/16"	1-9/16"	5
LB-125	1-1/4"	2-1/2"	7-5/16"	3-1/2"	7-13/16"	2"	2
LB-150	1-1/2"	2-1/2"	7-5/16"	3-1/2"	7-13/16"	2-3/16"	2
LB-200	2"	3-3/16"	9-1/2"	4-1/2"	10-1/16"	2-11/16"	1
LB-250	2-1/2"	4-1/2"	12-1/16"	5-5/16"	12-13/16"	3-5/16"	1
LB-300	3"	4-1/2"	12-1/16"	5-15/16"	12-13/16"	3-15/16"	1
LB-350	3-1/2"	5-9/16"	15-1/16"	7-5/16"	15-5/8"	4-9/16"	1
LB-400	4"	5-9/16"	15-7/16"	7-5/16"	15-5/8"	5"	1

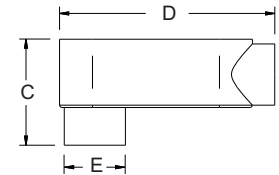
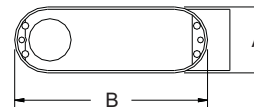
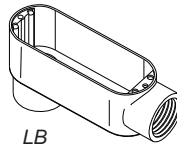

DIE CAST COPPER-FREE ALUMINUM THREADED CONDUIT BODIES "LL" SERIES WITHOUT COVERS

PRODUCT FEATURES

- ▶ Gray color
- ▶ Suitable for wet location when used with Gasket and Cover
- ▶ NPT Thread Hubs

Cat. No.	Trade Size	DIMENSIONS - LL SERIES					Std. Pkg.
		A	B	C	D	E	
LL-50	1/2"	1-5/16"	3-7/8"	2-1/16"	4-5/16"	1-3/8"	10
LL-75	3/4"	1-9/16"	4-11/16"	2-5/16"	5-1/8"	1-5/8"	10
LL-100	1"	1-13/16"	5-3/8"	2-11/16"	5-15/16"	1-7/8"	5
LL-125	1-1/4"	2-1/2"	7-5/16"	3-1/2"	7-13/16"	2-1/2"	2
LL-150	1-1/2"	2-1/2"	7-5/16"	3-1/2"	7-13/16"	2-1/2"	2
LL-200	2"	3-3/16"	9-1/2"	4-5/16"	10-1/16"	3-3/8"	1
LL-250	2-1/2"	4-1/2"	12-1/16"	5-7/8"	12-13/16"	4"	1
LL-300	3"	4-1/2"	12-1/16"	5-7/8"	12-13/16"	4-1/2"	1
LL-400	4"	5-9/16"	15-7/16"	7-11/16"	15-5/8"	5-5/8"	1

