

E1 Rigid Assembled Conduit Bodies - Aluminum

DIE CAST COPPER-FREE ALUMINUM THREADED CONDUIT BODIES "LB" SERIES

PRODUCT FEATURES

- ▶ Die Cast Cover and Neoprene Gasket included
- ▶ Gray color
- ▶ Suitable for wet location when used with Gasket and Cover
- ▶ NPT Thread Hubs

While supplies last. Will be superseded by LB-AS Series.

Cat. No.	Trade Size	DIMENSIONS - LB SERIES					Std. Pkg.
		A	B	C	D	E	
LB-50A	1/2"	1-5/16"	3-7/8"	2-1/8"	4-5/16"	1-1/16"	10
LB-75A	3/4"	1-9/16"	4-11/16"	2-3/8"	5-1/8"	1-5/16"	10
LB-100A	1"	1-13/16"	5-3/8"	2-3/4"	5-15/16"	1-9/16"	5
LB-125A	1-1/4"	2-1/2"	7-5/16"	3-1/2"	7-13/16"	2"	2
LB-150A	1-1/2"	2-1/2"	7-5/16"	3-1/2"	7-13/16"	2-3/16"	2
LB-200A	2"	3-3/16"	9-1/2"	4-1/2"	10-1/16"	2-11/16"	1
LB-250A	2-1/2"	4-1/2"	12-1/16"	5-5/16"	12-13/16"	3-5/16"	1
LB-300A	3"	4-1/2"	12-1/16"	5-15/16"	12-13/16"	3-15/16"	1
LB-350A	3-1/2"	5-9/16"	15-1/16"	7-5/16"	15-5/8"	4-9/16"	1
LB-400A	4"	5-9/16"	15-7/16"	7-5/16"	15-5/8"	5"	1

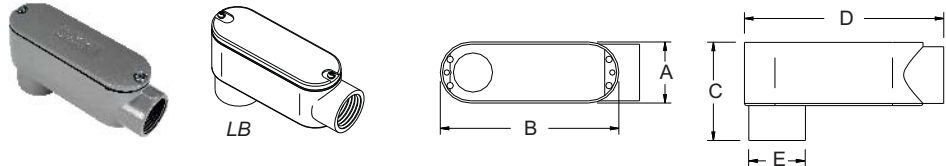

DIE CAST COPPER-FREE ALUMINUM THREADED CONDUIT BODIES "LL" SERIES

PRODUCT FEATURES

- ▶ Die Cast Cover and Neoprene Gasket included
- ▶ Gray color
- ▶ Suitable for wet location when used with Gasket and Cover
- ▶ NPT Thread Hubs

While supplies last. Will be superseded by LL-AS Series.

Cat. No.	Trade Size	DIMENSIONS - LL SERIES					Std. Pkg.
		A	B	C	D	E	
LL-50A	1/2"	1-5/16"	3-7/8"	2-1/16"	4-5/16"	1-3/8"	10
LL-75A	3/4"	1-9/16"	4-11/16"	2-5/16"	5-1/8"	1-5/8"	10
LL-100A	1"	1-13/16"	5-3/8"	2-11/16"	5-15/16"	1-7/8"	5
LL-125A	1-1/4"	2-1/2"	7-5/16"	3-1/2"	7-13/16"	2-1/2"	2
LL-150A	1-1/2"	2-1/2"	7-5/16"	3-1/2"	7-13/16"	2-1/2"	2
LL-200A	2"	3-3/16"	9-1/2"	4-5/16"	10-1/16"	3-3/8"	1
LL-250A	2-1/2"	4-1/2"	12-1/16"	5-7/8"	12-13/16"	4"	1
LL-300A	3"	4-1/2"	12-1/16"	5-7/8"	12-13/16"	4-1/2"	1
LL-400A	4"	5-9/16"	15-1/16"	7-11/16"	15-5/8"	5-5/8"	1

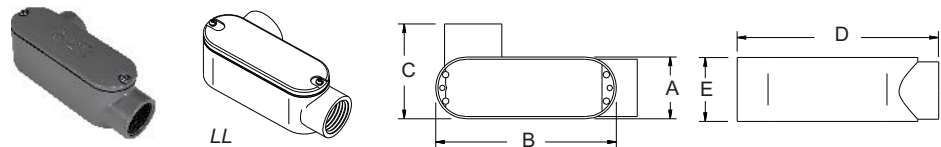

DIE CAST COPPER-FREE ALUMINUM THREADED CONDUIT BODIES "LR" SERIES

PRODUCT FEATURES

- ▶ Die Cast Cover and Neoprene Gasket included
- ▶ Gray color
- ▶ Suitable for wet location when used with Gasket and Cover
- ▶ NPT Thread Hubs

While supplies last. Will be superseded by LR-AS Series.

Cat. No.	Trade Size	DIMENSIONS - LR SERIES					Std. Pkg.
		A	B	C	D	E	
LR-50A	1/2"	1-5/16"	3-7/8"	2-1/16"	4-5/16"	1-3/8"	10
LR-75A	3/4"	1-9/16"	4-11/16"	2-5/16"	5-1/8"	1-5/8"	10
LR-100A	1"	1-13/16"	5-3/8"	2-11/16"	5-15/16"	1-7/8"	5
LR-125A	1-1/4"	2-1/2"	7-5/16"	3-1/2"	7-13/16"	2-1/2"	2
LR-150A	1-1/2"	2-1/2"	7-5/16"	3-1/2"	7-13/16"	2-1/2"	2
LR-200A	2"	3-3/16"	9-1/2"	4-5/16"	10-1/16"	3-3/8"	1
LR-250A	2-1/2"	4-1/2"	12-1/16"	5-7/8"	12-13/16"	4"	1
LR-300A	3"	4-1/2"	12-1/16"	5-7/8"	12-13/16"	4-1/2"	1
LR-400A	4"	5-9/16"	15-1/16"	7-11/16"	15-5/8"	5-5/8"	1

