

**DIE CAST COPPER-FREE ALUMINUM THREADED CONDUIT BODIES "LR" SERIES WITHOUT COVERS**

**PRODUCT FEATURES**

- ▶ Gray color
- ▶ Suitable for wet location when used with Gasket and Cover
- ▶ NPT Thread Hubs

Cat. No.	Trade Size	DIMENSIONS - LR SERIES					Std. Pkg.
		A	B	C	D	E	
LR-50	1/2"	1-5/16"	3-7/8"	2-1/16"	4-5/16"	1-3/8"	10
LR-75	3/4"	1-9/16"	4-11/16"	2-5/16"	5-1/8"	1-5/8"	10
LR-100	1"	1-13/16"	5-3/8"	2-11/16"	5-15/16"	1-7/8"	5
LR-125	1-1/4"	2-1/2"	7-5/16"	3-1/2"	7-13/16"	2-1/2"	2
LR-150	1-1/2"	2-1/2"	7-5/16"	3-1/2"	7-13/16"	2-1/2"	2
LR-200	2"	3-3/16"	9-1/2"	4-5/16"	10-1/16"	3-3/8"	1
LR-250	2-1/2"	4-1/2"	12-1/16"	5-7/8"	12-13/16"	4"	1
LR-300	3"	4-1/2"	12-1/16"	5-7/8"	12-13/16"	4-1/2"	1
LR-400	4"	5-9/16"	15-1/16"	7-11/16"	15-5/8"	5-5/8"	1

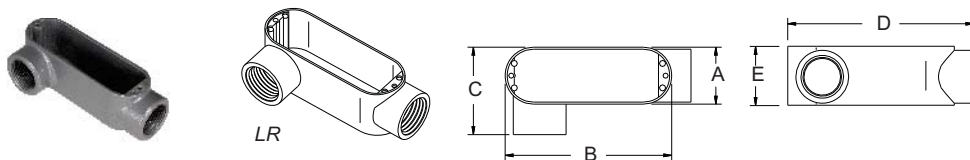

**DIE CAST COPPER-FREE ALUMINUM THREADED CONDUIT BODIES "C" SERIES WITHOUT COVERS**

**PRODUCT FEATURES**

- ▶ Gray color
- ▶ Suitable for wet location when used with Gasket and Cover
- ▶ NPT Thread Hubs

Cat. No.	Trade Size	DIMENSIONS - C SERIES					Std. Pkg.
		A	B	C	D	E	
C-50	1/2"	1-5/16"	3-7/8"	1-3/8"	4-11/16"	1-1/16"	10
C-75	3/4"	1-9/16"	4-11/16"	1-5/8"	5-1/2"	1-5/16"	10
C-100	1"	1-13/16"	5-3/8"	1-7/8"	6-7/16"	1-9/16"	5
C-125	1-1/4"	2-1/2"	7-5/16"	2-1/2"	8-3/8"	2"	2
C-150	1-1/2"	2-1/2"	7-5/16"	2-1/2"	8-3/8"	2-3/16"	2
C-200	2"	3-3/16"	9-1/2"	3-3/8"	10-9/16"	2-11/16"	1
C-250	2-1/2"	4-1/2"	12-1/16"	4"	13-1/2"	3-5/16"	1
C-300	3"	4-1/2"	12-1/16"	4-1/2"	13-1/2"	3-15/16"	1
C-400	4"	5-9/16"	15-1/16"	5-5/8"	16-5/16"	4-9/16"	1

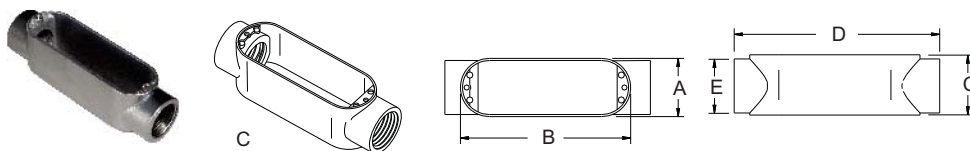

**DIE CAST COPPER-FREE ALUMINUM THREADED CONDUIT BODIES "T" SERIES WITHOUT COVERS**

**PRODUCT FEATURES**

- ▶ Gray color
- ▶ Suitable for wet location when used with Gasket and Cover
- ▶ NPT Thread Hubs

Cat. No.	Trade Size	DIMENSIONS - T SERIES					Std. Pkg.
		A	B	C	D	E	
T-50	1/2"	1-5/16"	3-7/8"	1-3/8"	4-11/16"	2-1/16"	10
T-75	3/4"	1-9/16"	4-11/16"	1-5/8"	5-1/2"	2-5/16"	10
T-100	1"	1-13/16"	5-3/8"	1-7/8"	6-7/16"	2-11/16"	5
T-125	1-1/4"	2-1/2"	7-5/16"	2-1/2"	8-3/8"	3-1/2"	2
T-150	1-1/2"	2-1/2"	7-5/16"	2-1/2"	8-3/8"	3-1/2"	2
T-200	2"	3-3/16"	9-1/2"	3-3/8"	10-9/16"	4-5/16"	1
T-250	2-1/2"	4-1/2"	12-1/16"	4"	13-1/2"	5-7/8"	1
T-300	3"	4-1/2"	12-1/16"	4-1/2"	13-1/2"	5-7/8"	1
T-400	4"	5-9/16"	15-1/16"	5-5/8"	16-5/16"	7-11/16"	1

